



Europäisches Patentamt
European Patent Office
Office européen des brevets



(11) **EP 1 219 768 A3**

(12) **EUROPEAN PATENT APPLICATION**

(88) Date of publication A3:
10.07.2002 Bulletin 2002/28

(51) Int Cl.7: **E05C 9/20**

(43) Date of publication A2:
03.07.2002 Bulletin 2002/27

(21) Application number: **01830626.6**

(22) Date of filing: **04.10.2001**

(84) Designated Contracting States:
**AT BE CH CY DE DK ES FI FR GB GR IE IT LI LU
MC NL PT SE TR**
Designated Extension States:
AL LT LV MK RO SI

(72) Inventor: **Bellandi, Paolo**
51012 Castellare di Pescia (Pistoia) (IT)

(74) Representative: **Bardini, Marco Luigi et al**
c/o Società Italiana Brevetti S.p.A.
Corso dei Tintori, 25
50122 Firenze (IT)

(30) Priority: **13.12.2000 IT FI200249**

(71) Applicant: **Euroinvest S.r.L.**
55011 Altopascio (Lucca) (IT)

(54) **Mechanical junction assembly for perimetrical locking device of wings of burglarproof doors and windows made of metallic profiles**

(57) A mechanical junction assembly between a coupling or transmission member (105) and a rod (107) for driving a perimetrical locking device of a wing of an burglarproof door or window. The coupling or transmission member is formed with an end tongue (111) overlapping the rod (107) and a lug (109) projecting from the tongue (111) for engaging with a hole (110) formed on the rod (107). The junction assembly comprises connection means (113) engaging with the rod (107) and the coupling or transmission member (105) at the side opposite to the overlapping side, whereby, even if the tongue (111) would be deformed and, as a result, the relevant lug (109) would be disengaged, the member (105) and the driving rod (107) are kept connected to each other, the connection means (113) being kept inaccessible below the member (105) and the rod (107).

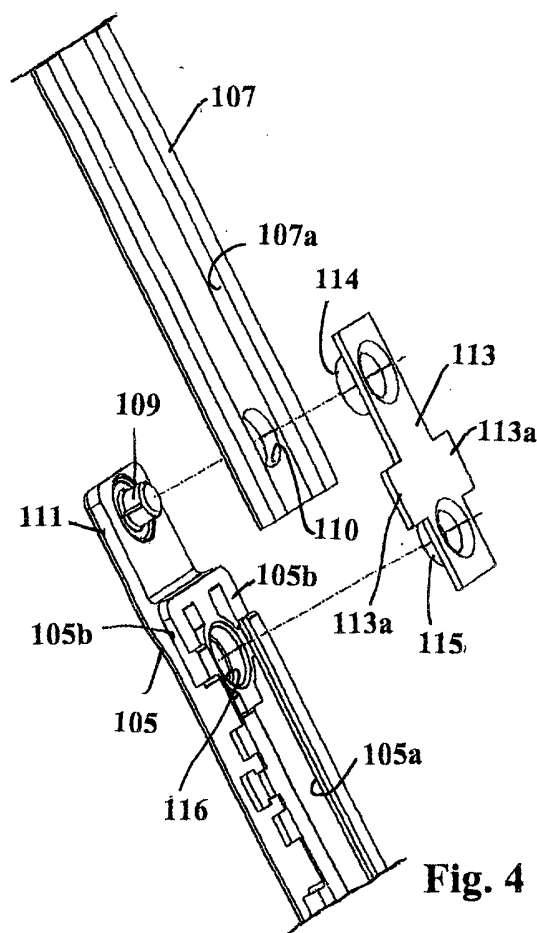

EP 1 219 768 A3



European Patent
Office

EUROPEAN SEARCH REPORT

Application Number
EP 01 83 0626

DOCUMENTS CONSIDERED TO BE RELEVANT			
Category	Citation of document with indication, where appropriate, of relevant passages	Relevant to claim	CLASSIFICATION OF THE APPLICATION (Int.Cl.7)
X	EP 0 163 816 A (FUHR CARL GMBH & CO) 11 December 1985 (1985-12-11) * page 4, line 25 - line 33; figure 3 *	8,9,11,12	E05C9/20
X	FR 2 509 777 A (SIEGENIA FRANK KG) 21 January 1983 (1983-01-21) * page 15, line 24 - page 16, line 1; figure 1 *	8-11	
X	DE 86 32 641 U (MAYER & CO.) 19 February 1987 (1987-02-19) * page 8, line 1 - line 21; figure *	8,9	
A	FR 2 280 769 A (FRANK GMBH WILH) 27 February 1976 (1976-02-27) * the whole document *	1	
A	FR 2 487 419 A (FERCO INT USINE FERRURES) 29 January 1982 (1982-01-29) * the whole document *	1	
A	DE 26 11 430 A (ESCHER JAKOB) 29 September 1977 (1977-09-29) * the whole document *	1	TECHNICAL FIELDS SEARCHED (Int.Cl.7)
A	FR 1 462 748 A (VEREINIGTE BAUBESCHLAGFABRIKEN GRETSCH & CO. GMBH) 27 February 1967 (1967-02-27) * the whole document *	1	E05C E05F
The present search report has been drawn up for all claims			
Place of search THE HAGUE		Date of completion of the search 7 May 2002	Examiner Pieracci, A
<p>CATEGORY OF CITED DOCUMENTS</p> <p>X : particularly relevant if taken alone Y : particularly relevant if combined with another document of the same category A : technological background O : non-written disclosure P : intermediate document</p> <p>T : theory or principle underlying the invention E : earlier patent document, but published on, or after the filing date D : document cited in the application L : document cited for other reasons & : member of the same patent family, corresponding document</p>			

EPO FORM 1503 03/82 (P04C01)

**ANNEX TO THE EUROPEAN SEARCH REPORT
ON EUROPEAN PATENT APPLICATION NO.**

EP 01 83 0626

This annex lists the patent family members relating to the patent documents cited in the above-mentioned European search report. The members are as contained in the European Patent Office EDP file on
The European Patent Office is in no way liable for these particulars which are merely given for the purpose of information.

07-05-2002

Patent document cited in search report		Publication date		Patent family member(s)	Publication date
EP 0163816	A	11-12-1985	DE	3416675 A1	21-11-1985
			AT	35714 T	15-07-1988
			DE	3563763 D1	18-08-1988
			EP	0163816 A2	11-12-1985
FR 2509777	A	21-01-1983	DE	3127929 A1	03-02-1983
			AT	374549 B	10-05-1984
			AT	204182 A	15-09-1983
			FR	2509777 A1	21-01-1983
DE 8632641	U	19-02-1987	DE	8632641 U1	19-02-1987
FR 2280769	A	27-02-1976	AT	354895 B	11-02-1979
			AT	593675 A	15-06-1979
			BE	832062 A1	01-12-1975
			FR	2280769 A1	27-02-1976
FR 2487419	A	29-01-1982	FR	2487419 A1	29-01-1982
DE 2611430	A	29-09-1977	DE	2611430 A1	29-09-1977
FR 1462748	A	27-02-1967	NONE		