



Europäisches Patentamt
European Patent Office
Office européen des brevets



(11) **EP 1 236 668 A3**

(12) **EUROPEAN PATENT APPLICATION**

(88) Date of publication A3:
30.10.2002 Bulletin 2002/44

(51) Int Cl.7: **B65H 65/00, B65H 67/04,
B65H 54/26**

(43) Date of publication A2:
04.09.2002 Bulletin 2002/36

(21) Application number: **02002723.1**

(22) Date of filing: **06.02.2002**

(84) Designated Contracting States:
**AT BE CH CY DE DK ES FI FR GB GR IE IT LI LU
MC NL PT SE TR**
Designated Extension States:
AL LT LV MK RO SI

(72) Inventors:
• **Kawabata, Hirayuki**
Otsu-shi, Shiga (JP)
• **Hasui, Keini**
Otsu-shi, shiga (JP)

(30) Priority: **28.02.2001 JP 2001054553**
03.09.2001 JP 2001265275

(74) Representative: **Liedl, Christine et al**
c/o Hansmann & Vogeser,
Albert-Rosshaupter-Strasse 65
81369 München (DE)

(71) Applicant: **Murata Kikai Kabushiki Kaisha**
Minami-ku, Kyoto-shi, Kyoto 601 (JP)

(54) **Yarn setting method to winding tube in automatic winder and automatic winder**

(57) The object of the present invention is to provide a yarn setting method to the winding tube in the automatic winder and the automatic winder capable of carrying out the setting work of the yarn of the yarn supplying body to the winding tube smoothly and speedily without adding a special device. The automatic winder 1 of the yarn setting method is provided with winding units 2 arranged in a plurality wherein each winding unit 2 includes the lower yarn trapping-leading member 22 for trapping the yarn of the yarn supplying body 5 and leading to the yarn joining device 20, and forms the yarn winding body 6 by winding up the yarn of the yarn supplying body 5 to a winding tube 7. In addition, such automatic winder comprises the doffing device 3 which runs along the plurality of winding units 2, and according to the demand signal from the winding unit 2, arrives at the winding unit 2 which transmitted the demand signal, and by picking up the yarn of the yarn supplying body 5 trapped by the lower yarn trapping-leading member 22, sets the yarn to the winding tube set in the winding unit (Fig. 1).

FIG. 1

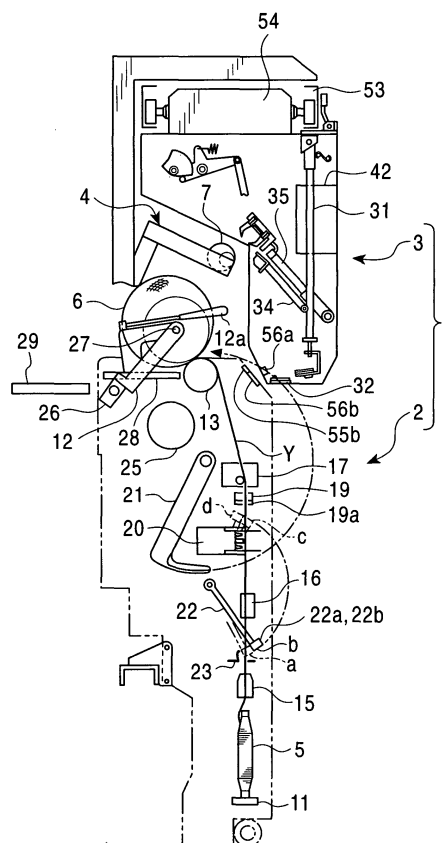

EP 1 236 668 A3



European Patent
Office

EUROPEAN SEARCH REPORT

Application Number
EP 02 00 2723

DOCUMENTS CONSIDERED TO BE RELEVANT			
Category	Citation of document with indication, where appropriate, of relevant passages	Relevant to claim	CLASSIFICATION OF THE APPLICATION (Int.Cl.7)
P, A	EP 1 127 831 A (W. SCHLAFHORST AG & CO) 29 August 2001 (2001-08-29) * the whole document *	1, 6, 9-11	B65H65/00 B65H67/04 B65H54/26
A	PATENT ABSTRACTS OF JAPAN vol. 2000, no. 13, 5 February 2001 (2001-02-05) -& JP 2000 289928 A (MURATA MACH LTD), 17 October 2000 (2000-10-17) * abstract; figures *	1-11	
D, A	PATENT ABSTRACTS OF JAPAN vol. 1996, no. 07, 31 July 1996 (1996-07-31) -& JP 08 059086 A (MURATA MACH LTD), 5 March 1996 (1996-03-05) * abstract; figures *	1-10	
D, A	PATENT ABSTRACTS OF JAPAN vol. 1999, no. 02, 26 February 1999 (1999-02-26) -& JP 10 297826 A (MURATA MACH LTD), 10 November 1998 (1998-11-10) * abstract; figures *	1-10	
A	PATENT ABSTRACTS OF JAPAN vol. 1999, no. 02, 26 February 1999 (1999-02-26) -& JP 10 297827 A (MURATA MACH LTD), 10 November 1998 (1998-11-10) * abstract; figures *	1-10	
The present search report has been drawn up for all claims			
Place of search		Date of completion of the search	Examiner
THE HAGUE		9 September 2002	D'Hulster, E
CATEGORY OF CITED DOCUMENTS X : particularly relevant if taken alone Y : particularly relevant if combined with another document of the same category A : technological background O : non-written disclosure P : intermediate document T : theory or principle underlying the invention E : earlier patent document, but published on, or after the filing date D : document cited in the application L : document cited for other reasons & : member of the same patent family, corresponding document			

EPO FORM 1503 03/82 (P04001)

**ANNEX TO THE EUROPEAN SEARCH REPORT
ON EUROPEAN PATENT APPLICATION NO.**

EP 02 00 2723

This annex lists the patent family members relating to the patent documents cited in the above-mentioned European search report.
The members are as contained in the European Patent Office EDP file on
The European Patent Office is in no way liable for these particulars which are merely given for the purpose of information.

09-09-2002

Patent document cited in search report		Publication date	Patent family member(s)	Publication date
EP 1127831	A	29-08-2001	DE 10007950 A1	23-08-2001
			EP 1127831 A2	29-08-2001
			JP 2001247258 A	11-09-2001
			US 2001022071 A1	20-09-2001
<hr/>				
JP 2000289928	A	17-10-2000	NONE	
<hr/>				
JP 08059086 8	A		NONE	
<hr/>				
JP 10297826 8	A		NONE	
<hr/>				
JP 10297827 8	A		NONE	
<hr/>				

EPO FORM P0459

For more details about this annex : see Official Journal of the European Patent Office, No. 12/82