



Europäisches Patentamt
European Patent Office
Office européen des brevets



(11)

EP 1 243 708 A2

(12)

EUROPEAN PATENT APPLICATION

(43) Date of publication:
25.09.2002 Bulletin 2002/39

(51) Int Cl.7: **E03C 1/04**

(21) Application number: **02380060.0**

(22) Date of filing: **18.03.2002**

(84) Designated Contracting States:
**AT BE CH CY DE DK ES FI FR GB GR IE IT LI LU
MC NL PT SE TR**
Designated Extension States:
AL LT LV MK RO SI

(72) Inventor: **Sanz Fernandez, Jordi**
08970 Sant Joan Despi (ES)

(74) Representative: **Ponti Sales, Adelaida et al**
Oficina Ponti
C. Consell de Cent, 322
08007 Barcelona (ES)

(30) Priority: **23.03.2001 ES 200100810**

(71) Applicant: **Industrias Ramon Soler, S.A.**
08970 Sant Joan Despi (ES)

(54) Fitting device for taps

(57) It is characterised in that the means for fitting the body of the tap (6) to a base surface (7) are made up of a pair of swivelling bodies (3) that can be moved over the length of a threaded stem (2), and are able to swivel between a substantially vertical position and a substantially horizontal position, said threaded stem (2) being provided with an upper recess (5) to make the stem rotate in relation to tap body (6) using a suitable tool, with access to that recess being possible through an orifice (8) provided in the upper part of said tap body (6).

This permits fitting of the tap to be carried out from its upper part.

FIG. 3

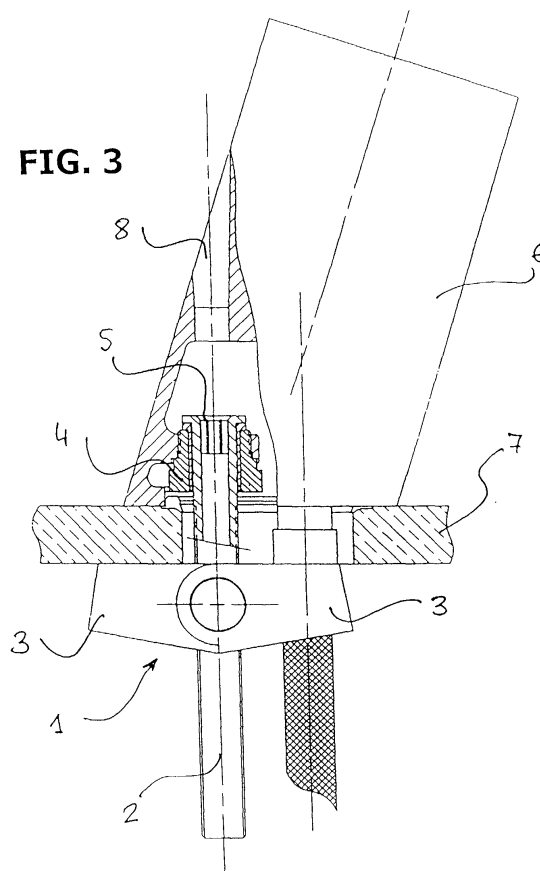

EP 1 243 708 A2

Description

[0001] This invention relates to a fitting device for taps, which permits fitting of the tap to a base surface from the upper part of said base.

BACKGROUND OF THE INVENTION

[0002] Currently existing systems for fitting taps including means for securing the tap body to a base surface. Said securing means have the main disadvantage of being accessible only from the lower part by means of a suitable tool. In consequence, fitting the taps is a very uncomfortable task for fitters.

[0003] An objective of this invention is therefore to achieve a fitting device for taps that can be used comfortably and easily by tap fitters, in which fitting can be carried out by means of a suitable tool by gaining access to the fitting device from the upper part of the tap body.

DESCRIPTION OF THE INVENTION

[0004] The fitting device of the invention manages to resolve the aforesaid disadvantages, while presenting other advantages which will be described.

[0005] The tap fitting device of this invention is characterised in that said means of fixing the tap body to a base surface are made up of a pair of swivelling bodies that can be moved over the length of a threaded stem, and are able to swivel between a substantially vertical position and a substantially horizontal position, said threaded stem being provided with an upper recess to make the stem rotate in relation to the tap body using a suitable tool, with access to that recess being possible through an orifice provided in the upper part of said tap body.

[0006] Thanks to this characteristic, the tap can be fitted from its upper part, which is much more comfortable for the tap fitter. Moreover, thanks to the presence of the two swivelling bodies, locking of the tap body into position is ensured once it has passed through the orifice of the base surface, when the threaded stem is made to rotate.

[0007] Advantageously, said swivelling bodies can have associated elastic means that exercise pressure to force them to take up their substantially horizontal position.

[0008] Preferably, said means for fixing the fitting device to the tap body are made up of a nut which is housed in a complementary orifice of the tap body.

BRIEF DESCRIPTION OF THE DRAWINGS

[0009] For a better understanding of all that has been outlined, some drawings are attached which, schematically and solely by way of non-restrictive example, show a practical case of embodiment.

[0010] Figure 1 is a perspective view of the fitting de-

vice of this invention.

[0011] Figure 2 is an elevation view of the tap body with the fitting device of this invention in a position prior to fitting; and

5 **[0012]** Figure 3 is an elevation view similar to that of Figure 2, with the tap body fitted onto a base surface.

DESCRIPTION OF A PREFERRED EMBODIMENT

10 **[0013]** As Figure 1 shows, the fitting device of this invention, marked in general with number reference 1, includes a threaded stem 2, a pair of swivelling bodies 3 that move along it, and a nut 4 fitted onto the upper part of said stem 2.

15 **[0014]** On the upper part of said stem 2 there is a recess 5 suitable for insertion of a tool.

[0015] The swivelling bodies 3 can swivel between a substantially vertical position and a substantially horizontal position, while said swivelling bodies 3 have associated elastic means (not shown in the figures) to force said bodies 3 to adopt their substantially horizontal position.

[0016] For fitting of the tap body 6 onto a base surface, such as a washbasin or a bath, the nut 4 has firstly to be housed in a complementary cavity provided in the tap body 6, leaving the nut 4 blocked in this position. As the nut 4 is placed on the upper part of the threaded stem 2, the stem will be fitted onto the tap body 6.

25 **[0017]** The next step will be to place the swivelling bodies 3 in their substantially vertical position (shown in Figure 2). They can be placed thus manually, for due to the action of the elastic means said bodies 3 will be in their substantially horizontal position.

30 **[0018]** Thanks to adoption of this position, the swivelling bodies 3 and the lower part of the stem 2 will be able to pass through the orifice provided in the base surface (Figure 2).

35 **[0019]** Once the swivelling bodies 3 have passed through the hole of the base surface 7, they will take up their substantially horizontal position due to the effect of gravity and thanks to the action of the elastic means.

[0020] When the swivelling bodies 3 are in their substantially horizontal position (Figure 3), the recess 5 must be accessed in order to make the threaded stem 2 rotate by means of a suitable tool. Access to the recess will be had from the upper part of the tap body 6 through an orifice 8 provided in it.

40 **[0021]** Fitting of the tap will thus be much more comfortable than if the fitting device had to be reached from its lower part.

50 **[0022]** Despite the fact that reference has been made to one specific embodiment of the invention, it will be obvious to a person skilled in the art that the fitting device described allows of many variations and modifications, and that all the details mentioned may be replaced by others that are technically equivalent, without departing from the scope of protection defined by the attached claims.

Claims

1. Fitting device for taps, which includes means for fixing it to the tap body (6) and means for fixing the position of the tap body (6) to a base surface (7),
characterised in that said means of fixing the tap body (6) to a base surface (7) are made up of a pair of swivelling bodies (3) that can be moved over the length of a threaded stem (2), and are able to swivel between a substantially vertical position and a substantially horizontal position, said threaded stem (2) being provided with an upper recess (5) to make the stem rotate in relation to tap body (6) using a suitable tool, with access to that recess being possible through an orifice (8) provided in the upper part of said tap body (6).
2. Fitting device as claimed in Claim 1, **characterised in that** said swivelling means (3) have associated elastic means that exercise pressure to force them to take up their substantially horizontal position.
3. Fitting device as claimed in Claim 1, **characterised in that** said means for fixing the fitting device (1) to the tap body (6) are made up of a nut (4) which is inserted into a complementary orifice of the tap body (6).

30

35

40

45

50

55

FIG. 1

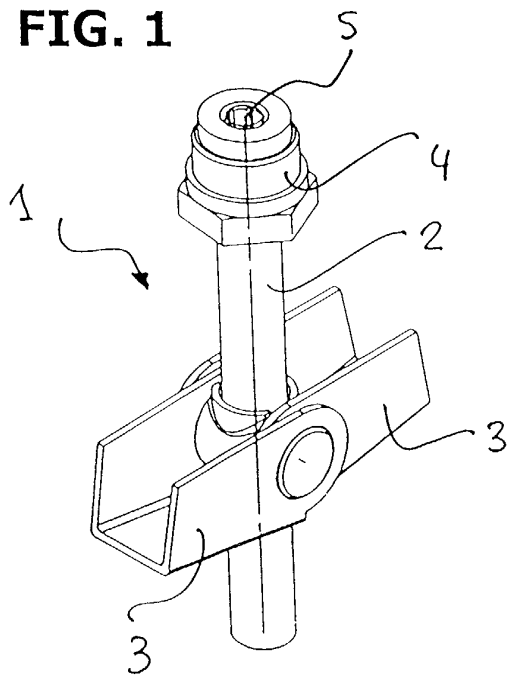

FIG. 2

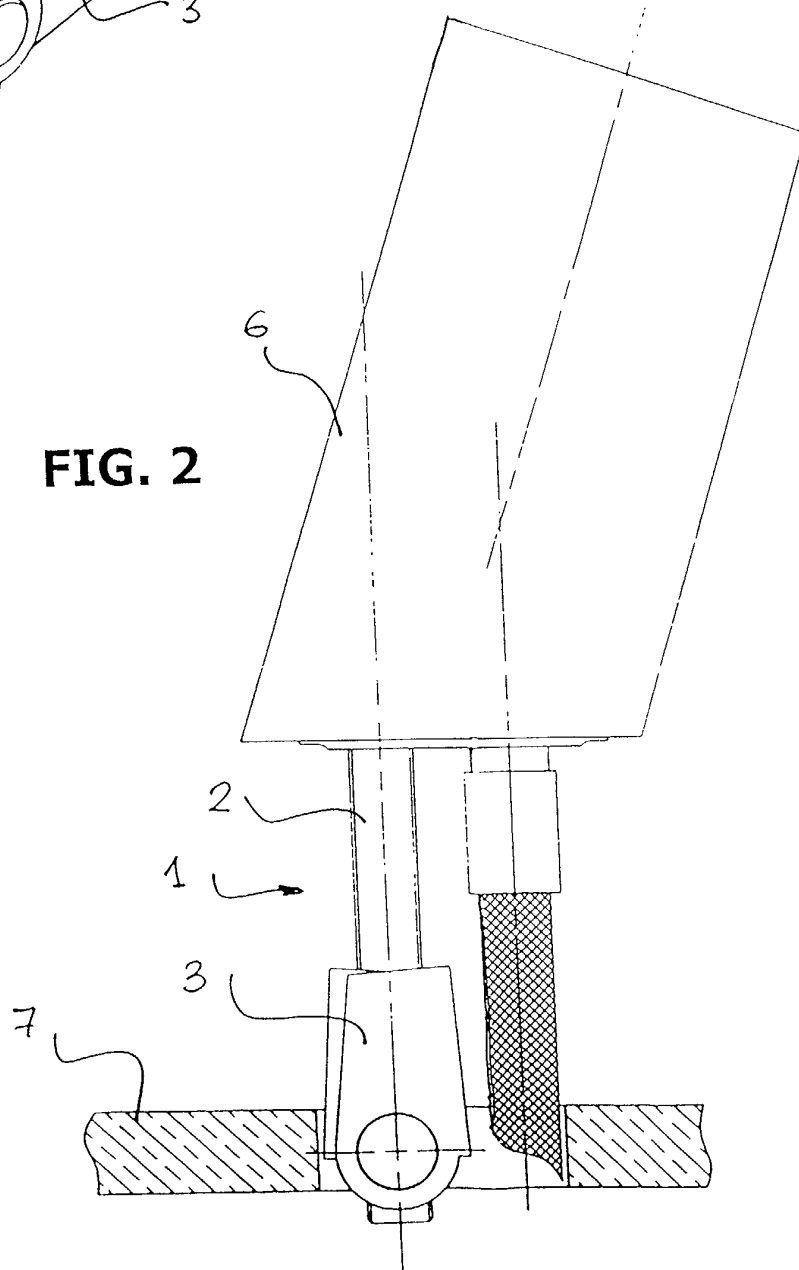

FIG. 3

