



(12) **EUROPEAN PATENT APPLICATION**

(43) Date of publication:
09.10.2002 Bulletin 2002/41

(51) Int Cl.7: **B65D 43/18**, B65D 47/26,
B65D 17/50

(21) Application number: **01108318.5**

(22) Date of filing: **02.04.2001**

(84) Designated Contracting States:
AT BE CH CY DE DK ES FI FR GB GR IE IT LI LU
MC NL PT SE TR
Designated Extension States:
AL LT LV MK RO SI

• **Schwingel, Colleen M.**
Chicago, IL 60610 (US)

(71) Applicant: **Rexam Beverage Can Company**
Chicago, IL 60631-3542 (US)

(74) Representative:
Ruschke, Hans Edvard, Dipl.-Ing. et al
Ruschke Hartmann Becker
Pienzenauerstrasse 2
81679 München (DE)

(72) Inventors:
• **McHenry, Robert J.**
St. Charles, IL 60174 (US)
• **Tung, Thomas T.**
Barrington, IL 60010 (US)

Remarks:
Amended claims in accordance with Rule 86 (2)
EPC.

(54) **Resealable closure for open end of beverage containers**

(57) A resealable closure (10) for beverage containers (12) uses initial physical interference to initiate a seal between a sealing flap (22) and a dispensing port (20) in a lid (18) of the resealable closure (10). In certain embodiments, once the initial seal is achieved, a pressure differential develops, resulting in additional force tending to bias the sealing flap (22) toward the dispensing port (20). The sealing flap (22) is actuated by an external

drive means (24), that can also be a dust cover to prevent debris from contaminating any surfaces that may come into contact with the contents of the beverage container (12). In many embodiments, there is a slack between initial movement of the external drive means (24) and initial movement of the sealing flap (22), during which the pressure differential is preferably equalized through the unsealing of a vent hole (36) in the resealable closure (10).

FIG. 2

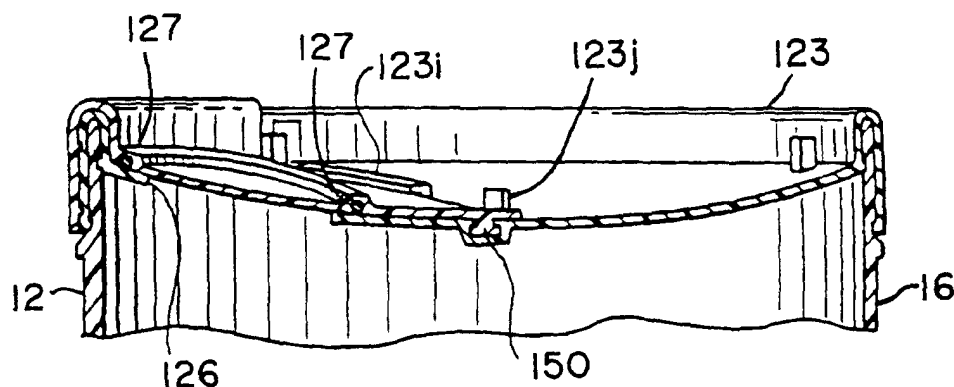

Description

Background Of The Invention

Field Of The Invention

[0001] The present invention relates to a closure member for an open end of a container, and more particularly to a resealable closure with a lid and a sealing flap mounted to the lid for closing a dispensing port provided in the lid. The invention further relates to resealable closures that utilize a combination of initial mechanical interference and pressure differential to achieve and maintain a tight, reliable seal of a dispensing port of a beverage container.

Description Of The Prior Art

[0002] The prior art includes a large number of containers for accommodating various types of goods, including beverages and other liquids. Such containers typically include a cylinder with an integrally formed bottom and an open top. They also include a closure that normally closes the open top and defines a sealed port through which one may discharge the contents of the container after breaking the seal. Some of the closures include resealable dispensing ports that allow a user to repeatedly open and close the port.

[0003] A resealable closure should have a rugged, simple and inexpensive construction that allows repeated closing and opening while maintaining a tight seal even when the container holds pressurized fluid. It should allow easy opening, and it should simulate the local shape and lip feel of a drinking glass. A resealable closure should also keep the area that the lips contact clean by shielding it from environmental dirt or dust. It should further minimize slosh and facilitate pouring..

[0004] In the case of beverage cans, most of the inventions previously proposed to enable resealing a carbonated beverage container in order that a portion of the contents could be saved for a later time have proposed using a variation on a bottle cork-- i.e., they involve inserting some kind of stopper into the dispensing port created by pushing in a scored portion of the metal end at the time of initial opening. None of these inventions have been commercially successful. The problem is that the carbonated beverage will emit a gas that exerts a force in the direction to dislodge the stopper from the opening. On a hot day, the pressure could exert a force of between forty and fifty pounds. If the stopper is jammed into the opening with sufficient mechanical interference to resist such a high force, it will not be possible for the average consumer to remove the stopper at normal use temperatures. In the design of conventional easy-open metal can ends, it is assumed that the consumer can exert a force no larger than 8 pounds.

[0005] One embodiment of the present invention avoids the above problem by using a sliding motion that

is nearly perpendicular to the primary vertical force generated by the internal pressure. There are two basic limitations with this design. The first is that, because of the creep tendencies of the plastic materials most suitable for such flaps, the flaps must be fairly thick in order to resist the forces generated by the internal pressure. The second is that the internal pressure creates a high friction force that resists the sliding of the flap.

[0006] The resealability problem has been solved for narrow neck bottles through the use of threaded bottle caps. Because of the mechanical advantage presented by the shallow angle of the threads, a moderate twisting force suffices to remove a cap that is strong enough to resist high internal pressures. With wider neck bottles, this type of closure is less successful. Although the same mechanical advantage principles apply, the force exerted by the gas pressure within the bottle is much higher. At a high beverage pressure, therefore, the friction force resisting the turning of the cap will be uncomfortably high. It is also well known that a threaded or lug closure on a wide mouth jar subjected to an external pressure (i.e. internal vacuum) can also be extremely difficult to open.

[0007] To reduce this friction force, it would be desirable to have a means to vent the pressure in the can or bottle prior to opening. There have been several inventions to achieve venting of the net internal pressure before full opening of a closure. Unfortunately, most of these inventions achieve the venting through the initial rotation of the closure. Such a venting means during the course of the rotation prevents a sudden and, possibly, dangerous missing of the closure when the threads on the closure eventually clear those on the container. Because the closure must be rotated in order to vent the pressure, these designs cannot aid in reducing the force required for initial rotation.

[0008] It would be possible to provide a separate, small plug that would initially cover a venting port (for purposes of this disclosure, a venting port means a hole or other means of communication between the inside of the container and the outside environment). This would require the consumer to first remove this small venting plug and then, in a separate action, remove the component that seals the dispensing port. It would be more desirable if the same action that initially vents the can could, when continued, open the dispensing port.

[0009] With current easy-open ends for metal beverage cans, one can vent and then open the end with the same lifting motion. In the initial portion of this venting, a small vent crack is created by fracturing a scored line in the panel. Unfortunately, this form of venting is non-reversible. Even if there were to be a means to reseal the main dispensing port, gas and liquid could still escape through this vent crack.

SUMMARY OF THE INVENTION

[0010] In accordance with the present invention, a clo-

sure member for closing an open end of a container includes a main body segment, or lid, secured to edge portions of a beverage container adjacent the open end and a moveable sealing flap mounted to the lid. The lid includes a discharge port, or dispensing port, through which fluid discharges from the container. The sealing flap is moveable between a first position in which it seals the dispensing port, and a second position away from the dispensing port.

[0011] In one embodiment, the sealing flap slides over the lid as it moves from the first to the second position. In this embodiment, the sealing flap lies rotatably mounted to the lid, and a sealing liner or gasket lies between the lid and the sealing flap to assure a fluid-tight seal between these two segments.

[0012] In each of the remaining embodiments of the present invention, a sealing flap is used to block the dispensing port of a beverage container in such a way that a pressure differential, i.e. the difference between the internal pressure of a beverage container and the surrounding atmosphere, enhances a seal of the dispensing port. For example, when the sealing flap is situated inside the container, i.e., under the lid of the container, and a sealing gasket is provided between the sealing flap and the perimeter of the dispensing port on the underside of the lid, the internal pressure of the container assists in forcing the sealing flap into a sealed engagement with the perimeter of the dispensing port.

[0013] In all the embodiments of the present invention, it is desirable to use some type of physical interference to force the sealing flap into sealed engagement with the perimeter of the dispensing port, regardless of whether the sealing flap is positioned above or below the lid. Once the sealing force is initiated by some type of physical interference, the carbonation within the beverage will gradually escape from the beverage and fill the head space beneath the lid, resulting in a build up of internal pressure. This creates a gradually increasing pressure differential, which enhances the seal between the sealing flap and the perimeter of the dispensing port in those embodiments where the sealing flap is situated beneath the lid. While it is recognized that the principles of the present invention can be applied to containers for non-carbonated beverages, and even to vacuum-packaged beverage and food containers, a particularly useful application of the present invention is for pressurized beverage containers, which are typically carbonated drinks.

[0014] In order to avoid exposing the surfaces that will contact the beverage or the consumer's mouth to debris, it is also desirable to provide a movable dust cover on the outside, i.e., top, of the lid. Many of the embodiments of the present invention include such a dust cover. Advantageously, the external drive means of the resealable closure of the present invention provides a means to actuate the sealing flap between a sealed and an unsealed position, and also serves as the dust cover. It is further recognized that it would be advantageous to vent

internal pressure of the beverage container prior to unsealing the dispensing port. This is because the internal pressure increases the force, including the friction force between the sealing flap and the perimeter of the dispensing port of the container lid, as well as between the sealing flap and other points of contact with the container. Once the internal pressure of the beverage container is vented, these resulting forces are substantially reduced, making it much easier to unseal the dispensing port.

[0015] A particular advantage of the present invention is that the forces necessary to initially vent the pressure in order to generally equalize the internal pressure with the surrounding atmospheric pressure are much lower in the various embodiments now disclosed, as compared to many conventional beverage containers, including bottles, because with these new resealable closures, venting is achieved prior to initial movement of the sealing flap. A further advantage is that any relatively high forces that must be exerted by a user on the external drive means in order to overcome the initial mechanical interference that had been used to initiate the seal between the sealing flap and the perimeter of the dispensing port on the underside of the lid need only be exerted for a relatively short interval of time. This is an important improvement over beverage container lids that would require the user to exert high forces throughout the entire duration of travel of the drive means to overcome forces from mechanical interference.

[0016] In order to be able to achieve repeated re-sealing and re-opening of the dispensing port, and retain adequate pressure within the beverage container after re-sealing so that carbonated beverages will still be carbonated after being left to sit for extended periods of time, it is necessary not only to re-seal the dispensing port, but also to re-seal any venting means that are used to initially vent the internal pressure of the beverage container. In fact, if the vent is not re-sealed, liquid product could also flow through the vent when the container is resting on its side. While re-sealing of the venting means may take place after re-sealing of the dispensing port, it is most desirable if the venting means is re-sealed prior to, or at least during, re-sealing of the dispensing port, so that a user does not forget to re-seal the vent once the dispensing port is re-sealed. Alternatively, in embodiments where the venting means is closed subsequent to re-sealing of the dispensing port, it is desirable to provide a tactile and/or audible reminder that activates upon re-sealing of the venting means, such that a user is assured both the dispensing port and the venting means are re-sealed. The manner in which these and other features of the present invention are accomplished is explained in greater detail in the following Detailed Description of the Preferred Embodiments and the accompanying drawings.

BRIEF DESCRIPTION OF THE DRAWINGS

[0017] For a more complete understanding of this invention, one should now refer to the embodiments illustrated in greater detail in the accompanying drawings and described below by way of examples of the invention. In the drawings:

FIG. 1 is a top plan view of an embodiment of the closure member of the present invention in place over a container;
 FIG. 2 is a sectional view taken along lines 2-2 of FIG. 1;
 FIG. 3 is a front elevation view of the closure member of FIG. 1 in place over a container;
 FIG. 4 is a plan view of the closure of FIG. 1, showing the flap segment as it moves away from the first position of FIG. 1 to a second position where it does not obstruct the discharge port of the closure member;
 FIG. 5 is an enlarged sectional view of the left hand portion of FIG. 2;
 FIG. 6 is an exploded view of a second embodiment of the resealable closure for beverage containers of the present invention, in which the sealing flap is initially oriented beneath the dispensing port in the lid;
 FIG. 7 is an enlarged exploded view of the interconnection between the external drive means and the sealing flap of the resealable closure shown in FIG. 6;
 FIG. 8 is a perspective view of the sealing flap of the resealable closure shown in FIG. 6;
 FIG. 9a is a top view of the resealable closure shown in FIG. 6, with the external drive means in its initial position, and wherein both the dispensing port of the beverage container and the vent are sealed;
 FIG. 9b is a bottom view of the resealable closure shown in FIG. 6, showing the resealable closure at the same instant in time as FIG. 9a, and taken along lines 9b-9b of FIG. 6, in which the sealing flap is in its initial position;
 FIG. 10a is a top view of the resealable closure shown in FIG. 6, with the external drive means moved to an intermediate position, wherein the vent of the resealable closure is unsealed and the dispensing port of the beverage container is still sealed;
 FIG. 10b is a bottom view of the resealable closure shown in FIG. 6, showing the resealable closure at the same instant in time as FIG. 10a, with the sealing flap still in its initial position;
 FIG. 11a is a top view of the resealable closure shown in FIG. 6, with the external drive means moved to a final position, wherein the vent of the resealable closure is unsealed and the dispensing port of the beverage container is unsealed;
 FIG. 11b is a bottom view of the resealable closure

shown in FIG. 6, showing the resealable closure at the same instant in time as FIG. 11a, with the sealing flap having been moved to its final position;
 FIG. 12 is a perspective view, broken away, of a plastic beverage container having a resealable closure of the type shown in FIG. 6;
 FIG. 13 is a perspective view, broken away, of a beverage container in the form of a metal can, including a resealable closure of the type shown in FIG. 10;
 FIG. 14 is an exploded view of a third embodiment of the resealable closure for beverage containers of the present invention;
 FIG. 15 is an exploded view of a modified version of the third embodiment of the resealable closure for beverage containers of the present invention;
 FIG. 16 is an enlarged exploded view of the interconnection between the external drive means and the sealing flap of the resealable closure shown in FIG. 15;
 FIG. 17 is an exploded view of a fourth embodiment of the resealable closure for beverage containers of the present invention;
 FIG. 18 is an exploded view of a fifth embodiment of the resealable closure for beverage containers of the present invention;
 FIG. 19 is a bottom view of the resealable closure in FIG. 18;
 FIG. 20 is a cross-sectional view taken along lines 20-20 of FIG. 19;
 FIG. 21 is an exploded view of a modified version of the fifth embodiment of the resealable closure for beverage containers of the present invention;
 FIG. 22 is a perspective view, cut away, of a sixth embodiment of the resealable closure for beverage containers of the present invention with the external drive means in its initial position, and wherein both the dispensing port of the beverage container and the vent are sealed;
 FIG. 23 is a left side view, partially broken away, of the resealable closure for beverage containers shown in FIG. 22, with the external drive means moved to an intermediate position, wherein the vent of the resealable closure is unsealed and the dispensing port of the beverage container is still sealed;
 FIG. 24 is an enlarged view, broken away, of an exemplary venting mechanism for the resealable closure for beverage containers shown in FIG. 22;
 FIG. 25 is a left side view of the resealable closure for beverage containers shown in FIG. 22, with the external drive means moved to a final position, wherein the vent of the resealable closure is unsealed and the dispensing port of the beverage container is unsealed;
 FIG. 26 is an exploded view of a seventh embodiment of the resealable closure of the present invention;
 FIG. 27 is a rear plan view of the drive mechanism

of the resealable closure of the present invention shown in FIG. 26;

FIG. 28 is a perspective view, broken away, of an eighth embodiment of the resealable closure of the present invention;

FIG. 29 is a perspective view of a ninth embodiment of the resealable closure of the present invention;

FIG. 30 is a cross-section of the resealable closure for beverage containers shown in FIG. 29;

- FIG. 31 is an exploded view of a tenth embodiment of the resealable closure of the present invention;

FIG. 32 is a cross-section of the resealable closure for beverage containers shown in FIG. 31; and

FIG. 33 is a bottom view of the resealable closure for beverage containers shown in FIG. 22, taken along lines 33-33 of FIG. 22.

[0018] While the following disclosure describes the invention in connection with various embodiments and modifications of those embodiments, one should understand that the invention is not limited to these embodiments and modifications. Furthermore, one should understand that the drawings are not to scale and that graphic symbols, diagrammatic representatives, and fragmentary views, in part, illustrate the embodiment. In certain instances, the disclosure may not include details which are not necessary for an understanding of the present invention such as conventional details of fabrication and assembly.

Detailed Description of the Preferred Embodiments

[0019] The resealable closure of the present invention shown generally at 10 closes an open top of a beverage container 12. The beverage container 12 may be a wide mouth plastic enclosure, a metal can, or any other enclosure made of any suitable material. The resealable closure 10 may be a one-piece, integrally formed unit or component made out of a single or multi-layered plastic material such as polyolefin or polypropylene, PET, or any other suitable material that provides a gas barrier and has sufficient strength, flexibility and corrosion resistance. The resealable closure 10 includes a lid 18 and a sealing flap 22 moveably mounted to the lid.

[0020] Referring to FIGS. 1-5, a first embodiment of the present invention includes a resealable closure 10 having a main body segment, or lid 18, with a rim portion 123b that has the same shape around the entire circumference of a beverage container 12. In addition, the connection between the sealing flap 22 and the lid 18 is a single pivot 150 about the center of the resealable closure 10 and the container 12. This pivot includes a knob portion of the sealing 22 flap and a cooperating well of the lid 18. In this embodiment, the sealing flap 22 lies rotatably connected to the lid 18. The sealing flap 22 rotates from a first position shown in FIG. 1, counter-clockwise to a second position shown in FIG. 4, away from a discharge port or dispensing port 20 in the lid 18.

In the first position, the sealing flap 22 covers the dispensing port 20; and a continuous sealing liner 127 disposed in a groove 124g and secured to the sealing flap 22 forms a fluid-tight seal around the dispensing port 20.

The liner 127 is a resilient member made out of rubber or any other suitable material.

[0021] The lid 18 includes a stop portion 123i that engages a side of the sealing flap 22 to stop further clockwise rotation of the sealing flap 22 beyond the position shown in FIG. 1, and exert a force downwardly toward the perimeter of the dispensing port 20 in the lid 18 of the beverage container 12, that can initiate and help maintain the seal between the flap segment and the main body segment. The lid 18 also includes a breakable projection 123j which the sealing flap 22 breaks, but does not detach, the first time that the sealing flap 22 rotates from the first to the second position. (This feature evidences any tampering with resealable the closure 10.) The sealing flap 22 may include a handle portion (not shown) used to drive the segment between the first and the second positions and to add rigidity to the sealing flap 22.

[0022] The first embodiment shown in FIGS. 1-5 also includes grooves in the rim portion of the lid 18 and cooperating threads on the inside of the rim portion of the sealing flap 22. This threading forces the sealing flap 22 inwardly of the beverage container 12 as the sealing flap 22 moves from the second to the first position. This action provides a better seal between the main body segment and the flap segment. It supplements the sealing force provided by the stop portion 123i.

[0023] In this first embodiment, "snap-on" type procedures make the connection between the closure 10 and the beverage container 12. "Snap-on" type procedures include conventional double seam-like and push on methods. However, it is recognized that there are various other methods by which the closure 10 may be connected to the beverage container 12, such as a threaded connection.

[0024] In a second embodiment of the present invention, shown in FIGS. 6-13, a resealable closure 10 for a beverage container 12 having a bottom 14, a sidewall 16, and a top panel or lid 18 having a dispensing port 20, includes a sealing flap 22 and an external drive means 24 taking the form of a dust cover 26. The terms "dust cover 26" and "external drive means 24" are used interchangeably throughout this disclosure, although it should be appreciated that the external drive means does not also have to be capable of providing protection from debris. In this embodiment, both the sealing flap 22 and the dust cover 26 slide in planes generally parallel to the lid 18. As explained in greater detail below, however, the present invention is not limited to sealing flaps and drive means that slide in planes generally parallel to the lid, but also includes sealing flaps and drive means that move in other planes as well.

[0025] Advantageously, a sealing surface is provided between the sealing flap 22 and the perimeter of the dis-

dispensing port 20. The sealing surface may take the form of a separate sealing gasket 28. Alternatively, the sealing flap 22 may be made of a sufficiently resilient material to obviate the need for a sealing gasket 28. The sealing gasket 28 is preferably made of resilient materials, such as ethylene-vinyl acetate copolymer resins or acid-modified ethylene-acrylate. While it is recognized that the sealing gasket 28 can be attached either to the perimeter of the dispensing port on the underside 19 of the lid 18 or to the upper surface of the sealing flap 22, it is preferable, for manufacturing considerations, that the sealing gasket 28 be attached to the upper surface of the sealing flap 22.

[0026] As best shown in FIG. 7, communication between the sealing flap 22 and the external drive means 24 is achieved in this second embodiment by a plurality of upwardly-directed projections 30 of the sealing flap 22, received in an aperture 31 of a socket 32 defined by projection-engaging members 33, preferably integral with, and extending downwardly from, the dust cover 24 through a hole 34 in the lid 18. Rib members 35 may also be provided on the underside of the dust cover 26 to slidably engage generally horizontal grooves 37 provided in the outermost sidewalls of the projections 30 to lock the sealing flap 22 and external drive means 24 into a constant vertical relationship with one another, at least while the external drive means 24 is causing movement of the sealing flap 22. As explained in greater detail below, it is advantageous to maintain a constant vertical relationship between the sealing flap 22 and the external drive means 24 during movement of the sealing flap 22 in the embodiments where both move generally in the plane of the lid 18, in order to avoid tilting or cocking of either the sealing flap 22 or the dust cover 26 during opening or re-closing of the beverage container 12.

[0027] Before unsealing the sealing flap 22, it is highly desirable that the internal pressure of the beverage container 12 be generally equalized with the surrounding atmosphere. Otherwise, friction between the underside 19 of the lid 18 and the sealing flap 22 or other forces caused by the pressure differential could be too high for many users to overcome with a reasonable amount of effort. Venting of the internal pressure is accomplished by venting means, which preferably takes the form of a pressure equalization port, or vent hole 36. The vent hole 36 may be provided in the sealing flap 22, or, alternatively, may take the form of a selectively unsealable hole (not shown) in the lid 18 that is covered by at least a portion of the dust cover 26. Some type of venting channel 38 is also preferably provided in a portion of the dust cover 26.

[0028] When the dust cover 26 is in the initial closed position shown in FIGS. 9a and 9b, a bottom surface 39 of one of the projection-engaging members 33 initially tightly covers the vent hole 36. As the dust cover 24 is moved a small amount from its initial position to an intermediate position, shown in FIGS. 10a and 10b, the bottom surface 39 of the projection engaging member

33 uncovers the vent hole 36, quickly allowing the vent hole 36 to communicate with the venting channel 38, and allowing internal pressure of the beverage container 12 to equalize with atmospheric pressure. As a result, the friction between the sealing flap 22, the sealing gasket 28 and the underside 19 of the lid 18 is reduced to a level that allows movement of the sealing flap 22 with only a reasonable degree of effort applied by a user to the dust cover 26. In a preferable resealable closure of the present invention, the dust cover 24 is moved approximately 15° from the initial position shown in FIG. 9a to the intermediate position shown in FIG. 10a.

[0029] Importantly, movement of the dust cover 26 does not immediately result in movement of the sealing flap 22. Instead, there is a delay, or dwell period, caused by a slack between initial movement of the dust cover 26 and initial movement of the sealing flap 22. This slack may be provided by making the differences between respective angles, such as α and β , between the surfaces of the elements that engage one another to initiate driving motion of the sealing flap 22, sufficient to allow venting to occur prior to motion of the sealing flap 22. Preferably, in the embodiment shown in FIG. 14, this slack allows for approximately 15° of relative motion of the dust cover 26 to allow venting prior to movement of the sealing flap 22. Also, upon re-closing of the resealable closure 10, the slack allows the vent hole 36 to be resealed prior to movement of the sealing flap 22 back toward its initial closed position underneath the dispensing port.

[0030] Once one of the projection engaging members 33 contacts the radial wall of one of the projections 30, further movement (in this embodiment, rotation) of the external drive means 24 results in corresponding motion of the sealing flap 22, thereby opening the dispensing port 20, as shown in FIGS. 11a and 11b.

[0031] Prior to unsealing the vent hole 36, forces from the internal pressure of the beverage container 12 help to keep the vent hole 36 sealed, by biasing the projection 30 toward the bottom surface 39 of the projection engaging member 30, at a position where the venting channel 38 and the vent hole 36 are out of communication because the vent hole 36 is covered, whereby the bottom surface 39 prevents gases from passing through the vent hole.

[0032] That the slack allows for a delay between initial movement of the dust cover 26 and initial movement of the sealing flap 22 not only before opening of the dispensing port 20, but also prior to closing of the dispensing port, is particularly advantageous because it allows re-sealing of the vent hole 36 to be a passive procedure, so the user will not forget to re-seal the vent after re-closing the dispensing port 20, undesirably allowing all the carbonation to be lost. During this reversed slack period, i.e. prior to closing of the dispensing port, the vent hole 36 is covered by the bottom surface 39 of one of the projection engaging members 30, thereby re-sealing the vent. Thereafter, continued sliding movement of

the external drive means 24 results in re-sealing of the dispensing port 20 in the lid 18 by returning the sealing flap 22 to its initial position. Alternatively, it is possible for the resealable closure of the present invention to be of such a design that re-sealing of the vent hole 36 does not occur until after re-sealing of the dispensing port 20. In such an alternate design, it would be desirable to provide an audible and/or tactile reminder that is activated upon re-sealing of the vent hole 36, so that the user will not simply re-close the dust cover 26 and forget to re-seal the vent hole 36, thereby causing the beverage to lose its carbonation.

[0033] Physical interference means are utilized in each embodiment of the present invention to initiate the seal between the sealing flap 22, the sealing gasket 28, and the perimeter of the dispensing port 20. Once the seal is initiated, a build up of internal pressure from gases inside the beverage container 12 collecting in the head space beneath the lid causes a pressure differential that gradually results in an axial force that tends to enhance the seal between the sealing flap 22, the sealing gasket 28, and the perimeter of the dispensing port 20, in all embodiments wherein the sealing flap 22 is initially oriented beneath the perimeter of the dispensing port 20, i.e. under the lid 18. To create the initial seal, the source of the physical interference means shown in FIG. 6 takes the form of one or more inwardly-directed annular ribs 44, offset a predetermined distance downwardly from the underside 19 of the lid 18, provided on an inner annular wall extending downwardly from the underside 19 of the lid 18.

[0034] The predetermined distance for at least one of the ribs 44 is at least slightly less than the combined thickness of the sealing flap 22 and the sealing gasket 28, such that when a distal end 23 of the sealing flap 22 is between at least one of the ribs 44 and the underside 19 of the lid 18, a force fit is created, biasing the sealing flap 22 in a direction toward the underside 19 of the lid 18 and initiating the seal between the sealing flap 22, the sealing gasket 28, and the perimeter of the dispensing port 20. Preferably, the upper surfaces of the ribs 44 are progressively sloped, such that during rotation of the sealing flap 22, the distance between the ribs 44 and the underside 19 of the lid 18 decreases as the sealing flap 22 approaches a position directly beneath the dispensing port 20. The distal end 23 of the sealing flap 22 may also be tapered, as shown in FIG. 3, to facilitate a ramping interaction between the sealing flap 22 and the ribs 44.

[0035] Advantageously, the present invention makes it unnecessary to overcome high friction between the sealing flap 22 and the ribs 44 throughout the duration of movement of the sealing flap 22 from the position shown in FIG. 10b to the position shown in FIG. 11b. Once the initial interference that helped form the seal between the sealing flap 22 and the perimeter of the dust cover 20 is overcome, as the dust cover 26 continues to drive the sealing flap 22, the tapered distal end 23 of

the sealing flap 22 moves with increasing ease as the distance between the top of the ribs 44 and the underside 19 of the lid 18 increases. Thus, a user need only exert a reasonable amount of force on the tabs 40, 42 of the dust cover 26 to drive the sealing flap 22 to the fully open position shown in FIG. 11b.

[0036] In order to prevent the dust cover 26 or the sealing flap 22 from cocking out of alignment during this ramping interaction between the sealing flap 22 and the ribs 44 as the sealing flap 22 is opened or closed, it is advantageous to allow the sealing flap 22, which is axially locked to the dust cover 26 by the ribs 35 received in grooves 37 (at least while the external drive means 24 is moving the sealing flap 22), to move vertically with respect to the lid 19. This is accomplished by means of raised buttons 41 provided on the top surface of the sealing flap 22, which ride in curved, sloped raceways 43. A corresponding pair of buttons may be provided on the underside of the dust cover 26, which ride in curved, sloped raceways (not shown) on the upper surface of the lid 18.

[0037] Another advantage of the present invention is that, because the force a user needs to exert on the external drive means 24 is relatively small during the initial venting of the internal pressure of the beverage container 12, it is possible to provide a tamper evident feature that a user could easily break upon initial venting. As best shown in FIGS. 9a, 10a, and 11a, the tamper evident feature may take the form of a raised pin 64 provided on the lid 18, securing the external drive means 24 in the fully closed initial position by a breakable membrane 66 near a side edge of the external drive means 24. The breakable membrane 66 is preferably an integral part of the dust cover 26. As the dust cover 26 is moved to the intermediate position to allow venting, the membrane 66 breaks, providing visible evidence that the dust cover 26 of the resealable closure 10 on the beverage container 12 has been manipulated. Preferably, the raised pin also has a mushroomed top (not shown) that will prevent the dust cover from being raised out of rotational engagement with the pin without breaking the membrane. Because the other forces required to move the dust cover easily during venting are small, more force can be devoted to rupturing a breakable membrane thereby resulting in a more easily observable evidence of tampering. Favorably, the pin 64 may also provide a stop to prevent over-rotation of the external drive means 24, so that the back end of the dust cover 26 is not rotated so far as to block the dispensing port 20.

[0038] Turning to FIGS. 14-16, a third embodiment of the present invention utilizes a riveted bayonet-type fitting between the external drive means 24 and the sealing flap 22. As in the second embodiment, a dwell period is provided between initial movement of the dust cover 26 and the sealing flap 22, achieved by means of providing a socket 32 that is larger than the horizontal bar 46 in the inverted T-shaped connector member 48 of the sealing flap 22. As best shown in FIG. 15, the stem or

post 49 of the inverted T-shaped connector member 48 extends upwardly through the hole 34 provided in the lid 18, and through a post-receiving hole 50 provided in the dust cover 26. The top of the post 49 is then flattened (not shown), to provide a riveted interconnection between the dust cover 26 and the sealing flap 22. Notwithstanding the riveted interconnection, the dust cover 26 can still move relative to the sealing flap 22 during the dwell period, i.e. until one of the walls of the socket 32 contacts one of the sides of the horizontal bar 46. A venting channel 38 selectively communicates with the vent hole 36 provided in the sealing flap 22 once the dust cover 26 reaches the intermediate position, i.e. the position shown in FIG. 10a, which vents the internal pressure of the beverage container. At that point, one or more of the walls of the socket 32 comes into contact with one or more of the sides of the horizontal bar 46, whereupon further rotational movement of the dust cover 26 results in corresponding rotation of the sealing flap 22, which opens the dispensing port 20 in the lid 18.

[0039] It is recognized that sealing of the vent hole 36 to prevent equalizing the internal and atmospheric pressure in the manner shown in FIG. 7 requires compression in the axial direction. Because temperature variations and other external conditions such as changes in altitude can cause dramatic changes in pressure differential between the inside of the beverage container 12 and the surrounding atmosphere, there is a possibility that the lid 18 will undergo some fluctuations in axial position, presenting a possibility for leakage of gasses through the vent hole 36 if such fluctuations are sufficient to lift the bottom surface 39 of the projection engaging member 33 away from the top of the vent hole 36. Therefore, a vent hole 36 that is oriented along a side wall, such as in FIG. 16, with a molded-in venting channel 38 provided in the dust cover 26 that comes into communication with the vent hole 36 only upon rotation, is less susceptible to leakage. Preferably, a vent hole gasket 47 is secured to the sealing flap 22, immediately surrounding the vent hole 36, to prevent leakage of gases or liquids whenever the venting channel 38 is not in communication with the vent hole 36.

[0040] Re-sealing of the closure member shown in FIGS. 15-16 is accomplished by moving the dust cover 26 in the opposite direction, which first brings the venting channel 38 out of communication with the vent hole 36, thereby re-closing the vent. Once the dust cover 26 reaches an intermediate position, such that the opposite side of the horizontal bar 46 comes into contact with the another wall of the socket 32, further rotational movement of the dust cover 26 causes the sealing flap 22 to return to its initial position, thereby closing the dispensing port 20. In the third embodiment, the dust cover 26 and the sealing flap 22 are axially locked to one another due to the riveting of the post 49. As in the second embodiment, there is a need to prevent cocking of either the dust cover 26 or the sealing flap 22 during their relative movement. Thus, buttons 41 may be provided on

the underside of the dust cover 26, which ride in curved, sloped raceways 43 in the top of the sealing flap 22 as dust cover 26 moves relative to the sealing flap 22.

[0041] The third embodiment of the present invention shown in FIG. 14 also addresses concerns regarding contamination of exposed portions of the lid 18. One reason many people prefer bottles to cans is that because individual beverage containers undergo substantial handling between the time of packaging and the time of consumption, there is great opportunity for debris to collect on cans, particularly on the surface of the lid 18 between the dispensing port 20 and the sidewall 16, where the user's mouth touches the beverage container 12. In bottles, however, the cap generally covers the threaded region where the user's mouth would touch, except when the user is drinking. In order to prevent debris from collecting on the surface of the lid 18 in this region of a beverage container, the dust cover 26 of the resealable closure shown in FIG. 14 includes a lip 51, having an inner portion 52 extending up the inner sidewall of the lid 18, an annular top portion 54, and an outer portion 56 that extends down the rim of the lid 18. This lip 51 effectively extends the dust cover 26 over the region of the lid 18 that is typically exposed in conventional cans. Annular top portion 54 is preferably provided with a tapered edge, and the rim of the lid 18 is provided with a complementary leading ramp, to facilitate slight lifting of the inner portion 52 of the lip 51, which enables rotating motion of the dust cover 26.

[0042] A stop member 58 in the form of a generally vertical tab may also be provided on the lid 18 in order to define a limit to the travel of the dust cover 26. The stop member 58 in FIG. 14 is shown to the right of the dispensing port 20, so it will be appreciated that the dust cover 26 is moved in the counter-clockwise direction to open the resealable closure 10, whereas the dust cover 26 in the second embodiment shown in FIGS. 6-8 is opened by moving in the clockwise direction. When constructing a sealing flap 22 for use with a dust cover 26 that opens in the counter-clockwise direction, it is desirable to taper the distal end 23 of the sealing flap 22 in the opposite direction to the taper shown in FIG. 8.

[0043] In a fourth embodiment of the resealable closure of the present invention, shown in FIG. 17, the dust cover 26 is extended to cover a broader area of the lid 18, in order to provide even additional sterility to the region of the beverage container 12 touched by a user's mouth. Instead of raised tabs 40, 42 shown in FIG. 6, the outer portion 56 of the dust cover 26 may be provided with a plurality of gripping ribs 60 to facilitate handling and rotation of the dust cover. As in the second and third embodiments, the communication between the dust cover 26 and the sealing flap 22 is such that there is a dwell period or slack, during which a vent hole 36 in the sealing flap 22 is exposed by movement of the dust cover 26 to allow venting of the internal pressure of the beverage container prior to opening of the dispensing port 20. The interconnection of the dust cover 26 and the

sealing flap 22 in this fourth embodiment can be similar to the interconnections shown in FIG. 14 or in FIGS. 15 and 16 for the third embodiment. In the fourth embodiment, the lid 18 may advantageously be provided with a dispensing spout 62 to facilitate drinking the beverage through the dispensing port 20, and to facilitate drainage back into the beverage container 12 through the dispensing port 20 of excess beverage that may collect on the lid 18. Such a dispensing spout may also be provided in a resealable closure of the third embodiment, as shown in FIG. 14. It will be appreciated that in both the third and fourth embodiments, the manner of providing the initial mechanical interference necessary to initiate the seal between the sealing flap 22, the sealing gasket 28, and the perimeter of the dispensing port 20 may be similar to the ribs 44 shown in FIG. 6, or may take other forms as explained in greater detail below.

[0044] As shown in FIGS. 13-16, the means of creating physical interference to initiate a seal between the sealing flap 22, the sealing gasket 28 and the perimeter of the dispensing port 20 may instead take the form of an annular shelf 45 extending the entire circumference of the beverage container 12, formed either as an integral part of the resealable closure, as shown in FIG. 18, or formed in the sidewall 16 of a can. By providing a predetermined distance of less than the combined thickness of the sealing flap 22 and the sealing gasket 28 between the underside 19 of the lid 18 and such a circumferential annular shelf 45, a force fit is created when the distal end 23 of the sealing flap 22 is between the shelf 45 and the underside 19 of the lid 18, helping to achieve and maintain a seal of the dispensing port 20. In this embodiment of the present invention, one avoids having to overcome frictional forces caused by the force fit during the entire motion of the sealing flap 22 because the path of the distal end 23 of the sealing flap 22 advantageously follows a different radius of curvature than the circumference of the lid 18, as can be appreciated with reference to FIG. 19. This could be achieved, for example, by providing the axis of the hole 34 through which the external drive means 24 communicates with the sealing flap 22 at a different location than the central axis CA of the lid 18. The distal end 23 of the sealing flap 22 is preferably tapered, as best seen in FIG. 20, so that the contact between the sealing flap 22 and the underside 19 of the lid 18 gradually increases as the sealing flap 22 approaches a position directly beneath the dispensing port 20.

[0045] By imparting a fillet or chamfered taper in the radial direction to the shelf 45 as shown in FIG. 18, which can be accomplished during manufacture of the lid 18, and imparting a complementary chamfered or azimuthal taper to the distal end 23 of the sealing flap 22, a tight seal is achieved between the sealing flap 22, the sealing gasket 28, and the perimeter of the dispensing port 20 on the underside 19 of the lid 18, as seen in FIG. 20. The eccentric movement of the sealing flap 22, during rotation about the location separate from the central axis

CA of the lid 18, includes a radial component to motion of the sealing flap 22 relative to the central axis CA, the side wall 16, and the shelf 45. Those of ordinary skill in the art will recognize that in order to accomplish the eccentric movement of the sealing flap 22 in a way that results in a flush, synchronized contact of the sealing flap 22 and the portion of the shelf 45 underneath the dispensing port, the sealing flap 22 must have an asymmetrical perimeter.

[0046] It will also be recognized by those of ordinary skill in the art that the physical interference means which biases the sealing flap 22 in a direction toward the underside 19 of the lid 18, and thereby initiates the seal between the sealing flap 22, the gasket 23, and the perimeter of the dispensing port 20, need not be located along the perimeter of the lid 18. Instead, it could take the form, for example, of a radially-oriented shelf (not shown), generally L-shaped in cross-section, that extends downwardly from the underside 19 of the lid 18 along one side of the dispensing port 20. Such an L-shaped radially oriented shelf would be similar to the stop portion 123i described on the top of the lid in the first embodiment, and shown in FIGS. 1, 2, 4 and 5. All that is necessary is for at least a portion of the sealing flap 22 to engage a physical obstacle during movement of the sealing flap 22 to a position directly beneath the dispensing port 20, such that the sealing flap 22 is biased in a direction toward the underside 19 of the lid 18, which initiates the seal between the sealing flap 22, the gasket 28, and the perimeter of the dispensing port 20. As noted above, a particular advantage of the present invention is that this seal is enhanced by the differential between the internal pressure, resulting from, e.g., carbonated beverages, and atmospheric pressure, in those embodiments where the sealing flap 22 is initially oriented underneath the perimeter of the dispensing port 20.

[0047] As also stated above, the principles of the present invention can be applied even to resealable closures in which either or both of the external drive means 24 and sealing flap 22 move outside of planes generally parallel to the lid 18. For example in FIGS. 22-25, a sixth embodiment of the resealable closure of the present invention is shown in which both the dust cover 26 and the sealing flap 22 flip outside of planes that are parallel to the lid 18. Advantageously, this embodiment also includes an initial slack during which venting takes place as a result of movement of the dust cover 26 prior to initial movement of the sealing flap 22. The external drive means 24 pivots about an axis just below the underside 19 of the lid 18. The pivot axis at a rear end of the external drive means 24 sits in a well 68 provided in the lid 18. The well 68 includes a pair of side walls 70, 72, a front wall 74 a rear wall 76, and a floor 78. In order to minimize the sealing required to prevent leakage, interaction between the external drive means 24 and the sealing flap 22 takes place outside of the well 68, i.e. within the beverage container 12.

[0048] As best seen in FIG. 24, the venting of the re-

sealable closure 10 is achieved with an axle 80 at the rear end of the dust cover 26, inside the well 68. The axle 80 includes a venting channel 38, which leads to the outside of the axle 80, thereby venting any gases in the channel 38. The venting channel 38 selectively rotatably engages a vent hole 36 provided in a rotatable drive gear shaft 82. Because the vent hole 36 is always in communication with a hollow central gas passageway 84 within the drive gear shaft 82, the internal pressure equalizes with the surrounding atmospheric pressure as soon as the venting channel 38 communicates with the vent hole 36. This takes place during the initial dwell period, i.e. before the axle 80 actuates the drive gear shaft 82.

[0049] Just as the vent hole gasket 47 in the embodiment shown in FIG. 16 is used to seal a vent hole 36 when not in communication with a venting channel 38, a gasket material (not shown) suitable to provide a gas tight seal for the vent hole 36 in the drive gear shaft 82 when the vent hole 36 is not in communication with the venting channel 38, is preferably provided in this embodiment. Such a gasket material could be secured to the drive gear shaft 82 between the exterior of the drive gear shaft 82 (immediately surrounding the vent hole 36) and the interior of the axle 80. Alternatively, one or more annular internal gaskets (not shown) may be provided between the vent hole 36 and the walls 70, 72 of the well, as necessary to seal the vent hole 36.

[0050] In order to prevent undesired leakage of beverage through the walls 70, 72 of the well, an annular gasket 86 is preferably provided at the intersection of the drive gear shaft 82 and the side walls 70, 72.

[0051] Once the internal and external pressures have generally been equalized by unsealing the vent hole 36, a radial surface in the interior of the axle 80 contacts a radial extension of the drive gear shaft 82, and further flipping movement of the external drive means 24 away from the plane of the lid 18 causes the axle 80 to rotate the drive gear shaft 82 in the same direction. The drive gear shaft 82 is provided with at least one drive gear 88 provided outside one or both side walls 70, 72. The drive gear 88 has been omitted from FIG. 24 for clarity, but can be seen in FIGS. 22, 23 and 25. The drive gear 88 includes a multiplicity of gear teeth that engage complementary teeth in a seal flap gear 90, at least one of which is provided on a separate seal flap gear shaft 92 extending from a projection 94 of the well 68 that extends forwardly the front wall 74 of the well 68. The projection 94 of the well 86 is narrower than the distance between the side walls 70, 72, which allows the seal flap gear shaft 92 to be integral with a rear end of the seal flap 22, in the same manner that the axle 80 is integral with the rear end of the external drive means 24. It is recognized that this slack between the radial surface of the interior of the axle 80 and radial extension of the drive gear shaft 82, which allows venting to occur prior to movement of the sealing flap 22, may alternatively be accomplished by providing sufficient slack in between the drive gear

88 and the sealing flap gear 90.

[0052] Movement of the drive gear shaft 82 results in clockwise rotation of the drive gear 88, thereby causing counter-clockwise rotation of the seal flap gear 90 and the seal flap gear shaft 92, resulting in the seal flap 22 flipping down and away from the dispensing port 20. Because the dust cover 26 covers the dispensing port 20 until the beverage container 12 reaches the user, the fact that the sealing flap 22 is moving down and into the beverage itself is of little concern to the user, inasmuch as there is only a small chance that debris can contaminate any surface of the sealing flap 22.

[0053] As discussed with respect to the previous embodiments, it is desirable to initiate the sealing force to seal the sealing flap 22 and sealing gasket 28 to the perimeter of the dispensing port 20 on the underside 19 of the lid 18. Such an initial sealing force was provided in previous embodiments, in which the sealing flap 22 rotated in a direction generally parallel to the lid 18, by translating angular motion of the sealing flap 22 into a sealing force generally perpendicular to the perimeter of the dispensing port 20. It is noted that in this sixth embodiment, as well as in subsequent embodiments discussed below, the direction of motion of the sealing flap, at least in the immediate vicinity of the lid 18, is already generally perpendicular to the perimeter of the dispensing port 20. Thus, it is not necessary to utilize initial physical interference means to translate angular motion of the sealing flap 22 into a force in a direction generally perpendicular to the perimeter of the dispensing port. Instead, one need only initially compress the sealing flap in its normal direction of motion toward the perimeter of the dispensing port to achieve the initial sealing force. This may be achieved by applying an initial compressive load to the external drive means 24, which in the present embodiment results in rotation of the seal flap gear 90 by the drive gear 88 to achieve compression of the sealing flap 22 toward the perimeter of the dispensing port 20. As in all of the previous embodiments in which the sealing flap 22 is initially located beneath the perimeter of the dispensing port, the seal between the sealing flap 22, the sealing gasket 28, and the perimeter of the dispensing port 20 is enhanced by virtue of the forces resulting from the pressure differential biasing the sealing flap 22 toward the perimeter of the dispensing port 20. Once there is a sufficient build up of pressure in the head space of a beverage container to provide such a pressure differential, the sealing force between the sealing flap 22, the sealing gasket 28, and the perimeter of the dispensing port 20 is advantageously sufficiently enhanced to make it unnecessary to continue to apply a compressive force to the external drive means. It will be appreciated that forms of engagement other than interlocking circular gears could be used to convert the rotation of the dust cover 26 into the desired flipping of the sealing flap 22.

[0054] Turning now to FIGS. 26 and 27, a seventh embodiment of the resealable closure 10 of the present in-

vention involves applying the same principles of the invention to a resealable closure 10 in which the external drive means 24 moves in a plane generally parallel to the lid 18, and selectively actuates movement of the sealing flap 22 in a direction outside of a plane generally parallel to the lid 18. The dust cover 24 in this embodiment may be of a style that extends on either side of the central axis of the beverage container, such as the dust cover 26 shown in FIGS. 14-15, but for clarity, FIG. 26 shows a dust cover 26 that only has a single tab 40 for a user to grip to actuate the dust cover 26. As in previous embodiments, an initial dwell period is provided during movement of the dust cover 26 prior to actuation of the sealing flap 22 in order to unseal a vent hole 36. A "bow-tie" connector 96 (named for its shape) projects downwardly from the dust cover 26, and is preferably an integral extension thereof. The bow-tie connector 96 is received in a socket 32 in a drive gear shaft 82. The walls of the socket 32 are spaced so as to provide sufficient slack or clearance for the male portion of the bow-tie connector 96 to not only be received in the socket 32, but also to rotate a short distance, preferably about 15°, in order to unseal the vent hole 36 prior to taking up this slack and moving the drive gear shaft 82.

[0055] A beveled drive gear 88 is provided at the bottom end of the drive gear shaft 82, and is provided with an annular gasket 86. At least a portion of the drive gear shaft 82 extends through the hole 34 in the lid 18, so that the annular gasket can be seated against the underside 19 of the lid 18, or at least against the bottom of a collar (not shown) extending downwardly from the hole 34 in the lid 18, to prevent leakage of gasses and liquids.

[0056] Once the vent hole 36 is unsealed, the bow-tie connector 96 comes into intimate contact with the walls of the socket 32. Continued rotating motion of the external drive means 24 (in the direction indicated by the arrows in FIG. 26 adjacent the dust cover 26) results in corresponding rotation of the beveled sealing flap gear 90, due to the inter-linkage of the drive gear 88 and sealing flap gear 90 as shown in FIG. 27. The resulting rotation of the sealing flap gear 90 rotates the sealing flap gear shaft 92, which is supported between side walls 70, 72 extending downwardly from the underside 19 of the lid 18. The sealing flap gear shaft 92 is drivingly received in an opening through the sealing flap gear 90. However, the sealing flap gear shaft 92 is only received in a third beveled gear, which is a dummy gear 98, for purposes of supporting that dummy gear 98. Because rotation of the drive gear 88 causes the sealing flap gear 90 and the dummy gear 98 to rotate in different directions, it will be understood that the dummy gear 98 is provided primarily for symmetry and support, rather than function.

[0057] The sealing flap gear shaft 92 is also received in (or, alternatively, may be an integral part of) the sealing flap 22. As in the sixth embodiment, the initial physical interference necessary to initiate the sealing force

to seal the sealing flap 22 and sealing gasket 28 to the perimeter of the dispensing port 20 on the underside 19 of the lid 18 can be achieved by means of a pre-load of the seal flap gear 90 by the drive gear 88.

[0058] In FIG. 28, an eighth embodiment applies the principles of the present invention to a resealable closure 10 in which it is the dust cover 26 that flips outside a plane generally parallel to the lid 18, which, subsequent to pressure equalization by venting of the internal pressure, causes the sealing flap 22 to move by rotation in a direction generally parallel to the lid 18. In this embodiment, the slack during which venting occurs prior to movement of the sealing flap 22 can be achieved primarily in the same way as discussed above with regard to the sixth and seventh embodiments, so a detailed explanation thereof is omitted. Subsequent to venting, a worm drive gear 88, provided outside (i.e., on the beverage side) of side wall 70 of a well 68 in the lid 18, rotates, causing rotational movement of a seal flap gear 90 by virtue of a multiplicity of teeth on the seal flap gear 90 riding along the worm gear 88. The seal flap gear 90 is shown in FIG. 28 to be integral with the seal flap 22, and both rotate about a seal flap gear shaft extending downwardly from the underside 19 of the lid 18 to move the seal flap 22 in the direction of the arrow shown in the drawing figure immediately adjacent the preferably tapered distal end 23 of the sealing flap 22.

[0059] Because the sealing flap 22 is moving by rotating in a plane generally parallel to the lid 18 in order to unseal the dispensing port 20, the initial physical interference required to initiate the seal between the sealing flap 22, the sealing gasket 28 and the perimeter of the dispensing port 20 on the underside 19 of the lid 18 can be accomplished, for example, by use of the intermittent annular ribs 44 shown in FIG. 6, if the sealing flap travels along a radius of curvature coinciding with that of the sidewall 16 of the beverage container 12. Alternatively, the initial mechanical interference can be accomplished by use of the annular shelf 45 shown in FIGS. 18 and 21, if the sealing flap travels along a different radius of curvature than the radius of curvature of the sidewall 16 of the beverage container 12.

[0060] FIGS. 29 and 30 show a ninth embodiment, wherein the external drive means 24 starts in a position away from the dispensing port 20, such that initially, only the sealing flap 22 prevents debris from entering the beverage container. It is understood that this embodiment may be less desirable, inasmuch as a portion of the sealing flap 22 that is exposed during shipment of the beverage container 12 flips down into the beverage. Because the final position of the external drive means 24 is directly over the dispensing port, the external drive means 24 is provided with its own aperture to facilitate drinking. Again, the initial slack to accommodate venting prior to movement of the sealing flap 22, and the initiation of a seal via initial mechanical interference, can be accomplished using the same principles discussed above for earlier embodiments.

[0061] FIGS. 31 and 32 show a tenth embodiment, in which rotation of the external drive means 24 in a plane generally parallel to the plane of the lid 18, after an initial dwell period to accomplish venting in a manner described above, rotates a drive gear 88, which causes axial movement of the sealing flap 22. The sealing flap 22 is preferably made of a flexible material, and is provided with internal threads 100 so as to axially ride along the drive gear 88 as the drive gear rotates. One or more columns 102, 104 may be provided along the interior of the sidewall 16 of the beverage container 12, so as to constrain movement of the sealing flap 22 in the axial direction. The initial mechanical interference can be accomplished by applying a pre-load, so that as the external drive means 24 returns to a position immediately over the dispensing port 20, the sealing flap 22 and sealing gasket 28 are sealed to the perimeter of the dispensing port 20 on the underside 19 of the lid 18.

[0062] It will be appreciated by those of ordinary skill in the art that many variations may be made to the embodiments disclosed herein that are still within the scope of the present invention. For example, while the various embodiments have been described generally with respect to containers for pressurized beverages, it will be understood that the principles of the present invention can be easily applied to resealable closures for vacuum-stored beverage and/or food containers. Therefore, by the appended claims, the applicants intend to cover any modifications and other embodiments as incorporate those features which constitute the essential features of this invention.

Claims

1. A resealable closure (10) for beverage containers having a lid (18) having a dispensing port (20) therein and a sealing flap (22), said sealing flap (22) being moveable between an initial sealed position with respect to a perimeter of the dispensing port (20), in which the sealing flap (22) prevents fluid from passing through the dispensing port (20), and an unsealed position with respect to the dispensing port (20);
said sealing flap (22) being further moveable from the unsealed position back to the initial sealed position with respect to the perimeter of the dispensing port (20),
characterized in that
said resealable closure (10) includes a seal initiating means to achieve an initial seal between the sealing flap (22) and the perimeter of the dispensing port (20) at a sealing surface between the sealing flap (22) and the perimeter of the dispensing port (20) while the sealing flap (20) is in the initial sealed position.
2. The resealable closure (10) of claim 1, further **characterized by**

a resilient sealing segment (28, 127) disposed between the lid (18) and the sealing flap (22) adjacent the dispensing port (20) when said sealing flap (22) is in the initial sealed position.

3. The resealable closure (10) of claims 1 or 2, further **characterized by** movement of the sealing flap (22) between the initial sealed position and the unsealed position including sliding of the sealing flap (22) in a plane generally parallel to the lid (18).
4. The resealable closure of claim 1 or 2, further **characterized by** integral means for translating movement of the sealing flap (22) from the unsealed position back toward the initial sealed position into a sealing force directed toward the dispensing port (20).
5. The resealable closure of claim 1, 2 or 4, further **characterized by** movement of the sealing flap (22) between the initial sealed position and the unsealed position being outside a plane generally parallel to the lid (18).
6. The resealable closure of claim 4 or 5, further **characterized by** reversible means for actuating the sealing flap (22) between the sealed and unsealed positions.
7. The resealable closure of claim 6, further **characterized by** the sealing flap (22) being disposed beneath the lid (18) and said reversible means for actuating the sealing flap (22) being provided on an exterior of the lid (18) to form an external drive means (24).
8. The resealable closure of claim 7, further **characterized by** a pressure equalization port (36) being provided in at least one of the sealing flap (22) and the lid (18), and said external drive means (24) including a venting channel (38) that selectively communicates with said pressure equalization port (36) to allow internal pressure of a beverage container (12) to which the resealable closure (10) is attached to equalize with atmospheric pressure.
9. The resealable closure (10) of claim 6, 7 or 8, further **characterized by** said reversible means for actuating the sealing flap (22) including a tamper evidence means associated therewith, said tamper evidence means being activated upon initiation of movement of the reversible means for actuating the sealing flap means.
10. A method for opening and resealing a pressurized beverage container (12) having a resealable closure (10) thereon, the method being **characterized by** the steps of:

first, unsealing a pressure equalizing port (36) provided in the resealable closure (10) ;
next, opening a dispensing port (20) provided in a lid (18) of the resealable closure (10), followed by the steps of:

re-sealing said pressure equalizing port (36); and closing the dispensing port (20).

11. The method of claim 10, further **characterized by** said pressure equalization port (36) being unsealed by moving an external drive means provided on said lid (18) from a first closed and unvented position in which the dispensing port (20) is closed by a sealing flap (22) provided on an underside of the lid (18), and a portion of said external drive means (24) is in a sealed relationship with the pressure equalization port (36), to a second closed and vented position in which said pressure equalization port (36) is unsealed and the dispensing port (20) remains closed by the sealing flap (22).
12. The method of claim 11, further **characterized by** the dispensing port (20) being opened by said external drive means (24) actuating the sealing flap (22) to move from an initial sealed relationship with the dispensing port (20), to a position out of the sealed relationship with the dispensing port (20), until the external drive means (24) reaches a third opened and vented position.
13. The method of claim 11 or 12 further **characterized by** the pressure equalization port (36) being re-sealed by moving said external drive means (24) to a position in which said external drive means (24) re-seals the pressure equalization port (36) without moving the sealing flap (22).

Amended claims in accordance with Rule (86)2 EPC.

1. A resealable closure (10) for beverage containers comprising:

a lid (18) having a dispensing port (20) therein; a sealing flap (22), movable between an initial sealed position with respect to the dispensing port (20), in which the sealing flap (22) prevents fluid from passing through the dispensing port (20), an unsealed position with respect to the dispensing port (20), in which the dispensing port (20) is at least partially unobstructed by the sealing flap (22) and a re-sealed position, and an external drive means (24) for actuating the sealing flap between the sealed and unsealed positions, **characterized by**:

a compressive force, resulting from a dif-

ferential between internal pressure within a head space of a beverage container (12) having the resealable closure (10) thereon and surrounding atmospheric pressure, the compressive force pushing the sealing flap (22) toward the dispensing port (20) at a sealing surface while the sealing flap (22) is in the sealed position; and a pressure equalization port (36) provided in at least one of the sealing flap (22) and the lid (18), to allow the internal pressure in the head space of the beverage container (12) to equalize with atmospheric pressure and relieve the compressive force prior to movement of the sealing flap (22) from the sealed position to the unsealed position.

2. The resealable closure of claim 1, further **characterized by** the sealing flap (22) having, in the re-sealed position, the same degree of seal integrity with the lid (18), substantially the same position and substantially the same orientation relative to the dispensing port (20), as in the initial sealed position.

3. The resealable closure of claim 1 or 2, further **characterized by** a seal initiating means to achieve an initial seal between the sealing flap (22) and the dispensing port (20), the seal initiating means including physical interference biasing the sealing flap (22) toward the dispensing port (20).

4. The resealable closure of claim 3, further **characterized by** the physical interference of the seal initiating means dissipating as the sealing flap (22) moves from either the sealed position or the re-sealed position toward the unsealed position.

5. The resealable closure of claim 1, 2, 3 or 4 further **characterized by** the sealing flap (22) being provided on an underside (19) of the lid (18).

6. The resealable closure of claim 1, 2, 3, 4 or 5, further **characterized by** a sealing gasket (28) disposed between the lid (18) and the sealing flap (22).

7. The resealable closure of claim 1, 2, 3, 4, 5 or 6, further **characterized by** the external drive means (24) including a venting channel (38) that selectively communicates with the pressure equalization port (36) to facilitate equalization of the internal pressure in the head space of the beverage container (12) with atmospheric pressure.

8. The resealable closure of claim 1, 2, 3, 4, 5, 6 or 7, further **characterized by** the pressure equalization port (36) being located so that it is resultantly re-sealed by movement of the external drive means

(34) prior to the sealing flap (22) reaching its re-sealed position.

9. The resealable closure of claim 1, 2, 3, 4, 5, 6, 7 or 8, further **characterized by** a lag between an initial movement of the external drive means (34) and an initial movement of the sealing flap (22), and wherein the pressure equalization port (36) is opened or closed by movement of the external drive means (34) during the lag. 5 10

10. The resealable closure of claim 1, 2, 3, 4, 5, 6, 7, 8 or 9, further **characterized by** a breakable tamper evidence means (123i, 123j) initially connecting the external drive means (34) to the lid (18), and wherein, until broken, the tamper evidence means (123i, 123j) impedes accidental movement of the external drive means (34). 15

11. A method for opening and resealing a positively or negatively pressurized beverage container (12) having a resealable closure (10) thereon having a lid (18) with a dispensing port (20) therein and a sealing flap (22) movable between an initial sealed position, an unsealed position, and a re-sealed position, **characterized by**: 20 25

first, unsealing a pressure equalization port (36) provided in the resealable closure (10) by reversibly exposing the pressure equalization port (36) to surrounding atmosphere; 30
next, moving the sealing flap (22) from the initial sealed position to the unsealed position, thereby at least partially opening the dispensing port (20); 35
next, re-sealing said pressure equalization port (36); followed by
closing said dispensing port (20) by moving the sealing flap (22) to the re-sealed position. 40

12. The method of claim 11, further **characterized by** unsealing the pressure equalization port (36) prior to initiating movement of the sealing flap (22) from the initial sealed position toward the unsealed position. 45

13. A resealable closure (10) for positively or negatively pressurized beverage containers comprising: 50

a lid (18) having a dispensing port (20) therein;
a sealing flap (22), movable between a sealed position with respect to the dispensing port (20), in which the sealing flap (22) prevents fluid from passing through the dispensing port (20), an unsealed position with respect to the dispensing port (20), in which the dispensing port (20) is at least partially unobstructed by the 55

sealing flap (22), and a re-sealed position, **characterized in that**:

in the re-sealed position, the sealing flap (22) has the same degree of seal integrity with the lid (18), substantially the same position, and substantially the same orientation relative to the dispensing port (20) as in the sealed position,
a seal initiating means to achieve an initial seal between the sealing flap (22) and the dispensing port (20), the seal initiating means including physical interference biasing the sealing flap (22) toward the perimeter of the dispensing port (20), and the physical interference of the seal initiating means dissipating as the sealing flap (22) moves from either the sealed position or the re-sealed position toward the unsealed position.

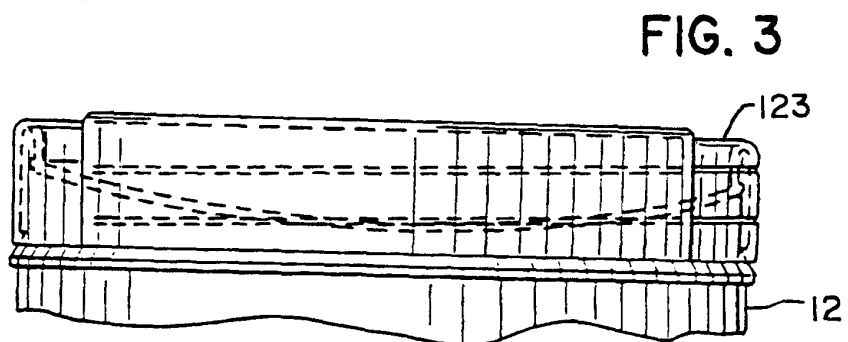
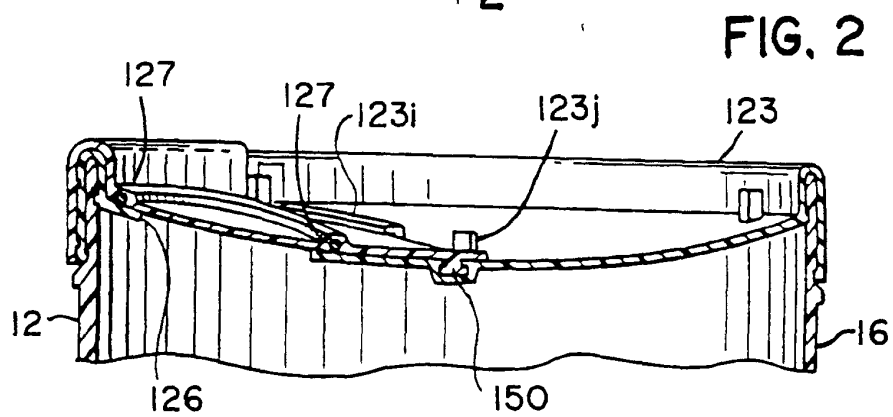
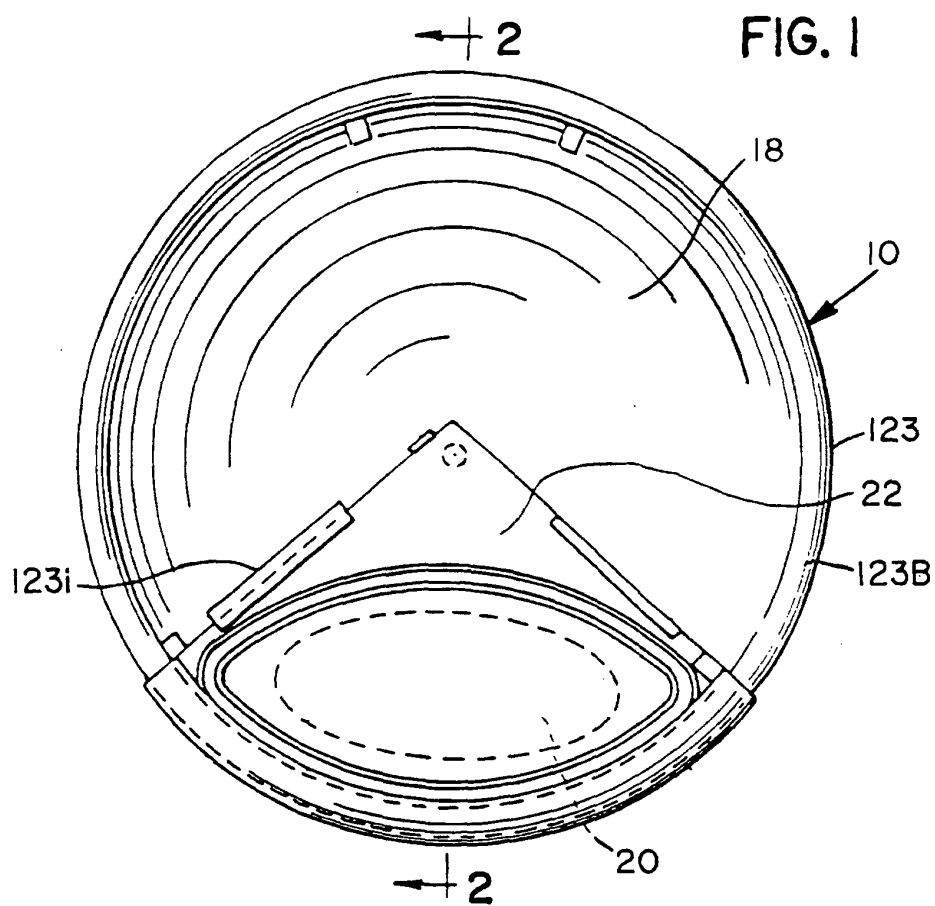

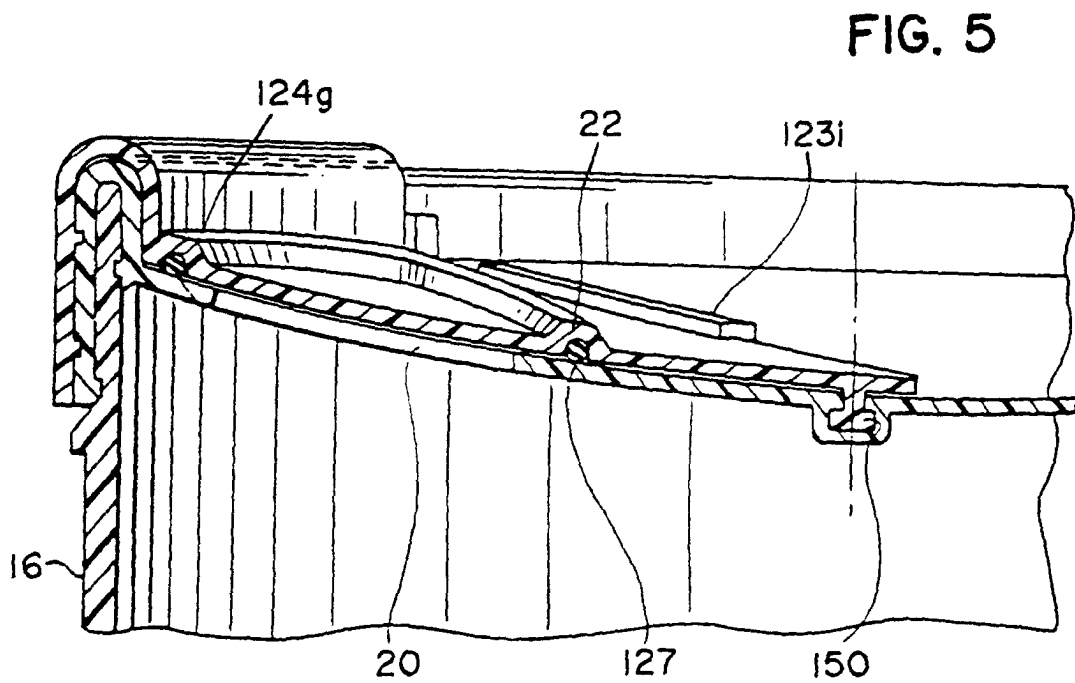
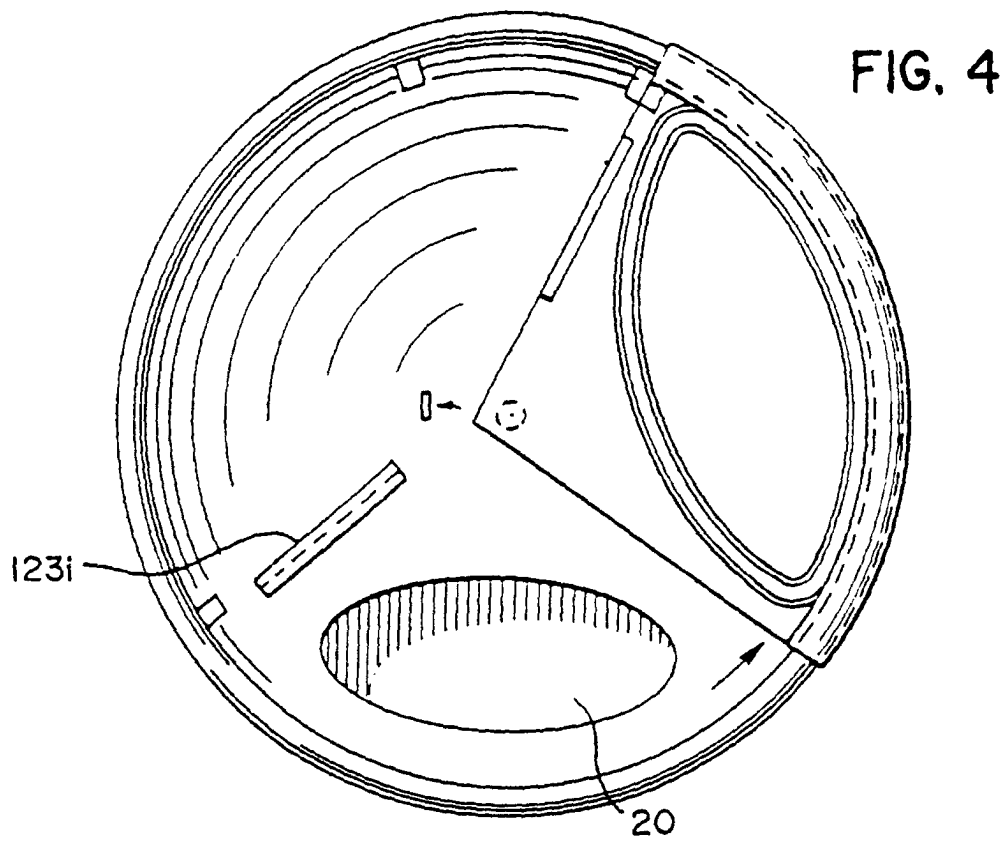

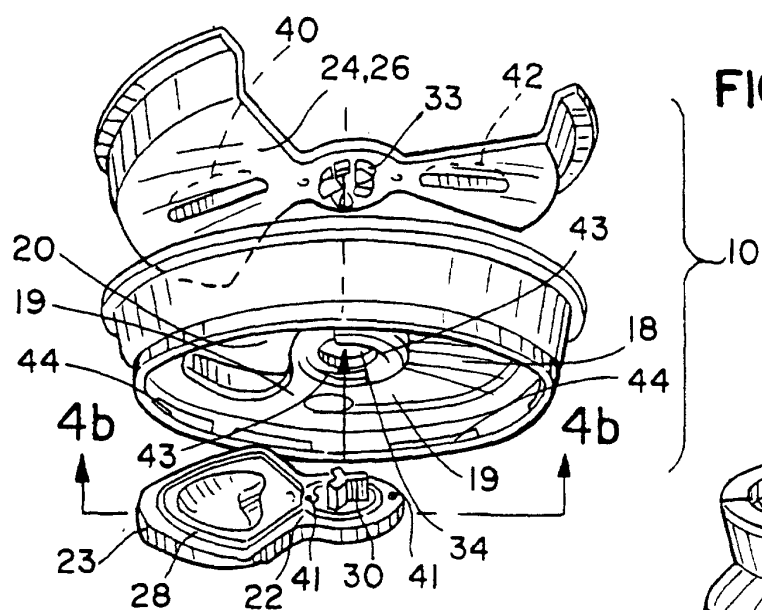

FIG. 6

FIG. 7

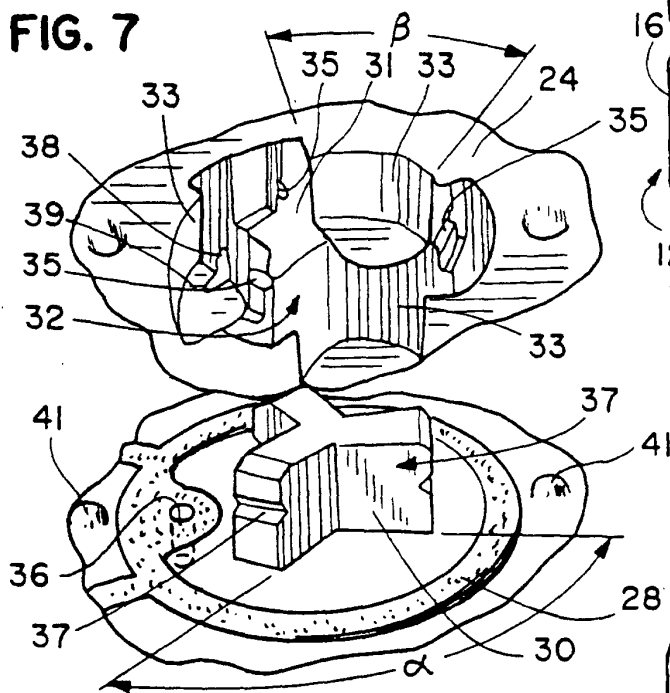

FIG. 8

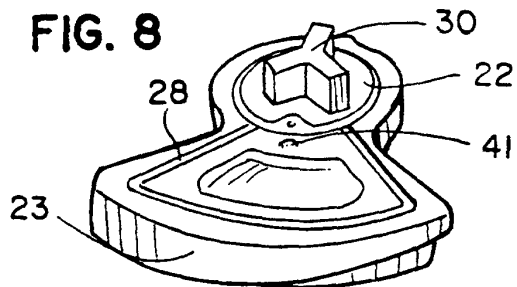

FIG. 12

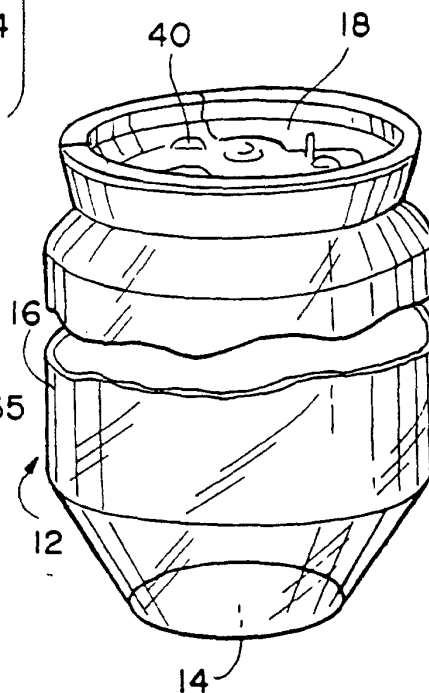

FIG. 13

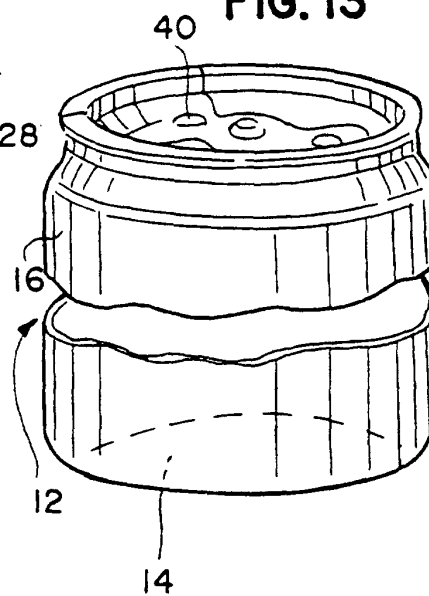

FIG. 9A

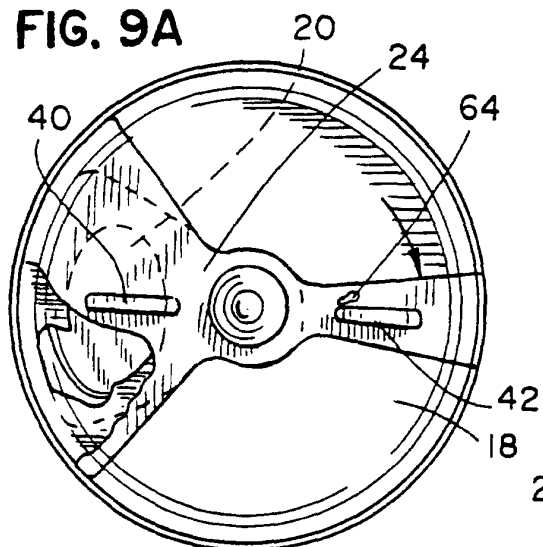

FIG. 9B

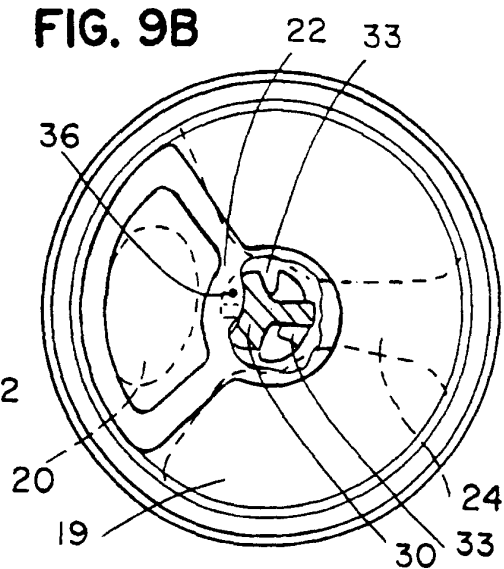

FIG. 10A

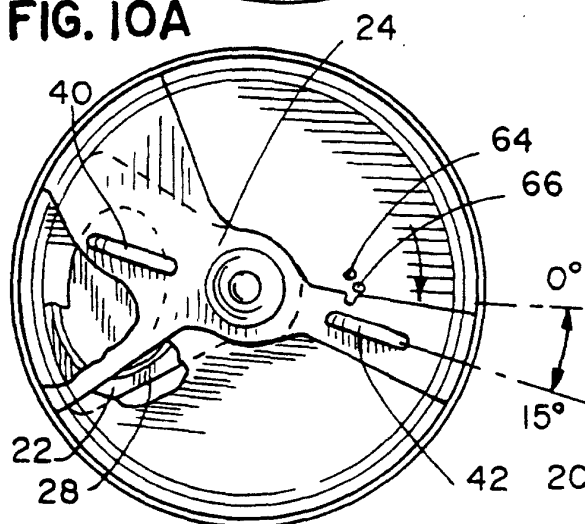

FIG. 10B

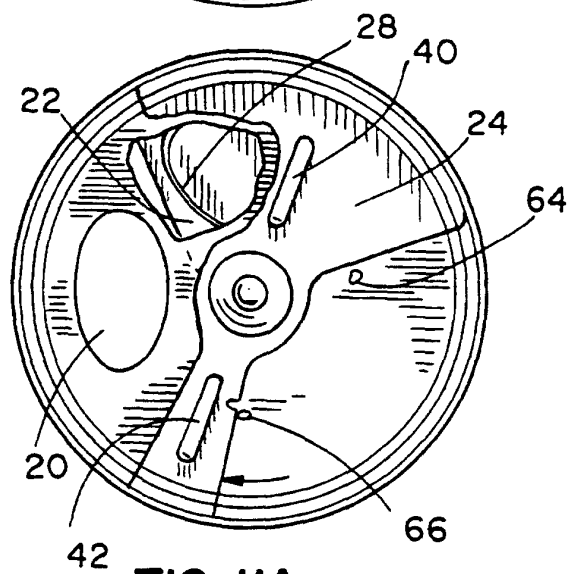
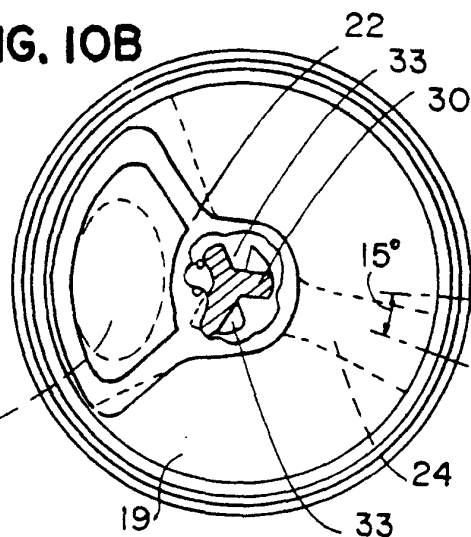

FIG. 11A

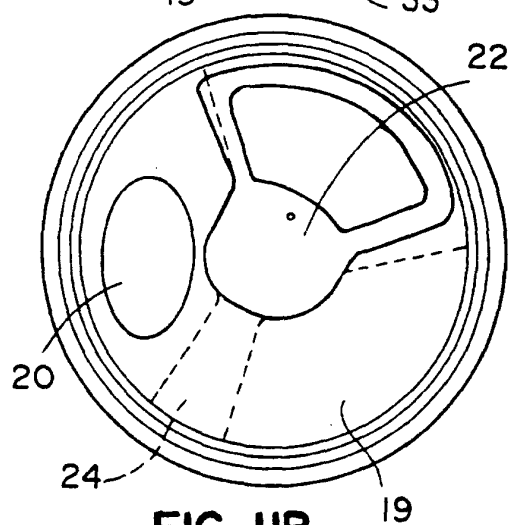
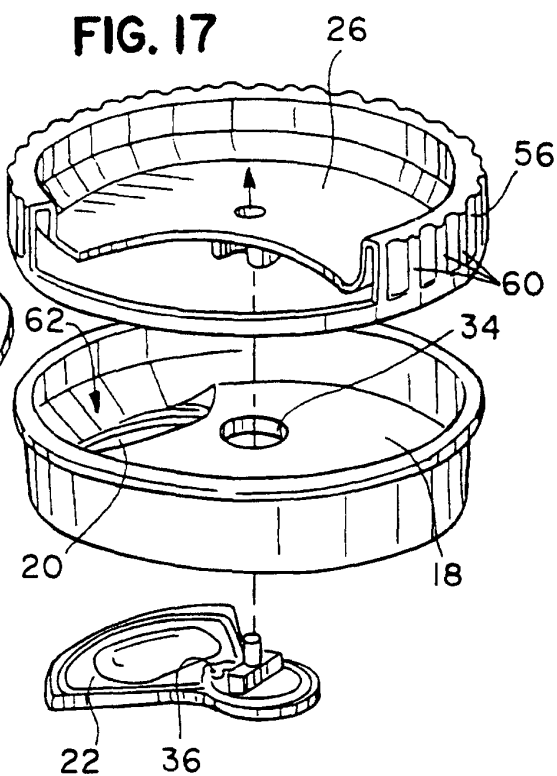
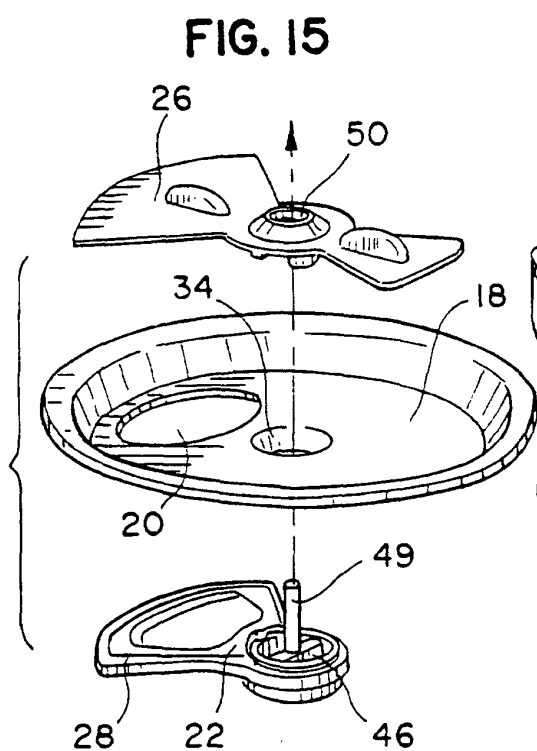
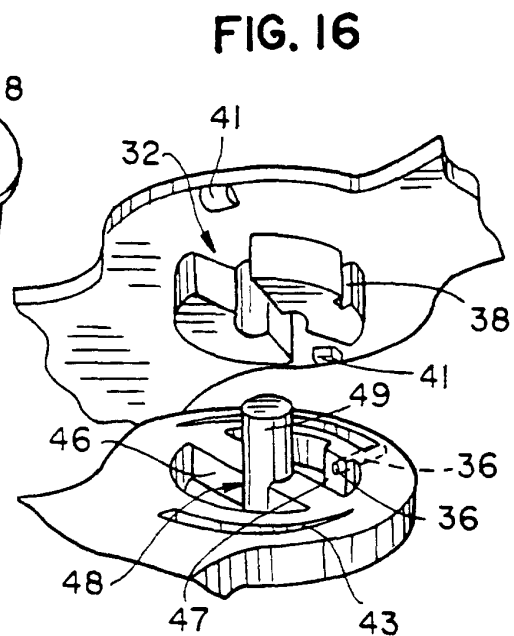
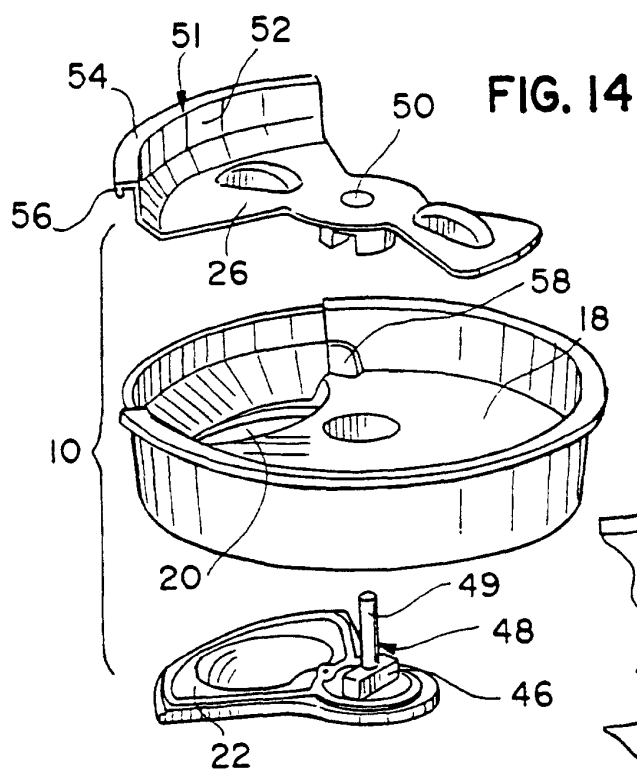
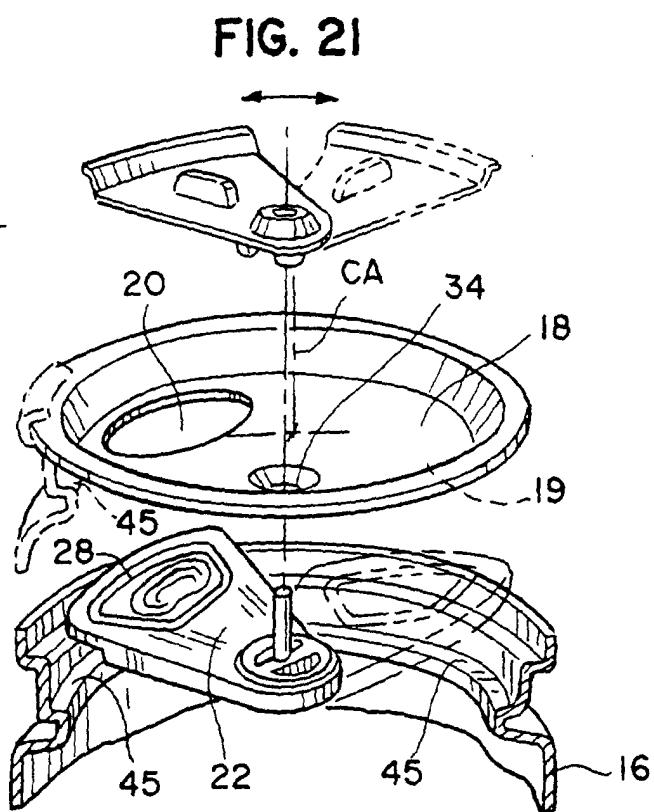
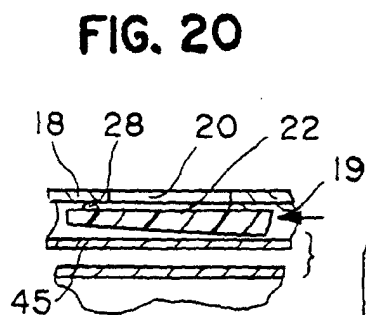
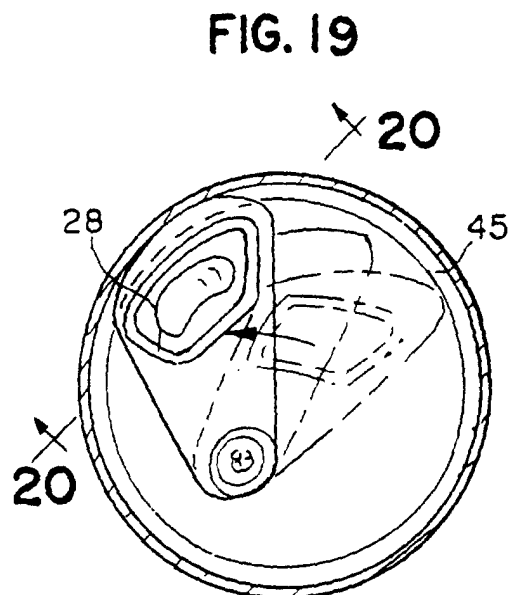
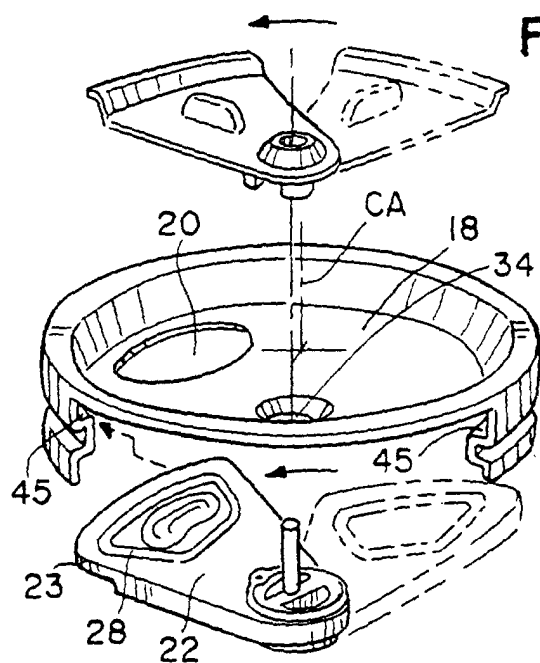

FIG. 11B





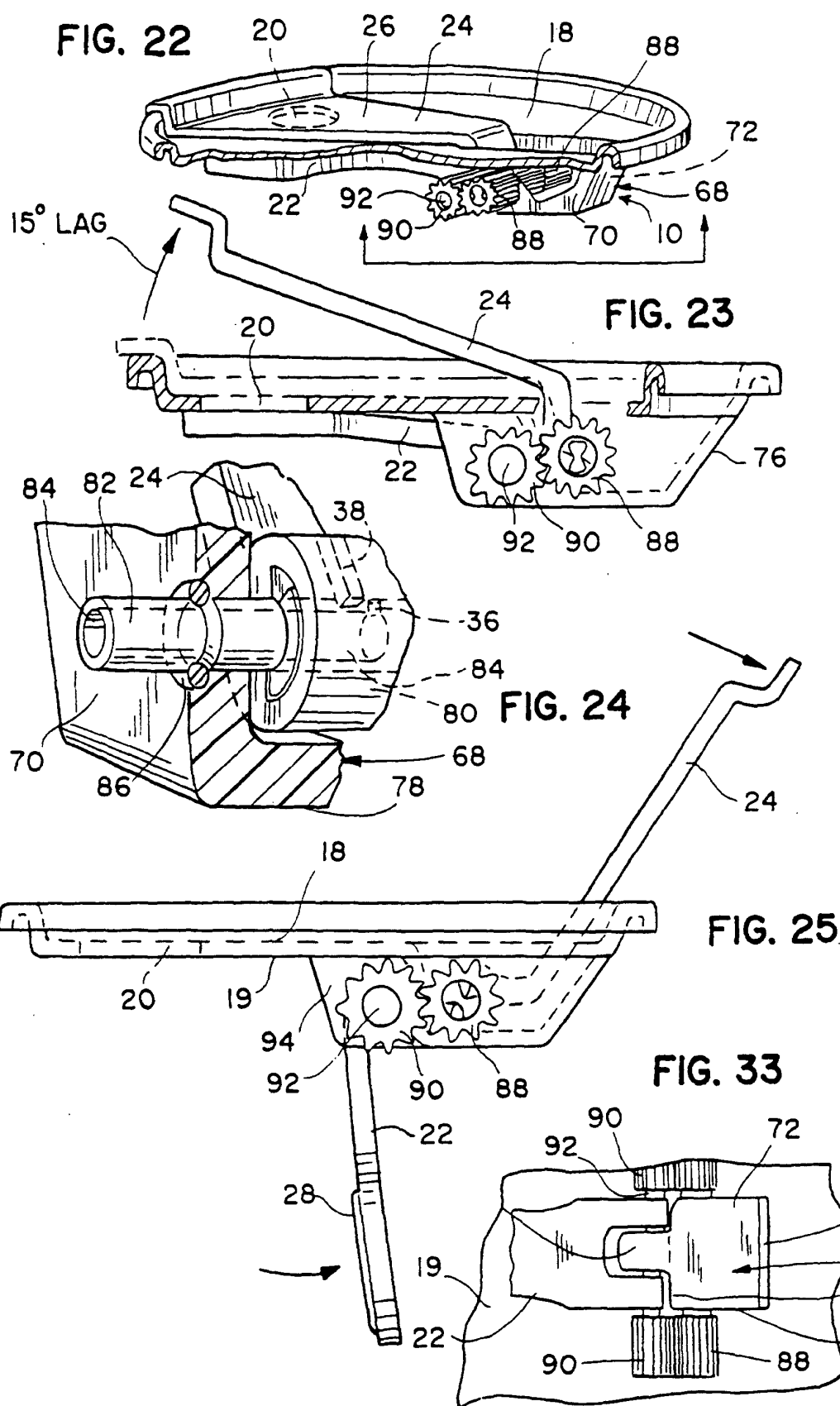

FIG. 26

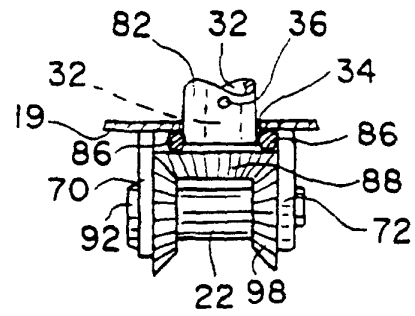
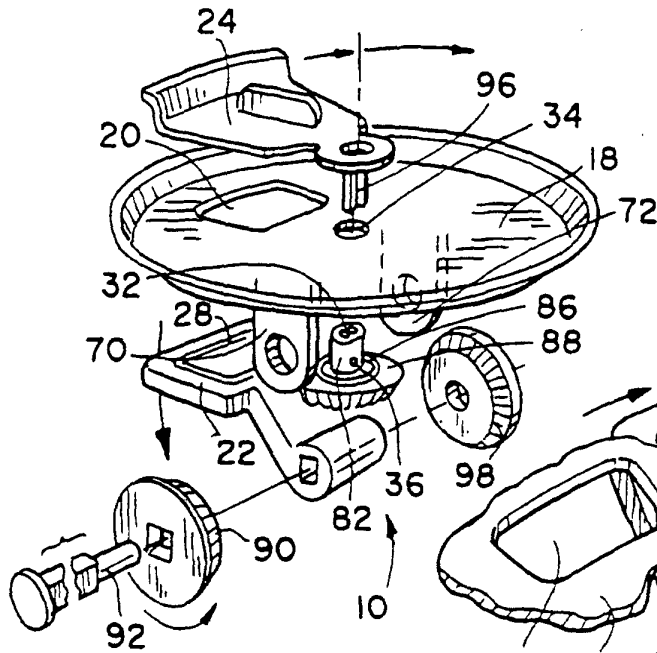

FIG. 27

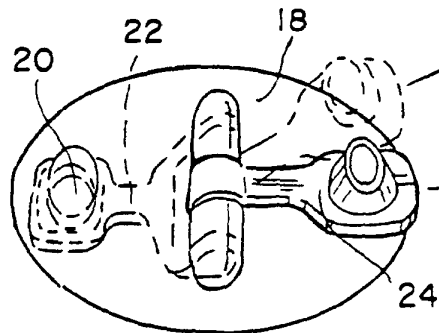

FIG. 29

FIG. 29

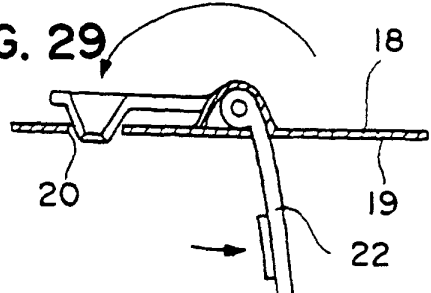

FIG. 32

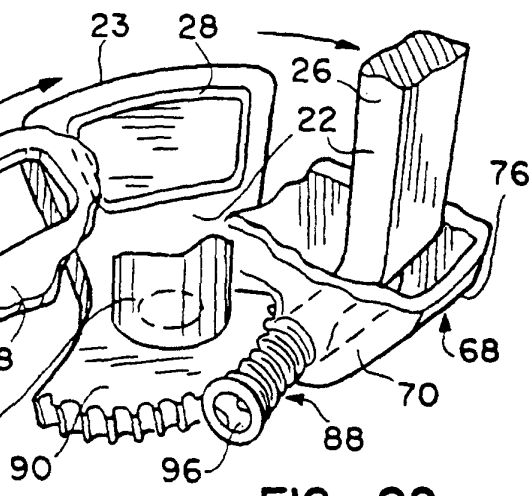
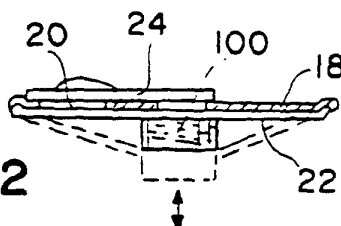

FIG. 28

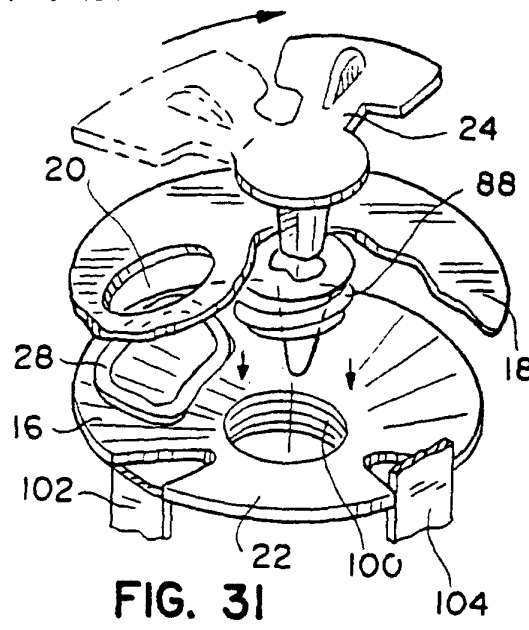

FIG. 31



European Patent
Office

EUROPEAN SEARCH REPORT

Application Number
EP 01 10 8318

DOCUMENTS CONSIDERED TO BE RELEVANT			
Category	Citation of document with indication, where appropriate, of relevant passages	Relevant to claim	CLASSIFICATION OF THE APPLICATION (Int.Cl.7)
X	DE 42 00 614 A (ERCAN OELKUE) 4 March 1993 (1993-03-04) * the whole document *	1,2,4,6, 7	B65D43/18 B65D47/26 B65D17/50
Y	-----	5	
Y	US 4 136 797 A (POTTS VINSON S) 30 January 1979 (1979-01-30) * figures 22-25 *	5	
A	-----	1,2	
X	US 3 447 724 A (FIDDYMENT EARL W) 3 June 1969 (1969-06-03) * the whole document *	1-4,6	
A	-----	8	
X	US 4 127 212 A (WATERBURY NELSON J) 28 November 1978 (1978-11-28) * the whole document *	1	
Y	-----	4,6,9	
Y	US 4 170 724 A (WATERBURY NELSON J) 9 October 1979 (1979-10-09) * the whole document *	4,6,9	TECHNICAL FIELDS SEARCHED (Int.Cl.7)
A	-----	1	B65D
X	US 4 576 306 A (KELSEY STEPHEN F ET AL) 18 March 1986 (1986-03-18) * column 2, line 26 - line 30 * * column 3, line 47 - line 54 * * figures 1-12 *	10	
X	US 5 242 079 A (STEPHENS RUTH A ET AL) 7 September 1993 (1993-09-07) * figures 1-5 *	10	
The present search report has been drawn up for all claims			
Place of search BERLIN		Date of completion of the search 2 October 2001	Examiner Schultz, O
CATEGORY OF CITED DOCUMENTS X : particularly relevant if taken alone Y : particularly relevant if combined with another document of the same category A : technological background O : non-written disclosure P : intermediate document		T : theory or principle underlying the invention E : earlier patent document, but published on, or after the filing date D : document cited in the application L : document cited for other reasons & : member of the same patent family, corresponding document	

EPO FORM 1503 03 82 (P04C01)

**ANNEX TO THE EUROPEAN SEARCH REPORT
ON EUROPEAN PATENT APPLICATION NO.**

EP 01 10 8318

This annex lists the patent family members relating to the patent documents cited in the above-mentioned European search report. The members are as contained in the European Patent Office EDP file on
The European Patent Office is in no way liable for these particulars which are merely given for the purpose of information.

02-10-2001

Patent document cited in search report		Publication date	Patent family member(s)	Publication date
DE 4200614	A	04-03-1993	DE 4200614 A1	04-03-1993
US 4136797	A	30-01-1979	FR 2375101 A1	21-07-1978
			AU 1467476 A	15-12-1977
			BE 844202 A1	16-11-1976
			BE 860784 A1	01-03-1978
			BR 7605722 A	23-08-1977
			DE 2630785 A1	03-02-1977
			DE 2751033 A1	24-05-1978
			FR 2318076 A1	11-02-1977
			JP 52012088 A	29-01-1977
			NL 7607917 A	18-01-1977
			NL 7712565 A	17-05-1978
			SE 7712830 A	16-05-1978
			US 4078695 A	14-03-1978
			ES 464168 A1	16-12-1978
			IT 1114669 B	27-01-1986
			NO 773890 A	18-05-1978
			PT 67275 A ,B	01-12-1977
US 3447724	A	03-06-1969	NONE	
US 4127212	A	28-11-1978	NONE	
US 4170724	A	09-10-1979	NONE	
US 4576306	A	18-03-1986	AT 39458 T	15-01-1989
			AU 568908 B2	14-01-1988
			AU 3847685 A	22-08-1985
			BR 8500634 A	01-10-1985
			DE 3566997 D1	02-02-1989
			DK 71885 A	19-08-1985
			EP 0153068 A2	28-08-1985
			ES 284655 U	01-02-1986
			GB 2154561 A ,B	11-09-1985
			GR 850413 A1	17-06-1985
			IE 55936 B1	27-02-1991
			IN 164024 A1	31-12-1988
			JP 3011984 B	19-02-1991
			JP 60217949 A	31-10-1985
			KE 3831 A	02-12-1988
			ZA 8501094 A	25-09-1985
			ZW 1685 A1	08-05-1985
US 5242079	A	07-09-1993	CA 2096560 A1	12-03-1994

EPO FORM P0459

For more details about this annex : see Official Journal of the European Patent Office, No. 12/82