



Europäisches Patentamt
European Patent Office
Office européen des brevets



(11) **EP 1 256 333 A3**

(12) **EUROPEAN PATENT APPLICATION**

(88) Date of publication A3:
08.10.2003 Bulletin 2003/41

(51) Int Cl.7: **A61G 5/12**

(43) Date of publication A2:
13.11.2002 Bulletin 2002/46

(21) Application number: **02010049.1**

(22) Date of filing: **06.05.2002**

(84) Designated Contracting States:
**AT BE CH CY DE DK ES FI FR GB GR IE IT LI LU
MC NL PT SE TR**
Designated Extension States:
AL LT LV MK RO SI

(71) Applicant: **Vassilli s.r.l.**
35020 Saonara (Padova) (IT)

(72) Inventor: **Vassilli, Berto**
35020 Saonara (Padova) (IT)

(30) Priority: **07.05.2001 IT PD20010107**

(54) **Invalid chair**

(57) It is a seating for disabled persons suffering from skeletal malformations, which can assist in obtaining a correct posture, or at least a support for the posture.

The part specifically innovative of the seat concerns the backrest, which consists of a plurality of parts, each allowing to be adjusted according to all six freedom degrees, in order to make up the more suitable rest and/or support for said malformations.

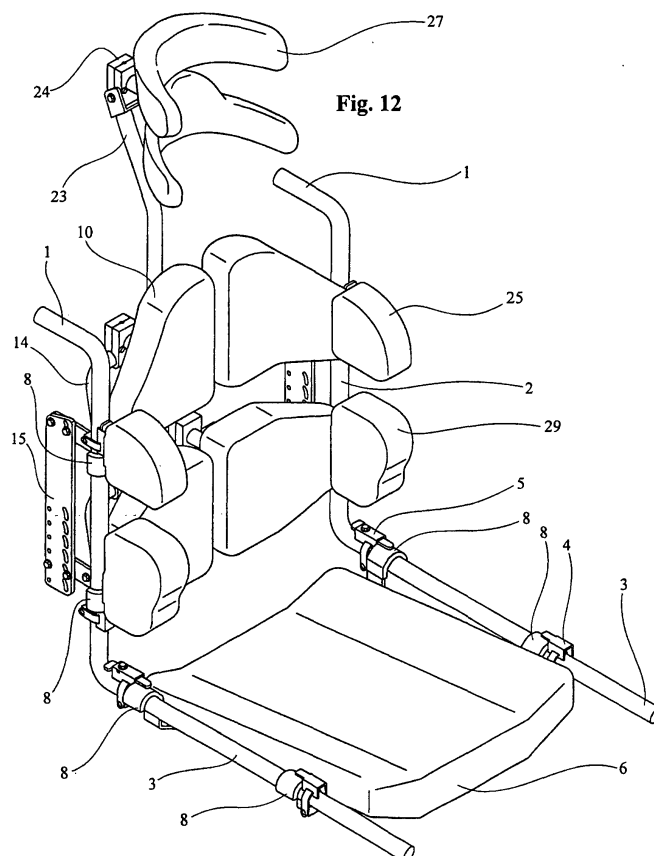

EP 1 256 333 A3



European Patent
Office

EUROPEAN SEARCH REPORT

Application Number
EP 02 01 0049

DOCUMENTS CONSIDERED TO BE RELEVANT			
Category	Citation of document with indication, where appropriate, of relevant passages	Relevant to claim	CLASSIFICATION OF THE APPLICATION (Int.Cl.7)
X	US 6 095 611 A (BAR CHRISTOPHER A ET AL) 1 August 2000 (2000-08-01) * column 2, line 40-45 * * column 19, line 24-38 * * figures 17,19,26 *	1-4	A61G5/12
Y	---	5-7	
Y	US 5 551 756 A (BUSSELL MARK H ET AL) 3 September 1996 (1996-09-03) * column 4, line 58-62 * * column 7, line 44 - column 8, line 10 * * figures 1,4B,5A-6 * -----	5-7	
			TECHNICAL FIELDS SEARCHED (Int.Cl.7)
			A61G
The present search report has been drawn up for all claims			
Place of search THE HAGUE		Date of completion of the search 13 August 2003	Examiner Ong, H.D.
<p>CATEGORY OF CITED DOCUMENTS</p> <p>X : particularly relevant if taken alone Y : particularly relevant if combined with another document of the same category A : technological background O : non-written disclosure P : intermediate document</p> <p>T : theory or principle underlying the invention E : earlier patent document, but published on, or after the filing date D : document cited in the application L : document cited for other reasons & : member of the same patent family, corresponding document</p>			

EPO FORM 1503 03 82 (P04C01)

**ANNEX TO THE EUROPEAN SEARCH REPORT
ON EUROPEAN PATENT APPLICATION NO.**

EP 02 01 0049

This annex lists the patent family members relating to the patent documents cited in the above-mentioned European search report.
The members are as contained in the European Patent Office EDP file on
The European Patent Office is in no way liable for these particulars which are merely given for the purpose of information.

13-08-2003

Patent document cited in search report	Publication date	Patent family member(s)	Publication date
US 6095611 A	01-08-2000	AU 754957 B2	28-11-2002
		AU 1185199 A	27-04-1999
		EP 0957717 A1	24-11-1999
		HU 0001277 A2	28-08-2000
		JP 2001507613 T	12-06-2001
		NO 992632 A	02-08-1999
		NZ 336201 A	27-07-2001
		NZ 510664 A	26-11-2002
		NZ 510665 A	25-10-2002
		WO 9917636 A1	15-04-1999

US 5551756 A	03-09-1996	NONE	
