



Europäisches Patentamt  
European Patent Office  
Office européen des brevets



(11) **EP 1 257 011 A3**

(12) **EUROPEAN PATENT APPLICATION**

(88) Date of publication A3:  
**24.09.2003 Bulletin 2003/39**

(51) Int Cl.7: **H01R 13/58**

(43) Date of publication A2:  
**13.11.2002 Bulletin 2002/46**

(21) Application number: **02010371.9**

(22) Date of filing: **07.05.2002**

(84) Designated Contracting States:  
**AT BE CH CY DE DK ES FI FR GB GR IE IT LI LU  
MC NL PT SE TR**  
Designated Extension States:  
**AL LT LV MK RO SI**

(72) Inventor: **Chirumbolo, Dino**  
**10036 Settimo Torinese (IT)**

(74) Representative: **Jorio, Paolo et al**  
**STUDIO TORTA S.r.l.,**  
**Via Viotti, 9**  
**10121 Torino (IT)**

(30) Priority: **08.05.2001 IT MI20010941**

(71) Applicant: **ITW Industrial Components S.r.l.**  
**20121 Milano (IT)**

(54) **Cable clamping device, particularly for clamping bundles of cables**

(57) A cable clamping device (1) including a base (2) having a seat (3) through which one or more electric cables (4), e.g. supply cables of an electric household appliance, are housed; and a clamping member (5), which is insertable inside the base, crosswise to the seat, through a mouth (6) formed in the base and directly facing the seat, to clamp the cables against a bottom wall (7) of the seat; the clamping member (5) being secured to the base (2) by at least one screw, and by a jack device (18) including a rib (20) having transverse teeth (21) and formed in one piece with the clamping member (5) on the opposite side to a hole (24) for receiving the at least one screw (25), and a recess (22) formed in the base, alongside the seat, to receive the whole length of the rib (20), and having, internally, at least one elastically deformable tooth (23) located so as to click onto the transverse teeth.

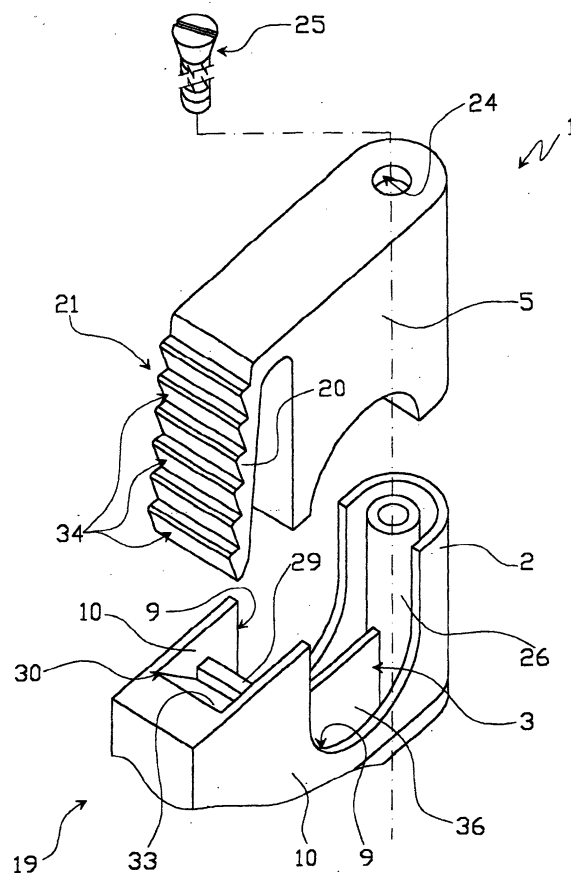

Fig. 3

EP 1 257 011 A3



European Patent  
Office

# EUROPEAN SEARCH REPORT

Application Number  
EP 02 01 0371

DOCUMENTS CONSIDERED TO BE RELEVANT			
Category	Citation of document with indication, where appropriate, of relevant passages	Relevant to claim	CLASSIFICATION OF THE APPLICATION (Int.Cl.7)
X	US 4 516 822 A (WOLFEL LEE A) 14 May 1985 (1985-05-14)	1	H01R13/58
Y	* column 2, line 19 - line 27; figures 1-3 *	2,3,7-9	
A	---	4-6	
X	GB 1 451 416 A (DRAKA KABEL BV) 6 October 1976 (1976-10-06)	1	
A	* page 2, line 54 - line 81; figures 4,5 *	4-6,8,9	
Y	DE 93 03 368 U (ELECTRO-TERMINAL GMBH) 27 May 1993 (1993-05-27)	2,3,7	
X	US 5 653 609 A (ORSTAD RICHARD EDWARD ET AL) 5 August 1997 (1997-08-05)	1	
Y	* abstract; figures 3,4,7-9 *	8,9	
A	GB 2 183 405 A (PLASTIC SEALS LIMITED) 3 June 1987 (1987-06-03)	7	
A	US 4 775 122 A (MCCLYMONT JAMES D) 4 October 1988 (1988-10-04)	2,3	
	* abstract; figures 1,2 *		TECHNICAL FIELDS SEARCHED (Int.Cl.7)
			H01R
The present search report has been drawn up for all claims			
Place of search		Date of completion of the search	Examiner
THE HAGUE		1 August 2003	Jiménez, J
<p>CATEGORY OF CITED DOCUMENTS</p> <p>X : particularly relevant if taken alone  Y : particularly relevant if combined with another document of the same category  A : technological background  O : non-written disclosure  P : intermediate document</p> <p>T : theory or principle underlying the invention  E : earlier patent document, but published on, or after the filing date  D : document cited in the application  L : document cited for other reasons  &amp; : member of the same patent family, corresponding document</p>			

EPO FORM 1503 03 82 (P04C01)

**ANNEX TO THE EUROPEAN SEARCH REPORT  
ON EUROPEAN PATENT APPLICATION NO.**

EP 02 01 0371

This annex lists the patent family members relating to the patent documents cited in the above-mentioned European search report.  
The members are as contained in the European Patent Office EDP file on  
The European Patent Office is in no way liable for these particulars which are merely given for the purpose of information.

01-08-2003

Patent document cited in search report	Publication date	Patent family member(s)	Publication date
US 4516822 A	14-05-1985	AT 60171 T	15-02-1991
		BR 8500831 A	15-10-1985
		CA 1232641 A1	09-02-1988
		DE 3581297 D1	21-02-1991
		EP 0154414 A2	11-09-1985
		ES 295896 U	16-06-1987
		HK 43494 A	13-05-1994
		IE 56721 B1	20-11-1991
		JP 2027274 C	26-02-1996
		JP 7046619 B	17-05-1995
		JP 60216477 A	29-10-1985
		KR 9104801 B1	13-07-1991
		MX 160728 A	30-04-1990
		NO 850429 A	28-08-1985
GB 1451416 A	06-10-1976	NL 7302186 A	20-08-1974
		BE 811136 A1	16-08-1974
		DE 2406003 A1	29-08-1974
		DK 145870 B	21-03-1983
		FR 2218671 A1	13-09-1974
		IT 1007361 B	30-10-1976
DE 9303368 U	27-05-1993	DE 9303368 U1	27-05-1993
US 5653609 A	05-08-1997	NONE	
GB 2183405 A	03-06-1987	NONE	
US 4775122 A	04-10-1988	EP 0268603 A1	01-06-1988
		WO 8707443 A1	03-12-1987
		JP 1500782 T	16-03-1989

EPO FORM P0459

For more details about this annex : see Official Journal of the European Patent Office, No. 12/82