



Europäisches Patentamt
European Patent Office
Office européen des brevets



(11) **EP 1 270 267 A3**

(12) **EUROPEAN PATENT APPLICATION**

(88) Date of publication A3:
05.11.2003 Bulletin 2003/45

(51) Int Cl.7: **B43M 3/04**

(43) Date of publication A2:
02.01.2003 Bulletin 2003/01

(21) Application number: **02012923.5**

(22) Date of filing: **11.06.2002**

(84) Designated Contracting States:
**AT BE CH CY DE DK ES FI FR GB GR IE IT LI LU
MC NL PT SE TR**
Designated Extension States:
AL LT LV MK RO SI

(72) Inventor: **Sting, Martin, Dr.**
61118 Bad Vilbel (DE)

(74) Representative: **Kuhnen & Wacker**
Patentanwalts-gesellschaft dbR
Prinz-Ludwig-Strasse 40A
85354 Freising (DE)

(30) Priority: **20.06.2001 DE 10129573**

(71) Applicant: **Pitney Bowes Technologies GmbH**
61169 Friedberg (DE)

(54) **Mail-processing machine**

(57) In the case of a mail-processing machine, a straightforward construction of the drive for the different machine parts is achieved in that the upwardly and downwardly directed pivoting movements of a pivoting-arm arrangement (30,31), on which a pressure-exerting roller bar (26) interacting with an envelope-conveying belt (25) is retained, are transmitted, via a coupling rod and an actuating lever, to a pivoting shaft on which a pivoting-lever arrangement is located, the bottom ends of the latter bearing spring-loaded auxiliary push-in fingers (10). Since the actuating movements of the pivoting-arm arrangement are produced by cams seated on a drive shaft, and this drive shaft also bears the chain wheels for driving a conveying-chain arrangement by means of which enclosures or sets of enclosures which are to be inserted into envelopes are delivered into the envelope-filling station perpendicularly to the running direction of the envelope-conveying belt, and this drive shaft is also in drive connection with a crank mechanism for the push-in arrangement, the drive systems as a whole can be simplified to a great extent.

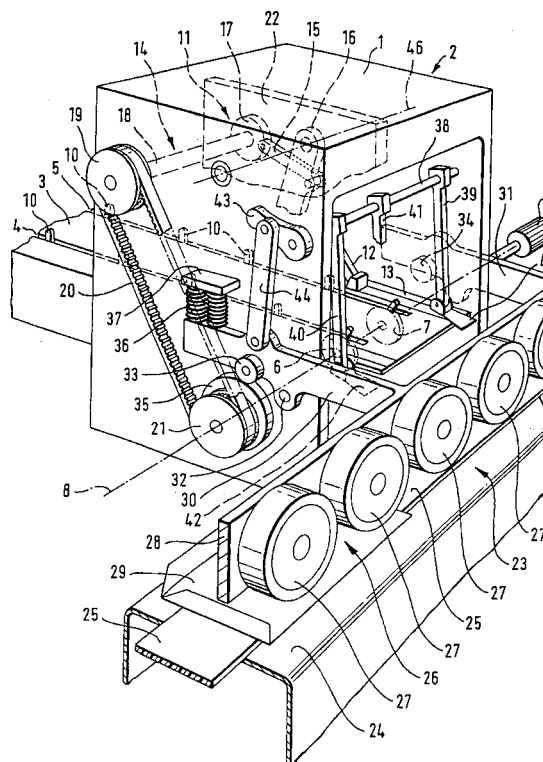

EP 1 270 267 A3



European Patent
Office

EUROPEAN SEARCH REPORT

Application Number
EP 02 01 2923

DOCUMENTS CONSIDERED TO BE RELEVANT			
Category	Citation of document with indication, where appropriate, of relevant passages	Relevant to claim	CLASSIFICATION OF THE APPLICATION (Int.Cl.7)
A,D	DE 100 15 754 C (BELL & HOWELL CO) 7 June 2001 (2001-06-07) * abstract * * column 2, line 5-68 * * column 3, line 1-56 * * claims; figures * ---	1-7	B43M3/04
A	DE 100 15 755 C (BELL & HOWELL CO) 7 June 2001 (2001-06-07) ---		
A	GB 2 353 279 A (BELL & HOWELL CO) 21 February 2001 (2001-02-21) ---		
A	WO 99 01295 A (BRAUNEIS AXEL ;STING MARTIN (DE); BELL & HOWELL CO (DE)) 14 January 1999 (1999-01-14) -----		
			TECHNICAL FIELDS SEARCHED (Int.Cl.7)
			B43M
The present search report has been drawn up for all claims			
Place of search THE HAGUE		Date of completion of the search 12 September 2003	Examiner Oltra García, R
<p>CATEGORY OF CITED DOCUMENTS</p> <p>X : particularly relevant if taken alone Y : particularly relevant if combined with another document of the same category A : technological background O : non-written disclosure P : intermediate document</p> <p>T : theory or principle underlying the invention E : earlier patent document, but published on, or after the filing date D : document cited in the application L : document cited for other reasons & : member of the same patent family, corresponding document</p>			

EPO FORM 1503 03/82 (P04C01)

**ANNEX TO THE EUROPEAN SEARCH REPORT
ON EUROPEAN PATENT APPLICATION NO.**

EP 02 01 2923

This annex lists the patent family members relating to the patent documents cited in the above-mentioned European search report.
The members are as contained in the European Patent Office EDP file on
The European Patent Office is in no way liable for these particulars which are merely given for the purpose of information.

12-09-2003

Patent document cited in search report	Publication date	Patent family member(s)	Publication date
DE 10015754 C	07-06-2001	DE 10015754 C1	07-06-2001
		GB 2362867 A ,B	05-12-2001
DE 10015755 C	07-06-2001	DE 10015755 C1	07-06-2001
		GB 2362628 A ,B	28-11-2001
GB 2353279 A	21-02-2001	DE 19938069 A1	22-02-2001
		US 6536184 B1	25-03-2003
WO 9901295 A	14-01-1999	DE 59802080 D1	13-12-2001
		WO 9901295 A1	14-01-1999
		EP 0993380 A1	19-04-2000
		JP 2002507943 T	12-03-2002
		US 6289658 B1	18-09-2001