



Europäisches Patentamt
European Patent Office
Office européen des brevets



(11) **EP 1 362 540 A1**

(12) **EUROPEAN PATENT APPLICATION**

(43) Date of publication:
19.11.2003 Bulletin 2003/47

(51) Int Cl.7: **A47K 5/122**

(21) Application number: **02076923.8**

(22) Date of filing: **14.05.2002**

(84) Designated Contracting States:
**AT BE CH CY DE DK ES FI FR GB GR IE IT LI LU
MC NL PT SE TR**
Designated Extension States:
AL LT LV MK RO SI

(72) Inventor: **Niada, Gianandrea**
20123 Milano MI (IT)

(74) Representative: **Concone, Emanuele et al**
Società Italiana Brevetti S.p.A.
Via Carducci 8
20123 Milano (IT)

(71) Applicant: **QTS S.r.L.**
20040 Caponago (Mi) (IT)

(54) **Liquid detergent dispenser**

(57) A liquid detergent dispenser includes a replaceable cartridge (R) with squeezeable structure and dispensing device (E), a support (S) provided with holes (H) for wall mounting as well as with a seat (U) suitable to receive the cartridge (R), and means (C, D, N) for locking the cartridge (R) in the seat (U) which can be disengaged only through a specific tool (K). In this way it is possible to combine the practicality of disposable dispensers with the irremovability of conventional wall dispensers.

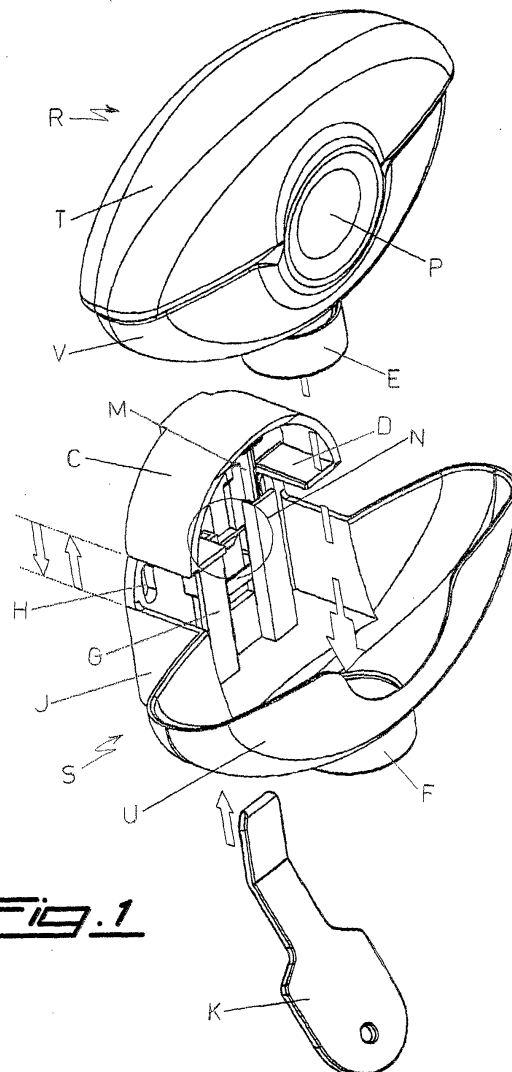

EP 1 362 540 A1

Description

[0001] The present invention relates to liquid detergent dispensers, and in particular to a dispenser with replaceable and/or rechargeable cartridge.

[0002] It is known that there are many types of liquid detergent dispensers for public premises, hotels and the like, in which the detergent is contained in a cartridge housed inside a wall-mounted dispensing apparatus.

[0003] In this type of dispensers the apparatus includes a dispensing device, typically operated through a lever or a pushbutton, while the cartridge only has the function of containing the detergent and when empty it is replaced with another cartridge. Therefore the dispensing device remains mounted on the apparatus and is always the same, which gives rise to some drawbacks.

[0004] A first drawback stems from the possibility that said device fails or gets clogged thus making impossible to dispense the detergent, while a second drawback is given by the difficulty in replacing a type of detergent with another having different chemical-physical properties (e.g. viscosity) which make the device inadequate for dispensing the new detergent.

[0005] On the other hand there are the well-known disposable dispensers simply consisting of a bottle with a dispensing pump mounted thereon, but these dispensers are not generally used in these situations since they can easily be carried off by the users.

[0006] Therefore the object of the present invention is to provide a dispenser which is free from said drawbacks. This object is achieved by means of a dispenser in which the wall support only acts as a fixing system for a replaceable and/or rechargeable cartridge which includes the dispensing device. Other advantageous features of the present dispenser are disclosed in the dependent claims.

[0007] The main advantage of the present dispenser is that of combining the practicality of disposable dispensers with the irremovability of conventional wall dispensers.

[0008] A further advantage stems from the fact that it has a very simple structure which is therefore cheap to manufacture and reliable in operation.

[0009] Further advantages and characteristics of the device according to the present invention will be clear to those skilled in the art from the following detailed description of an embodiment thereof, with reference to the annexed drawings wherein:

Fig.1 is a perspective exploded front view showing the members which make up the dispenser;

Fig.2 is a view similar to the preceding one which shows the locking system between the cartridge and the wall support; and

Fig.3 is a perspective bottom front view showing the assembled dispenser and the unlocking tool.

[0010] With reference to Figs.1 and 2 there is seen that the dispenser according to the present invention is made up of a wall support S in which there is introduced and locked a cartridge R, having a squeezeable structure, which can be removed only with the help of a suitable key K.

[0011] More specifically, support S includes a front seat U with a bottom opening F, as well as a rear extension J in which there are formed holes H for the wall mounting and vertical guides G engaging a semicircular cover C through corresponding columns M. This cover C is provided at its ends with internal horizontal wings D, and between its columns M there is provided a lock-tooth N suitable to engage a corresponding seat formed between guides G.

[0012] Cartridge R has a bottom portion V shaped and sized for introduction into seat U and a dispensing valve E also sized and positioned for introduction into the corresponding opening F. On the contrary, the top portion T is slightly larger to abut along the top edge of seat U, and in the central frontal area there is provided a comparatively more flexible area P which acts as pushbutton for dispensing the detergent in an amount proportional to the pressure exerted by the user.

[0013] The locking of cartridge R onto support S is achieved through projections formed on the back of cartridge R and suitable to be engaged by cover C. More specifically, a central tooth A is formed on the top portion of cartridge R and is engaged by the central portion of the arc of cover C, while a central horizontal ledge B formed on the bottom portion is engaged by wings D of cover C.

[0014] The simple operation of the present dispenser is readily understood from the description above: cartridge R is introduced into seat U, then cover C is lowered until tooth N snaps into engagement with the corresponding seat. To release the cartridge R to be replaced, key K is introduced from below into the bottom opening L of extension J, as shown in Fig.3, pushing upward until tooth N is disengaged so as to allow the lifting of cover C.

[0015] It is clear that the above-described and illustrated embodiment of the dispenser according to the invention is just an example susceptible of various modifications. In particular, the exact shape of seat U and of the corresponding cartridge R may be somewhat changed, same as the locking system for cartridge R and/or cover C, or the dispensing device that might replace valve E.

Claims

1. Liquid detergent dispenser **characterized in that** it includes a cartridge (R) with squeezeable structure and dispensing device (E), a support (S) provided with holes (H) for wall mounting as well as with a seat (U) suitable to receive said cartridge (R), and

means for locking the cartridge (R) in said seat (U) which can be disengaged only through a specific tool.

2. Dispenser according to claim 1, **characterized in that** the means for locking the cartridge (R) in the seat (U) consist of projections formed on the back of the cartridge (R) and suitable to be engaged by a cover (C) slidable on the support (S) between a locking position given by a proper lock-tooth (N) and an open position which allows the removal of the cartridge (R). 5
10
3. Dispenser according to claim 2, **characterized in that** the locking means consist of a central tooth (A) formed on the top portion of the cartridge (R) which is engaged by the central portion of the semicircularly shaped cover (C), and a central horizontal ledge (B) formed on the bottom portion of the cartridge (R) which is engaged by horizontal wings (D) internally arranged at the ends of the cover (C). 15
20
4. Dispenser according to claim 2 or 3, **characterized in that** the cover (C) is provided with columns (M) engaged in vertical guides (G) formed on a rear extension (J) of the seat (U) of the support (S), the lock-tooth (N) being formed between said columns (M) and its corresponding engagement seat being formed between said guides (G). 25
30
5. Dispenser according to claim 4, **characterized in that** the tool for disengaging the locking means consists of a key (K) which can be introduced from below in a bottom opening (L) of the extension (J) until it reaches and disengages the tooth (N). 35
6. Dispenser according to one or more of the preceding claims, **characterized in that** the cartridge (R) has a top portion (T) slightly larger than the bottom portion (V) which fits into the seat (U), so as to abut along the top edge of said seat (U). 40
7. Dispenser according to one or more of the preceding claims, **characterized in that** the cartridge (R) has a comparatively more flexible central frontal area (P) which acts as a pushbutton for dispensing the detergent in an amount proportional to the pressure exerted by the user. 45
50
55

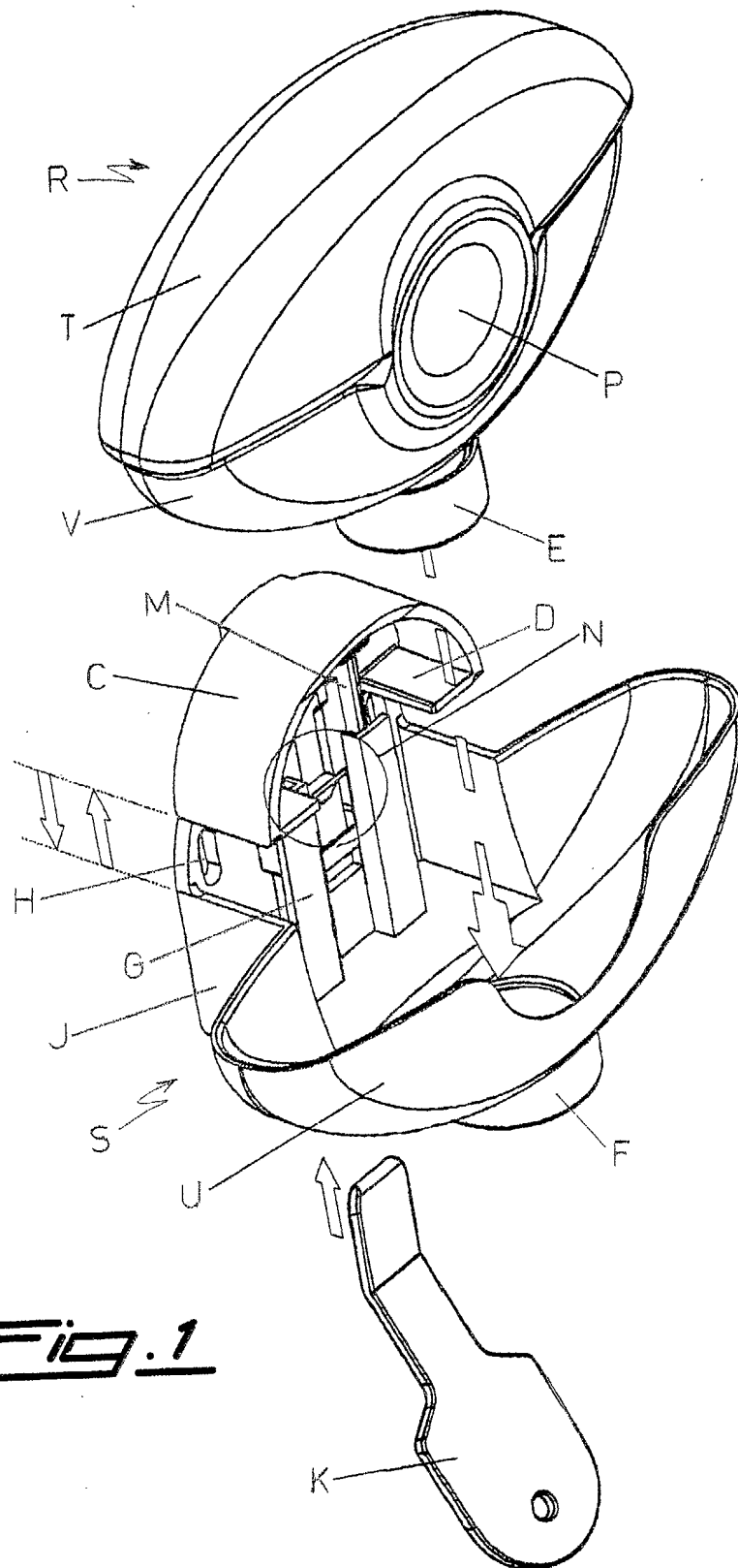
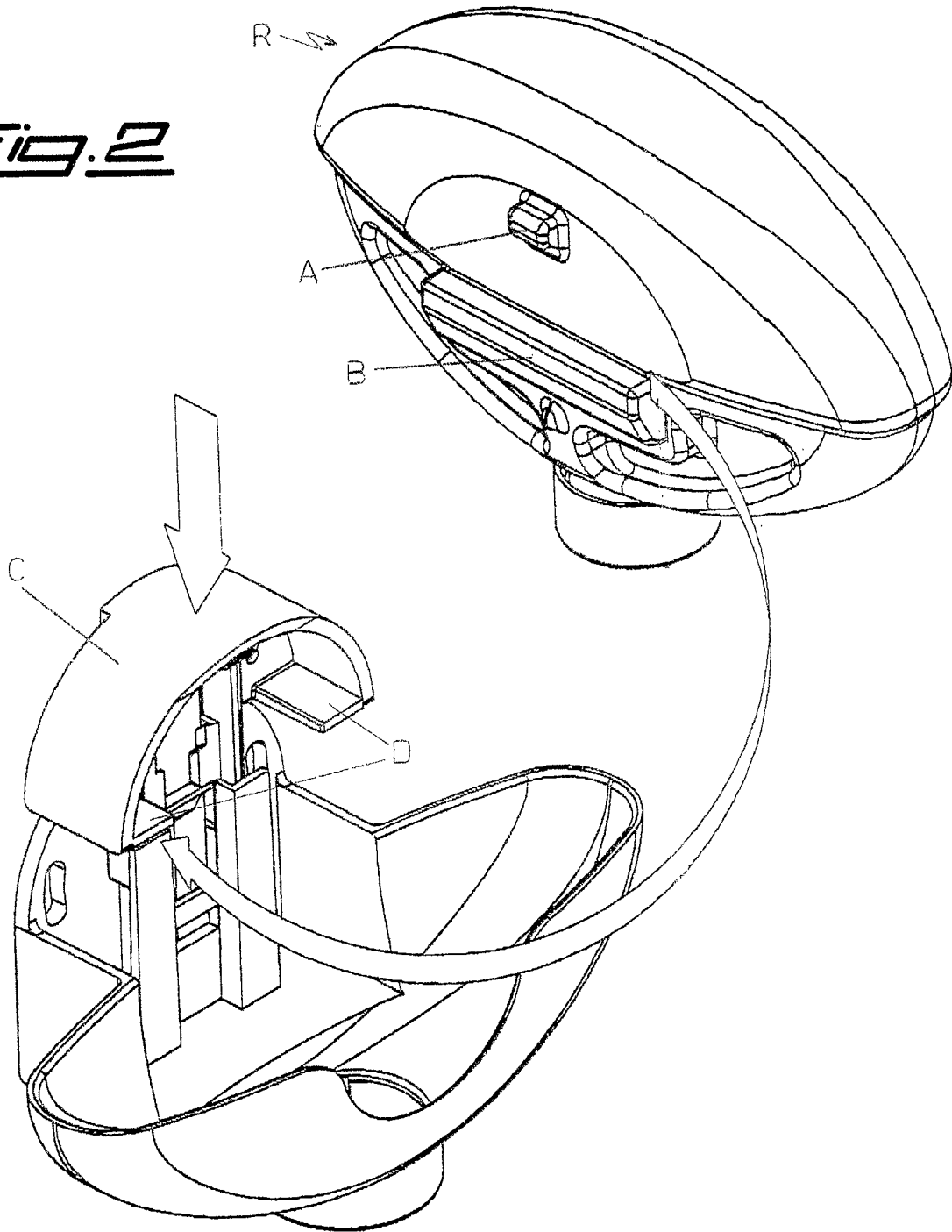

Fig. 1

Fig. 2



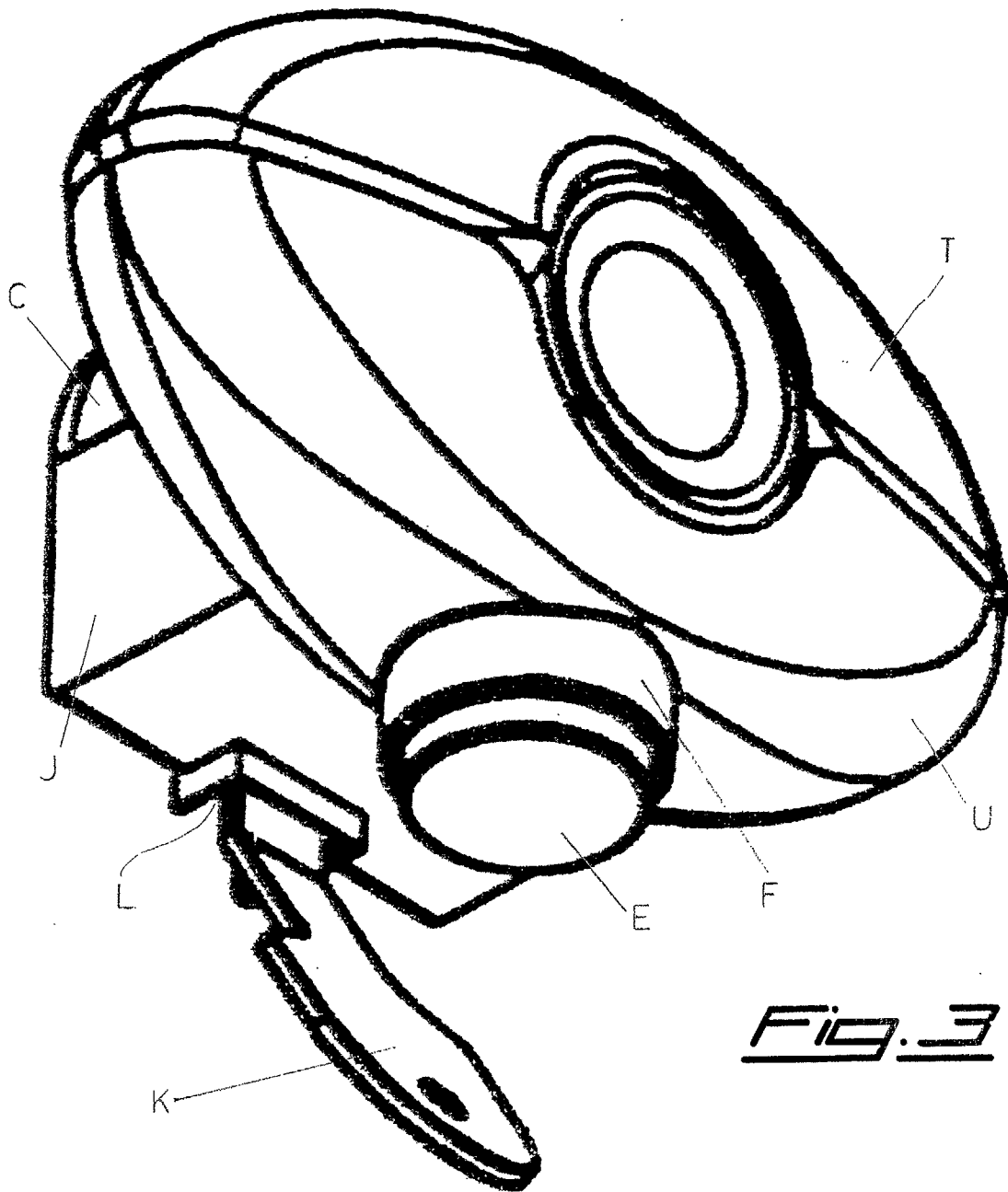

Fig. 3



European Patent
Office

EUROPEAN SEARCH REPORT

Application Number
EP 02 07 6923

DOCUMENTS CONSIDERED TO BE RELEVANT			
Category	Citation of document with indication, where appropriate, of relevant passages	Relevant to claim	CLASSIFICATION OF THE APPLICATION (Int.Cl.7)
X	EP 0 530 789 A (ADA HOTELCOSMETIC GMBH) 10 March 1993 (1993-03-10) * the whole document * ---	1,6	A47K5/122
A	US 4 673 109 A (CASSIA ANTONIO M) 16 June 1987 (1987-06-16) * the whole document * ---	1,2	
A	US 3 540 630 A (BROWN RICHARD ET AL) 17 November 1970 (1970-11-17) * the whole document * -----	1,2	
The present search report has been drawn up for all claims			TECHNICAL FIELDS SEARCHED (Int.Cl.7)
			A47K
Place of search	Date of completion of the search	Examiner	
THE HAGUE	2 October 2002	Fordham, A	
CATEGORY OF CITED DOCUMENTS		T : theory or principle underlying the invention E : earlier patent document, but published on, or after the filing date D : document cited in the application L : document cited for other reasons & : member of the same patent family, corresponding document	
X : particularly relevant if taken alone Y : particularly relevant if combined with another document of the same category A : technological background O : non-written disclosure P : intermediate document			

EPO FORM 1503 03/82 (P04/C01)

**ANNEX TO THE EUROPEAN SEARCH REPORT
ON EUROPEAN PATENT APPLICATION NO.**

EP 02 07 6923

This annex lists the patent family members relating to the patent documents cited in the above-mentioned European search report. The members are as contained in the European Patent Office EDP file on
The European Patent Office is in no way liable for these particulars which are merely given for the purpose of information.

02-10-2002

Patent document cited in search report		Publication date	Patent family member(s)	Publication date
EP 0530789	A	10-03-1993	DE 4129717 A1	11-03-1993
			AT 123393 T	15-06-1995
			CA 2125160 A1	18-03-1993
			DE 59202445 D1	13-07-1995
			WO 9304621 A1	18-03-1993
			EP 0530789 A1	10-03-1993
			ES 2074779 T3	16-09-1995
			HK 1006671 A1	12-03-1999
US 4673109	A	16-06-1987	AT 74730 T	15-05-1992
			CA 1312314 A1	05-01-1993
			DE 3684866 D1	21-05-1992
			EP 0219931 A2	29-04-1987
			JP 2010967 C	02-02-1996
			JP 7038838 B	01-05-1995
			JP 62094123 A	30-04-1987
US 3540630	A	17-11-1970	AT 282828 B	10-07-1970
			BE 716072 A	04-11-1968
			CH 517476 A	15-01-1972
			DE 1778796 A1	27-04-1972
			DK 135745 B	20-06-1977
			ES 354873 A1	16-11-1969
			FI 46459 B	02-01-1973
			FR 1569219 A	30-05-1969
			GB 1210515 A	28-10-1970
			IL 30094 A	29-12-1971
			LU 56361 A	04-10-1968
			NL 6808935 A , B	30-12-1968
			NO 124622 B	15-05-1972
SE 333625 B	22-03-1971			