



Europäisches Patentamt
European Patent Office
Office européen des brevets



(11)

EP 1 375 790 A3

(12)

EUROPEAN PATENT APPLICATION

(88) Date of publication A3:
18.10.2006 Bulletin 2006/42

(51) Int Cl.:
E05B 21/00 (2006.01) **E05B 9/02** (2006.01)
E05B 35/08 (2006.01)

(43) Date of publication A2:
02.01.2004 Bulletin 2004/01

(21) Application number: **03011699.0**

(22) Date of filing: **23.05.2003**

(84) Designated Contracting States:
**AT BE BG CH CY CZ DE DK EE ES FI FR GB GR
HU IE IT LI LU MC NL PT RO SE SI SK TR**
Designated Extension States:
AL LT LV MK

(72) Inventor: **Mottura, Sergio**
10057 Sant'Ambrogio (Torino) (IT)

(74) Representative: **Notaro, Giancarlo et al**
c/o Buzzi, Notaro & Antonielli d'Oulx
Via Maria Vittoria 18
10123 Torino (IT)

(30) Priority: **19.06.2002 IT TO20020529**

(71) Applicant: **MOTTURA SERRATURE DI
SICUREZZA S.p.A.**
I-10057 S.Ambrogio, (Torino) (IT)

(54) **Safety lock for household doors and similar**

(57) A safety lock is described that is equipped with a removable core provided with means of rekeying that permit the lock to be adapted to a new key.

Fig. 15

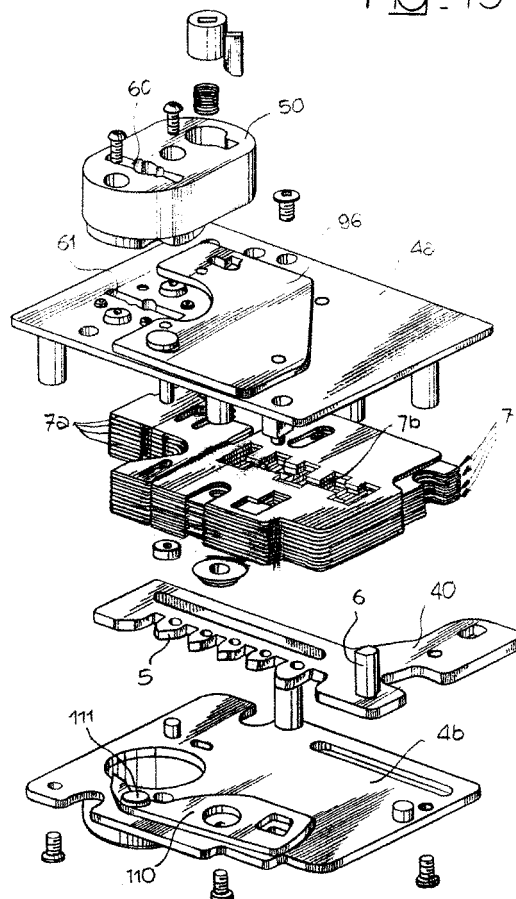

EP 1 375 790 A3



European Patent
Office

EUROPEAN SEARCH REPORT

Application Number
EP 03 01 1699

DOCUMENTS CONSIDERED TO BE RELEVANT			
Category	Citation of document with indication, where appropriate, of relevant passages	Relevant to claim	CLASSIFICATION OF THE APPLICATION (IPC)
X	EP 0 943 761 A (COSTRUZIONI ITALIANE SERRATURE; CISA S.P.A) 22 September 1999 (1999-09-22)	6	INV. E05B21/00 E05B9/02 E05B35/08
A	* the whole document *	1-4	
X	EP 0 744 517 A (COSTRUZIONI ITALIANE SERRATURE AFFINI C.I.S.A. S.P.A) 27 November 1996 (1996-11-27)	6	
A	* the whole document *	1-4	
X	EP 0 656 454 A (COSTRUZIONI ITALIANE SERRATURE AFFINI C.I.S.A. S.P.A) 7 June 1995 (1995-06-07)	6	
A	* the whole document *	1-4	
A	EP 1 154 102 A (MOTTURA SERRATURE DI SICUREZZA S.P.A) 14 November 2001 (2001-11-14)	1	
A	EP 0 974 717 A (DI. BI. PORTE BLINDATE S.R.L) 26 January 2000 (2000-01-26)	1	TECHNICAL FIELDS SEARCHED (IPC) E05B
The present search report has been drawn up for all claims			
Place of search The Hague		Date of completion of the search 12 September 2006	Examiner PEREZ MENDEZ, J
CATEGORY OF CITED DOCUMENTS X : particularly relevant if taken alone Y : particularly relevant if combined with another document of the same category A : technological background O : non-written disclosure P : intermediate document T : theory or principle underlying the invention E : earlier patent document, but published on, or after the filing date D : document cited in the application L : document cited for other reasons & : member of the same patent family, corresponding document			

3
EPO FORM 1503 03.82 (P04C01)



European Patent
Office

Application Number
EP 03 01 1699

CLAIMS INCURRING FEES

The present European patent application comprised at the time of filing more than ten claims.

- ☐ Only part of the claims have been paid within the prescribed time limit. The present European search report has been drawn up for the first ten claims and for those claims for which claims fees have been paid, namely claim(s):
- ☐ No claims fees have been paid within the prescribed time limit. The present European search report has been drawn up for the first ten claims.

LACK OF UNITY OF INVENTION

The Search Division considers that the present European patent application does not comply with the requirements of unity of invention and relates to several inventions or groups of inventions, namely:

see sheet B

- ☐ All further search fees have been paid within the fixed time limit. The present European search report has been drawn up for all claims.
- ☒ As all searchable claims could be searched without effort justifying an additional fee, the Search Division did not invite payment of any additional fee.
- ☐ Only part of the further search fees have been paid within the fixed time limit. The present European search report has been drawn up for those parts of the European patent application which relate to the inventions in respect of which search fees have been paid, namely claims:
- ☐ None of the further search fees have been paid within the fixed time limit. The present European search report has been drawn up for those parts of the European patent application which relate to the invention first mentioned in the claims, namely claims:



The Search Division considers that the present European patent application does not comply with the requirements of unity of invention and relates to several inventions or groups of inventions, namely:

1. claims: 1 and 2-5 (when dependent on claim 1)

Rekeyable safety lock with a removable core, the removable core itself being rekeyable.

2. claims: 6 and 2-5 (when dependent on 6)

Rekeyable safety lock having two-half safety plates and special means for blocking a first type of half-plate during rekeying.

**ANNEX TO THE EUROPEAN SEARCH REPORT
ON EUROPEAN PATENT APPLICATION NO.**

EP 03 01 1699

This annex lists the patent family members relating to the patent documents cited in the above-mentioned European search report.
The members are as contained in the European Patent Office EDP file on
The European Patent Office is in no way liable for these particulars which are merely given for the purpose of information.

12-09-2006

Patent document cited in search report		Publication date	Patent family member(s)	Publication date
EP 0943761	A	22-09-1999	ES 2159975 T3 IT B0980132 A1 PT 943761 T	16-10-2001 06-09-1999 30-01-2002
EP 0744517	A	27-11-1996	ES 2155549 T3 GR 3035921 T3 IT B0950266 A1 PT 744517 T	16-05-2001 31-08-2001 26-11-1996 30-08-2001
EP 0656454	A	07-06-1995	ES 2132311 T3 GR 3031000 T3 IT 1264745 B1	16-08-1999 31-12-1999 04-10-1996
EP 1154102	A	14-11-2001	CN 1323943 A IT T020000442 A1	28-11-2001 12-11-2001
EP 0974717	A	26-01-2000	IT M0980166 A1	21-01-2000