



(12) **EUROPEAN PATENT APPLICATION**

(88) Date of publication A3:
23.11.2005 Bulletin 2005/47

(51) Int Cl.7: **F01D 5/08, F01D 5/32**

(43) Date of publication A2:
03.03.2004 Bulletin 2004/10

(21) Application number: **03255403.2**

(22) Date of filing: **29.08.2003**

(84) Designated Contracting States:
**AT BE BG CH CY CZ DE DK EE ES FI FR GB GR
HU IE IT LI LU MC NL PT RO SE SI SK TR**
Designated Extension States:
AL LT LV MK

- **Barrera, Domingo Resendez**
Cincinnati, Ohio 45241 (US)
- **Brown, Jeffrey Louis**
Mason, Ohio 45040 (US)

(30) Priority: **29.08.2002 US 231420**

(74) Representative: **Goode, Ian Roy**
London Patent Operation,
General Electric International Inc.,
15 John Adam Street
London WC2N 6LU (GB)

(71) Applicant: **GENERAL ELECTRIC COMPANY**
Schenectady, NY 12345 (US)

(72) Inventors:
• **Dougherty, James Steven**
Mason, Ohio 45040 (US)

(54) **Gas turbine engine disk rim with axially cutback and circumferentially skewed cooling air slots**

(57) A gas turbine engine rotor disk assembly (10) includes a disk (12) having an annular hub (14) circumscribed about a centerline (16). An annular web (18) extends radially outwardly from the hub (14) to an annular rim (22). A plurality of dovetail slots (30) extend generally axially through the rim (22). A plurality of cooling air slots (32) extending generally radially through the rim (22) and are skewed circumferentially with respect to the centerline (16) and slanted axially aftwardly with respect to a normal radius perpendicular to the centerline (16). In the exemplary embodiment, each cooling air slot (32) has parallel side walls (36) skewed circumferentially with respect to the centerline (16) and an aft wall (38) extending between the side walls and slanted axially aftwardly with respect to the normal radius. The side walls (36) are skewed circumferentially about 5 degrees with respect to the centerline (16) and the aft wall (38) is slanted axially aftwardly about 18 degrees with respect to the normal radius.

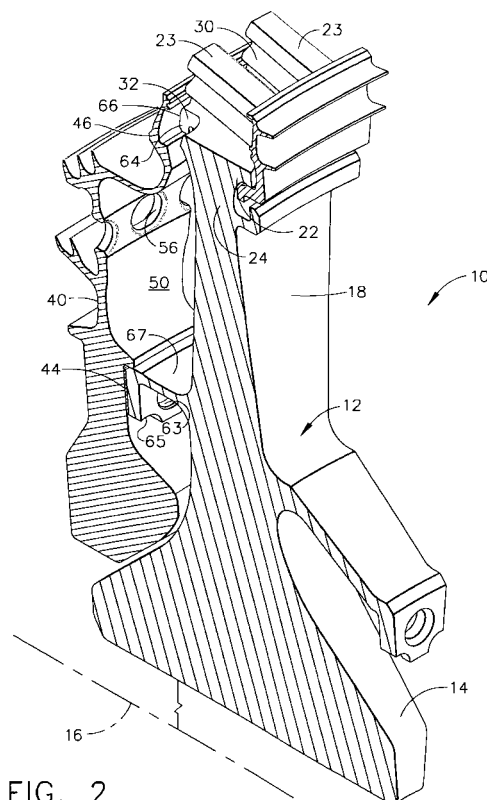

FIG. 2

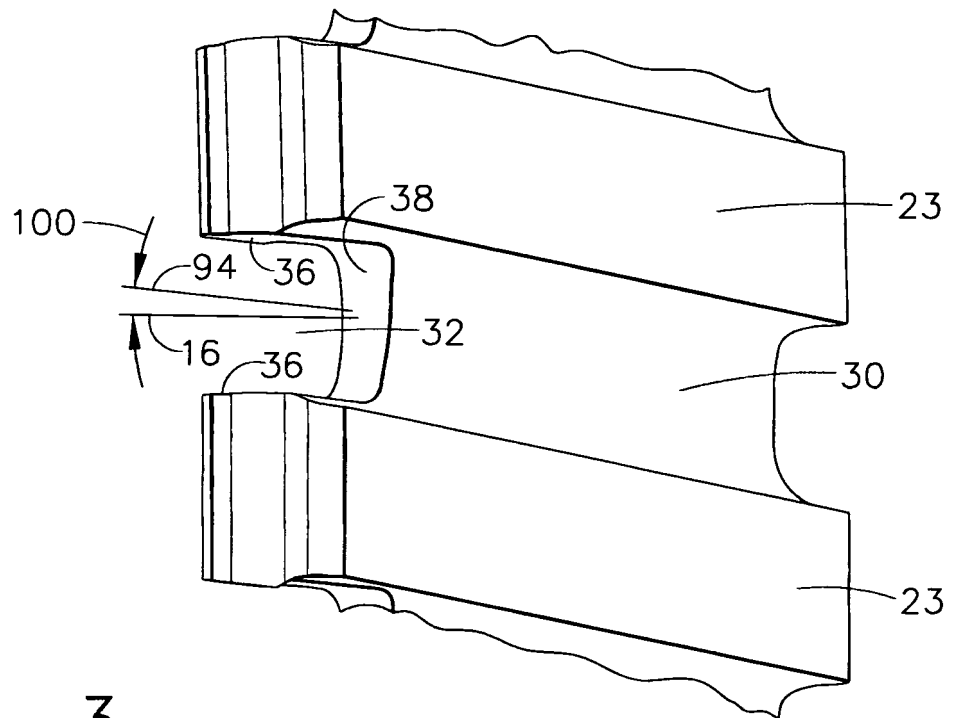

FIG. 3



DOCUMENTS CONSIDERED TO BE RELEVANT			
Category	Citation of document with indication, where appropriate, of relevant passages	Relevant to claim	CLASSIFICATION OF THE APPLICATION (Int.Cl.7)
A	EP 0 814 233 A (ROLLS-ROYCE PLC) 29 December 1997 (1997-12-29) * column 3, line 44 - line 45 * * column 4, line 42 - line 48 * * column 6, line 1 - line 5 * * figures 3-5 * -----	1-3,6,10	F01D5/08 F01D5/32
A	US 5 816 776 A (CHAMBON ET AL) 6 October 1998 (1998-10-06) * figures 2,4 * -----	1,5-8	
A	EP 0 502 660 A (GENERAL ELECTRIC COMPANY) 9 September 1992 (1992-09-09) * figure 9 * -----	1,2,5-7, 9	
A	US 2 951 340 A (HOWALD WERNER E) 6 September 1960 (1960-09-06) * figure 2 * -----	1,2,6,8, 10	
			TECHNICAL FIELDS SEARCHED (Int.Cl.7)
			F01D
The present search report has been drawn up for all claims			
Place of search		Date of completion of the search	Examiner
The Hague		28 September 2005	Angelucci, S
CATEGORY OF CITED DOCUMENTS			
X : particularly relevant if taken alone Y : particularly relevant if combined with another document of the same category A : technological background O : non-written disclosure P : intermediate document		T : theory or principle underlying the invention E : earlier patent document, but published on, or after the filing date D : document cited in the application L : document cited for other reasons & : member of the same patent family, corresponding document	

1
EPO FORM 1503 03.82 (F04C01)

**ANNEX TO THE EUROPEAN SEARCH REPORT
ON EUROPEAN PATENT APPLICATION NO.**

EP 03 25 5403

This annex lists the patent family members relating to the patent documents cited in the above-mentioned European search report. The members are as contained in the European Patent Office EDP file on the European Patent Office is in no way liable for these particulars which are merely given for the purpose of information.

28-09-2005

Patent document cited in search report		Publication date	Patent family member(s)	Publication date
EP 0814233	A	29-12-1997	DE 69709245 D1	31-01-2002
			DE 69709245 T2	13-06-2002
			US 5888049 A	30-03-1999

US 5816776	A	06-10-1998	CA 2196642 A1	09-08-1997
			DE 69701332 D1	06-04-2000
			DE 69701332 T2	27-07-2000
			EP 0789133 A1	13-08-1997
			FR 2744761 A1	14-08-1997

EP 0502660	A	09-09-1992	CA 2061983 A1	05-09-1992
			JP 5071305 A	23-03-1993

US 2951340	A	06-09-1960	NONE	
