



Europäisches Patentamt
European Patent Office
Office européen des brevets



(11) **EP 1 403 415 A3**

(12) **EUROPEAN PATENT APPLICATION**

(88) Date of publication A3:
17.11.2004 Bulletin 2004/47

(51) Int Cl.7: **D06F 39/02**

(43) Date of publication A2:
31.03.2004 Bulletin 2004/14

(21) Application number: **03021226.0**

(22) Date of filing: **18.09.2003**

(84) Designated Contracting States:
**AT BE BG CH CY CZ DE DK EE ES FI FR GB GR
HU IE IT LI LU MC NL PT RO SE SI SK TR**
Designated Extension States:
AL LT LV MK

(72) Inventor: **Chirumbolo, Dino**
10036 Settimo Torinese (IT)

(74) Representative: **Jorio, Paolo et al**
Studio Torta
Via Viotti 9
10121 Torino (IT)

(30) Priority: **19.09.2002 IT to20020813**

(71) Applicant: **ITW Industrial Components S.r.l.**
20121 Milano (IT)

(54) **Device for automatically extracting a dispenser drawer of an electrical household appliance such as a washing machine, and electric household appliance featuring such a device**

(57) A device for automatically extracting from a seat (4) a drawer (3) for dispensing detergent and/or other process fluids of an electric household appliance; the device including a release device (10), elastic means (11) for pushing the drawer from the seat into an extracted position, and decelerating means (12) for opposing the movement of the drawer; wherein the elastic means act on a rotary-to-linear motion conversion device (14) located between the drawer (3) and a fixed member of the seat (4) to produce a linear movement of the seat into the extracted position upon release of the elastic means (11); and wherein the decelerating means act on a rotary member (15) of the rotary-to-linear motion conversion device (14).

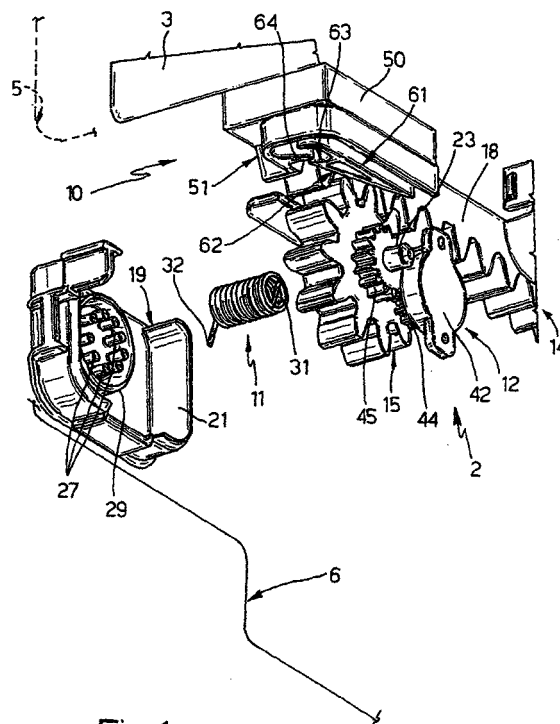

Fig. 1

EP 1 403 415 A3



European Patent
Office

EUROPEAN SEARCH REPORT

Application Number
EP 03 02 1226

DOCUMENTS CONSIDERED TO BE RELEVANT			
Category	Citation of document with indication, where appropriate, of relevant passages	Relevant to claim	CLASSIFICATION OF THE APPLICATION (Int.Cl.7)
X	US 4 828 344 A (OMATA NOBUAKI) 9 May 1989 (1989-05-09) * the whole document *	1,2,6-8	D06F39/02
X	US 4 494 806 A (WILLIAMS V HAROLD ET AL) 22 January 1985 (1985-01-22) * the whole document *	1,7-10	
A	US 5 675 994 A (GWEON TAE SOUNG) 14 October 1997 (1997-10-14) * the whole document *	1,12	
The present search report has been drawn up for all claims			TECHNICAL FIELDS SEARCHED (Int.Cl.7) D06F A47B
Place of search The Hague		Date of completion of the search 30 September 2004	Examiner Norman, P
CATEGORY OF CITED DOCUMENTS X : particularly relevant if taken alone Y : particularly relevant if combined with another document of the same category A : technological background O : non-written disclosure P : intermediate document T : theory or principle underlying the invention E : earlier patent document, but published on, or after the filing date D : document cited in the application L : document cited for other reasons & : member of the same patent family, corresponding document			

EPO FORM 1503 03.02 (P04C01)

**ANNEX TO THE EUROPEAN SEARCH REPORT
ON EUROPEAN PATENT APPLICATION NO.**

EP 03 02 1226

This annex lists the patent family members relating to the patent documents cited in the above-mentioned European search report. The members are as contained in the European Patent Office EDP file on
The European Patent Office is in no way liable for these particulars which are merely given for the purpose of information.

30-09-2004

Patent document cited in search report		Publication date	Patent family member(s)	Publication date
US 4828344	A	09-05-1989	JP 1624338 C	18-11-1991
			JP 2050275 B	01-11-1990
			JP 61078980 A	22-04-1986
US 4494806	A	22-01-1985	NONE	
US 5675994	A	14-10-1997	KR 149912 B1	15-05-1999
			CN 1141371 A ,B	29-01-1997
			JP 2709294 B2	04-02-1998
			JP 9000781 A	07-01-1997