



(12) **EUROPEAN PATENT APPLICATION**

(88) Date of publication A3:
28.11.2007 Bulletin 2007/48

(51) Int Cl.:
B65H 29/14 (2006.01)

(43) Date of publication A2:
15.09.2004 Bulletin 2004/38

(21) Application number: **04251424.0**

(22) Date of filing: **11.03.2004**

(84) Designated Contracting States:
AT BE BG CH CY CZ DE DK EE ES FI FR GB GR HU IE IT LI LU MC NL PL PT RO SE SI SK TR
Designated Extension States:
AL LT LV MK

• **Matsushima, Ryoichi,**
Brother Kogyo K. K.
Nagoya-shi,
Aichi-ken 467-8561 (JP)

(30) Priority: **14.03.2003 JP 2003070679**

(71) Applicant: **Brother Kogyo Kabushiki Kaisha**
Nagoya-shi, Aichi-ken 467-8561 (JP)

(74) Representative: **Smith, Samuel Leonard**
J.A. Kemp & Co.,
14 South Square,
Gray's Inn
London WC1R 5JJ (GB)

(72) Inventors:
• **Ohama, Takashi,**
Brother Kogyo K. K.
Nagoya-shi,
Aichi-ken 467-8561 (JP)

(54) **Sheet feeder in image reading apparatus**

(57) A sheet feeder includes a plurality of roller pairs (19,20), which are drive roller segments and driven roller segments that press against the drive roller segments, disposed in pairs at a downstream side of a reading point. At least an outer layer of each of the drive roller segments is constructed of a material, such as a rubber, having a high coefficient of friction relative to a document sheet and at least an outer layer of each of the driven roller segments is made from a material having a low coefficient of friction relative to the document sheet. The drive roller segments are disposed on an axis (30) perpendicular to a sheet feed direction, whereas the driven roller segments are disposed on axes (29) inclined to the sheet feed direction symmetrically about a centerline of a width of the document sheet. Further, the axes of the driven roller segments are inclined such that the end of each of the segment's axis furthest from the centerline is on one of an upstream or downstream side of a sheet feed direction and an end closest to the centerline is on one of a downstream or upstream side of the sheet feed direction opposite that of the other end.

FIG.3

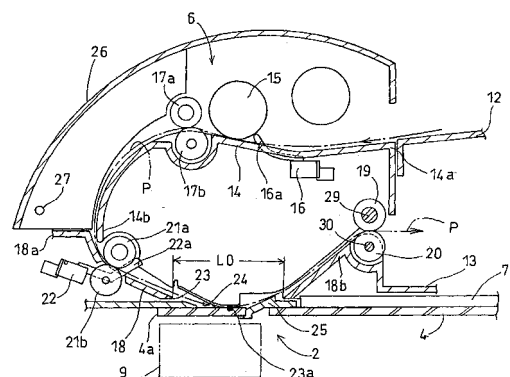



European Patent
Office

EUROPEAN SEARCH REPORT

Application Number
EP 04 25 1424

DOCUMENTS CONSIDERED TO BE RELEVANT			
Category	Citation of document with indication, where appropriate, of relevant passages	Relevant to claim	CLASSIFICATION OF THE APPLICATION (IPC)
A	US 6 254 078 B1 (TARUKI) 3 July 2001 (2001-07-03) * the whole document *	1,7,9, 11,18	INV. B65H29/14
A	US 5 579 099 A (NISHIYAMA) 26 November 1996 (1996-11-26) * the whole document *	1,7	
P,A	EP 1 335 575 A (CANON KABUSHIKI KAISHA) 13 August 2003 (2003-08-13) * the whole document *	1	
			TECHNICAL FIELDS SEARCHED (IPC)
			B65H
The present search report has been drawn up for all claims			
Place of search The Hague		Date of completion of the search 16 October 2007	Examiner De Rijck, Freddy
<p>CATEGORY OF CITED DOCUMENTS</p> <p>X : particularly relevant if taken alone Y : particularly relevant if combined with another document of the same category A : technological background O : non-written disclosure P : intermediate document</p> <p>T : theory or principle underlying the invention E : earlier patent document, but published on, or after the filing date D : document cited in the application L : document cited for other reasons & : member of the same patent family, corresponding document</p>			

1
EPO FORM 1503 03/82 (P04C01)

**ANNEX TO THE EUROPEAN SEARCH REPORT
ON EUROPEAN PATENT APPLICATION NO.**

EP 04 25 1424

This annex lists the patent family members relating to the patent documents cited in the above-mentioned European search report.
The members are as contained in the European Patent Office EDP file on
The European Patent Office is in no way liable for these particulars which are merely given for the purpose of information.

16-10-2007

Patent document cited in search report	Publication date	Patent family member(s)	Publication date
US 6254078	B1	03-07-2001	JP 3710636 B2 26-10-2005
			JP 2000181152 A 30-06-2000

US 5579099	A	26-11-1996	JP 3347858 B2 20-11-2002
			JP 7209927 A 11-08-1995

EP 1335575	A	13-08-2003	CN 1435990 A 13-08-2003
			JP 3943942 B2 11-07-2007
			JP 2003221145 A 05-08-2003
			US 2003141654 A1 31-07-2003

EPO FORM P0459

For more details about this annex : see Official Journal of the European Patent Office, No. 12/82