



Europäisches Patentamt  
European Patent Office  
Office européen des brevets



(11) **EP 1 477 730 A3**

(12) **EUROPEAN PATENT APPLICATION**

(88) Date of publication A3:  
**15.03.2006 Bulletin 2006/11**

(51) Int Cl.:  
**F21V 14/04<sup>(2006.01)</sup> F21S 10/06<sup>(2006.01)</sup>**

(43) Date of publication A2:  
**17.11.2004 Bulletin 2004/47**

(21) Application number: **04010445.7**

(22) Date of filing: **03.05.2004**

(84) Designated Contracting States:  
**AT BE BG CH CY CZ DE DK EE ES FI FR GB GR  
HU IE IT LI LU MC NL PL PT RO SE SI SK TR**  
Designated Extension States:  
**AL HR LT LV MK**

(72) Inventor: **Bonny, Lester**  
**40057 Cadriano di Granarolo Emilia (IT)**

(74) Representative: **Modiano, Micaela Nadia et al**  
**Dr. Modiano & Associati S.p.A.**  
**Via Meravigli 16**  
**20123 Milano (IT)**

(30) Priority: **06.05.2003 IT BO20030052**

(71) Applicant: **Emiservice SRL**  
**40127 Bologna (IT)**

(54) **Laser unit for emitting a beam of light, suitable to produce light effects**

(57) A laser unit (1) for emitting a light beam suitable to provide light effects, which comprises a laser generator (9), a mirror (11) arranged along a direction in which the beam is emitted by the generator (9), and a station (13) for the controlled deflection of the beam, all three components being rigidly mounted on a movable motorized base that allows to orientate the beam emitted by the generator (9); the station (13) comprises two elements for reflecting the light beam, which can move with respect to the base and can rotate about respective rotation axes.

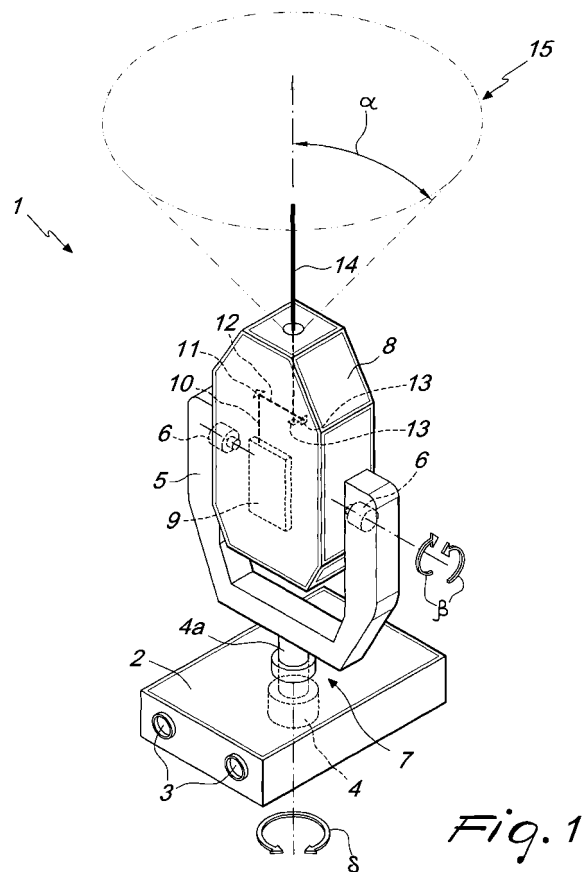

*Fig. 1*

**EP 1 477 730 A3**



European Patent  
Office

# EUROPEAN SEARCH REPORT

Application Number  
EP 04 01 0445

DOCUMENTS CONSIDERED TO BE RELEVANT			
Category	Citation of document with indication, where appropriate, of relevant passages	Relevant to claim	CLASSIFICATION OF THE APPLICATION (IPC)
X	US 5 864 417 A (HO ET AL) 26 January 1999 (1999-01-26) * column 2, line 14 - column 5, line 30; figures 1-6 *	1	F21V14/04 F21S10/06
Y	-----	8-10	
Y	GB 2 342 466 A (GARY STUART * MORRIS) 12 April 2000 (2000-04-12) * page 1, line 1 - page 12, line 5; figures 1,2 *	8-10	
A	----- US 6 079 835 A (YU ET AL) 27 June 2000 (2000-06-27) * column 1, line 66 - column 3, line 5; figures 1-8 *	1-10	
	-----		
			TECHNICAL FIELDS SEARCHED (IPC)
			F21V F21S G03B
The present search report has been drawn up for all claims			
Place of search Munich		Date of completion of the search 20 January 2006	Examiner Arboreanu, A
CATEGORY OF CITED DOCUMENTS X : particularly relevant if taken alone Y : particularly relevant if combined with another document of the same category A : technological background O : non-written disclosure P : intermediate document		T : theory or principle underlying the invention E : earlier patent document, but published on, or after the filing date D : document cited in the application L : document cited for other reasons ..... & : member of the same patent family, corresponding document	

1  
EPO FORM 1503 (03.02 (P04C01))

**ANNEX TO THE EUROPEAN SEARCH REPORT  
ON EUROPEAN PATENT APPLICATION NO.**

EP 04 01 0445

This annex lists the patent family members relating to the patent documents cited in the above-mentioned European search report.  
The members are as contained in the European Patent Office EDP file on  
The European Patent Office is in no way liable for these particulars which are merely given for the purpose of information.

20-01-2006

Patent document cited in search report		Publication date	Patent family member(s)	Publication date
US 5864417	A	26-01-1999	DE 29712018 U1	18-09-1997
GB 2342466	A	12-04-2000	NONE	
US 6079835	A	27-06-2000	NONE	