



Europäisches Patentamt  
European Patent Office  
Office européen des brevets



(11)

**EP 1 484 135 A1**

(12)

**EUROPEAN PATENT APPLICATION**

(43) Date of publication:  
**08.12.2004 Bulletin 2004/50**

(51) Int Cl.7: **B25B 13/46**

(21) Application number: **03018541.7**

(22) Date of filing: **18.08.2003**

(84) Designated Contracting States:  
**AT BE BG CH CY CZ DE DK EE ES FI FR GB GR  
HU IE IT LI LU MC NL PT RO SE SI SK TR**  
Designated Extension States:  
**AL LT LV MK**

(72) Inventor: **Huang, Hsiu-Ching**  
**Taipei (TW)**

(74) Representative: **Casalonga, Axel et al**  
**BUREAU D.A. CASALONGA - JOSSE**  
**Paul-Heyse-Strasse 33**  
**80336 München (DE)**

(30) Priority: **05.06.2003 US 454196**

(71) Applicant: **Huang, Hsiu-Ching**  
**Taipei (TW)**

(54) **Ratchet wrench**

(57) A wrench includes a handle (10), a clutch (30), a detent, a controller (40), a gear (20) and a C-ring (21). The handle includes an annular head (11) defining a circular space (12), a pothole (13) not overlapping the circular space, a channel (15) for communicating the circular space with the pothole, a recess (14) and an annular groove (16) both defined in a wall of the circular space. The clutch includes two claws (31) put in the recess and a spring (32) put between the claws. Each of the claws includes a toothed face (33) and a rod (34).

The claws can easily be put into the recess since the rods can be moved through the channel. A controller is put rotationally in the pothole for moving the rods. The gear is put in the circular space. The gear includes a toothed face (22) for engagement with the toothed face of one of the claws. The C-ring includes an external edge put in the annular groove, an internal edge for retaining the annular gear in the circular space and a gate (23) projecting from an upper face for blocking the channel.

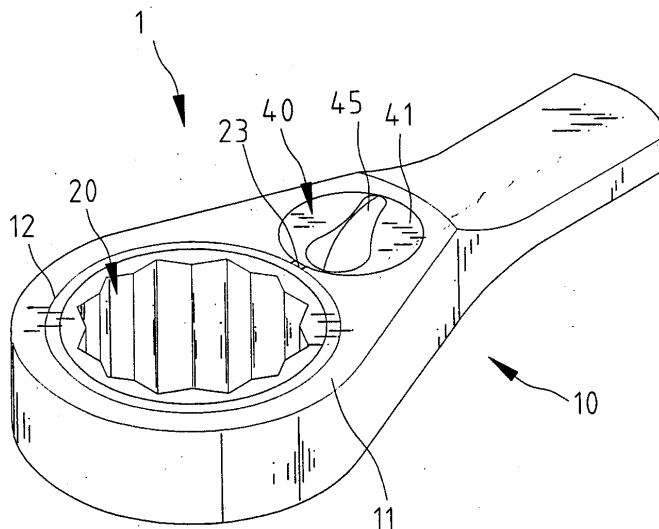

**Fig. 1**

**EP 1 484 135 A1**

## Description

### Field of Invention

[0001] The present invention relates to a robust wrench.

### Background of Invention

[0002] Taiwanese Patent Publication No. 380471 discloses a conventional wrench including an annular head 20 and a grip 21 extending from the annular head 20. The annular head 20 defines a space 22, a recess 23 communicated with the space 22, a hole 24 communicated with the recess 23, a hole 25 co-centrally communicated with the hole 24 and a hole 26 eccentrically communicated with the hole 24. The space 22 partially overlaps the hole 24. A clutch is put in the recess 23. The clutch includes two claws 40 and a spring 43 between the claws 40. Each of the claws 40 includes a toothed face 41 and a rod 42. An annular gear 30 is put in the space 22. The annular gear 30 includes a toothed internal face 31 for engagement with a nut or a head of a bolt and a toothed external face 33 for engagement with the toothed face 41 of one of the claws 40. A positioning device 60 is put in the hole 26. The positioning device 60 includes a spring 61 and a ball detent 62. A disc 50 is put in the hole 24. The disc 50 includes a central hole 51 through which a bolt is driven into the hole 25. A recess 52 and two recesses 53 are defined in a lower face of the disc 50. The rods 42 are put in the recess 52. The recess 52 includes two opposite walls in contact with the rods 42. The ball detent 62 can be put in one of the recesses 53. A handle 54 is secured to the disc 50. However, the annular gear 30 is likely to escape the space 22 since it is retained only by means of a portion of the disc 50.

[0003] The present invention is therefore intended to obviate or at least alleviate the problem encountered in prior art.

### Summary of Invention

[0004] The primary objective of the present invention is to provide a robust wrench.

[0005] According to the present invention, a wrench includes a handle, a clutch, a detent, a controller, a gear and a C-ring. The handle includes an annular head defining a circular space, a pothole not overlapping the circular space, a channel for communicating the circular space with the pothole, a recess and an annular groove both defined in a wall of the circular space. The clutch includes two claws put in the recess and a spring put between the claws. Each of the claws includes a toothed face and a rod. The claws can easily be put into the recess since the rods can be moved through the channel. A controller is put rotationally in the pothole for moving the rods. The gear is put in the circular space. The gear

includes a toothed face for engagement with the toothed face of one of the claws. The C-ring includes an external edge put in the annular groove, an internal edge for retaining the annular gear in the circular space and a gate projecting from an upper face for blocking the channel.

[0006] Other objects, advantages and novel features of the invention will become more apparent from the following detailed description in conjunction with the attached drawings.

### Brief Description of Drawings

[0007] The present invention will be described via detailed illustration of embodiments referring to the drawings.

Figure 1 is a perspective view of a wrench according to a first embodiment of the present invention.

Figure 2 is an exploded view of the wrench of Figure 1.

Figure 3 is a top view of the wrench of Figure 1.

Figure 4 is a cross-sectional view of the shown in Figure 1.

Figure 5 is an exploded view of a wrench according to a second embodiment of the present invention.

Figure 6 is an exploded view of a wrench according to a third embodiment of the present invention.

### Detailed Description of Embodiments

[0008] Referring to Figures 1~4, a wrench 1 according to a first embodiment of the present invention includes a handle 10, an annular gear 20, a clutch 30 and a controller 40.

[0009] The handle 10 includes an annular head 11 and a grip (not numbered) extending from the annular head 11.

[0010] The annular head 11 defines a space 12 and a pothole 13. The space 12 is in the form of a large circle. The pothole 13 is in the form of a small circle not overlapping the large circle. The space 12 is communicated with the pothole 13 through a channel 15. A recess 14 and an annular groove 16 are defined in the wall of the space 12. The recess 14 is communicated with the pothole 13. A hole 17 is defined in the bottom of the pothole 13.

[0011] The clutch 30 is put in the recess 14. The clutch 30 includes two claws 31 and a spring 32 between the claws 31. Each of the claws 31 includes a toothed face 33 and a rod 34. The claws 31 can be put into the recess 14 since the rods 34 can be moved through the channel 15.

[0012] A positioning device including a spring 18 and

a ball detent 19 is put in the hole 17.

[0013] The controller 40 is put in the pothole 13. The controller 40 includes a disc 41 and a C-ring 42. The disc 41 includes a recess 43 and two recesses 44 all defined in a lower face. The rods 34 are put in the recess 43. The recess 43 includes two opposite walls for contact with the rods 42. The ball detent 19 can be put in one of the recesses 44. A ridge 45 is formed on an upper face of the disc 41. The disc 41 defines an annular groove 46 so as to receive an internal edge of the C-ring 42. The wall of the pothole 13 defines an annular groove 47 so as to receive an external edge of the C-ring 42.

[0014] The annular gear 20 is put in the space 12. The annular gear 20 includes a toothed internal face (not numbered) for engagement with a nut or a head of a bolt and a toothed external face 22 for engagement with the toothed face 33 of one of the claws 31.

[0015] A C-ring 21 includes a gate 23 projecting from an upper face. The C-ring 21 includes an external edge put in the annular groove 16 and an internal edge for retaining the annular gear 20 in the space 12. The channel 15 is shut by means of the gate 21.

[0016] Figure 5 shows a wrench 1 according to a second embodiment of the present invention. In the second embodiment, the disc 41 includes a rod 48 projecting from the lower face. An annular groove 49 is defined in the rod 48. The rod 48 is inserted through an aperture 50 defined in the bottom of the pothole 13. A C-clip 51 includes an internal edge put in the annular groove 49 and an external edge for abutment against the annular head 11. The second embodiment is otherwise identical to the first embodiment.

[0017] Figure 6 shows a wrench 1 according to a third embodiment of the present invention. In the third embodiment, the disc 41 includes a hole 52 defined in the lower face. A bolt 53 is driven into the hole 52 through the aperture 50. A gear 24 is put in the space 12. The gear 24 includes an insert 25 projecting from a lower face. The insert 25 can be fit in a socket (not shown) that can receive a nut or a head of a bolt.

[0018] An annular groove 49 is defined in the rod 48. The rod 48 is inserted through an aperture 50 defined in the bottom of the pothole 13. A C-clip 51 includes an internal edge put in the annular groove 49 and an external edge for abutment against the annular head 11. The third embodiment is otherwise identical to the second embodiment.

[0019] The present invention has been described via detailed illustration of embodiments. Those skilled in the art can derive variations from the embodiments without departing from the scope of the present invention. Therefore, the embodiments shall not limit the scope of the present invention defined in the claims.

## Claims

1. A wrench including:

o a handle (10) including an annular head (11) defining a circular space (12), a pothole (13) not overlapping the circular space (12), a channel (15) for communicating the circular space (12) with the pothole (13), a recess (14) and an annular groove (16) both defined in a wall of the circular space (12);

o a clutch (30) including two claws (31) put in the recess (14) and a spring (32) put between the claws (31), the claws (31) each including a toothed face (33) and a rod (34), wherein the claws (31) can easily be put into the recess (14) since the rods (34) can be moved through the channel (15);

□ a controller (40) put rotationally in the pothole (13) for moving the rods (34);

□ a gear (20; 24) put in the circular space (12), the gear (20; 24) including a toothed face (22) for engagement with the toothed face (33) of one of the claws (31); and

o a C-ring (21) including an external edge put in the annular groove (16), an internal edge for retaining the annular gear (20) in the circular space (12) and a gate (23) projecting from an upper face for blocking the channel (15).

2. The wrench according to claim 1 wherein the gear (20) is an annular gear including a toothed internal face.

3. The wrench according to claim 1 wherein the gear (24) includes an insert (25) projecting from a lower face.

4. The wrench according to claim 1 including a detent (18; 19) put in a hole (17) defined in a bottom of the pothole (13), and the controller (40) defines two recesses (44) for receiving the detent (18; 19).

5. The wrench according to claim 1 wherein the controller (40) includes a disc (41) put rotationally in the pothole (13).

6. The wrench according to claim 5 wherein the disc (41) defines a recess (43) for receiving the rods (34).

7. The wrench according to claim 5 wherein the controller (40) includes a ridge (45) formed on the disc (41).

8. The wrench according to claim 5 wherein the controller (40) includes a C-ring (42) with an internal edge put in an annular groove (46) defined in the disc (41) and an external edge put in an annular groove (47) defined in a wall of the pothole (13).

9. The wrench according to claim 5 wherein the, con-

troller (40) includes a rod (48) projecting from the disc (41) and through an aperture (50) defined in the annular head (11), an annular groove (49) defined in the rod (48), and a C-clip (51) including an internal edge put in the annular groove (49) and an external edge for abutment against the annular head (11). 5

10. The wrench according to claim 5 wherein the controller (40) includes a hole (52) defined in the disc (41) and a bolt (53) driven into the hole (52) through an aperture (50) defined in the annular head (11). 10

15

20

25

30

35

40

45

50

55

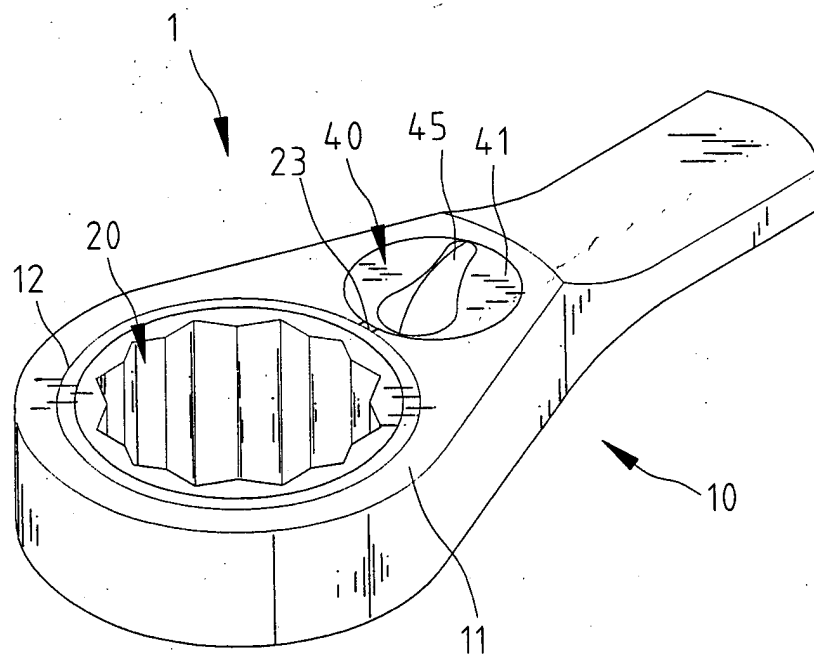
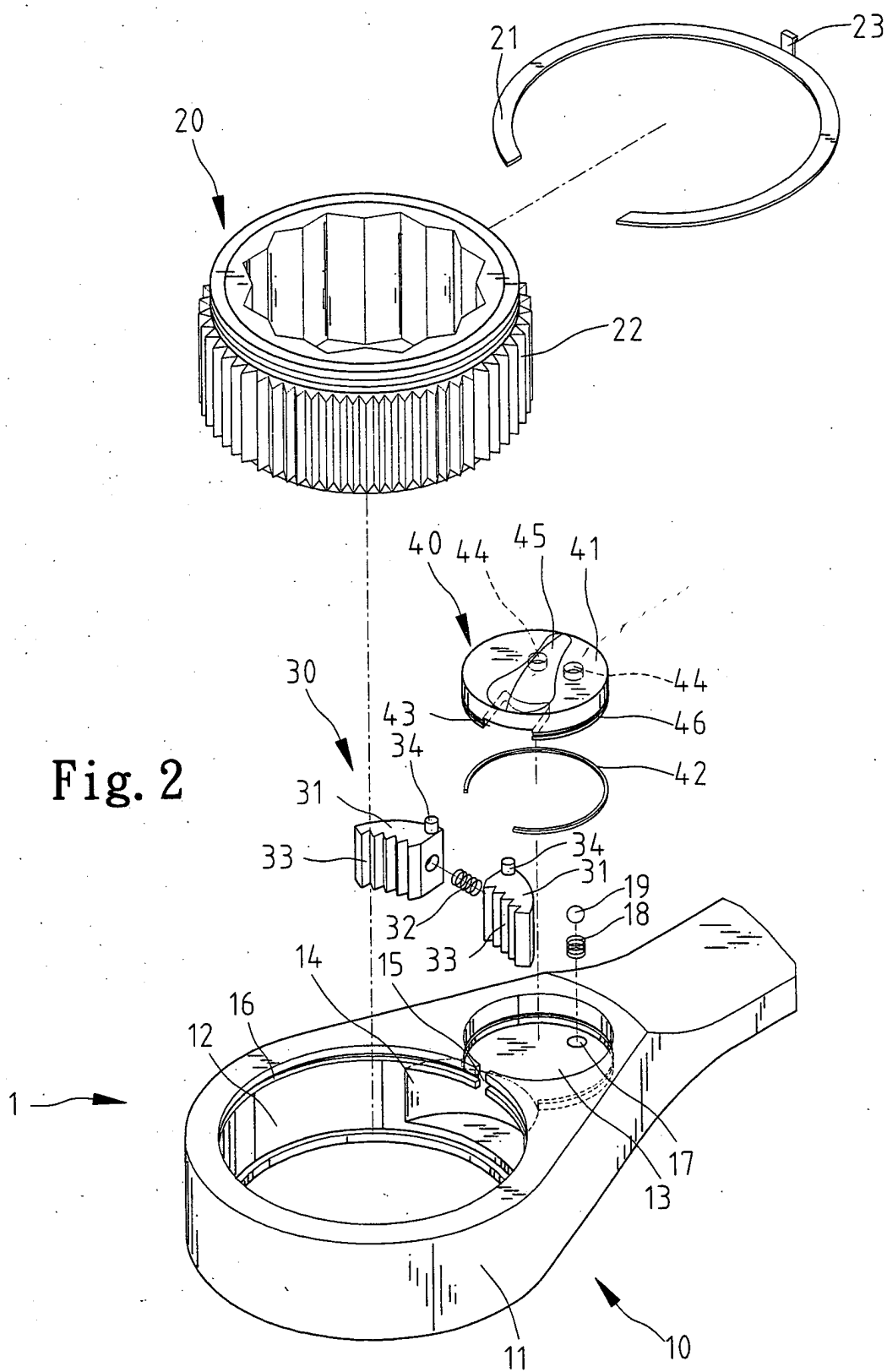

Fig. 1



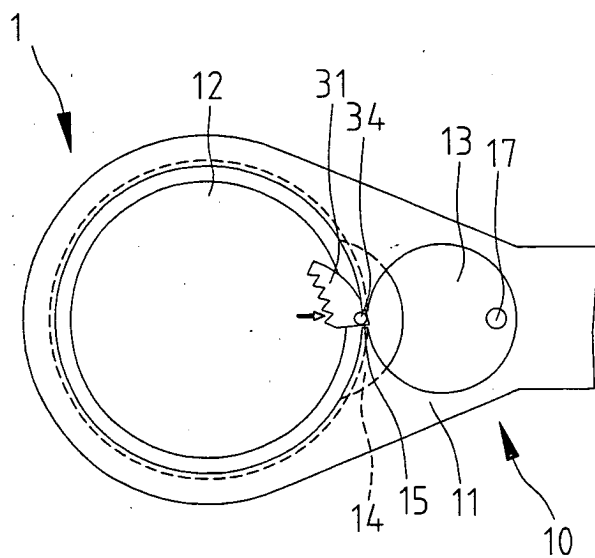

Fig. 3

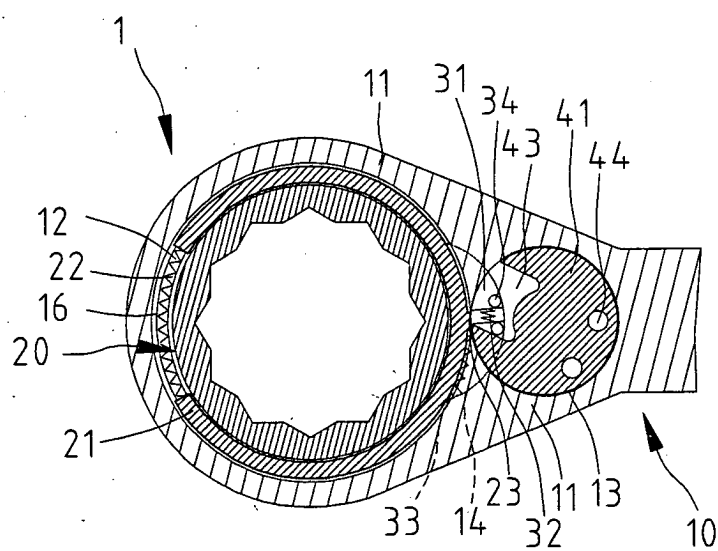
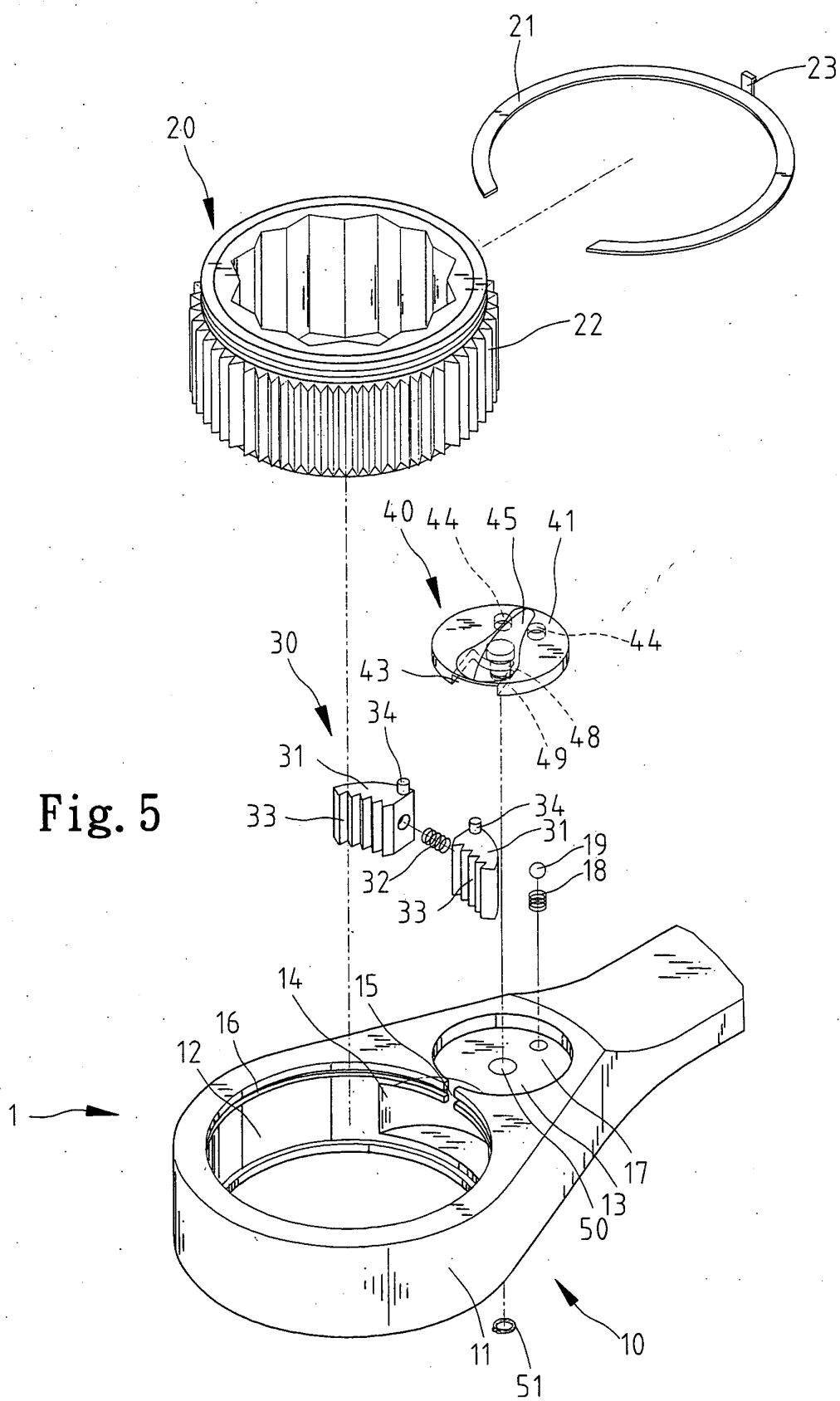

Fig. 4





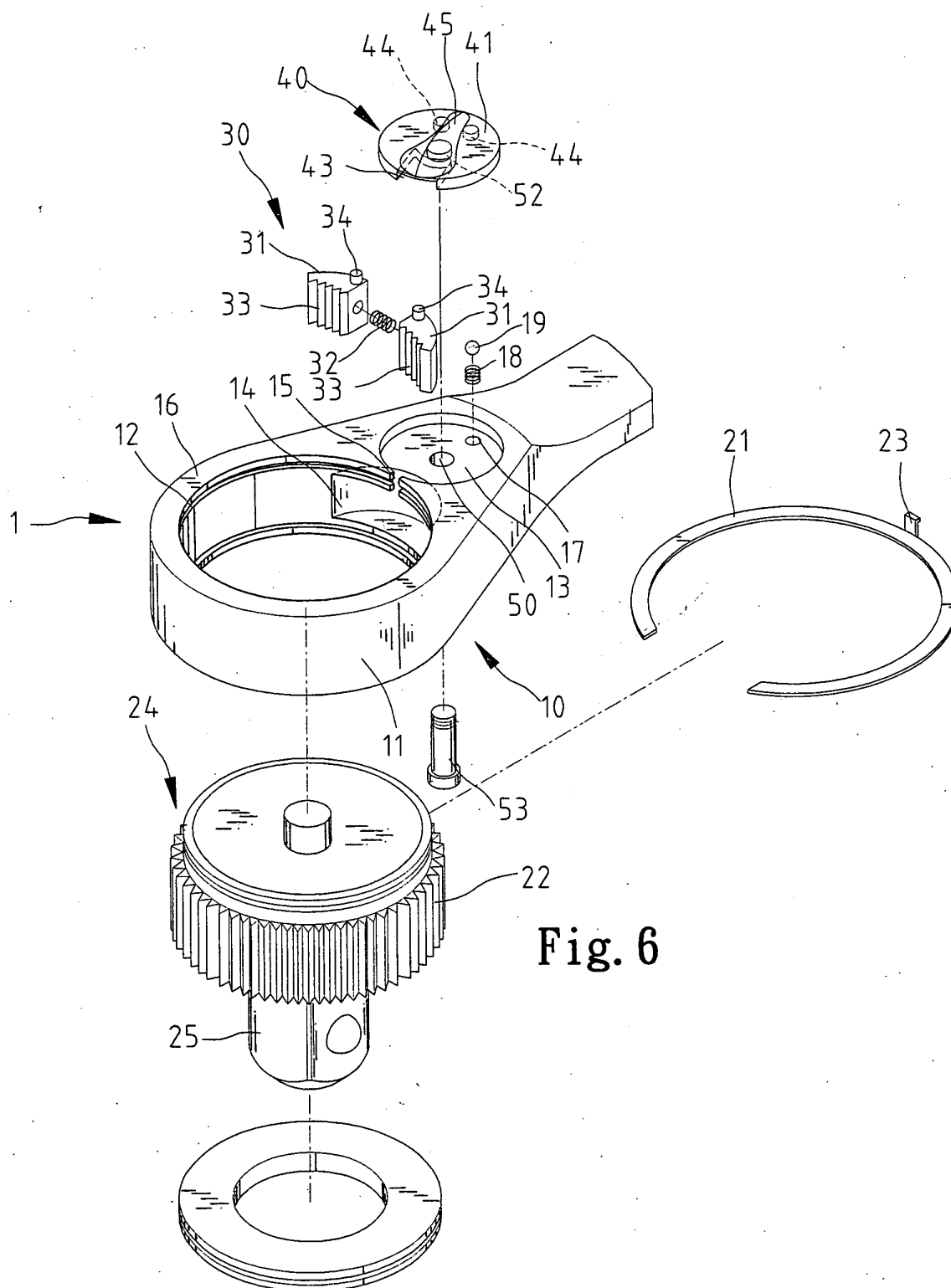

Fig. 6



European Patent  
Office

# EUROPEAN SEARCH REPORT

Application Number  
EP 03 01 8541

DOCUMENTS CONSIDERED TO BE RELEVANT			
Category	Citation of document with indication, where appropriate, of relevant passages	Relevant to claim	CLASSIFICATION OF THE APPLICATION (Int.Cl.7)
A	GB 2 353 746 A (LEE JACK) 7 March 2001 (2001-03-07) * the whole document *	1-7,10	B25B13/46
A	DE 202 01 047 U (LEE DANIEL) 11 April 2002 (2002-04-11) * figure 7 *	1,2,4-7,10	
A	US 6 513 409 B1 (LEE DANIEL) 4 February 2003 (2003-02-04) * column 4, line 9 - line 15; figure 2 *	1,2,4,5,8	
A	EP 1 084 797 A (HAND TOOL DESIGN CORP) 21 March 2001 (2001-03-21) * paragraph '0036!; figures 1,12 *	1,2,5,9	
A	US 6 386 072 B1 (PEI-CHIH YANG ET AL) 14 May 2002 (2002-05-14) * figure 2 *	1	
A	DE 102 38 793 A (HU BOBBY) 27 March 2003 (2003-03-27) * figure 2 *	1	TECHNICAL FIELDS SEARCHED (Int.Cl.7)
A	US 6 382 052 B1 (CHEN SHWU RUU) 7 May 2002 (2002-05-07) * figure 2 *	1	B25B
A	US 6 289 771 B1 (HSIEH CHIH-CHING) 18 September 2001 (2001-09-18) * figure 9 *	1	
The present search report has been drawn up for all claims			
Place of search THE HAGUE		Date of completion of the search 3 June 2004	Examiner Carmichael, Guy
CATEGORY OF CITED DOCUMENTS X : particularly relevant if taken alone Y : particularly relevant if combined with another document of the same category A : technological background O : non-written disclosure P : intermediate document T : theory or principle underlying the invention E : earlier patent document, but published on, or after the filing date D : document cited in the application L : document cited for other reasons & : member of the same patent family, corresponding document			

EPO FORM 1503 03 B2 (P04C01)

**ANNEX TO THE EUROPEAN SEARCH REPORT  
ON EUROPEAN PATENT APPLICATION NO.**

EP 03 01 8541

This annex lists the patent family members relating to the patent documents cited in the above-mentioned European search report. The members are as contained in the European Patent Office EDP file on  
The European Patent Office is in no way liable for these particulars which are merely given for the purpose of information.

03-06-2004

Patent document cited in search report		Publication date	Patent family member(s)	Publication date
GB 2353746	A	07-03-2001	AU 721120 B3	22-06-2000
			DE 29915837 U1	09-12-1999
			FR 2799147 A3	06-04-2001
			NL 1013081 C2	20-03-2001
DE 20201047	U	11-04-2002	DE 20201047 U1	11-04-2002
US 6513409	B1	04-02-2003	NONE	
EP 1084797	A	21-03-2001	US 6230591 B1	15-05-2001
			EP 1084797 A1	21-03-2001
US 6386072	B1	14-05-2002	NONE	
DE 10238793	A	27-03-2003	DE 10238793 A1	27-03-2003
US 6382052	B1	07-05-2002	NONE	
US 6289771	B1	18-09-2001	DE 20015932 U1	14-12-2000
			FR 2814103 A3	22-03-2002
			GB 2367515 A	10-04-2002

EPO FORM P0459

For more details about this annex : see Official Journal of the European Patent Office, No. 12/82