



(11) **EP 1 497 191 B1**

(12) **EUROPEAN PATENT SPECIFICATION**

(45) Date of publication and mention of the grant of the patent:  
**02.09.2009 Bulletin 2009/36**

(21) Application number: **03711609.2**

(22) Date of filing: **17.03.2003**

(51) Int Cl.:  
**B65D 33/36 (2006.01)**

(86) International application number:  
**PCT/US2003/008114**

(87) International publication number:  
**WO 2003/084831 (16.10.2003 Gazette 2003/42)**

(54) **FLEXIBLE CONTAINMENT CHARGING DEVICE**

FLEXIBLE BEHÄLTERFÜLLVORRICHTUNG

DISPOSITIF DE CHARGEMENT A CONFINEMENT SOUPLE

(84) Designated Contracting States:  
**AT BE BG CH CY CZ DE DK EE ES FI FR GB GR HU IE IT LI LU MC NL PT RO SE SI SK TR**

(30) Priority: **01.04.2002 US 368537 P**

(43) Date of publication of application:  
**19.01.2005 Bulletin 2005/03**

(73) Proprietor: **ILC DOVER, INC.**  
**Frederica, DE 19946 (US)**

(72) Inventor: **MANLOVE, Lance, Fuller**  
**Seaford, DE 19973 (US)**

(74) Representative: **Petraz, Gilberto Luigi et al**  
**GLP S.r.l.**  
**Piazzale Cavedalis 6/2**  
**33100 Udine (IT)**

(56) References cited:

<b>EP-A- 1 115 036</b>	<b>DE-U1- 9 208 593</b>
<b>GB-A- 2 354 754</b>	<b>US-A- 3 961 655</b>
<b>US-A- 4 817 824</b>	<b>US-A- 4 996 760</b>
<b>US-A- 5 018 877</b>	<b>US-A- 5 332 495</b>
<b>US-A- 5 365 720</b>	<b>US-A- 6 132 090</b>

**EP 1 497 191 B1**

Note: Within nine months of the publication of the mention of the grant of the European patent in the European Patent Bulletin, any person may give notice to the European Patent Office of opposition to that patent, in accordance with the Implementing Regulations. Notice of opposition shall not be deemed to have been filed until the opposition fee has been paid. (Art. 99(1) European Patent Convention).

## Description

### Background of the Invention

**[0001]** The present invention relates to a film based material transfer device, with an integrated restraint system that protects the process operator and environment from the potent or otherwise harmful, and/or toxic substances contained within it, as well as a method for producing the film based material transfer device. GB-A-2.354.754 discloses a fluid transport container having the features of the preamble of the independent claim.

### Description of the Related Art

**[0002]** Material transfer devices for potent compounds used in the pharmaceutical industry are typically constructed of rigid polymer bottles that can be integrated directly to a passive half of a split butterfly valve. These devices allow filling and/or discharging of potent substances in a contained manner when mated to the active half of a split butterfly valve. The rigid polymer bottles are strong enough to withstand limited pressurization during operation of the valve, during both filling and discharge.

**[0003]** However, such systems present problems with respect to product flow when certain powder substances are used, for example, fine chemicals, toxic and/or hazardous waste, pharmaceutical dry powder compositions, pharmaceutical intermediate processing compounds, laboratory and pilot plant pharmaceutical compounds, as well as pharmaceutical wet-cake material. Additionally, conventional containment charge devices prohibit visual verification that the system has been completely emptied of, or completely filled with, the potent product.

**[0004]** Other conventional transfer devices utilize a film enclosure that integrates to a sanitary fitting. This fitting can also be connected to a passive half of a split butterfly valve and used as above. While the film may be transparent to allow visual verification that the potent substance has been discharged, and the flexibility may allow for manual manipulation of the system to enhance product flow out of the device, such systems may only be used on a small product volume basis due to requirements such as material strength. Additionally, use of the conventional film enclosures is generally limited to non-pressurized environments to avoid the potential rupture of the film, breach of the containment device and the potential for release of the harmful, often toxic, material into the environment.

**[0005]** Despite the advantages of the conventional containment discharging devices, such systems provide no means of grounding to eliminate any static electric charge that can build-up while filling or discharging the substance, thus presenting a hazardous situation in solvent vapor environments.

**[0006]** Therefore, there exists a need in the art for a containment device which is integrated with a sanitary

valve, that can withstand pressurizations during filling and/or discharge, as well as being flexible enough to permit manual manipulation to assist the filling and/or discharge, while simultaneously permitting visual inspection of the contents disposed therein.

### Summary of the Invention

**[0007]** A process for integrating a flexible film based liner into a woven fabric restraint has been developed to transfer potent or toxic substances in a contained manner. The integration of the fabric restraint allows the system to withstand limited pressurization. The restraint not only adds strength to the system while maintaining flexibility but also protects the liner from breach of containment due to puncture. The film liner maybe welded to a polymer sanitary fitting that can be integrated to a passive half of a split butterfly valve. The flexible nature of the device allows the operator to manually massage the potent powder substance to enhance flow characteristics when emptying the device. The restraint can be fabricated of conductive or non-conductive material. If constructed from conductive material this will allow grounding of the device to eliminate static charge build-up while filling or discharging. The transfer device further comprises a window sewn or thermally sealed to the fabric restraint for viewing the load contained in the inner liner.

### Brief Description of the Drawings

#### **[0008]**

Fig. 1 is a representation of the flexible film liner assembly that forms the inner, containment layer of the charging device.

Fig. 1a is a top view of the structure of Fig. 1.

Fig. 2 is a representation of the woven fabric restraint assembled with the film liner. This provides both a pressure retaining capability of the system and protection from damage.

Fig. 2a is a top view of the structure of Fig. 2.

Fig. 3 is a section detail along lines A-A of Fig. 2 illustrating the stitched integration of the film liner to the restraint along with the lifting loop.

### Detailed Description of the Preferred Embodiments

**[0009]** The flexible charging device 1 of the invention utilizes an inner liner 10 of Fig. 1. Typically, inner liner 10 is fabricated from a thin impermeable film of polymer material. The shape of inner liner 10 may be constructed from patterns that are thermally welded or sewn to form a sealed structure together at joints 11 or provided as a single unit, having no welded joints. Inner liner 10 is also,

preferably, thermally welded to a sanitary fitting 12. For example, inner liner 10 may contain one or more sewn seams as described in U.S. Application No. 09/666,845. However, inner liner 10 may be joined to sanitary fitting 12 by any known, or later developed, method, including sewing or joining with an adhesive. This assures a totally sealed fabrication that eliminates crevices where toxic substance can get trapped. Although Fig. 1 depicts inner liner 10 as having a specific shape, it is understood that, preferably, inner liner 10 is a flexible material, conforming generally to the shape of its contents and/or the container.

**[0010]** Sanitary fitting 12 may be any structure capable for forming a substantially sealed joint with a filling device (not shown) such as an active or passive half split of a butterfly valve, and is preferably formed from a thermoplastic, such as a polyolefin. In one embodiment, sanitary fitting 12 is provided with sealing means, such as O-rings or locking members, to form an airtight seal with the filling device. Optionally, sanitary fitting 12 includes means for sealing to prevent the escape of any material contained in flexible charging device 1, i.e., the load.

**[0011]** Although a wide variety of materials are suitable for inner liner 10, typically, inner liner 10 is constructed of a thermoplastic film, such as a polyolefin. In addition, inner liner 10 may also include one or more barrier layers. Such barrier layers can prevent chemical fluid or vapor introduction/escape, light inhibition, or other barrier layers to prevent contact of the contents of the liner with the environment.

**[0012]** In one embodiment, inner liner 10 may be any thin flexible material, e.g., a woven or non-woven fabric, coated with at least one polymer layer, and optionally, a chemical barrier layer. When inner liner 10 is such a structure, the thin flexible material need not be impervious to the material disposed within flexible charging device 1, as the polymer layer should perform such a function. If the thin flexible material, coated with a polymer, provides the structure necessary to maintain the integrity of inner liner 10, the thickness of the polyolefin layer may be reduced. Typically, the polymer layer of inner liner 10 is a thermoplastic material, such as a polyolefin, for example, polyethylene, polypropylene or polybutylene.

**[0013]** As shown in Figs. 2 and 3, inner liner 10 is integrated to an outer fabric restraint 13. In one embodiment, fabric restraint 13 is provided with window 18, integrated into the side. A user may use window 18 to verify that all the contained substance has been emptied from the device during discharge. Window 18 is typically sewn over an opening in fabric restraint 13, using a thread, or may simply be thermally sealed to fabric restraint 13. Although inner liner 10 is a flexible material, which, in most situations will conform to the shape provided by the contents thereof, window 18 may include a second element providing observation through inner liner 10 as well. Accordingly, window 18 may include a seam, joining an aperture through both fabric restraint 13 and inner liner 10.

**[0014]** Similar to inner liner 10, fabric restraint 13 is preferably a polymeric material, such as a homopolymer or copolymer or blends of plastic material, such as a thermoplastic material, typically a polyolefin. The polyolefin may be an optionally substituted linear or branched material, for example, polyethylene, polypropylene or polybutylene. Although fabric restraint 13 may be formed from the same material as inner liner 10, typically, fabric restraint 13 is a woven polypropylene fabric.

**[0015]** In one embodiment, fabric restraint 13 is conductive. This may be accomplished by incorporating a small amount of metallic or conductive material, such as a powder, flakes or fibers, into the structure of fabric restraint 13, or optionally, by providing fabric restraint 13 with a plurality of conductive elements, such as wires, spokes or threads. Additionally, it is considered within the scope of the invention to incorporate other conductive material, other than metal, in the structure of fabric material 13, for example, carbon black or graphite particles. In order to form a path to ground, flexible charging device 1 may be provided, for example, with a grounding loop 19, sewn into fabric restraint 13. By forming fabric restraint 13 from a conductive material, any charge developed inside fabric restraint 13 may easily be discharged. If the fabric restraint 19 is not provided with conductive material, material disposed inside flexible charging device 1 may ignite or cause other dangerous situations, such as explosions.

**[0016]** Fig. 3 shows a cross-section of the top of flexible charging device 1 (when in a discharge position) along the line indicated at A-A in Fig. 2. Inner liner 10 is placed inside fabric restraint 13 and mechanically attached by a stitching 15 through both a hem 14 on fabric restraint 13 and, for example, a welded seam 16 at the top of inner liner 10. Integration of inner liner 10 to fabric restraint 13 will assure that the liner remains in place and prevent the liner from collapsing and hampering product discharge. In order to reduce any risk of breaching containment, it is preferable to provide stitching 15 only where necessary, i.e., at weld seam 16 and/or window 18.

**[0017]** A lifting loop 17 is also optionally provided. Lifting loop 17 may be captured in stitching 15 at the top of the device, or attached in any other manner to flexible charging device 1. For example, lifting loop may be welded to the side of fabric restraint 13 or joined to sanitary fitting 12. This gives the user a means of suspending the device during unloading.

**[0018]** It is additionally considered within the scope of the invention to integrate grounding loop 19 with lifting loop 17, or to provide lifting loop 17 with a hinge, such that it may also be used to maintain flexible charging device 1 to permit suspension during filling and discharging. Alternatively, flexible charging device 1 may be provided with a second lifting loop 17 for such a purpose.

**[0019]** As described herein, flexible charging device 1 may be used to contain any variety of materials, such as powders, flakes, emulsions and liquids, and need not be limited to containing harmful or toxic materials. However,

flexible charging device is particularly designed to contain and/or transport materials such as fine chemicals, toxic and/or hazardous waste, pharmaceutical compositions in dry or powder form, intermediate materials for pharmaceutical processing, and laboratory and pilot plant compounds, as well as pharmaceutical wet-cake material.

**[0020]** Although we have described the invention in connection with exemplary embodiments, the invention is not so limited and modifications thereof may be made by those skilled in the art without departing from the scope of the invention.

## Claims

1. A flexible material transfer device for transferring a load contained therein, comprising:
  - a flexible inner liner (10), having a closed end and an open end;
  - a sanitary fitting (12) affixed to the open end of said flexible inner liner (10);

wherein said transfer device comprises also an outer fabric restraint (13) surrounding and integrated to said inner liner (10), **characterized in that** it further comprises a window (18) sewn or thermally sealed to the outer fabric restraint (13) for viewing the load contained in the flexible inner liner (10).
2. The flexible material transfer device of any of the preceding claims, **characterized in that** said inner liner (10) is formed from a plurality of patterns, thermally welded or sewn together.
3. The flexible material transfer device of any of the preceding claims, **characterized in that** said sanitary fitting (12) comprises a sealing element for forming an airtight seal with a filling device used to deliver material to be transferred, such that the material is substantially prevented from escaping.
4. The flexible material transfer device of claim 3, **characterized in that** the sealing element comprises at least one selected from the group consisting of an O-ring and a locking member.
5. The flexible material transfer device of any of the preceding claims, **characterized in that** said inner liner (10) is formed from a polymeric material.
6. The flexible material transfer device of any of the preceding claims, **characterized in that** said inner liner (10) is formed from a thermoplastic film.
7. The flexible material transfer device of any of the preceding claims, **characterized in that** said inner liner (10) is formed from a polyolefin.
8. The flexible material transfer device of any of the preceding claims, **characterized in that** said inner liner (10) is formed from a material selected from the group consisting of polyethylene, polypropylene, polybutylene, and the like.
9. The flexible material transfer device of any of the preceding claims, **characterized in that** said inner liner (10) comprises at least one barrier layer to protect the contact of the load with the environment.
10. The flexible material transfer device of claim 9, **characterized in that** said at least one barrier layer is impervious to the load.
11. The flexible material transfer device of any of the preceding claims, **characterized in that** said inner liner (10) is impervious to the load.
12. The flexible material transfer device of any of the preceding claims, **characterized in that** said outer restraint (13) is formed from a flexible fabric.
13. The flexible material transfer device of claim 1, **characterized in that** said window (18) is sewn over an opening in the outer restraint (13).
14. The flexible material transfer device of claim 12, **characterized in that** the flexible fabric is formed from a thermoplastic material.
15. The flexible material transfer device of claim 12, **characterized in that** the flexible fabric is formed from a material selected from the group consisting of linear and branched polyethylene, polypropylene, and polybutylene.
16. The flexible material transfer device of claim 12, **characterized in that** the flexible fabric is conductive.
17. The flexible material transfer device of claim 12, **characterized in that** the flexible fabric comprises at least one conductive material selected from the group consisting of powder, flakes, fibers, wires, spokes, and non-metallic materials and threads.
18. The flexible material transfer device of claim 17, **characterized in that** the non-metallic material is selected from the group consisting of carbon black and graphite particles.
19. The flexible material transfer device of any of the preceding claims, **characterized in that** it further comprises a grounding loop (19).

20. The flexible material transfer device of claim 19, **characterized in that** said grounding loop (19) is attached to the flexible fabric.
21. The flexible material transfer device of any of the preceding claims, **characterized in that** it further comprises a lifting loop (17) attached to the outer restraint (13).
22. The flexible material transfer device of claims 19 and 21, **characterized in that** said lifting loop (17) is integrated with the grounding loop (19).
23. A method of transferring a load comprising:
- providing a material transfer device, the transfer device comprising a flexible inner liner (10), having a closed end and an open end; a sanitary fitting (12) affixed to the open end of said flexible inner liner (10);
- providing an outer fabric restraint (13) surrounding and integrated to said inner liner (10) and a window (18) sewn or thermally sealed to the outer fabric restraint (13) for viewing the load contained in the flexible inner liner (10); and
- filling the transfer device with the load.

#### Patentansprüche

1. Eine flexible Material-Transfervorrichtung für das Transferieren einer darin enthaltenen Beladung, die umfasst:
- eine flexible innere Auskleidung (10), die ein geschlossenes Ende und ein offenes Ende hat;
  - eine Sanitärarmatur (12), die an das offene Ende der flexiblen inneren Auskleidung (10) angebracht ist;
- wobei die Transfervorrichtung ebenfalls eine äußere Gewebehalteeinrichtung (13) umfasst, die die innere Auskleidung (10) umgibt und darin integriert ist, **dadurch gekennzeichnet, dass** sie weiter ein Fenster (18) umfasst, das an die äußere Gewebehalteeinrichtung (13) zur Ansicht der in der flexiblen inneren Auskleidung (10) enthaltenen Beladung angehängt oder thermisch daran versiegelt ist.
2. Die flexible Material-Transfervorrichtung nach einem der vorhergehenden Ansprüche, **dadurch gekennzeichnet, dass** die innere Auskleidung (10) aus einer Vielzahl von Mustern gebildet wird, die thermisch zusammengeschweißt oder zusammengehängt sind.
3. Die flexible Material-Transfervorrichtung nach einem der vorhergehenden Ansprüche, **dadurch gekennzeichnet, dass** die Sanitärarmatur (12) ein Dichtungselement für die Bildung einer luftdichten Dichtung mit einer Füllvorrichtung, die verwendet wird, um das Material, das transferiert werden soll, abzugeben, umfasst, so dass das Material im wesentlichen daran gehindert wird, auszutreten.
4. Die flexible Material-Transfervorrichtung nach Anspruch 3, **dadurch gekennzeichnet, dass** das Dichtungselement mindestens eines umfasst, das aus der Gruppe, die aus einem O-Ring und einem Verriegelungselement besteht, ausgewählt wird.
5. Die flexible Material-Transfervorrichtung nach einem der vorhergehenden Ansprüche, **dadurch gekennzeichnet, dass** die innere Auskleidung (10) aus einem Polymermaterial gebildet wird.
6. Die flexible Material-Transfervorrichtung nach einem der vorhergehenden Ansprüche, **dadurch gekennzeichnet, dass** die innere Auskleidung (10) aus einem thermoplastischen Film gebildet wird.
7. Die flexible Material-Transfervorrichtung nach einem der vorhergehenden Ansprüche, **dadurch gekennzeichnet, dass** die innere Auskleidung (10) aus einem Polyolefin gebildet wird.
8. Die flexible Material-Transfervorrichtung nach einem der vorhergehenden Ansprüche, **dadurch gekennzeichnet, dass** die innere Auskleidung (10) aus einem Material gebildet wird, das aus der Gruppe, die aus Polyethylen, Polypropylen, Polybutylen und ähnlichem besteht, ausgewählt wird.
9. Die flexible Material-Transfervorrichtung nach einem der vorhergehenden Ansprüche, **dadurch gekennzeichnet, dass** die innere Auskleidung (10) mindestens eine Grenzschicht umfasst, um vor dem Kontakt der Beladung mit der Umgebung zu schützen.
10. Die flexible Material-Transfervorrichtung nach Anspruch 9, **dadurch gekennzeichnet, dass** die mindestens eine Grenzschicht gegenüber der Beladung undurchlässig ist.
11. Die flexible Material-Transfervorrichtung nach einem der vorhergehenden Ansprüche, **dadurch gekennzeichnet, dass** die innere Auskleidung (10) gegenüber der Beladung undurchlässig ist.
12. Die flexible Material-Transfervorrichtung nach einem der vorhergehenden Ansprüche, **dadurch gekennzeichnet, dass** die äußere Halteeinrichtung (13) aus einem flexiblen Gewebe gebildet wird.
13. Die flexible Material-Transfervorrichtung nach An-

- spruch 1, **dadurch gekennzeichnet, dass** das Fenster (18) über eine Öffnungen in der äußeren Halteinrichtung (13) genäht ist.
14. Die flexible Material-Transfervorrichtung nach Anspruch 12, **dadurch gekennzeichnet, dass** das flexible Gewebe aus einem thermoplastischen Material gebildet wird.
15. Die flexible Material-Transfervorrichtung nach Anspruch 12, **dadurch gekennzeichnet, dass** das flexible Gewebe aus einem Material gebildet wird, das aus der Gruppe, die aus linearem und verzweigtem Polyethylen, Polypropylen und Polybutylen besteht, ausgewählt wird.
16. Die flexible Material-Transfervorrichtung nach Anspruch 12, **dadurch gekennzeichnet, dass** das flexible Gewebe leitfähig ist.
17. Die flexible Material-Transfervorrichtung nach Anspruch 12, **dadurch gekennzeichnet, dass** das flexible Gewebe mindestens ein leitfähiges Material umfasst, das aus der Gruppe, die aus Pulver, Flokken, Fasern, Drähten, Speichen und nicht-metallischen Materialien und Garnen besteht, ausgewählt wird.
18. Die flexible Material-Transfervorrichtung nach Anspruch 17, **dadurch gekennzeichnet, dass** das nicht-metallische Material aus der Gruppe, die aus Ruß- und Graphitteilchen besteht, ausgewählt wird.
19. Die flexible Material-Transfervorrichtung nach einem der vorhergehenden Ansprüche, **dadurch gekennzeichnet, dass** sie weiter eine Erd-Schleife (19) umfasst.
20. Die flexible Material-Transfervorrichtung nach Anspruch 19, **dadurch gekennzeichnet, dass** die Erd-Schleife (19) an das flexiblen Gewebe angebracht wird.
21. Die flexible Material-Transfervorrichtung nach einem der vorhergehenden Ansprüche, **dadurch gekennzeichnet, dass** sie weiter eine Hebe-Schleife (17) umfasst, die an die äußere Halteinrichtung (13) angebracht ist.
22. Die flexible Material-Transfervorrichtung nach Anspruch 19 und 21, **dadurch gekennzeichnet, dass** die Hebe-Schleife (17) in die Erd-Schleife integriert ist.
23. Ein Verfahren zum Transferieren einer Beladung, das umfasst:

- Bereitstellen einer Material-Transfervorrich-

tung,

wobei die Transfervorrichtung eine flexible innere Auskleidung (10), die ein geschlossenes Ende und ein offenes Ende hat; eine Sanitärarmatur (12), die an das offene Ende der flexiblen inneren Auskleidung (10) angebracht ist, umfasst;

- Bereitstellen einer äußeren Gewebehalteeinrichtung (13), die die innere Auskleidung (10) umgibt und darin integriert ist, und eines Fensters (18), das an die äußere Gewebehalteeinrichtung (13) zur Ansicht der in der flexiblen inneren Auskleidung (10) enthaltenen Beladung angenäht oder thermisch daran versiegelt ist; und

- Füllen der Transfervorrichtung mit der Beladung.

## Revendications

1. Dispositif de transfert de matériau souple pour transférer une charge contenue dans celui-ci, comprenant :

une doublure interne (10) souple, ayant une extrémité fermée et une extrémité ouverte ;  
un raccord sanitaire (12) fixé à l'extrémité ouverte de ladite doublure interne (10) souple ;

dans lequel ledit dispositif de transfert comprend également :

un élément de retenue externe (13) en tissu entourant ladite doublure interne (10) et intégré à celle-ci,

**caractérisé en ce qu'il** comprend en outre une fenêtre (18) cousue ou scellée thermiquement sur l'élément de retenue externe (13) en tissu pour observer la charge contenue dans la doublure interne (10) souple.

2. Dispositif de transfert de matériau souple selon l'une quelconque des revendications précédentes, **caractérisé en ce que** ladite doublure interne (10) est formée à partir d'une pluralité de motifs, soudés thermiquement ou cousus les uns avec les autres.

3. Dispositif de transfert de matériau souple selon l'une quelconque des revendications précédentes, **caractérisé en ce que** ledit raccord sanitaire (12) comprend un élément d'étanchéité pour former un joint étanche à l'air avec un dispositif de remplissage utilisé pour délivrer un matériau à transférer, de sorte que le matériau ne puisse pas sensiblement s'échapper.

4. Dispositif de transfert de matériau souple selon la revendication 3, **caractérisé en ce que** l'élément d'étanchéité comprend au moins l'un sélectionné dans le groupe consistant en un joint torique et un élément de blocage.
5. Dispositif de transfert de matériau souple selon l'une quelconque des revendications précédentes, **caractérisé en ce que** ladite doublure interne (10) est formée à partir d'un matériau polymérique.
6. Dispositif de transfert de matériau souple selon l'une quelconque des revendications précédentes, **caractérisé en ce que** ladite doublure interne (10) est formée à partir d'un film thermoplastique.
7. Dispositif de transfert de matériau souple selon l'une quelconque des revendications précédentes, **caractérisé en ce que** ladite doublure interne (10) est formée à partir d'une polyoléfine.
8. Dispositif de transfert de matériau souple selon l'une quelconque des revendications précédentes, **caractérisé en ce que** ladite doublure interne (10) est formée à partir d'un matériau sélectionné dans le groupe consistant en du polyéthylène, du polypropylène, du polybutylène, et similaire.
9. Dispositif de transfert de matériau souple selon l'une quelconque des revendications précédentes, **caractérisé en ce que** ladite doublure interne (10) comprend au moins une couche de barrière pour empêcher le contact de la charge avec l'environnement.
10. Dispositif de transfert de matériau souple selon la revendication 9, **caractérisé en ce que** ladite au moins une couche de barrière est imperméable à la charge.
11. Dispositif de transfert de matériau souple selon l'une quelconque des revendications précédentes, **caractérisé en ce que** ladite doublure interne (10) est imperméable à la charge.
12. Dispositif de transfert de matériau souple selon l'une quelconque des revendications précédentes, **caractérisé en ce que** ledit élément de retenue externe (13) est formé à partir d'un tissu souple.
13. Dispositif de transfert de matériau souple selon la revendication 1, **caractérisé en ce que** ladite fenêtre (18) est cousue sur une ouverture dans l'élément de retenue externe (13).
14. Dispositif de transfert de matériau souple selon la revendication 12, **caractérisé en ce que** le tissu souple est formé à partir d'un matériau thermoplastique.
15. Dispositif de transfert de matériau souple selon la revendication 12, **caractérisé en ce que** le tissu souple est formé à partir d'un matériau sélectionné dans le groupe consistant en du polyéthylène, du polypropylène et du polybutylène linéaire et à branches.
16. Dispositif de transfert de matériau souple selon la revendication 12, **caractérisé en ce que** le tissu souple est conducteur.
17. Dispositif de transfert de matériau souple selon la revendication 12, **caractérisé en ce que** le tissu souple comprend au moins un matériau conducteur sélectionné dans le groupe consistant en une poudre, des flocons, des fibres, des fils, des bâtons, et des matériaux et des fils non métalliques.
18. Dispositif de transfert de matériau souple selon la revendication 17, **caractérisé en ce que** le matériau non métallique est sélectionné dans le groupe consistant en du noir de carbone et des particules de graphite.
19. Dispositif de transfert de matériau souple selon l'une quelconque des revendications précédentes, **caractérisé en ce qu'**il comprend en outre une boucle de mise à la masse (19).
20. Dispositif de transfert de matériau souple selon la revendication 19, **caractérisé en ce que** ladite boucle de mise à la masse (19) est fixée au tissu souple.
21. Dispositif de transfert de matériau souple selon l'une quelconque des revendications précédentes, **caractérisé en ce qu'**il comprend en outre une boucle de levage (17) fixée à l'élément de retenue externe (13).
22. Dispositif de transfert de matériau souple selon les revendications 19 et 21, **caractérisé en ce que** ladite boucle de levage (17) est intégrée à la boucle de mise à la masse (19).
23. Procédé de transfert de charge consistant à :
- prévoir un dispositif de transfert de matériau, le dispositif de transfert comprenant une doublure interne (10) souple, comportant une extrémité fermée et une extrémité ouverte ; un raccord sanitaire (12) fixé à l'extrémité ouverte de ladite doublure interne (10) souple ; prévoir un élément de retenue externe (13) en tissu entourant et intégré à ladite doublure interne (10) et une fenêtre (18) cousue ou scellée thermiquement à l'élément de retenue externe (13) en tissu pour l'observation de la charge contenue dans la doublure interne (10) souple ; et remplir le dispositif de transfert avec la charge.

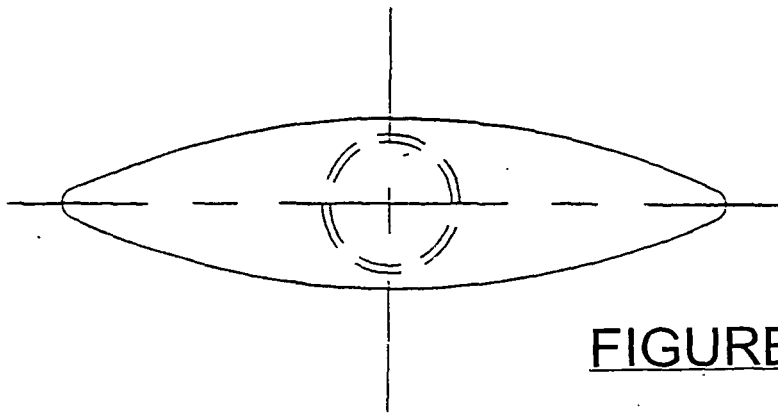

FIGURE 1a

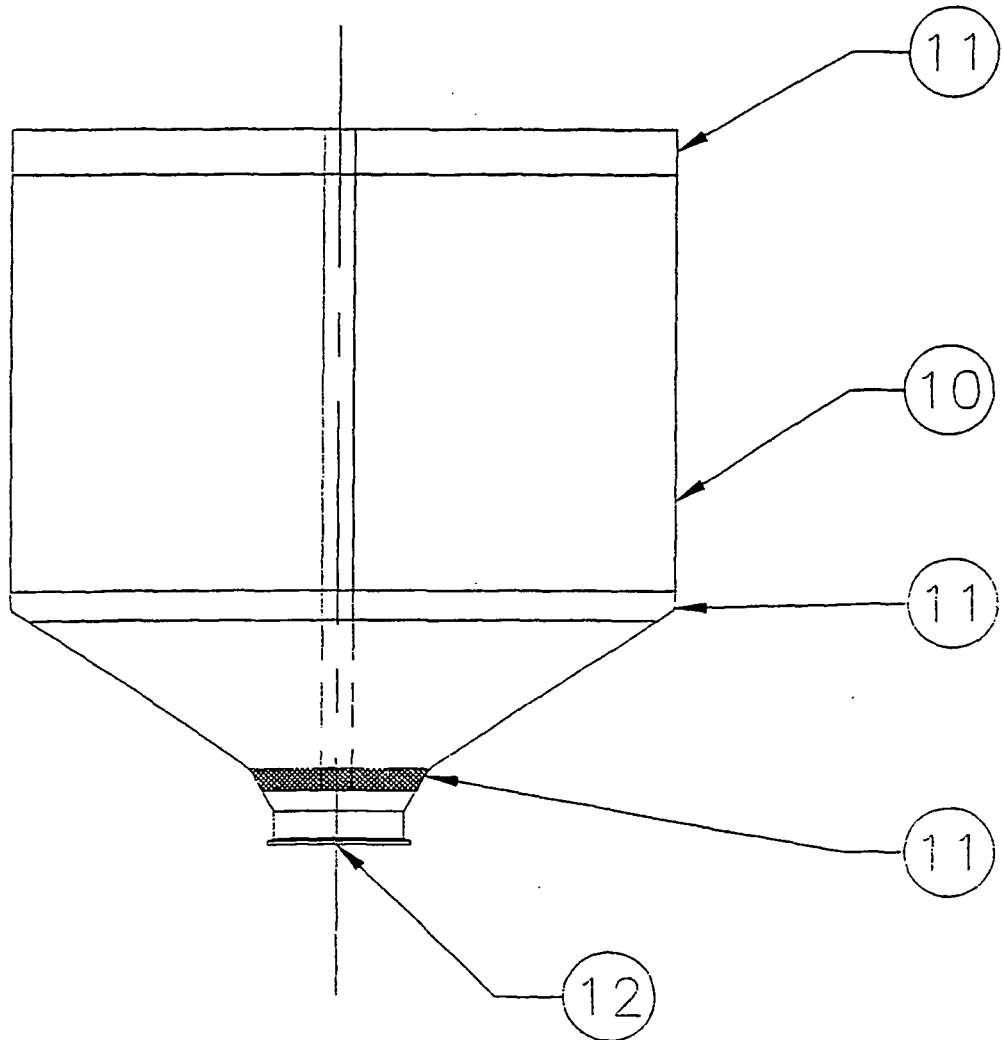
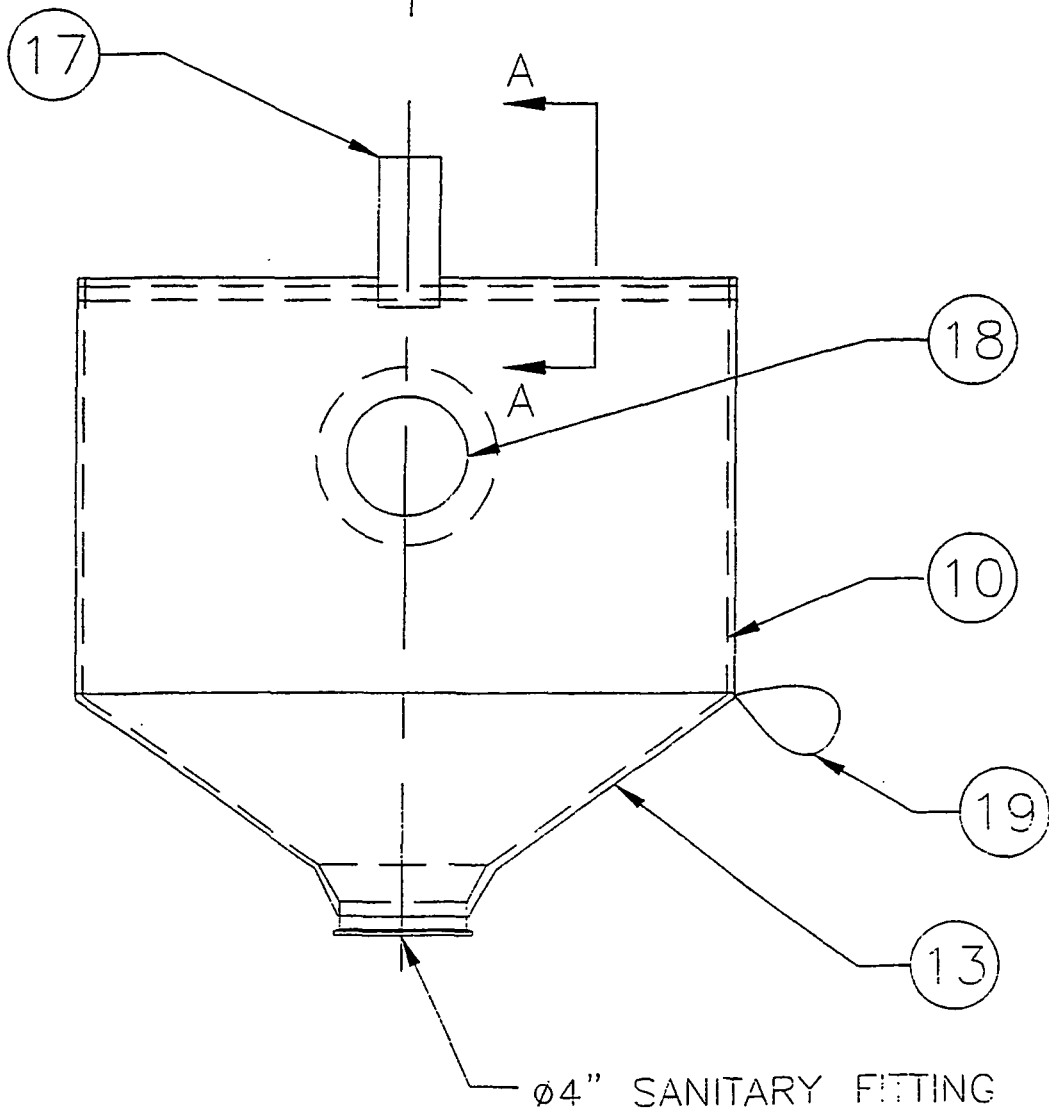
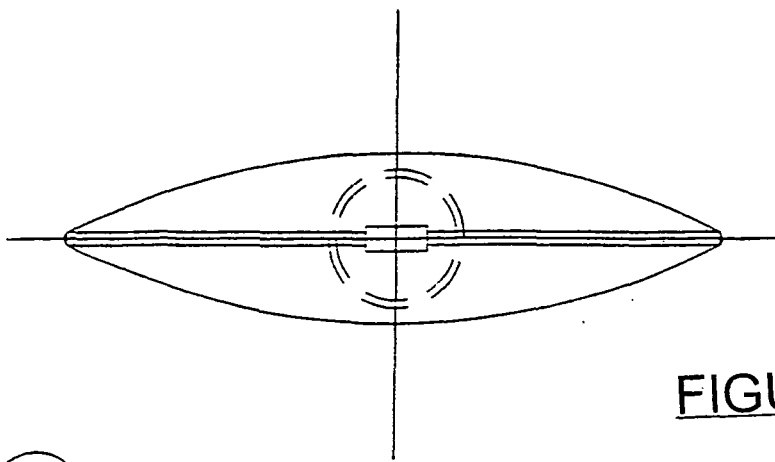
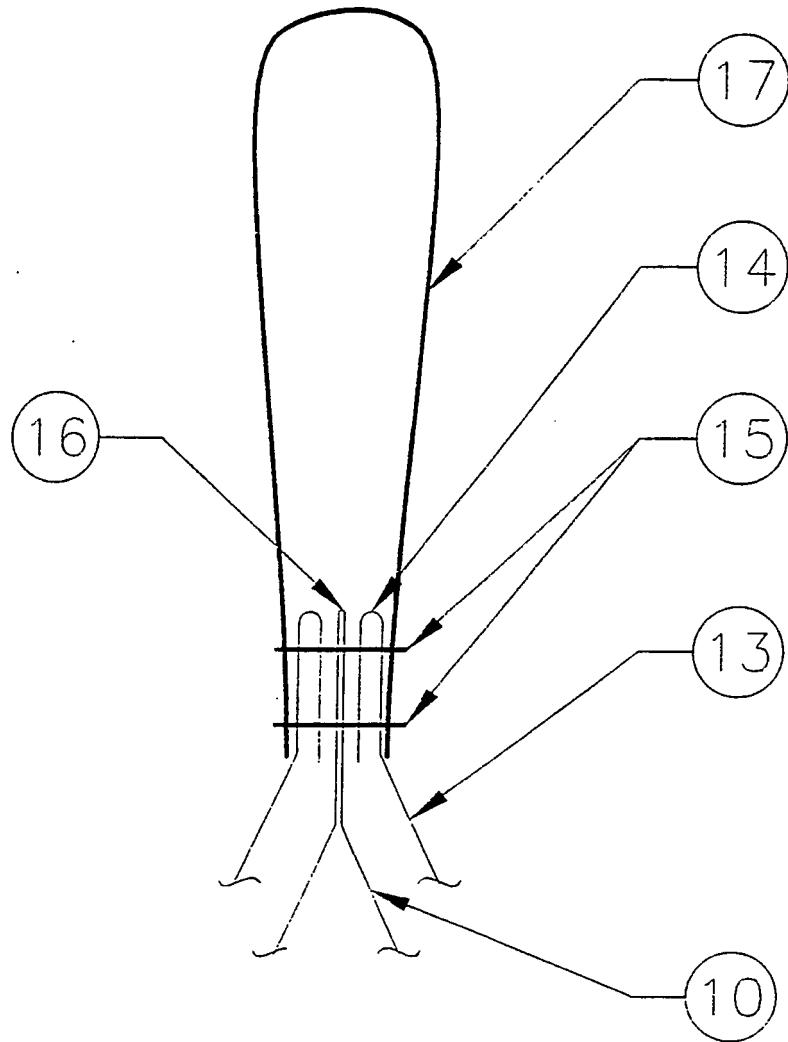

FIGURE 1





SECTION A-A

FIGURE 3

**REFERENCES CITED IN THE DESCRIPTION**

*This list of references cited by the applicant is for the reader's convenience only. It does not form part of the European patent document. Even though great care has been taken in compiling the references, errors or omissions cannot be excluded and the EPO disclaims all liability in this regard.*

**Patent documents cited in the description**

- GB 2354754 A [0001]
- US 666845 A [0009]