



Europäisches Patentamt
European Patent Office
Office européen des brevets



(11) **EP 1 512 928 A3**

(12) **EUROPEAN PATENT APPLICATION**

(88) Date of publication A3:
07.06.2006 Bulletin 2006/23

(51) Int Cl.:
F25D 25/02 (2006.01)

(43) Date of publication A2:
09.03.2005 Bulletin 2005/10

(21) Application number: **04104092.4**

(22) Date of filing: **26.08.2004**

(84) Designated Contracting States:
**AT BE BG CH CY CZ DE DK EE ES FI FR GB GR
HU IE IT LI LU MC NL PL PT RO SE SI SK TR**
Designated Extension States:
AL HR LT LV MK

(72) Inventor: **Sessa, Luigi**
Whirlpool Europe s.r.l.
21025, Comerio (IT)

(30) Priority: **08.09.2003 IT MI20030401**

(74) Representative: **Guerci, Alessandro**
Whirlpool Europe S.r.l.
Patent Department
Viale G. Borghi 27
21025 Comerio (VA) (IT)

(71) Applicant: **WHIRLPOOL CORPORATION**
Benton Harbor
Michigan 49022 (US)

(54) **Device for adjusting the shelf height within a refrigerator preservation compartment**

(57) A device for adjusting the height of shelves (12, 13) within a refrigerator preservation compartment (1), this latter comprising side walls (4) and an end wall (5), on said side walls (4) there being provided supports for supporting end projecting parts (11) of the shelves on which food to be preserved is placed, and enabling said

shelves (12, 13) to be positioned at different heights within said compartment (1). The supports are defined by pairs of support elements (10) having an elongate body (15) presenting a plurality of recesses (25) opening into a side (21) of said body (15), said recesses (25) being arranged to contain the end projecting parts (11) of the shelves (12, 13).

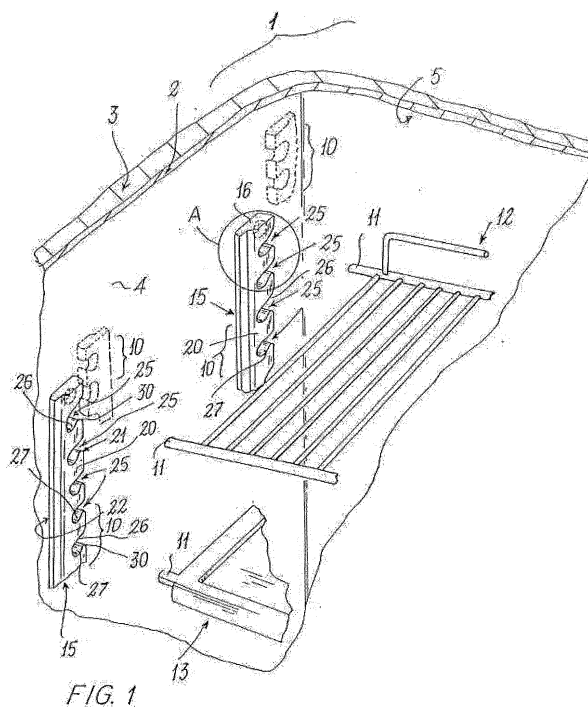

EP 1 512 928 A3



European Patent
Office

EUROPEAN SEARCH REPORT

Application Number
EP 04 10 4092

DOCUMENTS CONSIDERED TO BE RELEVANT			
Category	Citation of document with indication, where appropriate, of relevant passages	Relevant to claim	CLASSIFICATION OF THE APPLICATION (IPC)
X	EP 1 030 142 A (BSH BOSCH SIEMENS HAUSGERAETE) 23 August 2000 (2000-08-23)	1,5,6,9,11	INV. F25D25/02
Y	* paragraph [0032]; figures 1-3 *	8	
Y	US 2 604 375 A (BECKETT LEO G) 22 July 1952 (1952-07-22) * column 3, line 44 - column 4, line 50; figures 1,3,4 *	8	
X	DE 35 44 446 C (BOSCH SIEMENS HAUSGERAETE) 8 January 1987 (1987-01-08) * column 3, line 14 - column 4, line 57; figures 1,2 *	1-4,6,7,11	
X	US 2 265 542 A (NORBERG OSCAR E ET AL) 9 December 1941 (1941-12-09) * the whole document *	1,5,6,11	
X	US 2 291 547 A (WHITNEY GIFFARD) 28 July 1942 (1942-07-28) * the whole document *	1,5,6,11	
A	US 3 162 416 A (LORENZO AMARILLAS) 22 December 1964 (1964-12-22)		TECHNICAL FIELDS SEARCHED (IPC)
A	US 552 579 A (H.J.HOFFMANN) 7 January 1896 (1896-01-07)		F25D A47B
The present search report has been drawn up for all claims			
Place of search Munich		Date of completion of the search 18 April 2006	Examiner Jessen, F
<p>CATEGORY OF CITED DOCUMENTS</p> <p>X : particularly relevant if taken alone Y : particularly relevant if combined with another document of the same category A : technological background O : non-written disclosure P : intermediate document</p> <p>T : theory or principle underlying the invention E : earlier patent document, but published on, or after the filing date D : document cited in the application L : document cited for other reasons & : member of the same patent family, corresponding document</p>			

1
EPO FORM 1503 03.82 (P04C01)

**ANNEX TO THE EUROPEAN SEARCH REPORT
ON EUROPEAN PATENT APPLICATION NO.**

EP 04 10 4092

This annex lists the patent family members relating to the patent documents cited in the above-mentioned European search report. The members are as contained in the European Patent Office EDP file on
The European Patent Office is in no way liable for these particulars which are merely given for the purpose of information.

18-04-2006

Patent document cited in search report		Publication date	Patent family member(s)	Publication date
EP 1030142	A	23-08-2000	DE 19907093 A1	24-08-2000
US 2604375	A	22-07-1952	NONE	
DE 3544446	C	08-01-1987	NONE	
US 2265542	A	09-12-1941	NONE	
US 2291547	A	28-07-1942	NONE	
US 3162416	A	22-12-1964	NONE	
US 552579	A		NONE	