



(12) **EUROPEAN PATENT APPLICATION**

(88) Date of publication A3:  
**03.05.2006 Bulletin 2006/18**

(51) Int Cl.:  
**A47L 11/00** <sup>(2006.01)</sup> **A47L 11/24** <sup>(2006.01)</sup>  
**A47L 11/33** <sup>(2006.01)</sup>

(43) Date of publication A2:  
**15.06.2005 Bulletin 2005/24**

(21) Application number: **04257527.4**

(22) Date of filing: **03.12.2004**

(84) Designated Contracting States:  
**AT BE BG CH CY CZ DE DK EE ES FI FR GB GR  
HU IE IS IT LI LT LU MC NL PL PT RO SE SI SK TR**  
Designated Extension States:  
**AL BA HR LV MK YU**

(30) Priority: **09.12.2003 GB 0328561**  
**10.11.2004 GB 0424759**

(71) Applicant: **Grey Technology Limited**  
**Whittington,**  
**Worcester WR5 2RQ (GB)**

(72) Inventor: **Grey, Nicholas Gerald**  
**Crowle, Worcestershire WR7 4BH (GB)**

(74) Representative: **Jackson, Derek Charles**  
**Derek Jackson Associates**  
**The Old Yard**  
**Lower Town**  
**Claines**  
**Worcester WR3 7RY (GB)**

(54) **Motorised surface cleaning apparatus**

(57) A surface cleaning apparatus comprising a cleaning body (1) and collection means (29) for accumulating debris retrieved from a surface to be cleaned. The collection means (29) is provided solely at a first end portion of the cleaning body (1) of the surface cleaning apparatus. A handle means (49) is connected by pivot means (54) to a second end portion (51) of the cleaning body (1) of the surface cleaning apparatus opposite the first end portion. The pivot means (54) is arranged to permit the first end portion of the cleaning body (1) to pivot relative to the handle means (49) from a first orientation to a second, depending orientation. A rotatable elongate brush arrangement (17) is provided between the collection means (29) and the second end portion (51) and is adapted to retrieve the debris from the surface to be cleaned and to direct the debris into the collection means (29). A motor (5) is provided between the brush arrangement (17) and the second end portion (51) of the cleaning body (1) and is arranged to rotate the brush arrangement (17).

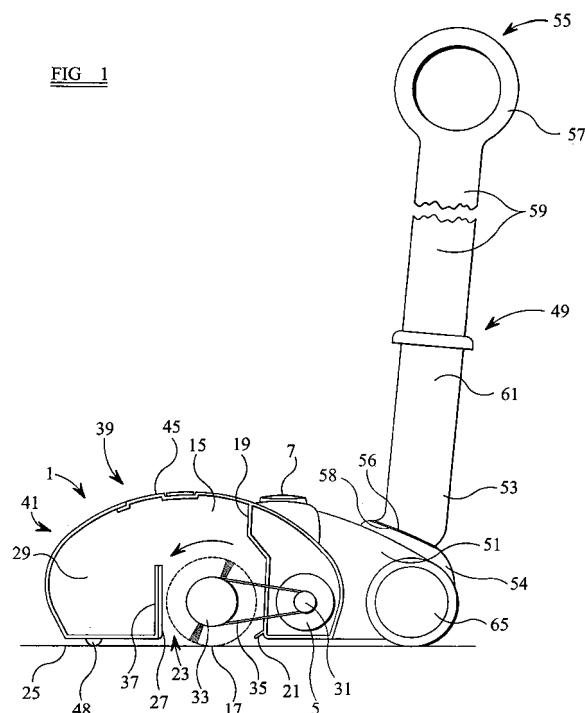



European Patent  
Office

# EUROPEAN SEARCH REPORT

Application Number  
EP 04 25 7527

DOCUMENTS CONSIDERED TO BE RELEVANT			
Category	Citation of document with indication, where appropriate, of relevant passages	Relevant to claim	CLASSIFICATION OF THE APPLICATION (IPC)
Y	GB 1 442 587 A (MOULINEX SA) 14 July 1976 (1976-07-14)  * page 1, lines 31-46 * * page 2, lines 50-57; figures 1-4 * -----	1-5, 10-13, 16-19, 21-23	A47L11/00 A47L11/24 A47L11/33
Y	CA 2 460 997 A1 (GREY, NICHOLAS, GERALD) 30 January 2003 (2003-01-30) * page 4, paragraphs 1-3,7 * * page 6, lines 14,15 * * page 8, paragraph 2; figures 1-3 * -----	1,7-9, 14-16,20	
Y	US 2002/062530 A1 (FISCHER FRANZ ET AL) 30 May 2002 (2002-05-30) * paragraphs [0005], [0024], [0026]; figure 2 * -----	1-5,7-23	
A	US 1 920 624 A (BILDE TORD ERIK DANIEL) 1 August 1933 (1933-08-01) * page 1, lines 109-111; figure 6 * -----	6	TECHNICAL FIELDS SEARCHED (IPC)
A	US 6 421 875 B1 (COOMBS RICHARD L ET AL) 23 July 2002 (2002-07-23) * column 2, lines 28-33; figures 1-3 * -----	24	A47L
A	EP 1 203 556 A (KAO CORPORATION) 8 May 2002 (2002-05-08) -----		
A	US 2 235 432 A (KENYON RICHARD WALTON) 18 March 1941 (1941-03-18) -----		
A	US 4 099 284 A (SHINOZAKI ET AL) 11 July 1978 (1978-07-11) -----		
The present search report has been drawn up for all claims			
Place of search <b>Munich</b>		Date of completion of the search <b>10 March 2006</b>	Examiner <b>Papadimitriou, S</b>
CATEGORY OF CITED DOCUMENTS X : particularly relevant if taken alone Y : particularly relevant if combined with another document of the same category A : technological background O : non-written disclosure P : intermediate document T : theory or principle underlying the invention E : earlier patent document, but published on, or after the filing date D : document cited in the application L : document cited for other reasons & : member of the same patent family, corresponding document			

1  
EPO FORM 1503 03.02 (P04C01)

**ANNEX TO THE EUROPEAN SEARCH REPORT  
ON EUROPEAN PATENT APPLICATION NO.**

EP 04 25 7527

This annex lists the patent family members relating to the patent documents cited in the above-mentioned European search report.  
The members are as contained in the European Patent Office EDP file on  
The European Patent Office is in no way liable for these particulars which are merely given for the purpose of information.

10-03-2006

Patent document cited in search report		Publication date	Patent family member(s)	Publication date
GB 1442587	A	14-07-1976	BE 825730 A1	16-06-1975
			CH 586033 A5	31-03-1977
			DE 2506956 A1	28-08-1975
			DE 7505004 U	24-04-1980
			ES 434910 A1	01-12-1976
			FR 2261735 A1	19-09-1975
-----				
CA 2460997	A1	30-01-2003	CA 2461002 A1	30-01-2003
			CA 2486199 A1	30-01-2003
-----				
US 2002062530	A1	30-05-2002	AT 262301 T	15-04-2004
			AU 765006 B2	04-09-2003
			AU 6694300 A	05-03-2001
			BR 0012957 A	30-04-2002
			CA 2378422 A1	15-02-2001
			CN 1364063 A	14-08-2002
			DE 29913843 U1	28-10-1999
			WO 0110283 A1	15-02-2001
			EP 1199972 A1	02-05-2002
			ES 2215708 T3	16-10-2004
-----				
US 1920624	A	01-08-1933	GB 340408 A	01-01-1931
-----				
US 6421875	B1	23-07-2002	NONE	
-----				
EP 1203556	A	08-05-2002	CN 1352915 A	12-06-2002
			TW 558430 B	21-10-2003
			US 2002023666 A1	28-02-2002
-----				
US 2235432	A	18-03-1941	GB 504728 A	28-04-1939
-----				
US 4099284	A	11-07-1978	NONE	
-----				