



(12) **EUROPEAN PATENT APPLICATION**

(88) Date of publication A3:
31.01.2007 Bulletin 2007/05

(51) Int Cl.:
E06B 9/58 (2006.01) E06B 9/54 (2006.01)

(43) Date of publication A2:
19.10.2005 Bulletin 2005/42

(21) Application number: **05007773.4**

(22) Date of filing: **08.04.2005**

(84) Designated Contracting States:
AT BE BG CH CY CZ DE DK EE ES FI FR GB GR HU IE IS IT LI LT LU MC NL PL PT RO SE SI SK TR
Designated Extension States:
AL BA HR LV MK YU

• **ETNA ALLUMINIO S.p.A.**
95047 Paterno' (CT) (IT)

(72) Inventor: **Mingrone, Pietro**
40024 Castel S.Pietro Terme (BO) (IT)

(30) Priority: **08.04.2004 IT MO20040079**

(74) Representative: **Luppi, Luigi**
Luppi Crugnola & Partners S.r.l.
Viale Corassori 54
41100 Modena (IT)

(71) Applicants:
• **Medal S.r.l.**
40023 Castel Guelfo di Bologna (BO) (IT)

(54) **Locking means**

(57) Locking means, in particular locking means (1) for mosquito-net uprights (2) comprises base means (4) suitable for interacting between an upright end (7) and a surface (3) of a window or door aperture, cursor means (5) engaging in a groove (17) of said uprights (2) and suitable for regulating a preliminary position (A) of said base means (4), a cam element (6) suitable for regulating a final position (B) of said base means (4), said cursor means (5) being provided inside itself with a coupling seat (15) suitable for receiving said cam element (6).

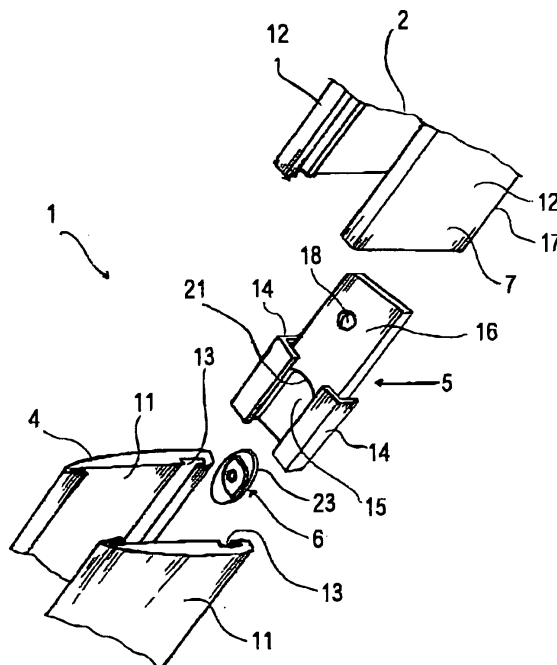

Fig. 1



European Patent
Office

EUROPEAN SEARCH REPORT

Application Number
EP 05 00 7773

DOCUMENTS CONSIDERED TO BE RELEVANT			
Category	Citation of document with indication, where appropriate, of relevant passages	Relevant to claim	CLASSIFICATION OF THE APPLICATION (IPC)
A	FR 2 826 048 A3 (CARUSO BENEDETTO [IT]) 20 December 2002 (2002-12-20) * page 4, line 15 - line 20 * * page 5, line 22 - line 30; figures * -----	1	INV. E06B9/58 E06B9/54
			TECHNICAL FIELDS SEARCHED (IPC)
			E06B
The present search report has been drawn up for all claims			
Place of search Munich		Date of completion of the search 19 December 2006	Examiner Peschel, Gerhard
<p>CATEGORY OF CITED DOCUMENTS</p> <p>X : particularly relevant if taken alone Y : particularly relevant if combined with another document of the same category A : technological background O : non-written disclosure P : intermediate document</p> <p>T : theory or principle underlying the invention E : earlier patent document, but published on, or after the filing date D : document cited in the application L : document cited for other reasons & : member of the same patent family, corresponding document</p>			

2
EPO FORM 1503 03/02 (P04C01)

19-12-2006

Patent document cited in search report	Publication date	Patent family member(s)	Publication date
FR 2826048	A3	20-12-2002	DE 20207428 U1 08-08-2002
			ES 1052071 U1 01-11-2002
			IT B020010387 A1 19-12-2002
			PT 9815 U 31-12-2002

EPO FORM P0459

3