



(12) **EUROPEAN PATENT APPLICATION**

(88) Date of publication A3:
18.01.2006 Bulletin 2006/03

(51) Int Cl.:
A61G 7/012 (2006.01) **A61G 1/06** (2006.01)
B66F 7/08 (2006.01)

(43) Date of publication A2:
23.11.2005 Bulletin 2005/47

(21) Application number: **05005885.8**

(22) Date of filing: **17.03.2005**

(84) Designated Contracting States:
**AT BE BG CH CY CZ DE DK EE ES FI FR GB GR
HU IE IS IT LI LT LU MC NL PL PT RO SE SI SK TR**
Designated Extension States:
AL BA HR LV MK YU

(30) Priority: **21.05.2004 FI 20040211 U**

(71) Applicants:
• **Evac + Chair International Limited**
Birmingham B11 3RS (GB)
• **PENSI RESCUE OY**
38270 Sammaljoki (FI)

(72) Inventors:
• **Williams, Robert Alan**
West Midlands B91 1LX (GB)
• **Pernu, Paavo Henrik**
32730 Keikyä (FI)
• **Vuorenoja, Eero Olavi**
38270 Sammaljoki (FI)

(74) Representative: **Wardley, Diana Mary**
Forrester & Boehmert,
Pettenkoferstr. 20-22
80336 München (DE)

(54) **Vertically adjustable stretcher**

(57) An adjustable support apparatus (1) comprising, first (12) and second (10) support elements, which are, in use, spaced vertically from each other and are moveable relative to each other between a first position, in which they are spaced from each other, and a second position, in which they lie closer to each other, first (14) and second (16) cross members connecting the first (12) and second (10) support elements to each other, at each side of the apparatus (1), said cross members (14, 16) being pivotally connected to each other between their ends with the first cross member (14) being pivotally connected at one end to the second support element (10) and connected at its opposite end to the first support

element (12), and with the second cross member (16) being pivotally connected at one end to the first support element (12) and connected at its opposite end to the second support element (10), and actuating means (21) for effecting movement of the first (12) and second (10) support elements relative to each other, characterised in that the connection of each of the first cross members (14) to the first support element (12) includes a rack gear (34) connected to the first support element (12) and the corresponding end of both of the first cross members (14) supports a respective pinion gear (35) which engages the respective rack gear (34) on the first support element (12), with the pinion gears (35) of both of the first cross members (14) being rotationally fast with each other.

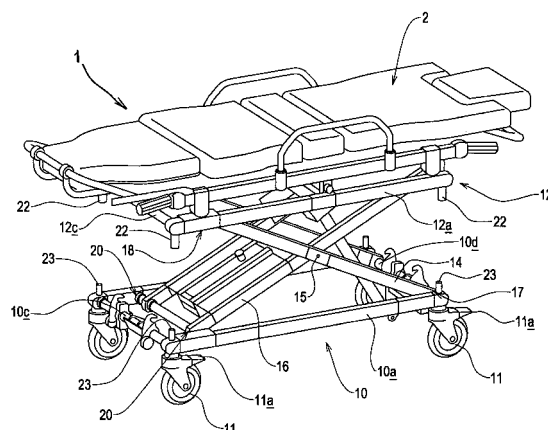

FIG. 1



European Patent
Office

EUROPEAN SEARCH REPORT

Application Number
EP 05 00 5885

DOCUMENTS CONSIDERED TO BE RELEVANT			
Category	Citation of document with indication, where appropriate, of relevant passages	Relevant to claim	CLASSIFICATION OF THE APPLICATION (IPC)
X	DE 43 27 897 A1 (STARFORT DI PAUL STUBENRUSS, BRESSANONE, BOZEN/BOLZANO, IT) 10 March 1994 (1994-03-10) * column 1, line 53 - line 64 * * column 2, line 33 - line 57 * * figure 2 *	1-5	A61G7/012 A61G1/06 B66F7/08
Y	-----	6-9	
Y	WO 94/20405 A (SAMHALL REHAB AB; AHLROT, TOMAS) 15 September 1994 (1994-09-15) * page 3, line 26 - line 30 * * figure 5 * -----	6-9	
			TECHNICAL FIELDS SEARCHED (IPC)
			A61G B22F B66F
The present search report has been drawn up for all claims			
Place of search The Hague		Date of completion of the search 30 August 2005	Examiner Ong, H.D.
CATEGORY OF CITED DOCUMENTS X : particularly relevant if taken alone Y : particularly relevant if combined with another document of the same category A : technological background O : non-written disclosure P : intermediate document T : theory or principle underlying the invention E : earlier patent document, but published on, or after the filing date D : document cited in the application L : document cited for other reasons & : member of the same patent family, corresponding document			

2
EPO FORM 1503 03.82 (P04C01)



European Patent
Office

Application Number

EP 05 00 5885

CLAIMS INCURRING FEES

The present European patent application comprised at the time of filing more than ten claims.

- ☐ Only part of the claims have been paid within the prescribed time limit. The present European search report has been drawn up for the first ten claims and for those claims for which claims fees have been paid, namely claim(s):
- ☐ No claims fees have been paid within the prescribed time limit. The present European search report has been drawn up for the first ten claims.

LACK OF UNITY OF INVENTION

The Search Division considers that the present European patent application does not comply with the requirements of unity of invention and relates to several inventions or groups of inventions, namely:

see sheet B

- ☐ All further search fees have been paid within the fixed time limit. The present European search report has been drawn up for all claims.
- ☐ As all searchable claims could be searched without effort justifying an additional fee, the Search Division did not invite payment of any additional fee.
- ☐ Only part of the further search fees have been paid within the fixed time limit. The present European search report has been drawn up for those parts of the European patent application which relate to the inventions in respect of which search fees have been paid, namely claims:
- ☒ None of the further search fees have been paid within the fixed time limit. The present European search report has been drawn up for those parts of the European patent application which relate to the invention first mentioned in the claims, namely claims:

1-9



European Patent
Office

LACK OF UNITY OF INVENTION
SHEET B

Application Number

EP 05 00 5885

The Search Division considers that the present European patent application does not comply with the requirements of unity of invention and relates to several inventions or groups of inventions, namely:

1. claims: 1-9

An adjustable support apparatus

2. claims: 10-19

A device for inhibiting relative movement

**ANNEX TO THE EUROPEAN SEARCH REPORT
ON EUROPEAN PATENT APPLICATION NO.**

EP 05 00 5885

This annex lists the patent family members relating to the patent documents cited in the above-mentioned European search report.
The members are as contained in the European Patent Office EDP file on
The European Patent Office is in no way liable for these particulars which are merely given for the purpose of information.

30-08-2005

Patent document cited in search report		Publication date		Patent family member(s)	Publication date
DE 4327897	A1	10-03-1994	IT	1260801 B	22-04-1996

WO 9420405	A	15-09-1994	AU	6225494 A	26-09-1994
			SE	501039 C2	24-10-1994
			SE	9300816 A	10-09-1994
