



(11) **EP 1 634 835 A3**

(12) **EUROPEAN PATENT APPLICATION**

(88) Date of publication A3:
14.11.2007 Bulletin 2007/46

(51) Int Cl.:
B65H 29/14 (2006.01)

(43) Date of publication A2:
15.03.2006 Bulletin 2006/11

(21) Application number: **05019703.7**

(22) Date of filing: **09.09.2005**

(84) Designated Contracting States:
**AT BE BG CH CY CZ DE DK EE ES FI FR GB GR
HU IE IS IT LI LT LU LV MC NL PL PT RO SE SI
SK TR**
Designated Extension States:
AL BA HR MK YU

(30) Priority: **09.09.2004 GB 0420031**

(71) Applicant: **Pitney Bowes Limited**
Harlow,
Essex CM19 5BD (GB)

(72) Inventors:
• **Farmer, Geoffrey Alan**
Ingatestone
Essex CM4 0BE (GB)
• **Watson, Peter John**
Rayleigh
Essex SS6 7LX (GB)
• **Watts, Keith George Robert**
Abbots Langley
Hertfordshire WD5 0SW (GB)

(74) Representative: **HOFFMANN EITLE**
Patent- und Rechtsanwälte
Arabellastrasse 4
81925 München (DE)

(54) **Trailing edge deflector for sheet handling apparatus**

(57) A sheet handling apparatus (1000) for feeding a sequential plurality of sheets is disclosed having a sheet feed path for guiding sheets in a sheet feeding direction through the apparatus, the apparatus comprising driving means (104,351) for driving sheets along the sheet feed path, and trail edge deflecting means (380) located on the sheet feed path, the trail edge deflecting means being arranged to deflect the trailing edge of a leading sheet to ensure overlap by a following sheet on a predetermined side of the leading sheet.

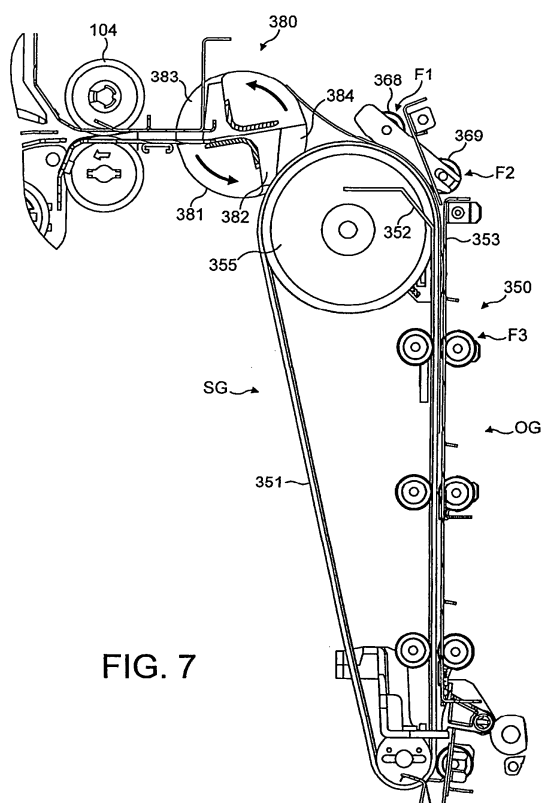

FIG. 7

EP 1 634 835 A3



European Patent
Office

EUROPEAN SEARCH REPORT

Application Number
EP 05 01 9703

DOCUMENTS CONSIDERED TO BE RELEVANT			
Category	Citation of document with indication, where appropriate, of relevant passages	Relevant to claim	CLASSIFICATION OF THE APPLICATION (IPC)
X	DE 197 49 610 C1 (SIEMENS AG [DE]) 12 November 1998 (1998-11-12) * the whole document *	1,3,4, 11-14	INV. B65H29/14
X	EP 0 768 260 A2 (INTELMAIL AUSTRALIA PTY LTD [AU]) 16 April 1997 (1997-04-16) * column 5, line 14 - line 31; figure 4 *	1,3,4, 11-14	
X	US 5 244 200 A (MANZKE G WILLIAM [US]) 14 September 1993 (1993-09-14) * the whole document *	1,2,4, 11-13	
X	US 5 655 761 A (SANCHEZ JOSE R [US]) 12 August 1997 (1997-08-12) * the whole document *	1,3,4, 11-14	
			TECHNICAL FIELDS SEARCHED (IPC)
			B65H
The present search report has been drawn up for all claims			
Place of search Munich		Date of completion of the search 26 September 2007	Examiner Beckman, Anja
<p>CATEGORY OF CITED DOCUMENTS</p> <p>X : particularly relevant if taken alone Y : particularly relevant if combined with another document of the same category A : technological background O : non-written disclosure P : intermediate document</p> <p>T : theory or principle underlying the invention E : earlier patent document, but published on, or after the filing date D : document cited in the application L : document cited for other reasons & : member of the same patent family, corresponding document</p>			

2
EPO FORM 1503.03.82 (P04C01)

**ANNEX TO THE EUROPEAN SEARCH REPORT
ON EUROPEAN PATENT APPLICATION NO.**

EP 05 01 9703

This annex lists the patent family members relating to the patent documents cited in the above-mentioned European search report.
The members are as contained in the European Patent Office EDP file on
The European Patent Office is in no way liable for these particulars which are merely given for the purpose of information.

26-09-2007

Patent document cited in search report	Publication date	Patent family member(s)	Publication date
DE 19749610	C1	12-11-1998	EP 0915051 A1 12-05-1999
		US 6179284 B1	30-01-2001
EP 0768260	A2	16-04-1997	AT 214679 T 15-04-2002
		DE 69619924 D1	25-04-2002
		DE 69619924 T2	07-11-2002
		DK 768260 T3	15-07-2002
		ES 2174031 T3	01-11-2002
		PT 768260 T	30-09-2002
		US 5851008 A	22-12-1998
US 5244200	A	14-09-1993	CA 2142591 A1 01-03-1994
		DE 69317051 D1	26-03-1998
		DE 69317051 T2	27-08-1998
		EP 0655983 A1	07-06-1995
		JP 8500807 T	30-01-1996
		WO 9404451 A1	03-03-1994
US 5655761	A	12-08-1997	NONE