



(12) **EUROPEAN PATENT APPLICATION**

(88) Date of publication A3:
28.05.2008 Bulletin 2008/22

(51) Int Cl.:
B66B 27/00 (2006.01) B66B 23/12 (2006.01)

(43) Date of publication A2:
15.03.2006 Bulletin 2006/11

(21) Application number: **05016573.7**

(22) Date of filing: **29.07.2005**

(84) Designated Contracting States:
AT BE BG CH CY CZ DE DK EE ES FI FR GB GR HU IE IS IT LI LT LU LV MC NL PL PT RO SE SI SK TR
Designated Extension States:
AL BA HR MK YU

- **Ojima, Kazuhira,**
c/o Hitachi, Ltd.
Chiyoda-ku
Tokyo 100-8220 (JP)
- **Abe, Yoshio,**
c/o Hitachi, Ltd.
Chiyoda-ku
Tokyo 100-8220 (JP)
- **Yamashita, Tomonori,**
c/o Hitachi, Ltd.
Chiyoda-ku
Tokyo 100-8220 (JP)

(30) Priority: **10.09.2004 JP 2004263203**

(71) Applicant: **Hitachi, Ltd.**
Tokyo (JP)

(72) Inventors:
• **Hamada, Tomoyuki,**
c/o Hitachi, Ltd.
Chiyoda-ku
Tokyo 100-8220 (JP)

(74) Representative: **Beetz & Partner**
Steinsdorfstrasse 10
80538 München (DE)

(54) **A passenger conveyer and a step for use of inspection thereof**

(57) In a passenger conveyer apparatus, including an escalator (80), for example, passengers are carried through movement of the steps (1), which are connected endlessly. At least one piece of the steps (1) is one for use of an inspection, and within an inside thereof, i.e., on a reverse side surface of a loading surface (1c) for loading a passenger thereon; there are provided an ac-

celeration sensor (4, 5, 6, 7) for detecting acceleration of the steps (1), a signal processor apparatus (8) for conducting signal processing upon an output signal of the acceleration sensor (4, 5, 6, 7), a transmitter means (9) for transmitting an output of the signal processor apparatus (8), an electric power supply means for supplying electric power to the signal processor apparatus (8).

FIG.1

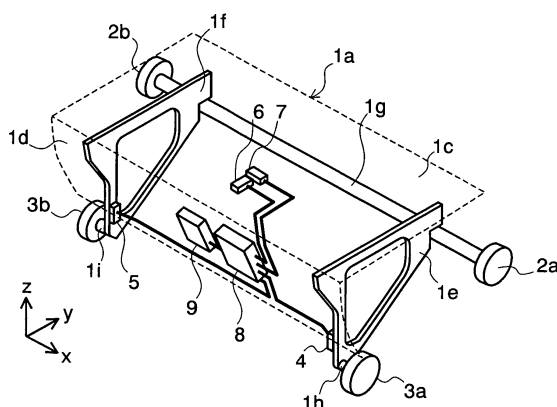



European Patent
Office

EUROPEAN SEARCH REPORT

Application Number
EP 05 01 6573

DOCUMENTS CONSIDERED TO BE RELEVANT			
Category	Citation of document with indication, where appropriate, of relevant passages	Relevant to claim	CLASSIFICATION OF THE APPLICATION (IPC)
X	JP 07 133088 A (TOKYO SHIBAURA ELECTRIC CO) 23 May 1995 (1995-05-23)	1,2,5,6,8,10	INV. B66B27/00
Y	* abstract; figures 1-5 *	4	B66B23/12
A	-----	9	
Y	EP 1 055 634 A (INVENTIO AG [CH]) 29 November 2000 (2000-11-29)	4	
A	* abstract *	1	

P,X	JP 2005 067847 A (MITSUBISHI ELECTRIC CORP; MITSUBISHI ELEC BUILDING TECHN) 17 March 2005 (2005-03-17)	1-8,10	
	* abstract; figures 1-10 *		

			TECHNICAL FIELDS SEARCHED (IPC)
			B66B
The present search report has been drawn up for all claims			
Place of search		Date of completion of the search	Examiner
The Hague		22 April 2008	Janssens, Gerd
CATEGORY OF CITED DOCUMENTS X : particularly relevant if taken alone Y : particularly relevant if combined with another document of the same category A : technological background O : non-written disclosure P : intermediate document T : theory or principle underlying the invention E : earlier patent document, but published on, or after the filing date D : document cited in the application L : document cited for other reasons & : member of the same patent family, corresponding document			

2

EPO FORM 1503 03/82 (P04C01)

**ANNEX TO THE EUROPEAN SEARCH REPORT
ON EUROPEAN PATENT APPLICATION NO.**

EP 05 01 6573

This annex lists the patent family members relating to the patent documents cited in the above-mentioned European search report.
The members are as contained in the European Patent Office EDP file on
The European Patent Office is in no way liable for these particulars which are merely given for the purpose of information.

22-04-2008

Patent document cited in search report		Publication date	Patent family member(s)	Publication date
JP 7133088	A	23-05-1995	NONE	
EP 1055634	A	29-11-2000	NONE	
JP 2005067847	A	17-03-2005	JP 4020204 B2	12-12-2007