



(12) **EUROPEAN PATENT APPLICATION**

(88) Date of publication A3:
01.08.2007 Bulletin 2007/31

(51) Int Cl.:
D03D 39/22 (2006.01)

(43) Date of publication A2:
31.05.2006 Bulletin 2006/22

(21) Application number: **05025225.3**

(22) Date of filing: **18.11.2005**

(84) Designated Contracting States:
AT BE BG CH CY CZ DE DK EE ES FI FR GB GR HU IE IS IT LI LT LU LV MC NL PL PT RO SE SI SK TR
Designated Extension States:
AL BA HR MK YU

(30) Priority: **25.11.2004 JP 2004340486**

(71) Applicant: **TSUDAKOMA KOGYO KABUSHIKI KAISHA**
Kanazawa-shi,
Ishikawa-ken 921-8650 (JP)

(72) Inventors:
• **Banba, Hideki**
Kanazawa-shi
Ishikawa-ken 921-8650 (JP)
• **Yamamoto, Akihiko**
Kanazawa-shi
Ishikawa-ken 921-8650 (JP)
• **Kakuda, Hiroshi**
Kanazawa-shi
Ishikawa-ken 921-8650 (JP)

(74) Representative: **von Samson-Himmelstjerna, Friedrich et al**
SAMSON & PARTNER,
Widenmayerstrasse 5
80538 München (DE)

(54) **Method for driving terry motion members in cloth-shifting-type pile loom**

(57) In a cloth-shifting-type pile loom (1) in which let-off-side and take-up side terry motion members (15, 16) are driven via a driving mechanism by at least one designated driving motor (m1, m2) independent of a main driving motor of the pile loom (1), at least one of the terry motion members (15, 16) is driven in a first driving mode

by at least one driving motor (m1, m2) for a predetermined period. The first driving mode is different from a second driving mode performed under a steady operation of the pile loom (1). The predetermined period starts from a point at which the pile loom (1) is activated after the pile loom (1) is stopped.

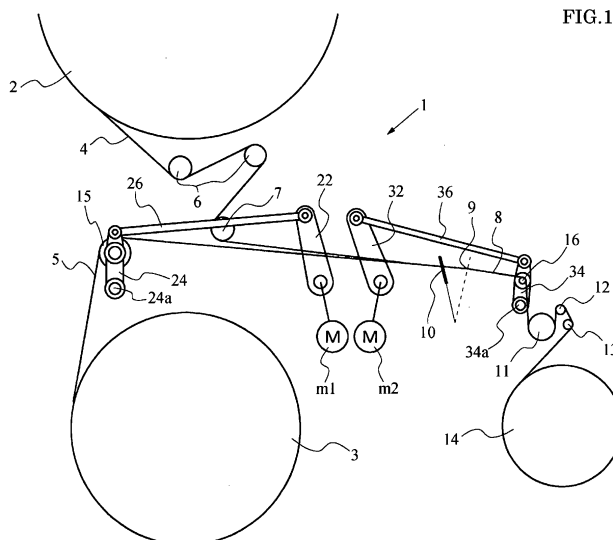



European Patent
Office

EUROPEAN SEARCH REPORT

Application Number
EP 05 02 5225

DOCUMENTS CONSIDERED TO BE RELEVANT			
Category	Citation of document with indication, where appropriate, of relevant passages	Relevant to claim	CLASSIFICATION OF THE APPLICATION (IPC)
D,A	JP 07 173743 A (RUETI AG MASCHF [CH]) 11 July 1995 (1995-07-11) * abstract *	1-4	INV. D03D39/22
D,A	JP 02 047334 A (SULZER AG) 16 February 1990 (1990-02-16) * figures 9-11 *	1-4	
A	US 5 392 817 A (SEIFERT EBERHARD [CH] ET AL) 28 February 1995 (1995-02-28) * abstract; figures 1,2 *	1-4	
A	EP 0 878 571 A1 (TOYODA AUTOMATIC LOOM WORKS [JP] TOYOTA JIDOSHOKKI KK [JP]) 18 November 1998 (1998-11-18) * the whole document *	1-4	
The present search report has been drawn up for all claims			TECHNICAL FIELDS SEARCHED (IPC)
			D03D
Place of search		Date of completion of the search	Examiner
The Hague		21 June 2007	Pussemier, Bart
<p>CATEGORY OF CITED DOCUMENTS</p> <p>X : particularly relevant if taken alone Y : particularly relevant if combined with another document of the same category A : technological background O : non-written disclosure P : intermediate document</p> <p>T : theory or principle underlying the invention E : earlier patent document, but published on, or after the filing date D : document cited in the application L : document cited for other reasons & : member of the same patent family, corresponding document</p>			

2

EPO FORM 1503 03/82 (P04C01)

**ANNEX TO THE EUROPEAN SEARCH REPORT
ON EUROPEAN PATENT APPLICATION NO.**

EP 05 02 5225

This annex lists the patent family members relating to the patent documents cited in the above-mentioned European search report.
The members are as contained in the European Patent Office EDP file on
The European Patent Office is in no way liable for these particulars which are merely given for the purpose of information.

21-06-2007

Patent document cited in search report		Publication date		Patent family member(s)	Publication date
JP 7173743	A	11-07-1995	DE	59309910 D1	27-01-2000
			EP	0648875 A1	19-04-1995
			JP	3515184 B2	05-04-2004
			US	5499662 A	19-03-1996

JP 2047334	A	16-02-1990	CN	1039454 A	07-02-1990
			DE	58901071 D1	07-05-1992
			EP	0350446 A1	10-01-1990
			JP	3171396 B2	28-05-2001
			US	5058628 A	22-10-1991

US 5392817	A	28-02-1995	DE	59206642 D1	01-08-1996
			EP	0518809 A1	16-12-1992
			JP	5156546 A	22-06-1993

EP 0878571	A1	18-11-1998	DE	69814982 D1	03-07-2003
			DE	69814982 T2	26-02-2004
			JP	10317254 A	02-12-1998
