



(12) **EUROPEAN PATENT APPLICATION**

(88) Date of publication A3:  
**16.12.2009 Bulletin 2009/51**

(51) Int Cl.:  
**E05B 9/08 (2006.01)** *E05C 9/12 (2006.01)*  
*E05C 9/04 (2006.01)*

(43) Date of publication A2:  
**05.07.2006 Bulletin 2006/27**

(21) Application number: **05077928.9**

(22) Date of filing: **20.12.2005**

(84) Designated Contracting States:  
**AT BE BG CH CY CZ DE DK EE ES FI FR GB GR HU IE IS IT LI LT LU LV MC NL PL PT RO SE SI SK TR**  
Designated Extension States:  
**AL BA HR MK YU**

(71) Applicant: **Prefer Commerciale S.R.L.**  
**20020 Cantalupo di Cerro Maggiore (IT)**

(72) Inventor: **Finardi, Ivo**  
**20020 Arese (IT)**

(74) Representative: **Patrito, Pier Franco**  
**Patent Agency Patrito Brevetti**  
**Via Don Minzoni 14**  
**10121 Torino (IT)**

(30) Priority: **28.12.2004 IT TO20040905**

(54) **Lock for rolling shutters, swinging doors and section doors**

(57) A lock for rolling shutters, swinging doors and section doors, comprising a box (1-3), a box covering (19), a pair of bolt actuating members (15) selectively displaceable between withdrawn positions and extracted positions, and an operating system of toothed wheels (10,13) intended for driving the bolt actuating members (15) under control of a lock cylinder (26) included in a cylinder lock unit (15). According to the invention, the cylinder lock unit (15) is connected to the lock box covering (19) by means of at least one screw acting between the box covering (19) and the cylinder lock unit (25); the screw is accessible by a maneuver tool through at least

one corresponding bore (7) formed in the front wall (1) of the lock box, and the lock comprises a shutter member (11) arranged for preventing the insertion of the tool through the bore (7) when the lock cylinder (26) is situated in any position different from a preestablished change position, which can be attained only by rotating the lock cylinder (26) by means of the corresponding key (28). Preferably, the shutter member (11) is formed by a flange portion (11) of the central toothed wheel (10) of the lock operating system, and this central toothed wheel (10) is embodied by means of a half-shear operation from a metal plate disk whose periphery forms the flange (11).

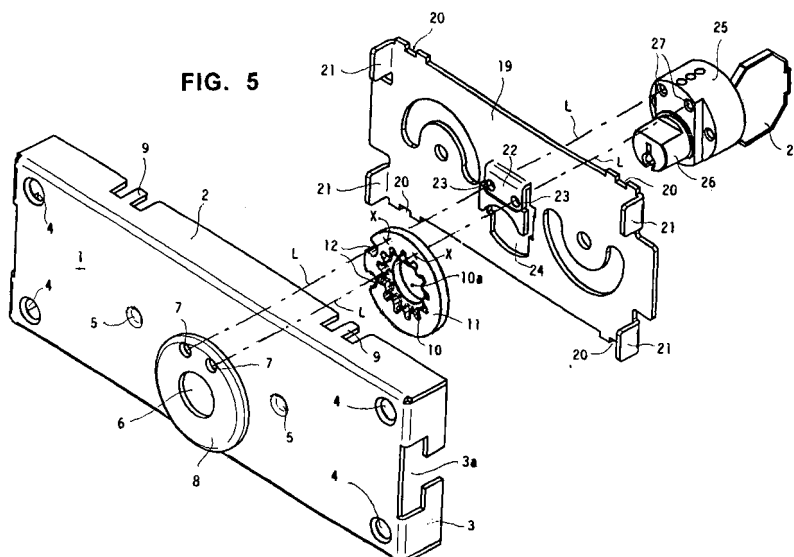



## EUROPEAN SEARCH REPORT

Application Number  
EP 05 07 7928

DOCUMENTS CONSIDERED TO BE RELEVANT			
Category	Citation of document with indication, where appropriate, of relevant passages	Relevant to claim	CLASSIFICATION OF THE APPLICATION (IPC)
A,D	IT 851 968 B1 (PREDELLI FERMO) 5 November 1969 (1969-11-05) * the whole document *	1	INV. E05B9/08
A	US 5 577 408 A (ROOS ANGSTROM GE [NO]) 26 November 1996 (1996-11-26) * column 2, line 37 - line 43 * * figures 4,5 *	1	ADD. E05C9/12 E05C9/04
A	US 5 044 180 A (LEBRECHT HORST [US]) 3 September 1991 (1991-09-03) * column 1, line 60 - column 2, line 14 * * figures 4,5 *	1	
			TECHNICAL FIELDS SEARCHED (IPC)
			E05B
The present search report has been drawn up for all claims			
Place of search The Hague		Date of completion of the search 26 October 2009	Examiner Bitton, Alexandre
<p>CATEGORY OF CITED DOCUMENTS</p> <p>X : particularly relevant if taken alone Y : particularly relevant if combined with another document of the same category A : technological background O : non-written disclosure P : intermediate document</p> <p>T : theory or principle underlying the invention E : earlier patent document, but published on, or after the filing date D : document cited in the application L : document cited for other reasons &amp; : member of the same patent family, corresponding document</p>			

4  
EPO FORM 1503 03 82 (P04C01)

**ANNEX TO THE EUROPEAN SEARCH REPORT  
ON EUROPEAN PATENT APPLICATION NO.**

EP 05 07 7928

This annex lists the patent family members relating to the patent documents cited in the above-mentioned European search report.  
The members are as contained in the European Patent Office EDP file on  
The European Patent Office is in no way liable for these particulars which are merely given for the purpose of information.

26-10-2009

Patent document cited in search report	Publication date	Patent family member(s)	Publication date
IT 851968	B1	NONE	
US 5577408	A	26-11-1996 NO 934885 A	30-06-1995
US 5044180	A	03-09-1991 CN 1056921 A	11-12-1991
		CN 1219636 A	16-06-1999
		DE 4116403 A1	28-11-1991
		ES 2043497 A2	16-12-1993
		FR 2662462 A1	29-11-1991
		GB 2244310 A	27-11-1991
		HK 1007781 A1	23-04-1999
		HK 1007782 A1	23-04-1999
		IT 1245534 B	29-09-1994
		JP 7091127 A	04-04-1995