



(12) **EUROPEAN PATENT APPLICATION**

(88) Date of publication A3:
11.04.2007 Bulletin 2007/15

(51) Int Cl.:
A47K 17/02 (2006.01) **A47K 10/04 (2006.01)**
A47B 95/02 (2006.01) **E05B 1/00 (2006.01)**

(43) Date of publication A2:
30.08.2006 Bulletin 2006/35

(21) Application number: **06110366.9**

(22) Date of filing: **23.02.2006**

(84) Designated Contracting States:
AT BE BG CH CY CZ DE DK EE ES FI FR GB GR HU IE IS IT LI LT LU LV MC NL PL PT RO SE SI SK TR
Designated Extension States:
AL BA HR MK YU

(71) Applicant: **M.P.M. SNC di Malini Primo & C.**
36060 Romano d'Ezzelino, VI (IT)

(72) Inventor: **Malini, Primo Roberto**
36027 Rosa' (VI) (IT)

(74) Representative: **Bonini, Ercole**
Corso Fogazzaro, 8
36100 Vicenza (IT)

(30) Priority: **24.02.2005 IT VI20050051**

(54) **Gripping or supporting element.**

(57) The invention is a gripping or supporting element (1), comprising a shaped body (2) provided with ends (2a, 2b) connected to a bearing structure (S), bushes (3, 4) applied to the bearing structure (S) through first fastening means (5) that project from the outer surface (S_e) of the bearing structure (S) and second fastening means

(6) that permanently connect said shaped body (2) to the bushes (3, 4). The gripping or supporting element (1) comprises shaped inserts (7, 8) joined to the ends (2a, 2b) of the shaped body (2) through third fastening means (9), said inserts being coupled to the bushes (3, 4) when the shaped body (2) is positioned against the bearing structure (S).

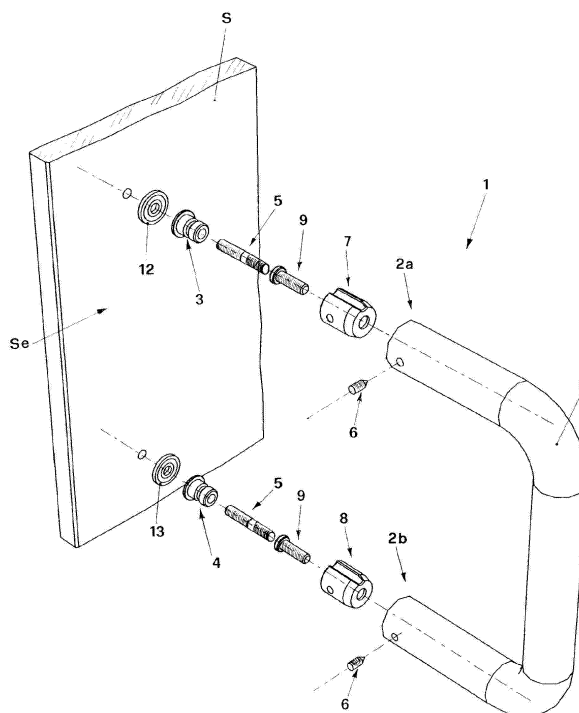

FIG.1



European Patent
Office

EUROPEAN SEARCH REPORT

Application Number
EP 06 11 0366

DOCUMENTS CONSIDERED TO BE RELEVANT			
Category	Citation of document with indication, where appropriate, of relevant passages	Relevant to claim	CLASSIFICATION OF THE APPLICATION (IPC)
X	EP 0 563 568 A2 (HOPPE AG [DE]) 6 October 1993 (1993-10-06)	1,2, 10-12	INV. A47K17/02
Y	* column 4, lines 20-39 *	13	A47K10/04
A	* column 5, lines 38-46; figures 1a,2,3 *	3-6, 14-16	A47B95/02 E05B1/00

X	DE 101 03 243 C1 (FRANZ KALDEWEI GMBH & CO KG [DE]) 2 October 2002 (2002-10-02)	1,10-12	
Y	* columns 2-3, paragraphs 14,15; figures 1,2 *	13	
A		2	

X	US 5 810 502 A (REITZ REINHOLD [DE] ET AL) 22 September 1998 (1998-09-22)	1,10-12	
A	* abstract; figure 2c *	2-4	

X	DE 35 18 127 A1 (GRIMBERG HANS EDELSTAHL [DE]) 18 December 1986 (1986-12-18)	1,10,11	
A	* page 11, paragraph 3 - page 13, paragraph 1; figure 2 *	2,16	

			TECHNICAL FIELDS SEARCHED (IPC)
			A47K A47B E05B E04F F16B
The present search report has been drawn up for all claims			
Place of search Munich		Date of completion of the search 21 February 2007	Examiner FAJARNES JESSEN, A
<p>CATEGORY OF CITED DOCUMENTS</p> <p>X : particularly relevant if taken alone Y : particularly relevant if combined with another document of the same category A : technological background O : non-written disclosure P : intermediate document</p> <p>T : theory or principle underlying the invention E : earlier patent document, but published on, or after the filing date D : document cited in the application L : document cited for other reasons & : member of the same patent family, corresponding document</p>			

1
EPO FORM 1503 03.82 (P04C01)

**ANNEX TO THE EUROPEAN SEARCH REPORT
ON EUROPEAN PATENT APPLICATION NO.**

EP 06 11 0366

This annex lists the patent family members relating to the patent documents cited in the above-mentioned European search report. The members are as contained in the European Patent Office EDP file on
The European Patent Office is in no way liable for these particulars which are merely given for the purpose of information.

21-02-2007

Patent document cited in search report		Publication date		Patent family member(s)	Publication date
EP 0563568	A2	06-10-1993	DE	9202868 U1	01-04-1993

DE 10103243	C1	02-10-2002	NONE		

US 5810502	A	22-09-1998	AT	163983 T	15-03-1998
			AT	224496 T	15-10-2002
			CN	1145651 A	19-03-1997
			CZ	9602599 A3	12-02-1997
			DE	29500691 U1	16-03-1995
			DK	742863 T3	04-01-1999
			WO	9622436 A1	25-07-1996
			EP	0742863 A1	20-11-1996
			ES	2115423 T3	16-06-1998
			ES	2184000 T3	01-04-2003
			FI	963152 A	12-08-1996
			HU	9602546 A2	29-09-1997
			JP	3059217 B2	04-07-2000
			JP	9508685 T	02-09-1997
			NO	963889 A	12-11-1996
			PL	315897 A1	09-12-1996
			SI	9620003 A	28-02-1997
			SK	117296 A3	09-07-1997

DE 3518127	A1	18-12-1986	NONE		
