



(12) **EUROPEAN PATENT APPLICATION**

(88) Date of publication A3:
23.01.2008 Bulletin 2008/04

(51) Int Cl.:
F16B 21/18 ^(2006.01) **E05B 15/02** ^(2006.01)
E05B 3/06 ^(2006.01)

(43) Date of publication A2:
15.11.2006 Bulletin 2006/46

(21) Application number: **06116488.5**

(22) Date of filing: **16.01.2004**

(84) Designated Contracting States:
AT BE BG CH CY CZ DE DK EE ES FI FR GB GR HU IE IS IT LI LT LU LV MC NL PL PT RO SE SI SK TR
 Designated Extension States:
AL BA HR MK YU

(62) Document number(s) of the earlier application(s) in accordance with Art. 76 EPC:
04425018.1 / 1 455 035

(71) Applicant: **Zamet S.R.L.**
25071 Agnosine (Brescia) (IT)

(72) Inventors:
 • **ZANONI, Mario**
25071, Agnosine (BS) (IT)
 • **ZANONI, Bruno**
25071, Agnosine (BS) (IT)

(74) Representative: **Galassi, Alessandro**
Bugnion S.p.A.,
Via Dante, 17
25122 Brescia (IT)

(54) **Sealing ring and mechanism for door shackles comprising such a sealing ring**

(57) Mechanism for door shackles (15), comprising a support body (2) to be fastened to a door and having a hole (3), a rotary element (16) associated to said support body (2) and having an engagement portion (16a) to be associated to a shackle (15), and an elastic element (17) placed between the support body (2) and the rotary element (16) and having a first end (17a) associated to an operating portion (18) of the support body (2) and a

second end (17b) associated to an operating portion (19) of the rotary element (16), said support body (2), rotary element (16) and elastic element (17) defining an elastic return mechanism (14) for a shackle (15). The mechanism for door shackles (15) further comprises an elastic sealing ring (24) placed beside said rotary element (16) and to be movably associated to an operating end (15a) of a shackle (15) so as to fasten said operating end (15a) to said rotary element (16).

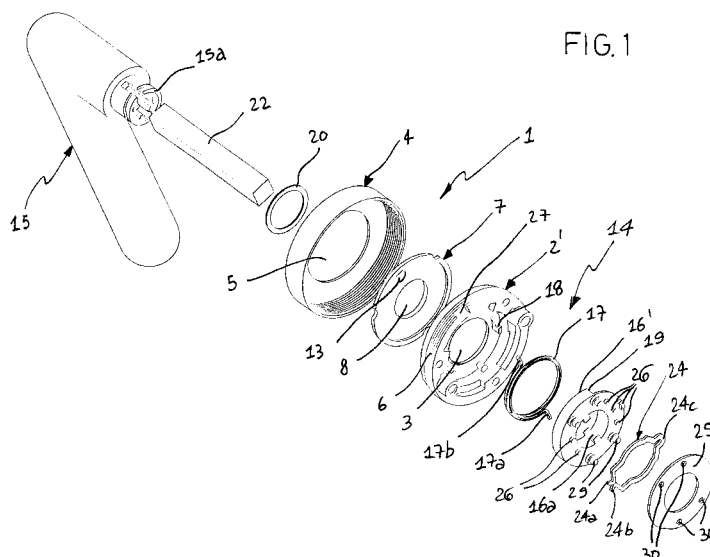

FIG. 1



European Patent
Office

EUROPEAN SEARCH REPORT

Application Number
EP 06 11 6488

DOCUMENTS CONSIDERED TO BE RELEVANT				
Category	Citation of document with indication, where appropriate, of relevant passages	Relevant to claim	CLASSIFICATION OF THE APPLICATION (IPC)	
X	GB 606 209 A (HERBERT GEORGE SMITH) 10 August 1948 (1948-08-10)	1-3	INV. F16B21/18 E05B15/02 E05B3/06	
A	* the whole document *	4		
X	DE 36 04 115 A1 (WILKE RUDOLF [DE]) 4 September 1986 (1986-09-04)	1		
A	* page 51, paragraph 1 - page 52, paragraph 4 * * page 55, paragraph 3 - page 60, paragraph 2 * * figures 14,15,21-28 *	4		
X	EP 0 754 827 A2 (WILKE HEINRICH HEWI GMBH [DE]) 22 January 1997 (1997-01-22)	1,2		
A	* the whole document *	4		
X	FR 2 797 290 A1 (CT D APPROVISIONNEMENT EN DECO [FR]) 9 February 2001 (2001-02-09)	1,2		
A	* the whole document *	4		
X	GB 2 312 934 A (RIPPONLEA AUSTRALIA PTY LTD [AU]) 12 November 1997 (1997-11-12)	1-4		TECHNICAL FIELDS SEARCHED (IPC)
X	DE 197 18 439 A1 (CENTREX LTD [GB] CX HOLDINGS LTD [GB]) 3 September 1998 (1998-09-03)	1,3,4		E05B
X	GB 1 220 187 A (JAMES COLLINS BIRMINGHAM LTD) 20 January 1971 (1971-01-20)	1,3,4		
D,X	IT BS 940 038 A1 (ZAMET METALLURG S N C DEI F LL [IT]) 23 October 1995 (1995-10-23)	1,3,4		
The present search report has been drawn up for all claims				
Place of search The Hague		Date of completion of the search 12 December 2007	Examiner Westin, Kenneth	
<p>CATEGORY OF CITED DOCUMENTS</p> <p>X : particularly relevant if taken alone Y : particularly relevant if combined with another document of the same category A : technological background O : non-written disclosure P : intermediate document</p> <p>T : theory or principle underlying the invention E : earlier patent document, but published on, or after the filing date D : document cited in the application L : document cited for other reasons & : member of the same patent family, corresponding document</p>				

2
EPO FORM 1503 03.82 (P04C01)

**ANNEX TO THE EUROPEAN SEARCH REPORT
ON EUROPEAN PATENT APPLICATION NO.**

EP 06 11 6488

This annex lists the patent family members relating to the patent documents cited in the above-mentioned European search report.
The members are as contained in the European Patent Office EDP file on
The European Patent Office is in no way liable for these particulars which are merely given for the purpose of information.

12-12-2007

Patent document cited in search report		Publication date	Patent family member(s)	Publication date
GB 606209	A	10-08-1948	NONE	
DE 3604115	A1	04-09-1986	NONE	
EP 0754827	A2	22-01-1997	AT 344865 T	15-11-2006
			DE 29511547 U1	21-11-1996
			DK 0754827 T3	19-03-2007
			ES 2277337 T3	01-07-2007
FR 2797290	A1	09-02-2001	NONE	
GB 2312934	A	12-11-1997	NONE	
DE 19718439	A1	03-09-1998	NL 1005384 C2	28-08-1998
GB 1220187	A	20-01-1971	NONE	
IT BS940038	A1	23-10-1995	NONE	

EPO FORM P0459

For more details about this annex : see Official Journal of the European Patent Office, No. 12/82