



(11)

**EP 1 733 660 A1**

(12)

**EUROPEAN PATENT APPLICATION**

(43) Date of publication:

**20.12.2006** Bulletin 2006/51

(51) Int Cl.:

**A47H 1/04** (2006.01)

**A47H 2/00** (2006.01)

(21) Application number: **05425429.7**

(22) Date of filing: **15.06.2005**

(84) Designated Contracting States:

**AT BE BG CH CY CZ DE DK EE ES FI FR GB GR  
HU IE IS IT LI LT LU MC NL PL PT RO SE SI SK TR**

Designated Extension States:

**AL BA HR LV MK YU**

(71) Applicant: **Gargano, Gaetano**

**95047 Paterno (CT) (IT)**

(72) Inventor: **Gargano, Gaetano**

**95047 Paterno (CT) (IT)**

(54) **Universal system for curtain holder**

(57) Universal system for curtain holders constituted by an extrudate aluminium profile (1) containing interchangeable ornamental decorative elements (11) characterized by the fact that said extrudate aluminium profile (1) presents at least two channels (2,3) (one posterior

(2) and one superior (3) having a "C" form) and a hollow (5) in the anterior part to receive the decorative ornamental element, that said channels are used to receive the angular joints, the elements of fixture to the wall or to the ceiling and the chases for the double, triple or quadruple curtain rods assembly.

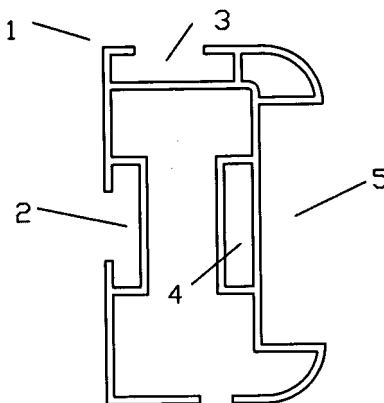

Fig. 1

## Description

### Technical field of invention

**[0001]** The universal system for curtain holders, object of present invention, concerns a profile in extrudate aluminium which permits to realize curtain holders with interchangeable ornamental decorative elements, and curtain holders with double or even triple curtains.

### State of the art

**[0002]** Different types of profiles have been studied in order to realize the curtain holding systems. These profiles present numerous limits. The profile used for the frontal bar differs from the profile type used for the lateral bars. Frontal and lateral bars can not receive interchangeable ornamental decorative elements. It is not possible to mount double curtains without using special pieces.

**[0003]** The patent IT-B-1230406 describes one of such curtain holders systems constituted by an extrudate aluminium profile for the frontal bar realization, the profile in the vertical anterior wall contains one superior flange and one inferior flange which emerge outside. Both the superior and inferior flanges include on their external edge a limited grooved part, curved on one side. The decorative fascia contains a trait of semicircular external wall and two key parts that emerge inside. Said decorative fascia is mounted by blocking the two hooking parts on the curved parts of the inferior and superior flanges of frontal bar. The lateral fascia are constituted only by decorative fascia that are inserted into the wall mount plates.

**[0004]** The system proposed in the patent mentioned above presents numerous disadvantages and inconveniences.

**[0005]** The resistance of frontal bar and lateral fascia is not uniform. Only the hollow decorative fascia can be used, and, consequently, the decorative fascia of, for example, solid wood, can not be used.

**[0006]** Several parallel bars can not be mounted in order to realize curtain holding systems with more than one curtain.

**[0007]** The joint angular elements are fixed and variable angular joints can not be mounted. In such a way the usage of this system in the situations where the only fixed angular joints can be used is limited.

### Invention advantages

**[0008]** The present invention aims to overcome the difficulties present in the state of the art.

**[0009]** The difficulties present in the state of the art are overcome by realization of a universal system for curtain holders constituted by an extrudate aluminium profile containing interchangeable ornamental decorative elements characterized by the fact that said extrudate aluminium

profile presents at least two channels (one posterior and one superior having a "C" form) and a hollow in the anterior part to receive the decorative ornamental element, that said channels are used to receive the angular joints, the elements of fixture to the wall or to the ceiling and the chases for the double, triple or quadruple curtain holding assembly.

**[0010]** Another characteristics is given by the fact that said profile presents a third anterior channel of closed rectangular form which is used to receive the mounts of fixture to the wall or ceiling and the angular joints.

**[0011]** Another characteristics is given by the fact that said profile presents in the lower part a grooved guide for the curtain holder slides.

**[0012]** Another characteristics is given by the fact that each of the mounts of the fixture to the wall is formed by the anchorage plate having an insertion element; said anchorage plate must be fixed to the wall and the insertion element must be introduced in the profile channel to hold it.

**[0013]** Another characteristics is given by the fact that said anchorage plate presents a regulation guide which permits to settle perfectly the height of the insertion element and, consequently, of the profile; the insertion element has a slide/blockage system which can slide inside the guide and be blocked on the desired height.

**[0014]** Another characteristics is given by the fact that said profile is fixed on the ceiling using the superior channel; in said superior channel the mounts are inserted and by means of screws introduced in the predisposed holes remain fixed to the ceiling.

**[0015]** Another characteristics is given by the fact that the profile is helded by intermediate holders; said intermediate holders have an anchorage plate and an insertion element which is introduced in the posterior channel of the extrudate aluminium profile.

**[0016]** Another characteristics is given by the fact that said anchorage plate has a regulation guide and a slide/blockage system for a perfect settling of the intermediate holders height.

**[0017]** Another characteristics is given by the fact that said system presents a frontal profile and lateral profiles which are fixed one with another by the angular joints.

**[0018]** Another characteristics is given by the fact that the angular joints are variable.

**[0019]** Another characteristics is given by the fact that the angular joints are fixed.

**[0020]** Another characteristics is given by the fact that said fixed angular joint presents in the lower part a guide for the curtain rod slides which joins perfectly with the guides of lateral profiles and frontal profile.

**[0021]** Another characteristics is given by the fact that said fixed angular joint presents in the frontal part a hollow adopted to receive an ornamental decorative element, that the hollow and the ornamental decorative element present on the fixed angular joint are identical to the hollow and to the ornamental decorative element present on the profiles and form a unique body with them.

**[0022]** Another characteristics is given by the fact that said fixed angular joint keys in the profiles that it must connect by means of the insertion elements which are introduced in all the channels or in a couple of channels.

**[0023]** Another characteristics is given by the fact that few frontal profiles are mounted on two lateral profiles perpendicular to frontal profiles by means of chases constituted by an insertion plate which is introduced into the posterior channel of two perpendicular lateral profiles and by an insertion element which is introduced into posterior channel or into the anterior channel of the frontal profiles to realize a double, triple or quadruple curtain.

**[0024]** Another characteristics is given by the fact that ornamental decorative elements are fixed to the profile with a "swallow tail" system which presumes a swallow-tail groove present on the anterior side of profile hollow and a swallow-tail mount which is present on the posterior side of the decorative ornamental element.

**[0025]** Another characteristics is given by the fact that ornamental decorative elements are fixed to the profile with a "swallow tail" system which presumes a swallow-tail mount present on the anterior side of profile hollow and a swallow-tail groove which is present on the posterior side of the decorative ornamental element.

**[0026]** Another characteristics is given by the fact that the ornamental decorative elements are fixed with magnetic systems, with velcro assembly systems or with bonding systems.

**[0027]** Another characteristics is given by the fact that the decorative ornamental elements are solid.

**[0028]** Another characteristics is given by the fact that the ornamental decorative elements are formed by a lamina, suitably shaped, which presents the hook elements keyed with the other hook elements present in the profile hollow.

**[0029]** Another characteristics is given by the fact that the ornamental decorative elements are made of any manufactured, decorated or, anyway, coloured material.

**[0030]** Another characteristics is given by the fact that the ornamental decorative elements are lined with the tissue of the curtain itself.

**[0031]** Another characteristics is given by the fact that the profile is closed on its ends by a plate having the same shape of the profile.

**[0032]** Another characteristics is given by the fact that said plate is provided with holes and can be screwed by means of the screws to the correspondent threaded holes present on said profile.

**[0033]** Another characteristics is given by the fact that said plate has key elements which are inserted in the channels of said profile.

**[0034]** Other characteristics and advantages of the invention will be clear from the following description of different modes of the invention realization given as a not limiting example on the figures 1, 2, 3, 4a, 4b, 5, 6, 7, 8, 9, 10, 11, 12, 13, 14, 15 and 16.

## Short description of figures

### [0035]

- 5 Figure 1 is a profile section of the system object of present invention.  
 Figure 2 is a mounting scheme of screw closure plate of one profile end.  
 Figure 3 is a mounting scheme of key closure plate of one profile end.  
 10 Figure 4a is a mounting scheme of a fixed angular joint.  
 Figure 4b is a mounting scheme of the guide with slides on which the curtain is mounted.  
 Figure 5 is a mounting scheme of a variable angular joint.  
 15 Figure 6 is a wall anchoring scheme.  
 Figure 7 is a scheme of anchoring by intermediate holder.  
 Figure 8 is a ceiling mounting scheme.  
 Figure 9 is a mounting scheme of curtain holder with double profile.  
 Figure 10 is an absonometrical view of curtain holder with double profile already mounted.  
 20 Figure 11 is a mounting scheme of ornamental decorative profile with a "swallow tail" mounting with hollow.  
 Figure 12 is a mounting scheme of ornamental decorative profile with a "swallow tail" mounting without hollow.  
 25 Figure 13 is a mounting scheme of ornamental decorative profile with a "swallow tail" groove with hollow.  
 Figure 14 is a mounting scheme of ornamental decorative profile with a "swallow tail" groove with hollow and chamfers at right angles.  
 30 Figure 15 is a mounting scheme of ornamental decorative profile with hollow and splays on right angles.  
 Figure 16 is a mounting scheme of ornamental profile with spring hook both for curtains with whip and rope scrolling curtains and for vertical bands curtains.  
 35  
 40  
 45

## Detailed description of preferred embodiments of the invention

**[0036]** The universal system for curtain holders, object of present invention, is described in the figures.

**[0037]** Referring to figure 1, the curtain holding system is constituted by a profile 1 of extrudate aluminium which presents a posterior "C"-form channel 2, a superior "C"-form channel 3 and an anterior channel having a closed rectangular form 4.

**[0038]** Besides, the profile 1 presents forward a hollow 5 suitable to receive an ornamental decorative element.

**[0039]** Referring to figure 2 the profile 1 can be closed on its ends by a plate 6 having the same shape of the profile 1 and which, having the holes 7 can be screwed by means of screws in the correspondent threaded holes

8 present on the profile.

**[0040]** Referring to figure 3 the plate 6 may have the key elements 9 that are inserted into the channels 2, 3 and 4.

**[0041]** Referring to figure 4a the profile 1 may be jointed with another profile 1 by means of angular fixed joint 10.

**[0042]** The angular fixed joint 10 presents forward the hollow 5' suitable to receive an ornamental decorative element 11'.

**[0043]** The hollow 5' and ornamental decorative element 11' present on the angular fixed joint 10 are identical to the hollow 5 and to the ornamental decorative element 11 present on profiles 1 and form a unique body with them.

**[0044]** The fixed angular joint 10 keys in the profiles 1 which must be linked by means of insertion elements 12 which are introduced into the channels 2 and 3 or in another couple of channels.

**[0045]** The fixed angular joint 10 can only be angular and the insertion elements 12 are fixed to the plate 13 which is subsequently screwed to said fixed joint 10.

**[0046]** Referring to figure 4b, the profile 1 presents a grooved guide 40 in which the slides 41 are inserted. The curtain is mounted to the slides 41 by means of known systems, for example by rings 42.

**[0047]** The slides 41 realise the curtain opening and closing motion both with whip and by rope scrolling.

**[0048]** By means of the fixed angular joint 10, as shown in figure 4a, the grooved guide 40 continuity is realised and that's why the slides 41 and, hence, the curtain can be gathered on the wall on the left or on the right side.

**[0049]** Two profiles 1, as shown in figure 5, can be linked with an angular joint 13. Said angular joint 13 has the swivel insertion elements 14, that are inserted into the channels 4. Said swivel insertion elements 14 permit to the joint to assume any angle and subsequently permit a variable angular joint according to the necessities.

**[0050]** The profile 1 can be mounted in the most suitable way by choice of interior decorator.

**[0051]** If the profile 1 has the arms perpendicular to the wall, it can be fixed to the wall with the mount 15 formed by an anchorage plate 16 provided with insertion element 17, as shown in figure 6. Said anchorage plate 16 is fixed to the wall and the insertion element 17 is inserted into the channel of the profile 1 to hold it. Said anchorage plate 16 presents a regulation guide 18 which permits to arrange perfectly the height of the insertion element 17, and subsequently of the profile 1, the insertion element is provided with a sliding/blockage system 19 which can run inside the guide 18 and be blocked on the desired height.

**[0052]** If the profile 1 is very long the intermediate holders 20 are requested (see fig. 7), said intermediate holders are provided with an anchorage plate 22 and with an insertion element 21 which is introduced into the posterior channel 2 of the profile 1. Said anchorage plate 22 can be provided with a regulation guide and with a sliding/

blockage system in order to arrange to a perfect measure the height of the intermediate holders.

**[0053]** The profile 1, as shown in figure 8, can also be fixed to the ceiling using the superior channel 3. In said superior channel 3 the mounts 23 are inserted and by means of the screws introduced into the holes 24 are fixed to the ceiling.

**[0054]** Besides, the profile 1, as shown in figure 9 and in figure 10, permits to mount a double profile for a double curtain.

**[0055]** A frontal profile 1 is mounted onto two lateral profiles 1b perpendicular to the frontal profile by means of stapes 25 constituted by an insertion plate 26 which is introduced into the posterior channel 2 of two perpendicular lateral profiles and by an insertion element 27 which is introduced into the posterior channel 2 or into the anterior channel 4 of the frontal profile 1.

**[0056]** If the interior decorator desires, it is possible to mount the double curtain by means of said profile 1, but it is possible to mount also the triple or even the quadruple curtain, if necessary.

**[0057]** The decorative ornamental elements 11 can be fixed to the profile 1 with a "swallow-tail" system which has a "swallow-tail" groove 30 present on the anterior side of the hollow 5 of the profile 1 and a "swallow-tail" mount 31 situated on the posterior side of the decorative ornamental element 11. (see figures 11 and 12).

**[0058]** On the contrary, the decorative ornamental elements 11 can be fixed to the profile 1 by means of "swallow tail" system which is provided with a "swallow tail" mount 31 present on the anterior side of hollow 5 of the profile 1 and a "swallow tail" groove 30 which is situated on the posterior side of the decorative ornamental element 11. (see figures 13 and 14).

**[0059]** Besides, the decorative ornamental elements can be fixed with magnetic systems, with velcro assembly systems or with bonding systems, not provided with mounts as shown on the figures 14, 15.

**[0060]** The decorative ornamental elements 11 may be solid but may also be formed by a lamina. In this case the lamina suitably shaped presents the hook elements 32 which spring and key with the hook elements present in the hollow 5 of the profile 1.

**[0061]** The ornamental decorative elements 11 are made of any manufactured, decorated or, anyway, coloured material, besides it can be lined with the tissue of the curtain itself.

**[0062]** The system is applied both to opening and closing sliding curtain with whip, rope scrolling curtains and to curtains with vertical bands, as shown on the figure 16.

**[0063]** The invention, certainly, is not limited, to the representation of the figures, but can receive perfections and modifications from men skilled in the art, without going out of the patent frames.

**[0064]** The present invention permits numerous advantages and, particularly, allows to overcome the difficulties that could not be superated using the systems that are actually in commerce.

## Claims

1. Universal system for curtain holders constituted by an extrudate aliminium profile containing interchangeable ornamental decorative elements **characterized by** fact that said extrudate aliminium profile presents at least two channels (one posterior and one superior having a "C" form) and a hollow in the anterior part to receive the decorative ornamental element, that said channels are used to receive the angular joints, the elements of fixture to the wall or to the ceiling and the chases for the double, triple or quadruple curtain rods assembly.
2. Universal system for curtain holders as to claim 1 **characterized by** the fact that said profile presents a third anterior channel of closed rectangular form which is used to receive the mounts of fixture to the wall or ceiling and the angular joints.
3. Universal system for curtain holders as to claim 1 **characterized by** the fact that said profile presents in the lower part a grooved guide for the curtain holders slides.
4. Universal system or curtain holders as to one of the previous claims **characterized by** the fact that each of the mounts of the fixture to the wall is formed by the anchorage plate having an insertion element; said anchorage plate must be fixed to the wall and the insertion element must be introduced in the profile channel to hold it.
5. Universal system for curtain holders as to the previous claim **characterized by** the fact that said anchorage plate presents a regulation guide which permits to settle perfectly the height of the insertion element and, consequently, of the profile; the insertion element has a slide/blockage system which can slide inside the guide and be blocked on the desired height.
6. Universal system for curtain holders as to one of the claims 1, 2 or 3 **characterized by** the fact that said profile is fixed on the ceiling using the superior channel; in said superior channel the mounts are inserted and by means of screws introduced in the predisposed holes remain fixed to the ceiling.
7. Universal system for curtain holders as to one of the previous claims **characterized by** the fact that the profile is holded by intermediate holders; said intermediate holders have an anchorage plate and an insertion element which is introduced in the posterior channel of the extrudate aluminium profile.
8. Universal system for curtain holders as to the previous claim **characterized by** the fact that said anchorage plate has a regulation guide and a slide/blockage system for a perfect settling of the intermediate holders height.
9. Universal system for curtain holders as to one of the previous claims **characterized by** the fact that said system presents a frontal profile and lateral profiles which are fixed one with another by the angular joints.
10. Universal system for curtain holders as to the previous claim **characterized by** the fact that the angular joints are variable.
11. Universal system for curtain holders as to the claim 9 **characterized** caratterizzato by the fact that the angular joints are fixed.
12. Universal system for curtain holders as to the previous claim **characterized by** the fact that said fixed angular joint presents in the lower part a guide for the curtain rod slides which joins perfectly with the guides of lateral profiles and frontal profile.
13. Universal system for curtain holders as to the previous claim **characterized by** the fact that said fixed angular joint presents in the frontal part a hollow adopted to receive an ornamental decorative element, that the hollow and the ornamental decorative element present on the fixed angular joint are identical to the hollow and to the ornamental decorative element present on the profiles and form a unique complex with them.
14. Universal system for curtain holders as to a previous claim **characterized by** the fact that said fixed angular joint keys in the profiles that it must connect by means of the insertion elements which are introduced in all the channels or in a couple of channels.
15. Universal system for curtain holders as to one of the previous claims **characterized by** the fact that few frontal profiles are mounted on two lateral profiles perpendicular to frontal profiles by means of chases constituted by an insertion plate which is introduced into the posterior channel of two perpendicular lateral profiles and by an insertion element which is introduced into posterior channel or into the anterior channel of the frontal profiles to realize a double, triple or quadruple curtain.
16. Universal system for curtain holders as to one of the previous claims **characterized by** the fact that ornamental decorative elements are fixed to the profile with a "swallow tail" system which presumes a swallow-tail groove present on the anterior side of profile hollow and a swallow-tail mount which is present on the posterior side of the decorative ornamental element.

ment.

17. Universal system for curtain holders as to one of the claims from 1 to 15 **characterized by** the fact that ornamental decorative elements are fixed to the profile with a "swallow tail" system which presumes a swallow-tail mount present on the anterior side of profile hollow and a swallow-tail groove which is present on the posterior side of the decorative ornamental element. 5  
10
  
18. Universal system for curtain holders as to one of the claims from 1 to 15 **characterized by** the fact that the ornamental decorative elements are fixed with magnetic systems, with velcro assembly systems or with bonding systems. 15
  
19. Universal system for curtain holders as to one of the claims from 16 to 18 **characterized by** the fact that the decorative ornamental elements are solid. 20
  
20. Universal system for curtain holders as to one of the claims from 1 to 15 **characterized by** the fact that the ornamental decorative elements are formed by a lamina, suitably shaped, which present the hook elements keyed with the other hook elements present in the profile hollow. 25
  
21. Universal system for curtain holders as to the claim 20 **characterized by** the fact that the ornamental decorative elements are made of any manufactured, decorated or, anyway, coloured material. 30
  
22. Universal system for curtain holders as to the claim 20 **characterized by** the fact that the ornamental decorative elements are lined with the tissue of the tenting itself. 35
  
23. Universal system for curtain holders as to a claim 1, 2 or 3 **characterized by** the fact that the profile is closed on its ends by a plate having the same shape of the profile. 40
  
24. Universal system for curtain holders as to the claim 23 **characterized by** the fact that said plate has the holes and can be screwed by means of the screws to the correspondent threaded holes present on the said profile. 45
  
25. Universal system for curtain holders as to the claim 23 **characterized by** the fact that said plate has key elements which are inserted in the channels of said profile. 50

55

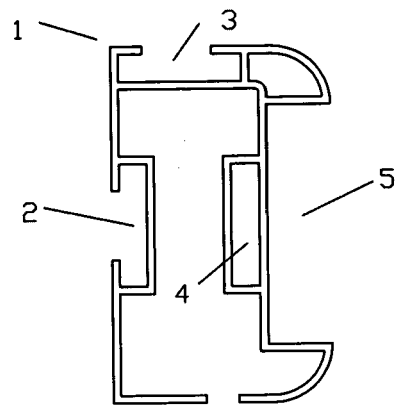

Fig. 1

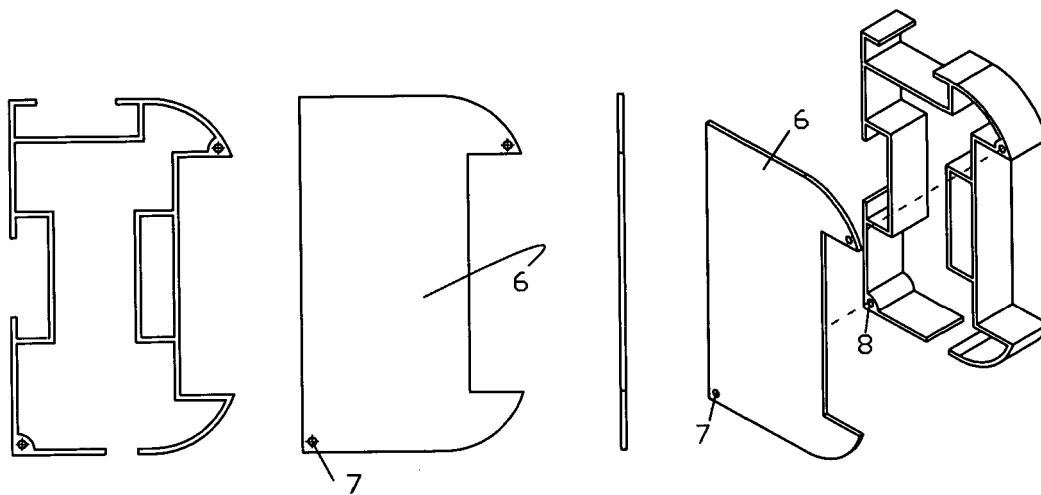

Fig. 2

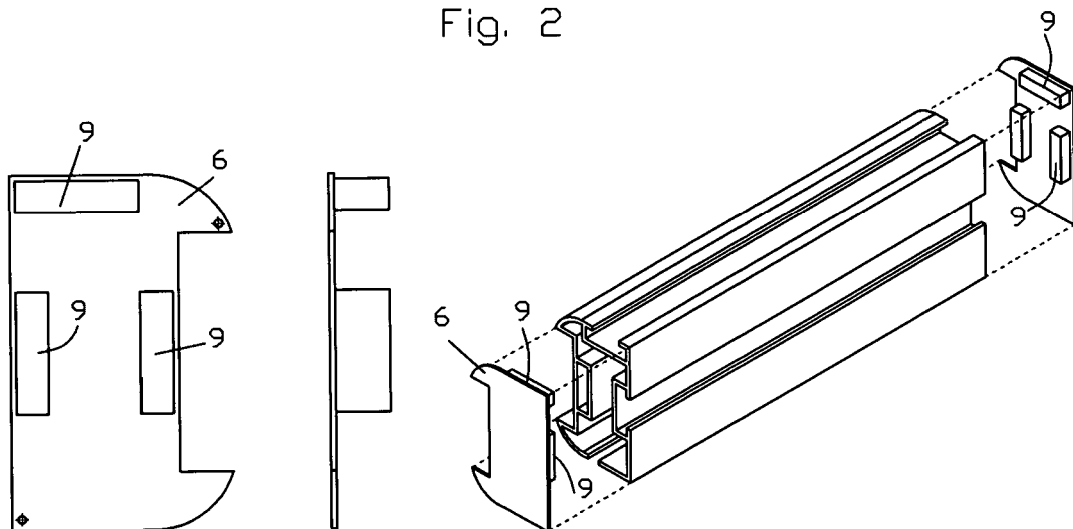

Fig. 3

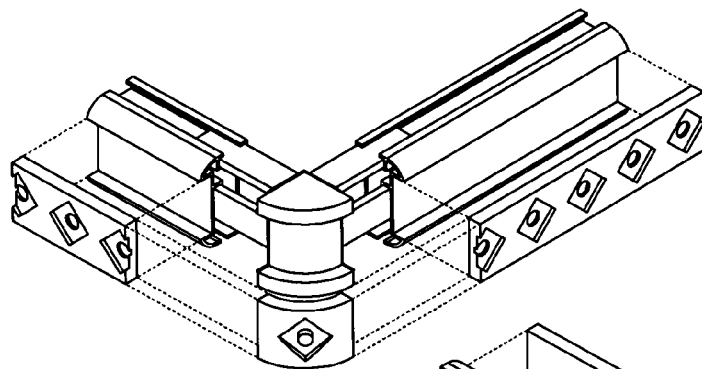

Fig. 4a

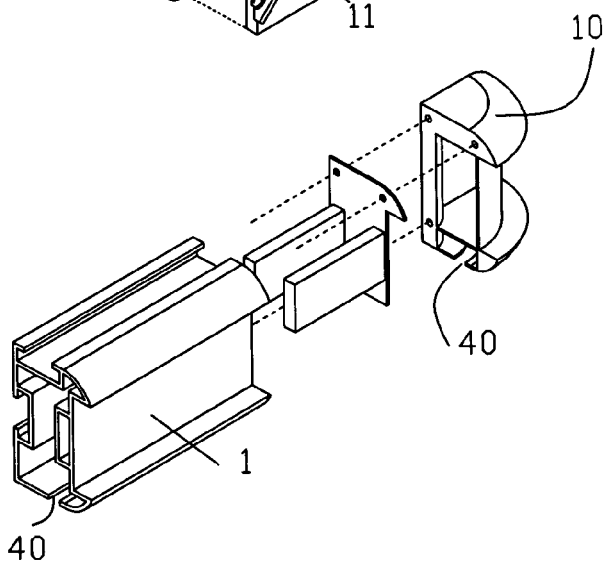
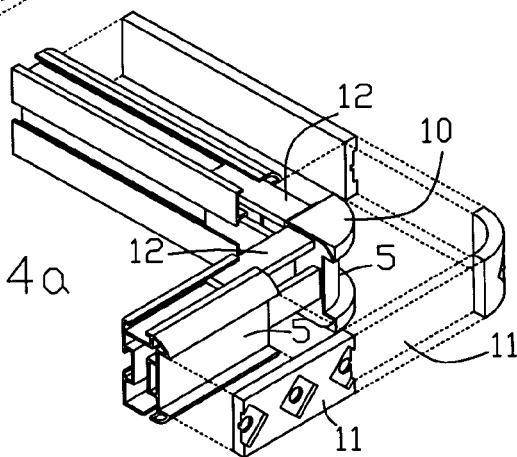
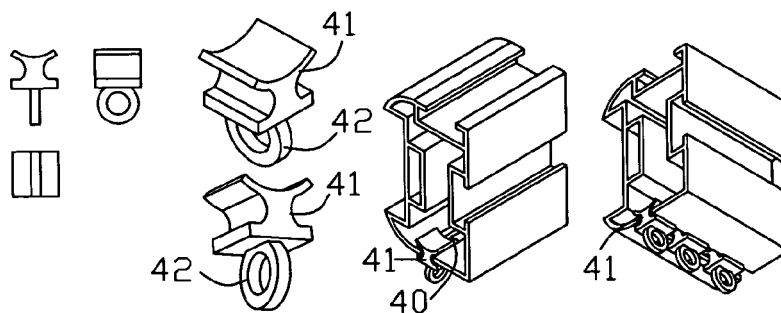

Fig. 4b





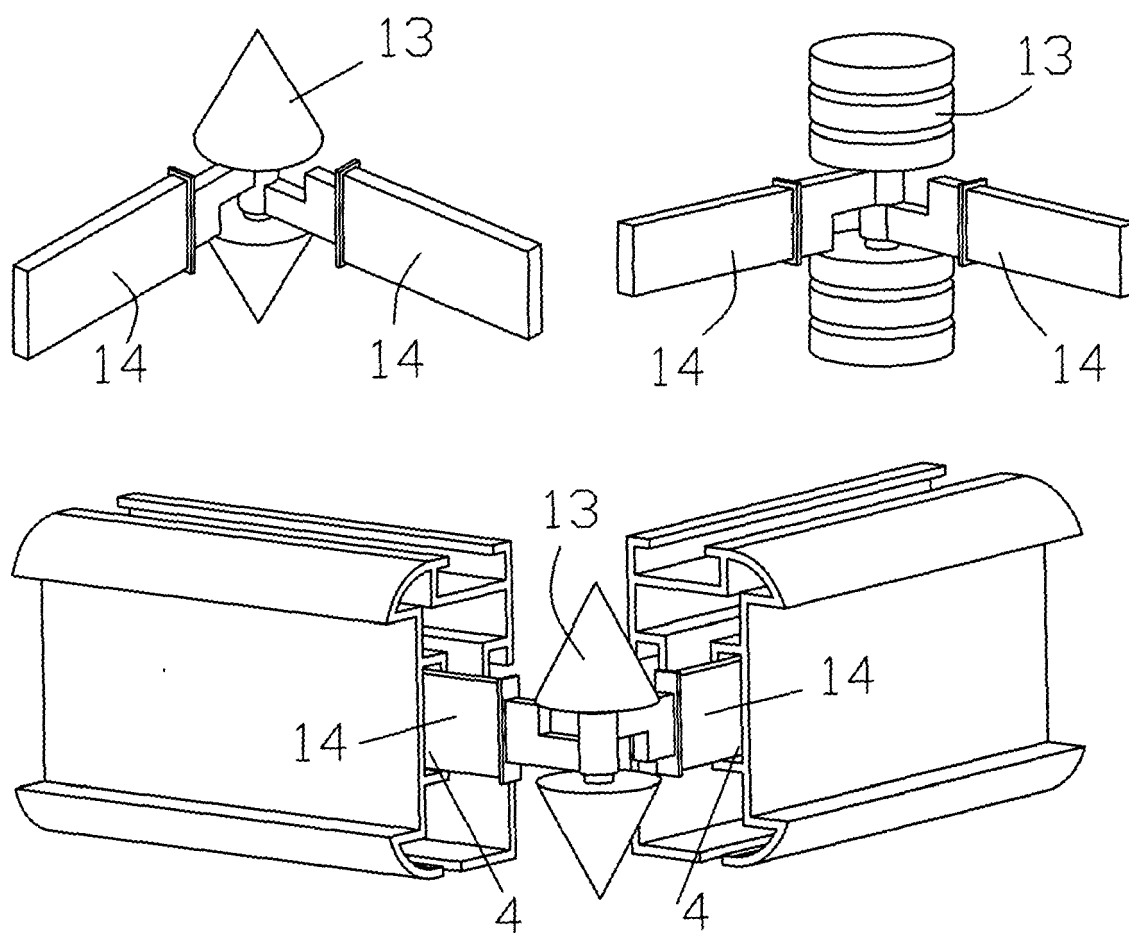

Fig. 5

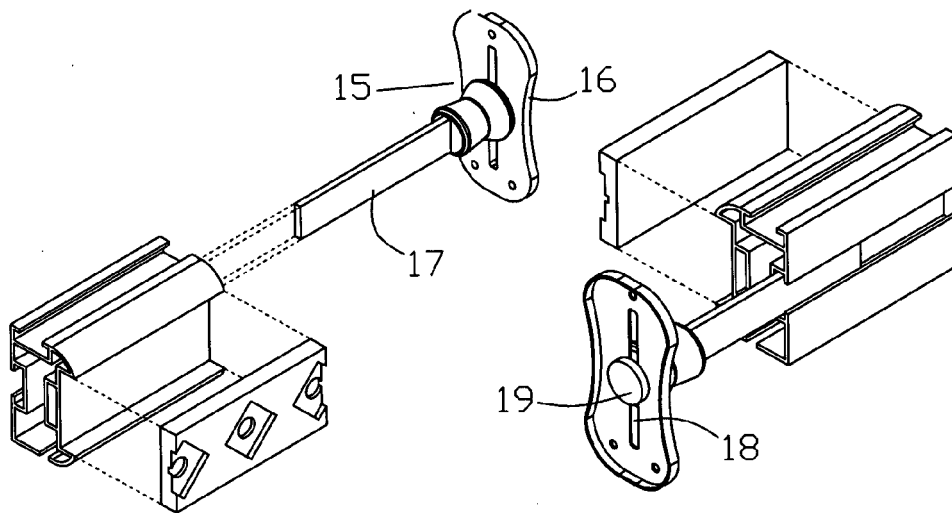

Fig. 6

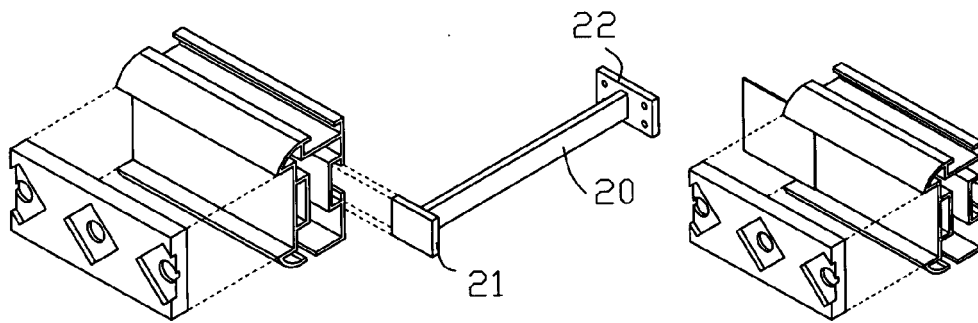

Fig. 7

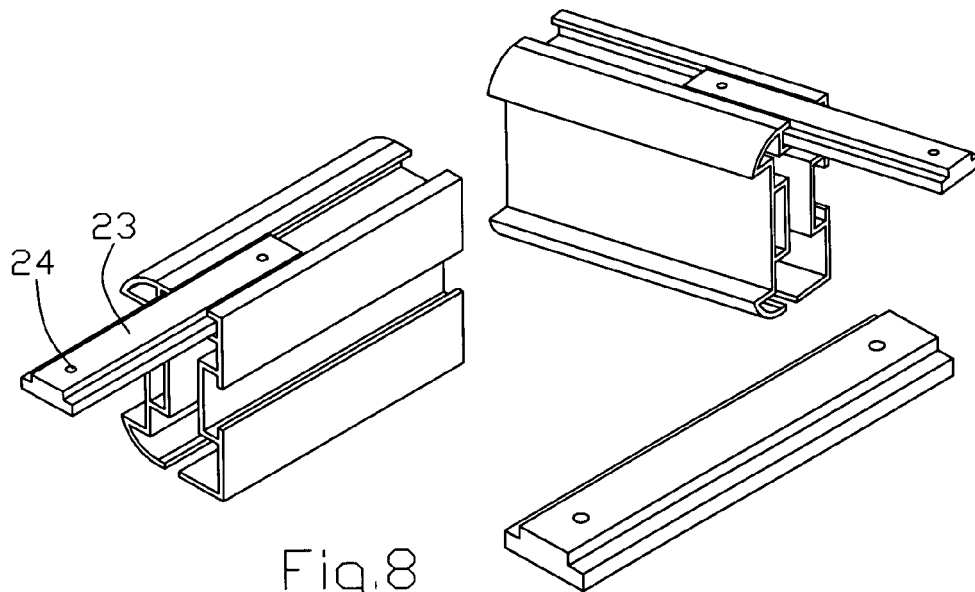

Fig. 8

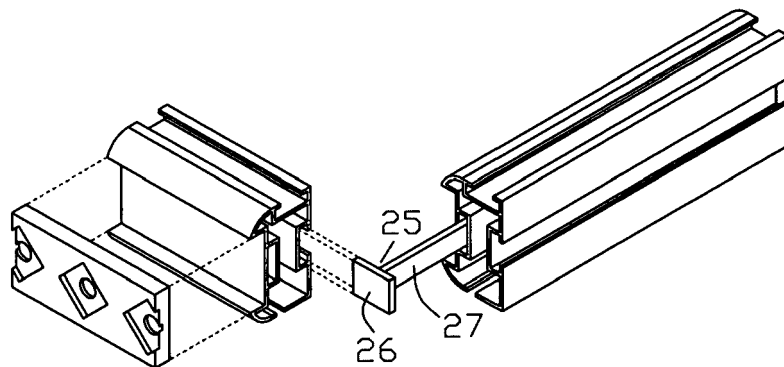

Fig. 9

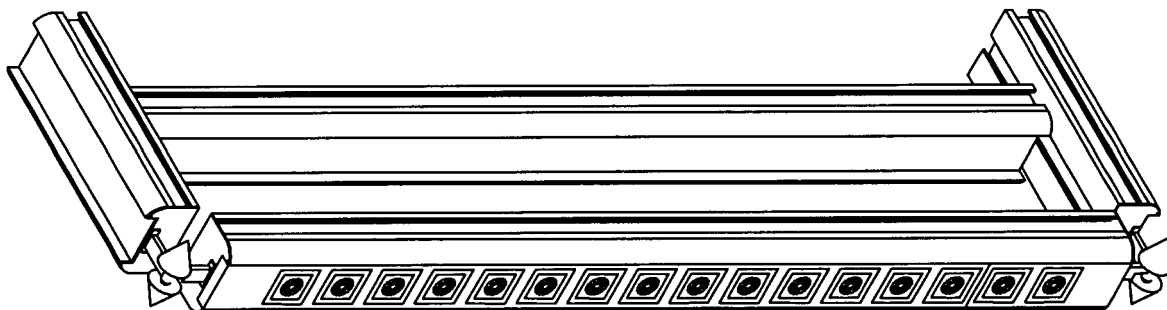
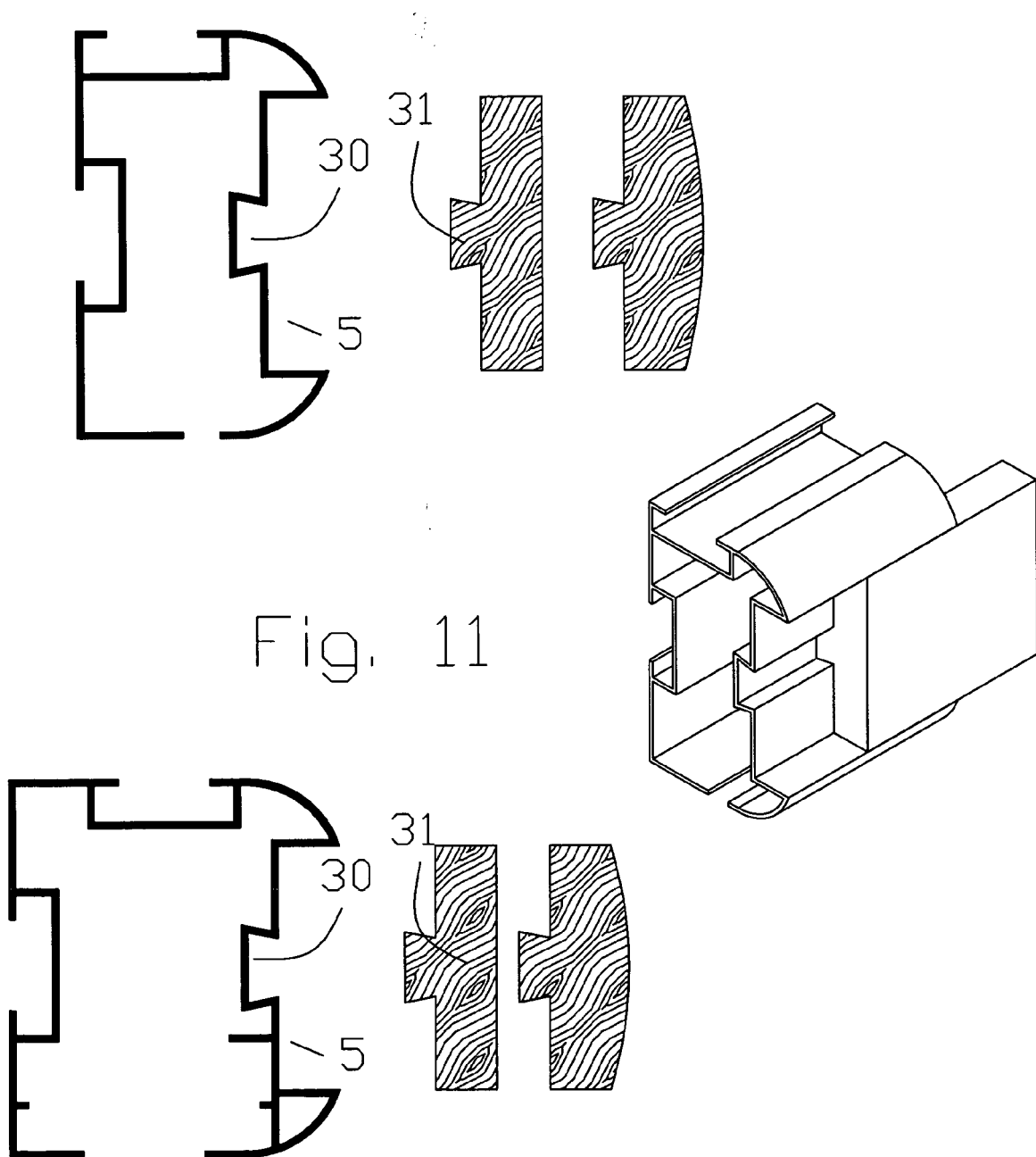

Fig. 10



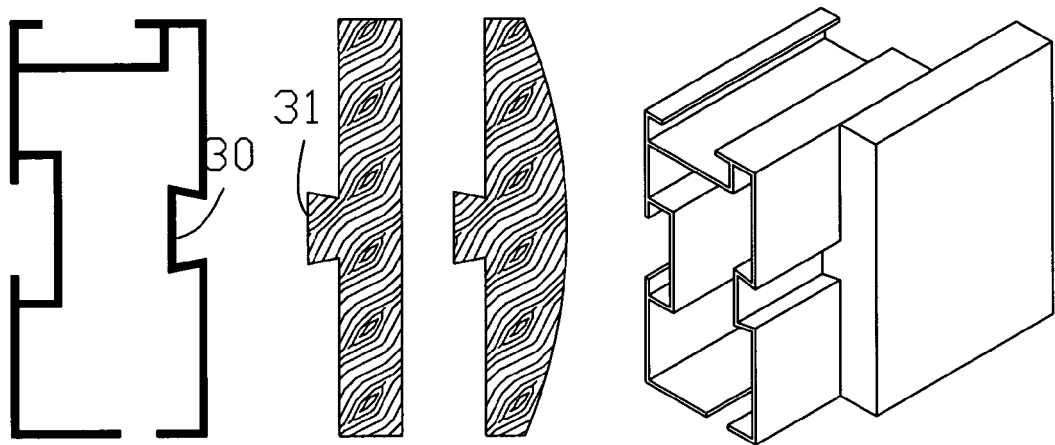
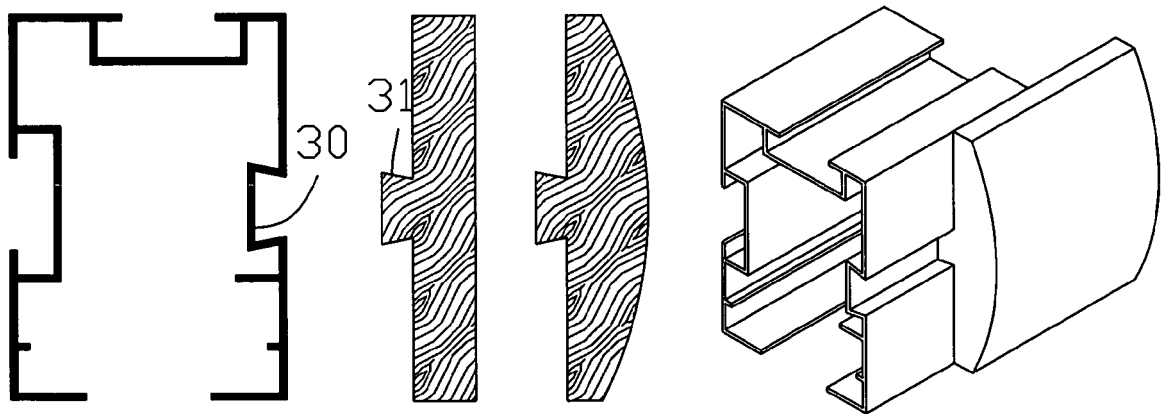

Fig. 12



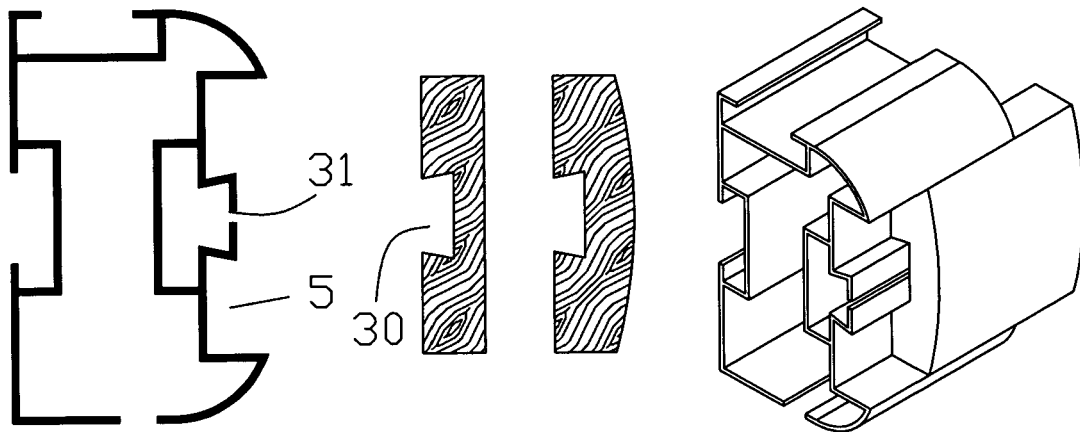
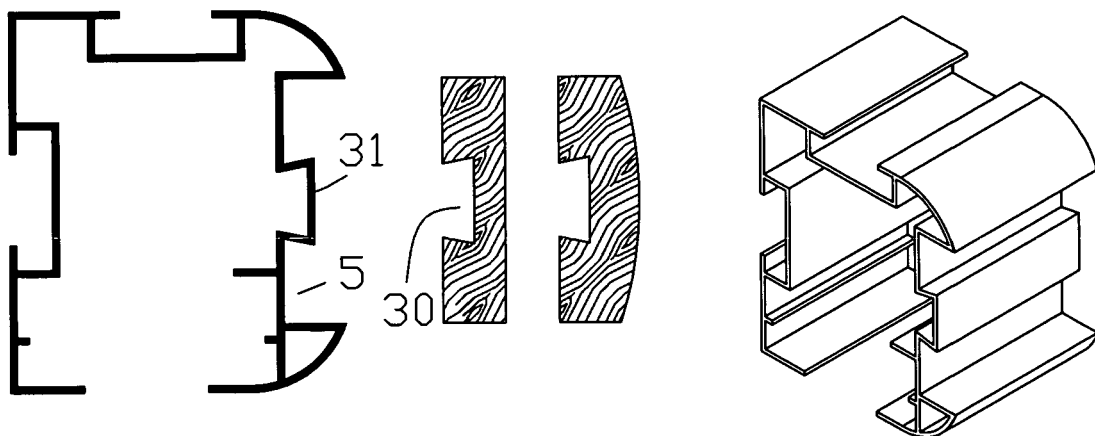

Fig. 13



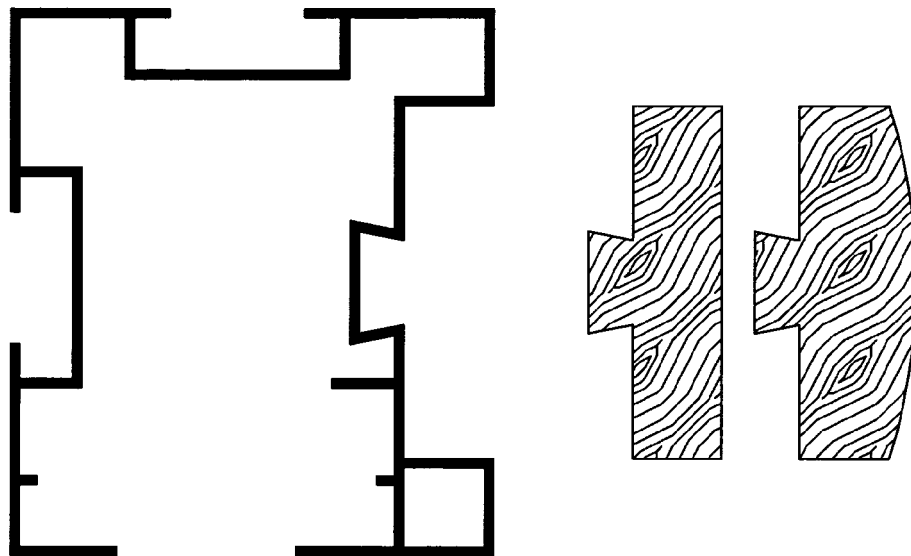
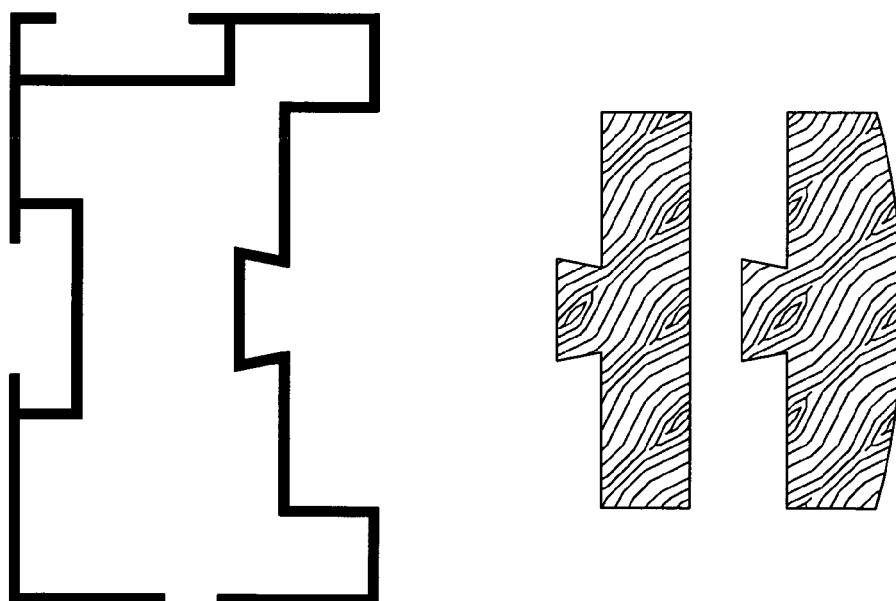

Fig. 14



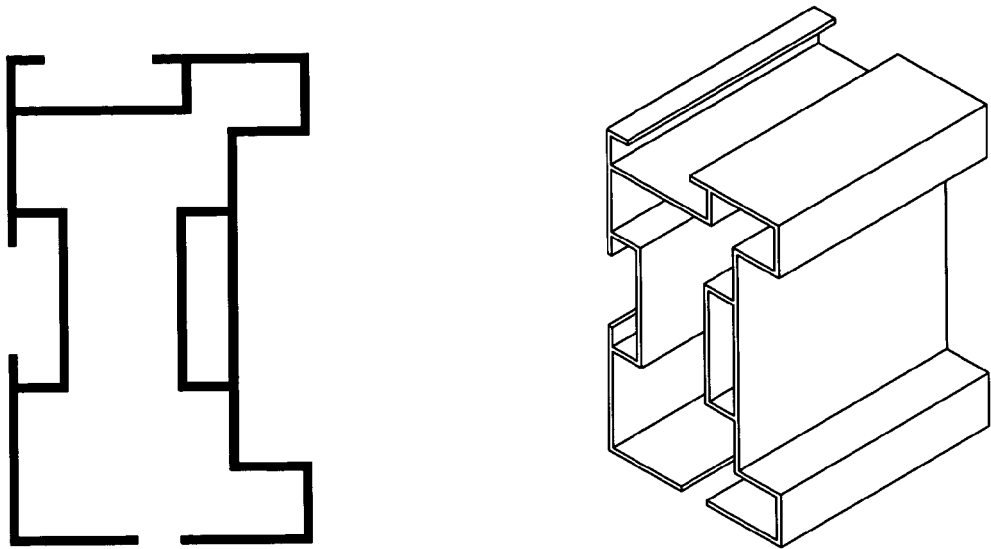
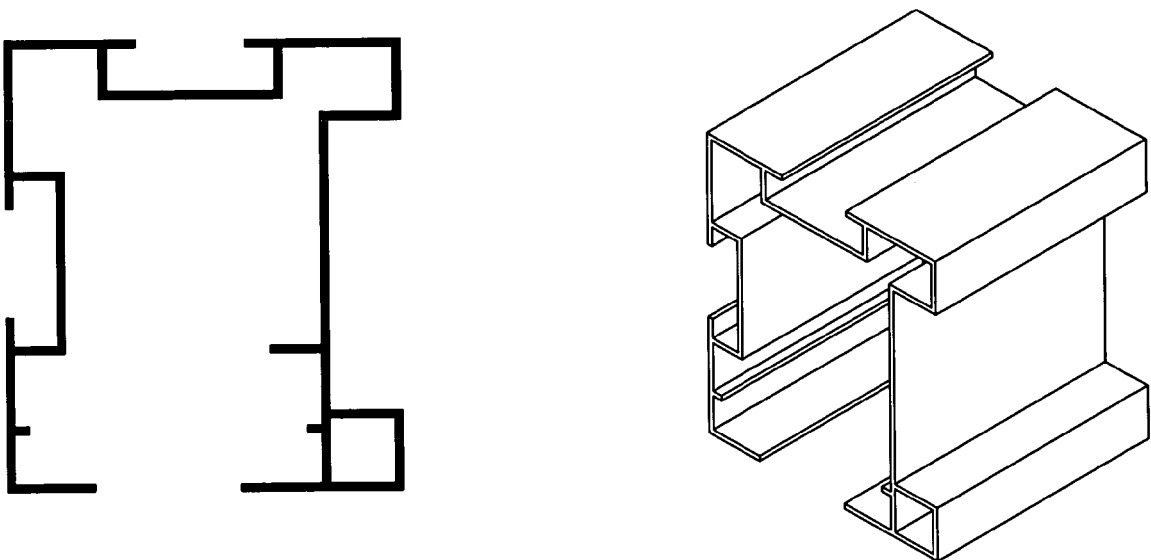

Fig. 15





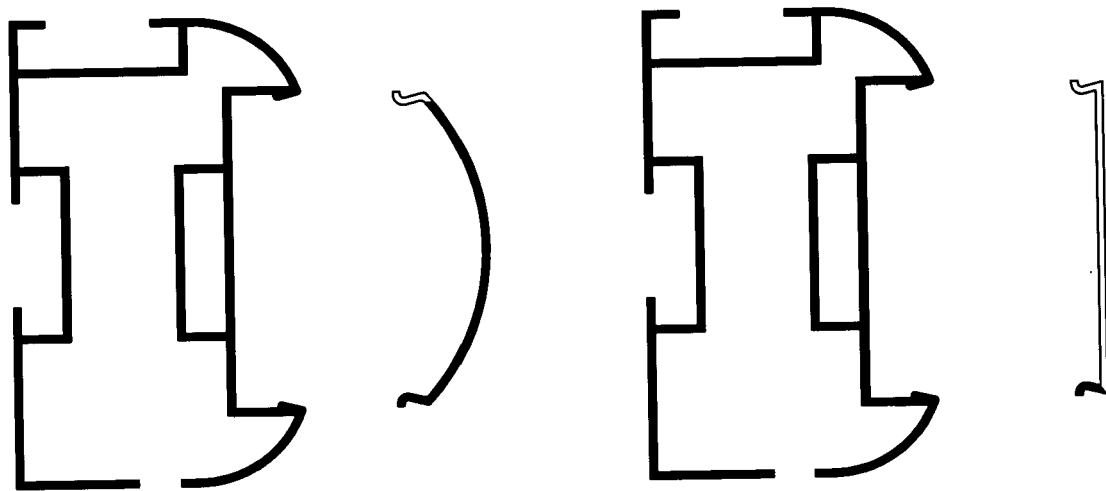
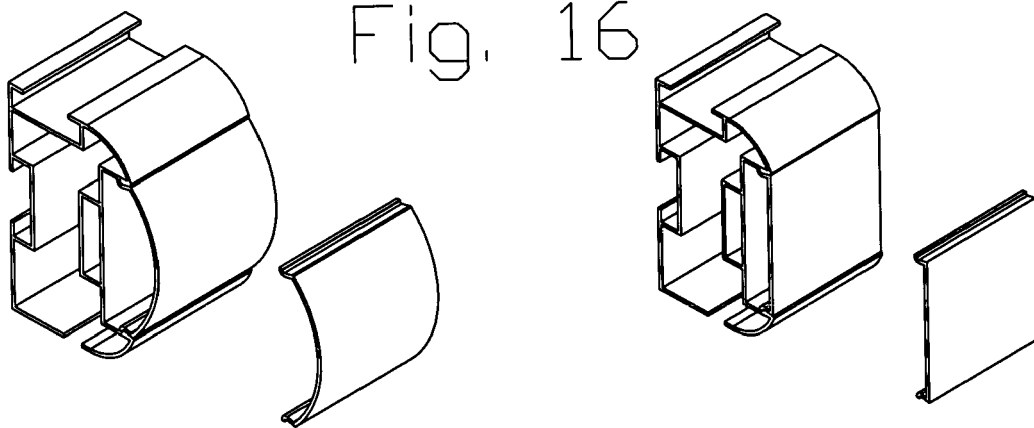

Fig. 16





European Patent  
Office

# EUROPEAN SEARCH REPORT

Application Number  
EP 05 42 5429

DOCUMENTS CONSIDERED TO BE RELEVANT			
Category	Citation of document with indication, where appropriate, of relevant passages	Relevant to claim	CLASSIFICATION OF THE APPLICATION (IPC)
Y	US 6 532 625 B1 (STONE PAM) 18 March 2003 (2003-03-18) * column 2, lines 41,42; figures 2,3,5,7 *	1	INV. A47H1/04 A47H2/00
Y	US 6 094 796 A (BIRO ET AL) 1 August 2000 (2000-08-01) * figure 1 *	1	
Y	GB 2 225 525 A (* COOPER INDUSTRIES INC) 6 June 1990 (1990-06-06) * the whole document *	1	
			TECHNICAL FIELDS SEARCHED (IPC)
			A47H
The present search report has been drawn up for all claims			
Place of search Munich		Date of completion of the search 20 March 2006	Examiner Stern, C
<p>CATEGORY OF CITED DOCUMENTS</p> <p>X : particularly relevant if taken alone Y : particularly relevant if combined with another document of the same category A : technological background O : non-written disclosure P : intermediate document</p> <p>T : theory or principle underlying the invention E : earlier patent document, but published on, or after the filing date D : document cited in the application L : document cited for other reasons</p> <p>&amp; : member of the same patent family, corresponding document</p>			

1

EPO FORM 1503 03.92 (P04C01)

**ANNEX TO THE EUROPEAN SEARCH REPORT  
ON EUROPEAN PATENT APPLICATION NO.**

EP 05 42 5429

This annex lists the patent family members relating to the patent documents cited in the above-mentioned European search report.  
The members are as contained in the European Patent Office EDP file on  
The European Patent Office is in no way liable for these particulars which are merely given for the purpose of information.

20-03-2006

Patent document cited in search report	Publication date	Patent family member(s)	Publication date
US 6532625	B1	18-03-2003	NONE
US 6094796	A	01-08-2000	US 6234233 B1 22-05-2001 US 6629481 B1 07-10-2003
GB 2225525	A	06-06-1990	AU 608446 B2 28-03-1991 AU 3596389 A 07-06-1990 CA 1295232 C 04-02-1992 ES 2017400 A6 01-02-1991 IT 1230406 B 21-10-1991

**REFERENCES CITED IN THE DESCRIPTION**

*This list of references cited by the applicant is for the reader's convenience only. It does not form part of the European patent document. Even though great care has been taken in compiling the references, errors or omissions cannot be excluded and the EPO disclaims all liability in this regard.*

**Patent documents cited in the description**

- IT 1230406 B [0003]