



(12) **EUROPEAN PATENT APPLICATION**

(88) Date of publication A3:
01.07.2009 Bulletin 2009/27

(51) Int Cl.:
B62J 7/04 (2006.01)

(43) Date of publication A2:
11.04.2007 Bulletin 2007/15

(21) Application number: **06255167.6**

(22) Date of filing: **06.10.2006**

(84) Designated Contracting States:
AT BE BG CH CY CZ DE DK EE ES FI FR GB GR HU IE IS IT LI LT LU LV MC NL PL PT RO SE SI SK TR

Designated Extension States:
AL BA HR MK RS

(30) Priority: **07.10.2005 JP 2005294673**
28.08.2006 JP 2006231304

(71) Applicant: **Yamaha Hatsudoki Kabushiki Kaisha Iwata-shi, Shizuoka 438-8501 (JP)**

(72) Inventor: **Taki, Atsushi Iwata-shi Shizuoka-ken 438-8501 (JP)**

(74) Representative: **Lamb, Martin John Carstairs Marks & Clerk LLP 90 Long Acre London WC2E 9RA (GB)**

(54) **Straddle-type vehicle**

(57) A luggage storage box 100 provided in a motorcycle 10 has a front wall section 100F, a side wall section 100S, and a rear wall section 100R. The side wall section 100S is positioned further to the outside in the vehicle width direction than a body frame 60, and the front wall section 100F is positioned beneath a seat front end section when the motorcycle 10 is viewed from the side surface thereof. In addition, the rear wall section 100R is positioned further to the rear from a rear wheel axle when the motorcycle 10 is viewed from the side surface thereof.

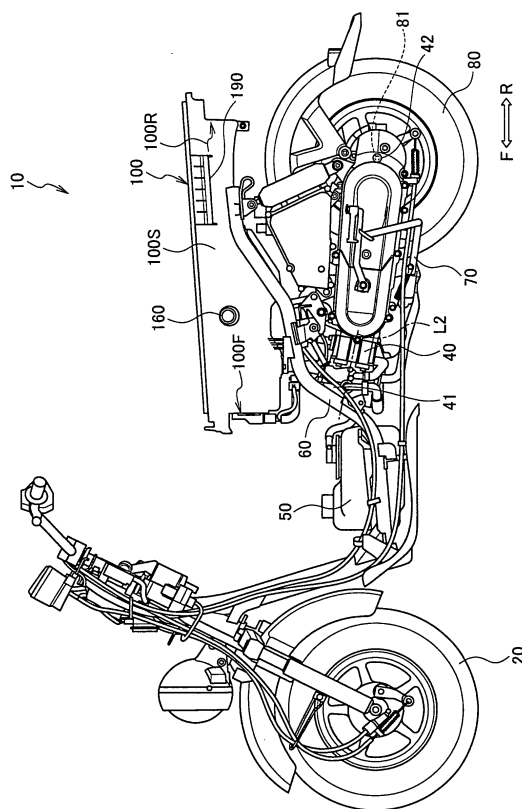

FIGURE 2



EUROPEAN SEARCH REPORT

Application Number
EP 06 25 5167

DOCUMENTS CONSIDERED TO BE RELEVANT			
Category	Citation of document with indication, where appropriate, of relevant passages	Relevant to claim	CLASSIFICATION OF THE APPLICATION (IPC)
X	JP 2001 063657 A (YAMAHA MOTOR CO LTD) 13 March 2001 (2001-03-13)	1,18, 20-29	INV. B62J7/04
Y	* abstract; figures *	2-11,13, 14	
Y	----- US 2005/155804 A1 (KAMEMIZU FUMINORI [JP] ET AL) 21 July 2005 (2005-07-21) * abstract; figures *	2-6	
Y	----- US 4 697 664 A (KOHYAMA MIKIHIRO [JP]) 6 October 1987 (1987-10-06) * abstract; figures *	7-11,13, 14	
X	----- JP 61 191486 A (YAMAHA MOTOR CO LTD) 26 August 1986 (1986-08-26) * figures *	1,15-17, 19,20, 26,27	
A	----- EP 0 262 912 A (HONDA MOTOR CO LTD [JP]) 6 April 1988 (1988-04-06) * abstract; figures *	1,2,20, 26,27	TECHNICAL FIELDS SEARCHED (IPC)
A	----- EP 1 510 450 A (SUZUKI CO LTD [JP]) 2 March 2005 (2005-03-02) * abstract; figures *	1,20,26, 27	B62J
A	----- EP 0 463 942 A (HONDA MOTOR CO LTD [JP]) 2 January 1992 (1992-01-02) * abstract; figures *	1,20,26, 27	
The present search report has been drawn up for all claims			
Place of search The Hague		Date of completion of the search 27 May 2009	Examiner Wagner, Helmut
<p>CATEGORY OF CITED DOCUMENTS</p> <p>X : particularly relevant if taken alone Y : particularly relevant if combined with another document of the same category A : technological background O : non-written disclosure P : intermediate document</p> <p>T : theory or principle underlying the invention E : earlier patent document, but published on, or after the filing date D : document cited in the application L : document cited for other reasons & : member of the same patent family, corresponding document</p>			

2
EPO FORM 1503 03.82 (P04C01)

**ANNEX TO THE EUROPEAN SEARCH REPORT
ON EUROPEAN PATENT APPLICATION NO.**

EP 06 25 5167

This annex lists the patent family members relating to the patent documents cited in the above-mentioned European search report.
The members are as contained in the European Patent Office EDP file on
The European Patent Office is in no way liable for these particulars which are merely given for the purpose of information.

27-05-2009

Patent document cited in search report		Publication date	Patent family member(s)	Publication date
JP 2001063657	A	13-03-2001	NONE	
US 2005155804	A1	21-07-2005	BR PI0405769 A	07-06-2005
			CN 1605530 A	13-04-2005
			DE 102004048480 A1	19-05-2005
			JP 2005112313 A	28-04-2005
			TW 275512 B	11-03-2007
US 4697664	A	06-10-1987	JP 61081884 A	25-04-1986
JP 61191486	A	26-08-1986	NONE	
EP 0262912	A	06-04-1988	DE 3781492 D1	08-10-1992
			DE 3781492 T2	07-01-1993
			IN 169309 A1	28-09-1991
			JP 5041988 Y2	22-10-1993
			JP 63053890 U	11-04-1988
			US 4802682 A	07-02-1989
EP 1510450	A	02-03-2005	CN 1590205 A	09-03-2005
			CN 2790890 Y	28-06-2006
			DE 602004010752 T2	11-12-2008
			JP 2005075030 A	24-03-2005
			US 2005045400 A1	03-03-2005
EP 0463942	A	02-01-1992	ES 2063464 T3	01-01-1995
			JP 4055181 A	21-02-1992