



(12) **EUROPEAN PATENT APPLICATION**

(88) Date of publication A3:
26.12.2007 Bulletin 2007/52

(51) Int Cl.:
B62K 23/02 ^(2006.01) **B62M 25/00** ^(2006.01)
B62J 6/02 ^(2006.01)

(43) Date of publication A2:
22.08.2007 Bulletin 2007/34

(21) Application number: **06026337.3**

(22) Date of filing: **19.12.2006**

(84) Designated Contracting States:
AT BE BG CH CY CZ DE DK EE ES FI FR GB GR HU IE IS IT LI LT LU LV MC NL PL PT RO SE SI SK TR
Designated Extension States:
AL BA HR MK YU

(30) Priority: **21.02.2006 US 357336**

(71) Applicants:
• **SHIMANO INC.**
Osaka 590-8577 (JP)
• **Shimano (Singapore) Pte. Ltd.**
Jurong Town 629852 (SG)

(72) Inventors:
• **Iteya, Yoshihide**
Sakai City
Osaka 590-8577 (JP)
• **Tokumoto, Naoya**
Sakai City
Osaka 590-8577 (JP)
• **Hock, Kua Wei**
Jurong town
Singapore 629852 (SG)

(74) Representative: **Harrison, Robert John et al**
Sonnenberg Fortmann
Patent- & Rechtsanwälte
Postfach 33 08 65
80068 München (DE)

(54) **Bicycle shift control device with light structure**

(57) A bicycle shift control device includes a shifter housing (20), a shift control mechanism (22) and a bicycle light structure (24). The shift control mechanism (22) is coupled to the shifter housing (20). The shift control mechanism (22) is configured and arranged to control a bicycle transmission component. The bicycle light structure (24) is coupled to the shifter housing (20). The bicycle

light structure (24) includes a bicycle location light that is arranged and configured to project light outwardly from the shifter housing (20) at a location remote from a gear position indicator (26). Preferably, the bicycle light structure (24) is also configured and arranged to illuminate the gear position indicator (26) at a location remote from the light projecting outwardly from the shifter housing (20).

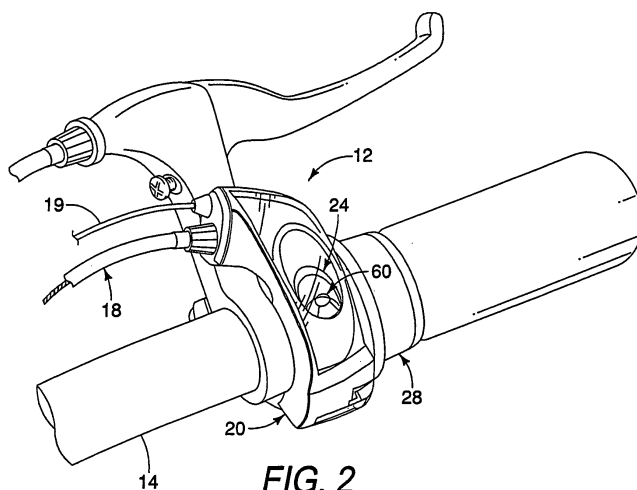

FIG. 2



European Patent
Office

EUROPEAN SEARCH REPORT

Application Number
EP 06 02 6337

DOCUMENTS CONSIDERED TO BE RELEVANT			
Category	Citation of document with indication, where appropriate, of relevant passages	Relevant to claim	CLASSIFICATION OF THE APPLICATION (IPC)
Y	US 6 204 752 B1 (KISHIMOTO HITOSHI [JP]) 20 March 2001 (2001-03-20) * column 5, line 53 - line 65; claims; figures *	1-10	INV. B62K23/02 B62M25/00 B62J6/02
Y	US 2004/105273 A1 (TAKEDA KAZUHIRO [JP]) 3 June 2004 (2004-06-03) * paragraph [0020]; figure 3 *	1-10	
Y	EP 0 744 334 A (SHIMANO KK [JP]) 27 November 1996 (1996-11-27) * column 5, line 32 - line 39; figures *	7,10	
A	WO 2005/035345 A (NIEWALD LOTHAR [DE]) 21 April 2005 (2005-04-21) * claims; figures *	1	
A	DE 101 47 283 A1 (MERLAKU KASTRIOT [DE]) 24 April 2003 (2003-04-24) * claims; figures *	1	
A	US 2 454 732 A (CATHEY ROBERT S ET AL) 23 November 1948 (1948-11-23) * column 1, line 10 - line 14; figures *	1	
A	EP 1 270 397 A (SHIMANO KK [JP]) 2 January 2003 (2003-01-02) * claims 1,12-14; figures *	1	TECHNICAL FIELDS SEARCHED (IPC) B62K B62M B62J
The present search report has been drawn up for all claims			
Place of search The Hague		Date of completion of the search 19 November 2007	Examiner Grunfeld, Michael
CATEGORY OF CITED DOCUMENTS X : particularly relevant if taken alone Y : particularly relevant if combined with another document of the same category A : technological background O : non-written disclosure P : intermediate document T : theory or principle underlying the invention E : earlier patent document, but published on, or after the filing date D : document cited in the application L : document cited for other reasons & : member of the same patent family, corresponding document			

3
EPO FORM 1503 03.82 (P04C01)

**ANNEX TO THE EUROPEAN SEARCH REPORT
ON EUROPEAN PATENT APPLICATION NO.**

EP 06 02 6337

This annex lists the patent family members relating to the patent documents cited in the above-mentioned European search report. The members are as contained in the European Patent Office EDP file on
The European Patent Office is in no way liable for these particulars which are merely given for the purpose of information.

19-11-2007

Patent document cited in search report		Publication date	Patent family member(s)	Publication date
US 6204752	B1	20-03-2001	CN 1304850 A	25-07-2001
			DE 60025145 T2	31-08-2006
			EP 1103454 A2	30-05-2001
			JP 3534694 B2	07-06-2004
			JP 2001187593 A	10-07-2001
			TW 472011 B	11-01-2002

US 2004105273	A1	03-06-2004	EP 1410982 A1	21-04-2004
			JP 3819894 B2	13-09-2006
			JP 2004136879 A	13-05-2004
			TW 267468 B	01-12-2006

EP 0744334	A	27-11-1996	CN 1144761 A	12-03-1997
			DE 69624620 D1	12-12-2002
			DE 69624620 T2	03-07-2003
			JP 3449577 B2	22-09-2003
			JP 8318888 A	03-12-1996

WO 2005035345	A	21-04-2005	NONE	

DE 10147283	A1	24-04-2003	NONE	

US 2454732	A	23-11-1948	NONE	

EP 1270397	A	02-01-2003	CN 1394787 A	05-02-2003
			CZ 20022274 A3	12-02-2003
			DE 60217228 T2	04-10-2007
			JP 3573723 B2	06-10-2004
			JP 2003011879 A	15-01-2003
			TW 581738 B	01-04-2004
			US 2003001357 A1	02-01-2003
