



(12) **EUROPEAN PATENT APPLICATION**

(88) Date of publication A3:
18.02.2009 Bulletin 2009/08

(51) Int Cl.:
E05D 3/02 (2006.01) **E05D 5/02** (2006.01)
E05D 11/00 (2006.01) **E06B 7/36** (2006.01)

(43) Date of publication A2:
29.08.2007 Bulletin 2007/35

(21) Application number: **06125172.4**

(22) Date of filing: **30.11.2006**

(84) Designated Contracting States:
AT BE BG CH CY CZ DE DK EE ES FI FR GB GR HU IE IS IT LI LT LU LV MC NL PL PT RO SE SI SK TR
Designated Extension States:
AL BA HR MK RS

(71) Applicant: **Stilopress S.r.L.**
25068 Sarezzo BS (IT)

(72) Inventor: **GHIDINI, Ruggero**
25068, Sarezzo (Brescia) (IT)

(74) Representative: **Crippa, Paolo Ernesto et al**
Jacobacci & Partners S.p.A.
Piazza della Vittoria, 11
25122 Brescia (IT)

(30) Priority: **28.02.2006 IT BS20060043**

(54) **Hinge for doors**

(57) The present invention relates to a hinge (10) comprising a first element (20) and a second element (30). The first element, to be fixed to a jamb (2), comprises a first appendix (22) coupled to a pin (40) that defines a hinge axis (X). The second element, to be fixed to a door (3), comprises at least a second appendix (32) coupled to the same pin. The two elements are mutually pivoted

about the hinge axis. The two appendices define sliding surfaces (47) suitable for transmitting forces along the hinge axis. The second element further comprises a fairing (34) suitable for covering, in a front view of the closed hinge, the first appendix and the sliding surfaces. The invention also relates to a furnishing item comprising at least one hinge described above.

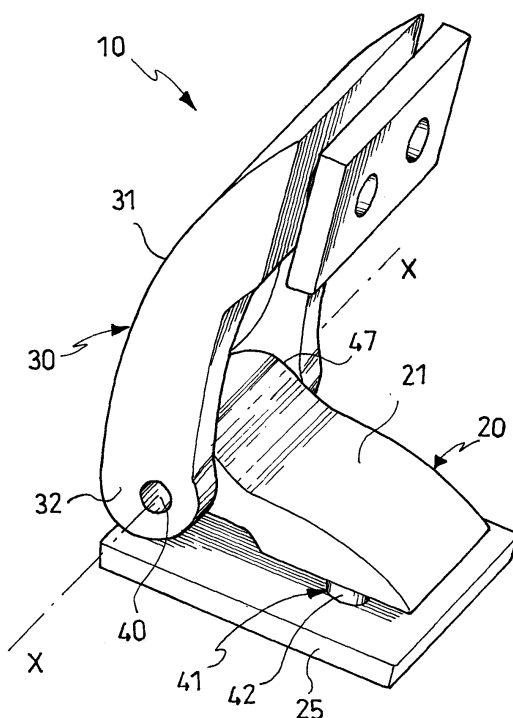

FIG.1



EUROPEAN SEARCH REPORT

Application Number
EP 06 12 5172

DOCUMENTS CONSIDERED TO BE RELEVANT			
Category	Citation of document with indication, where appropriate, of relevant passages	Relevant to claim	CLASSIFICATION OF THE APPLICATION (IPC)
X	GB 2 401 146 A (EPWIN GROUP PLC [GB] EPWIN GROUP PLC [GB]; EPWIN GROUP LTD [GB]) 3 November 2004 (2004-11-03) * page 3, line 20 - line 24 * * page 7, line 1 - line 5 * * page 7, line 21 - line 23; figures 1b-5 *	1-14, 16-19	INV. E05D3/02 E05D5/02 E05D11/00 E06B7/36
X	GB 290 200 A (BUDD EDWARD G MFG CO) 9 August 1928 (1928-08-09) * page 2 - page 3; figures 7-10 *	1,7-12, 15,16	
X	GB 381 732 A (JOSEPH SOSS) 13 October 1932 (1932-10-13) * claim 1; figures 1-5 *	1,2,7,8, 10,11, 15,17-19	
A	EP 1 193 360 A (DORMA GMBH & CO KG [DE]) 3 April 2002 (2002-04-03) * column 5, line 21 - line 22 * * column 5, line 38 - line 44 * * figure 1 *	9,12,13	
The present search report has been drawn up for all claims			TECHNICAL FIELDS SEARCHED (IPC) E05D
Place of search The Hague		Date of completion of the search 13 January 2009	Examiner Koulo, G
CATEGORY OF CITED DOCUMENTS X : particularly relevant if taken alone Y : particularly relevant if combined with another document of the same category A : technological background O : non-written disclosure P : intermediate document		T : theory or principle underlying the invention E : earlier patent document, but published on, or after the filing date D : document cited in the application L : document cited for other reasons & : member of the same patent family, corresponding document	

6
EPO FORM 1503 03/02 (P04C01)

**ANNEX TO THE EUROPEAN SEARCH REPORT
ON EUROPEAN PATENT APPLICATION NO.**

EP 06 12 5172

This annex lists the patent family members relating to the patent documents cited in the above-mentioned European search report. The members are as contained in the European Patent Office EDP file on
The European Patent Office is in no way liable for these particulars which are merely given for the purpose of information.

13-01-2009

Patent document cited in search report		Publication date	Patent family member(s)	Publication date
GB 2401146	A	03-11-2004	NONE	
GB 290200	A	09-08-1928	NONE	
GB 381732	A	13-10-1932	NONE	
EP 1193360	A	03-04-2002	DE 10049244 A1	25-04-2002