



(12) **EUROPEAN PATENT APPLICATION**

(88) Date of publication A3:
26.09.2007 Bulletin 2007/39

(51) Int Cl.:
E01B 7/02 (2006.01)

(43) Date of publication A2:
12.09.2007 Bulletin 2007/37

(21) Application number: **07108998.1**

(22) Date of filing: **26.01.2005**

(84) Designated Contracting States:
DE FR GB IT

(72) Inventor: **Biagiotti, Maurizio**
56124, Pisa (IT)

(30) Priority: **17.02.2004 US 780116**

(74) Representative: **Bedford, Grant Richard**
London Patent Operation
GE International Inc.
15 John Adam Street
London WC2N 6LU (GB)

(62) Document number(s) of the earlier application(s) in accordance with Art. 76 EPC:
05712112.1 / 1 718 803

(71) Applicant: **General Electric Company**
Schenectady, NY 12345 (US)

(54) **Switch machine with switch point connectors**

(57) A switch machine for a railroad switch provided with two switch points (A1,A2), including two operating rods (4,5) extending from the housing (1) to the switch points; a shifting body within the housing, capable of sliding relative to the housing to simultaneously displace the

operating rods (4,5); an engagement device within the housing (1) for selectively engaging the operating rods (4,5) to the housing (1) at the two end stroke points; and a pivoting connector between each operating rod and its associated switch point.

FIG. 1

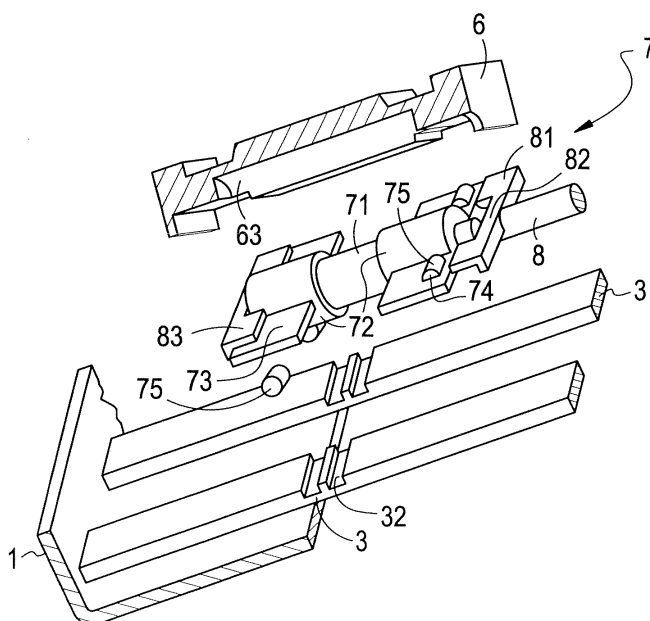



European Patent
Office

EUROPEAN SEARCH REPORT

Application Number
EP 07 10 8998

DOCUMENTS CONSIDERED TO BE RELEVANT			
Category	Citation of document with indication, where appropriate, of relevant passages	Relevant to claim	CLASSIFICATION OF THE APPLICATION (IPC)
A	US 5 195 703 A (KAIS ET AL) 23 March 1993 (1993-03-23) * column 5, line 8 - column 6, line 37; figure 7 *	1-6	INV. E01B7/02
A	FR 828 268 A (SOCIETE ANONYME DE CONSTRUCTION D'AIGUILLAGES ET APPAREILS DE VOIE D'A) 13 May 1938 (1938-05-13) * figure 1 *	1-6	
A	FR 1 279 988 A (S. N. C. GRANDI ANTONIO DI DANTE GRANDI & C) 29 December 1961 (1961-12-29) * figures 1-8 *	1-6	
			TECHNICAL FIELDS SEARCHED (IPC)
			B61L E01B
The present search report has been drawn up for all claims			
Place of search Munich		Date of completion of the search 1 August 2007	Examiner Fernandez, Eva
<p>CATEGORY OF CITED DOCUMENTS</p> <p>X : particularly relevant if taken alone Y : particularly relevant if combined with another document of the same category A : technological background O : non-written disclosure P : intermediate document</p> <p>T : theory or principle underlying the invention E : earlier patent document, but published on, or after the filing date D : document cited in the application L : document cited for other reasons & : member of the same patent family, corresponding document</p>			

4
EPO FORM 1503 03.82 (P04C01)

**ANNEX TO THE EUROPEAN SEARCH REPORT
ON EUROPEAN PATENT APPLICATION NO.**

EP 07 10 8998

This annex lists the patent family members relating to the patent documents cited in the above-mentioned European search report. The members are as contained in the European Patent Office EDP file on
The European Patent Office is in no way liable for these particulars which are merely given for the purpose of information.

01-08-2007

Patent document cited in search report		Publication date	Patent family member(s)	Publication date
US 5195703	A	23-03-1993	AT 117950 T	15-02-1995
			CA 2041809 A1	05-11-1991
			DE 4014248 A1	07-11-1991
			DK 455153 T3	12-06-1995
			EP 0455153 A2	06-11-1991
			ES 2068422 T3	16-04-1995
			GR 3015483 T3	30-06-1995

FR 828268	A	13-05-1938	NONE	

FR 1279988	A	29-12-1961	NONE	
