



(11) **EP 1 837 228 A8**

(12) **CORRECTED EUROPEAN PATENT APPLICATION**

Note: Bibliography reflects the latest situation

(15) Correction information:

Corrected version no 1 (W1 A1)
Abstract

(51) Int Cl.:

B60N 2/00 (2006.01)

(48) Corrigendum issued on:

30.04.2008 Bulletin 2008/18

(43) Date of publication:

26.09.2007 Bulletin 2007/39

(21) Application number: **07110386.5**

(22) Date of filing: **13.01.2000**

(84) Designated Contracting States:

DE FR GB

(30) Priority: **14.01.1999 JP 838099**

19.02.1999 JP 4125599

23.04.1999 JP 11655199

21.05.1999 JP 14224799

03.09.1999 JP 25077099

21.09.1999 JP 26690199

12.01.2000 JP 2000003293

(62) Document number(s) of the earlier application(s) in accordance with Art. 76 EPC:

00100659.2 / 1 020 320

(71) Applicant: **Toyota Jidosha Kabushiki Kaisha**

Toyota-shi, Aichi-ken, 471-8571 (JP)

(72) Inventors:

- **Hamada, Makoto**
Toyota-shi Aichi 471-8571 (JP)
- **Sekizuka, Makoto**
Toyota-shi Aichi 471-8571 (JP)
- **Fukawatase, Osamu**
Toyota-shi Aichi 471-8571 (JP)
- **Fujimoto, Osamu**
Toyota-shi Aichi 471-8571 (JP)

(74) Representative: **TBK-Patent**

Bavariaring 4-6
80336 München (DE)

Remarks:

This application was filed on 15-06-2007 as a divisional application to the application mentioned under INID code 62.

(54) **Sitting passenger detecting apparatus and sitting passenger detecting method**

(57) A sitting passenger detecting apparatus characterized in that the apparatus comprises:

first load detecting means (342) for detecting a load added to the front portion of a seating surface of a seat (310) of a vehicle;

second load detecting means (344) for detecting a load added to the rear portion of the seating surface;

first determining means (326) for determining a fact that a passenger which is sitting on said seat is an adult when the sum of values detected by said first and second load detecting means (342,344) is not smaller than a first threshold value; and

a second determining means (326) for determining a fact that a passenger which is sitting on the seat is an adult when a value detected by said first load detecting means (342) is not smaller than a second threshold value and a value detected by said second load detecting means (344) is not smaller than a third threshold value.

FIG. 19

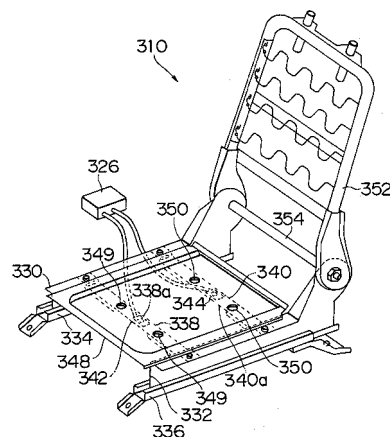

EP 1 837 228 A8