



(12) **EUROPEAN PATENT APPLICATION**

(88) Date of publication A3:
19.01.2011 Bulletin 2011/03

(51) Int Cl.:
E04F 10/06^(2006.01)

(43) Date of publication A2:
10.10.2007 Bulletin 2007/41

(21) Application number: **07104884.7**

(22) Date of filing: **26.03.2007**

(84) Designated Contracting States:
AT BE BG CH CY CZ DE DK EE ES FI FR GB GR HU IE IS IT LI LT LU LV MC MT NL PL PT RO SE SI SK TR
Designated Extension States:
AL BA HR MK RS

(30) Priority: **05.04.2006 IT PD20060127**

(71) Applicant: **PROGETTOTENDA S.p.A.**
35030 Saccolongo PD PD (IT)

(72) Inventor: **Danieli, Lorenzo**
35030 Selvazzano Dentro (PD) (IT)

(74) Representative: **Cantaluppi, Stefano et al**
Cantaluppi & Partners S.r.l.
Piazzetta Cappellato Pedrocchi, 18
35122 Padova (IT)

(54) **Roller blind with a guide element**

(57) What is described is a roller blind comprising a cassette (2) for housing a winding roller (3), on to which a blind fabric (4) is wound, an aperture (7) being formed in the cassette for the passage of the fabric in the unwinding and winding of the latter, the aperture (7) being delimited by a pair of opposing edges (7a,7b) extending in the direction of longitudinal extension of the cassette (2), and a front strip (6) which has a pair of corresponding edges (6a,6b) running longitudinally and opposed to each other and which is fixed to an end (4a) of the fabric (4) transversely opposed to the roller (3), the strip being

movable to close the aperture (7) in the cassette when the fabric (4) is wound on to the winding roller (3) in an inoperative condition. The blind comprises at least one guide element (10) fitted in the cassette (2) in a position such that it interferes with the strip (6) in the approach of the latter to the cassette, as a result of the winding of the fabric (4) on to the roller (3), in such a way as to guide the strip (6) in the closing of the aperture (7), with the longitudinal edges of the strip (6) and the cassette (2) which face each other being engaged with each other, in opposition to the flexural deformation of the strip.

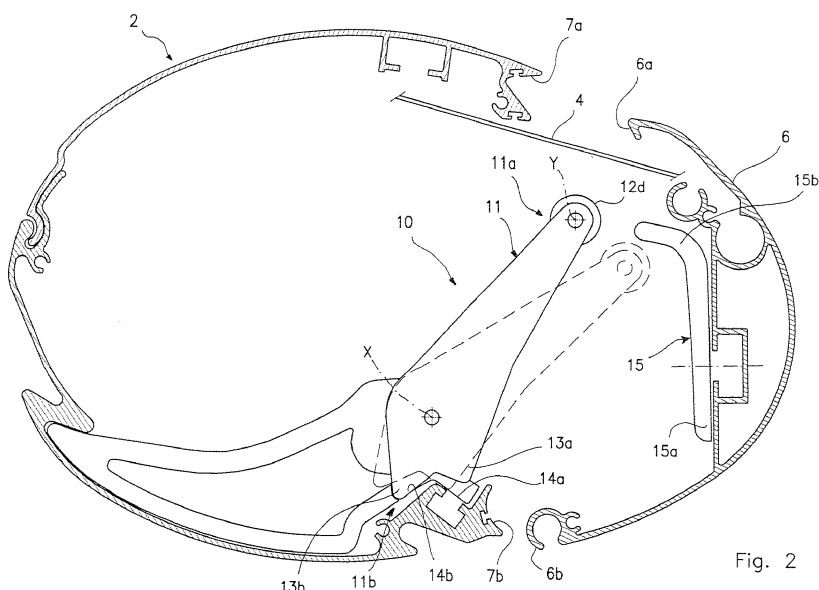

Fig. 2



EUROPEAN SEARCH REPORT

Application Number
EP 07 10 4884

DOCUMENTS CONSIDERED TO BE RELEVANT			
Category	Citation of document with indication, where appropriate, of relevant passages	Relevant to claim	CLASSIFICATION OF THE APPLICATION (IPC)
X	EP 0 665 346 A1 (WEIERMANN DIETER WEINOR [DE]) 2 August 1995 (1995-08-02)	1-3,5	INV. E04F10/06
A	* figure 1 * * column 4, line 25 - column 5, line 45 * -----	4,6-12	
X	DE 41 05 520 A1 (MARKISEN SPETTMANN GMBH [DE]) 3 September 1992 (1992-09-03) * figure 1 * * column 2, line 15 - column 3, line 5 * -----	1,4	
The present search report has been drawn up for all claims			TECHNICAL FIELDS SEARCHED (IPC)
			E04F
Place of search		Date of completion of the search	Examiner
Munich		14 December 2010	Tänzler, Ansgar
<p>CATEGORY OF CITED DOCUMENTS</p> <p>X : particularly relevant if taken alone Y : particularly relevant if combined with another document of the same category A : technological background O : non-written disclosure P : intermediate document</p> <p>T : theory or principle underlying the invention E : earlier patent document, but published on, or after the filing date D : document cited in the application L : document cited for other reasons & : member of the same patent family, corresponding document</p>			

1
EPO FORM 1503 03.82 (P04C01)

**ANNEX TO THE EUROPEAN SEARCH REPORT
ON EUROPEAN PATENT APPLICATION NO.**

EP 07 10 4884

This annex lists the patent family members relating to the patent documents cited in the above-mentioned European search report.
The members are as contained in the European Patent Office EDP file on
The European Patent Office is in no way liable for these particulars which are merely given for the purpose of information.

14-12-2010

Patent document cited in search report	Publication date	Patent family member(s)	Publication date	
EP 0665346	A1	02-08-1995	DE 4402964 A1	03-08-1995
DE 4105520	A1	03-09-1992	NONE	