



(12) **EUROPEAN PATENT APPLICATION**

(88) Date of publication A3:
09.12.2009 Bulletin 2009/50

(51) Int Cl.:
A47B 96/06 (2006.01)

(43) Date of publication A2:
17.10.2007 Bulletin 2007/42

(21) Application number: **07105960.4**

(22) Date of filing: **11.04.2007**

(84) Designated Contracting States:
AT BE BG CH CY CZ DE DK EE ES FI FR GB GR HU IE IS IT LI LT LU LV MC MT NL PL PT RO SE SI SK TR
Designated Extension States:
AL BA HR MK RS

(71) Applicant: **Ferramenta Livenza S.r.l.**
33070 Maron di Brugnera,
Pordenone (IT)

(72) Inventor: **Ferro, Renato**
33170, Pordenone (IT)

(30) Priority: **14.04.2006 IT PN20060030**
23.06.2006 IT PN20060052
05.10.2006 IT PN20060075

(74) Representative: **Giugni, Valter**
Propria S.r.l.
Via della Colonna 35
33170 Pordenone (IT)

(54) **Concealed-type support arrangement for brackets, shelves and the like**

(57) Concealed-type support arrangement for brackets, consoles, shelves, and the like, comprising a longitudinal mounting bracket (2) adapted to be attached to a wall, a support arm (3) capable of being inserted in a receptacle provided in a shelf (4), adjustment means for adjusting the position of the support arm (3) relative to the mounting bracket (2), the adjustment means comprise a movable member (5) accommodated in a housing body (6) formed by the mounting bracket (2) and adapted to be associated to the support arm (3), a first threaded

member (7) engaging the movable member (5) and adapted to cooperate with the housing body (6) to translationally displace the movable member (5) within the housing body (6) along a longitudinal axis (8) so as to adjust the position of the arm (3) along the mounting bracket (2), a second threaded member (9) engaging the movable member (5) and adapted to cooperate with the housing body (6) to cause the movable member (5) to rotate about the longitudinal axis (8) within the housing body (6) so as to adjust the inclination of the support arm (3) relative to the mounting bracket (2).

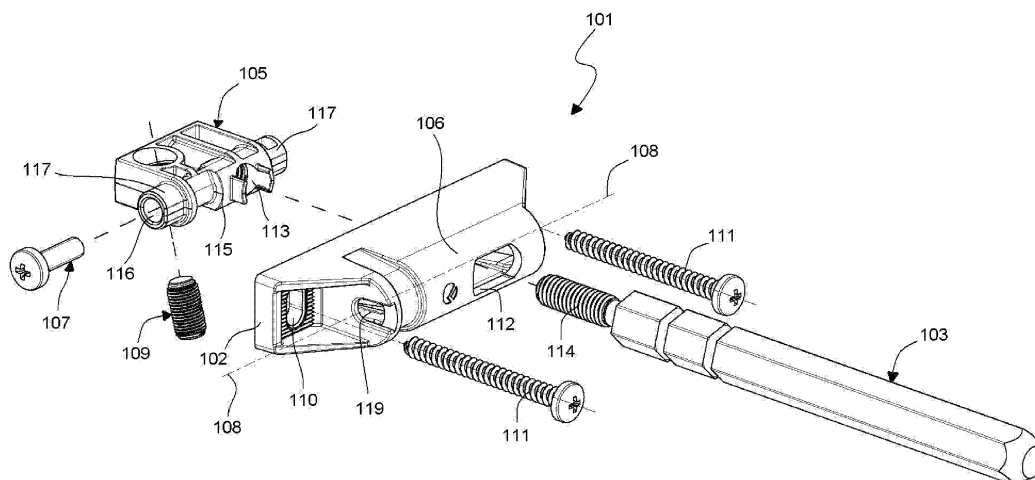

FIG. 1



EUROPEAN SEARCH REPORT

Application Number
EP 07 10 5960

DOCUMENTS CONSIDERED TO BE RELEVANT			
Category	Citation of document with indication, where appropriate, of relevant passages	Relevant to claim	CLASSIFICATION OF THE APPLICATION (IPC)
X	DE 10 2004 025126 B3 (EBB BESCHLAGTECHNIK GMBH [DE]) 29 September 2005 (2005-09-29) * abstract; figures 1-4 * * page 3, paragraph 20 * * page 3, paragraph 23 * -----	1-8,12	INV. A47B96/06
			TECHNICAL FIELDS SEARCHED (IPC)
			A47B
The present search report has been drawn up for all claims			
Place of search The Hague		Date of completion of the search 30 October 2009	Examiner Jones, Clive
<p>CATEGORY OF CITED DOCUMENTS</p> <p>X : particularly relevant if taken alone Y : particularly relevant if combined with another document of the same category A : technological background O : non-written disclosure P : intermediate document</p> <p>T : theory or principle underlying the invention E : earlier patent document, but published on, or after the filing date D : document cited in the application L : document cited for other reasons & : member of the same patent family, corresponding document</p>			

1
EPO FORM 1503 03.82 (P04C01)

