



(12) **EUROPEAN PATENT APPLICATION**

(43) Date of publication:
13.02.2008 Bulletin 2008/07

(51) Int Cl.:
D06F 58/24 ^(2006.01) **D06F 58/20** ^(2006.01)

(21) Application number: **06118596.3**

(22) Date of filing: **08.08.2006**

(84) Designated Contracting States:
AT BE BG CH CY CZ DE DK EE ES FI FR GB GR HU IE IS IT LI LT LU LV MC NL PL PT RO SE SI SK TR
Designated Extension States:
AL BA HR MK YU

(71) Applicant: **Electrolux Home Products Corporation N.V.**
1930 Zaventem (BE)

(72) Inventors:
• **Sartor, Luciano**
31015 Conegliano (Treviso) (IT)
• **Pillot, Sergio**
33087 Pasiano di Pordenone (Pordenone) (IT)

(74) Representative: **Giugni, Valter**
PROPRIA S.r.l.
P.O. Box 365
Via della Colonna, 35
33170 Pordenone (IT)

(54) **Laundry treating machine**

(57) The present invention refers to a laundry treating machine, such as a dryer or a washer/dryer machine, suitable for applying a steam treatment to laundry.

A laundry treating machine according to the invention comprises: a drum (1) having an inner region (3) for receiving laundry to be treated; air conveying means (7, 11) for conveying treating air from and to said drum inner region (3); a condenser (9) for removing moisture from laundry treating air; collecting means (12, 14, 16, 17, 19, 20) for receiving condensate produced by the condenser (9); a steam generator (22) in fluid connection with the collecting means (12, 14, 16, 17, 19, 20) and with the drum inner region (3) for directing steam in said region (3); said machine being characterised in that said collecting means (12, 14, 16, 17, 19, 20) comprise a multiple-way conduit (17, 19, 20) directing said condensate towards a plurality of tanks (14, 16), said conduit (17, 19, 20) being provided with valving means (18) for controlling condensate flow towards said tanks (14, 16).

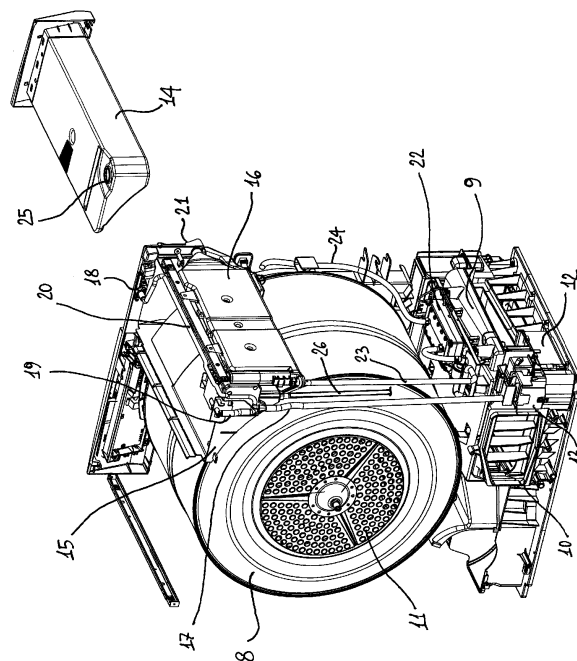

Fig. 2

Description

[0001] The present invention refers to a laundry treating machine, such as a dryer or a washer/dryer machine, suitable for applying a steam treatment to laundry.

[0002] Laundry treating machines having means for applying a steam treatment to laundry are known and are normally provided with a rotating drum having an inner region for receiving laundry to be treated, with means for conveying air from and to the drum and with a condenser for removing moisture from air coming out from the drum after having treated the laundry. A steam generator is further provided for evaporating an amount of water, or other laundry treating substances, and directing the steam so produced inside the drum inner region. Such treatment can be useful for removing odours from laundry or for relaxing and remove wrinkles from clothes.

[0003] In laundry treating machine of known type, the steam generator is supplied with treating liquors by a single tank that can be filled manually by a user and/or, automatically by the machine itself collecting condensate obtained in a condenser that removes moisture from air coming out from the drum. One of these machines is disclosed in the European Patent Application No. EP 1579052.

[0004] A drawback of the known laundry treating machines consists in that a steam treatment can be performed only whether a sufficient amount of treating liquor is available in the tank supplying the steam generator. Therefore the user has to remember to refill manually such tank before starting the appropriate steam treating program or, if the machine can refill the tank automatically with condensate, the user has to perform first a laundry drying program in order to allow the condenser to produce liquor to be evaporated. This is particularly annoying and time-consuming for a user who would rather have a machine suitable for promptly performing a laundry steam treatment.

[0005] A further drawback of known laundry treating machines consists in that a complex machine control program must be provided controlling the liquor level in the single tank available because the latter can be refilled both periodically by the user both automatically by the machine. The control program must be suitable for informing the user whether and with which amount of liquor he/she has to refill the tank when a predetermined amount of liquor is already present in the tank because of previous steam treating or laundry drying operations. In addition a drying program might not be performed unless the control program advises the user to empty the tank if the liquor level in the latter is too high. Such control programs can be the cause of frequent and undesired malfunctioning of the laundry treating machine.

[0006] The aim of the present invention is therefore to solve the noted problems and thus providing a laundry treating machine having an improved reliability with respect to known machines.

[0007] Another object of the present invention is to pro-

vide a laundry treating machine allowing the user to perform a steam treating operation without performing a laundry drying operation first.

[0008] A further object of the invention is to provide a laundry treating machine providing an efficient recovery of condensate extracted from laundry in order to use it for steam treating clothes.

[0009] Advantages, objects, and features of the invention will be set forth in part in the description which follows and in part will become apparent to those having ordinary skill in the art upon examination of the following or may be learned from practice of the invention. The objects and advantages of the invention may be realised and attained as particularly pointed out in the appended claims.

[0010] The accompanying drawings, which are included to provide a further understanding of the invention and are incorporated in and constitute a part of this specification, illustrate a possible embodiment of the invention and together with the description serve to explain the principles of the invention.

[0011] In the drawings:

[0012] Figure 1 shows a perspective view of a laundry treatment machine according to the invention with a disassembled cabinet;

[0013] Figure 2 shows a rear perspective view of the laundry treating machine of figure 1 without the cabinet;

[0014] Figure 3 shows, in a perspective view, a particular of the secondary tank.

[0015] With reference to the drawings, a laundry treating machine according to the invention, such as a laundry dryer or a laundry washer/dryer, comprises a drum 1 rotatably mounted inside a cabinet 2 which is shown in an exploded view in figure 1. The drum 1 has an inner region 3 adapted to receive articles to be treated through a loading opening 4 formed in the front portion of the drum 1.

[0016] Arranged at a base region 5 of the machine a condenser 9 is provided for cyclically drying laundry treating air that enters the inner drum region 3 through openings 11 formed on a rear portion 8 of the drum 1 (see figure 2) and exiting the latter from a conveyer 7 placed on the loading opening 4. Condenser 9 is cooled by an airflow that enters the machine from an inlet opening 10 on the machine back side (see figure 2) and that is exhausted through an outlet opening 6 at the front side of the laundry treating machine. The condenser cooling airflow and the laundry treating air are pumped by fans not shown in the drawings, in addition treating air is heated before entering the drum 1 in a known manner.

[0017] Liquor extracted by the condenser 9 from moist air exiting the drum inner region 3 is collected in a tray 12. A pump 13 and a pipe 17 convey the condensate from the tray 12 to a principal tank 14, which is removably associated to the machine and preferably placed in an upper region of the cabinet 2, so as to be easily extracted by a user.

[0018] A secondary tank 16 is provided to be in fluid communication with the condensate collecting tray 12 by

means of the pipe 17. Valving means 18 control the condensate flow towards the principal tank 14 and the secondary tank 16. Said valving means 18 can be in the form of a solenoid valve driven by the laundry treating machine electronics according to a preset operative program or in the form of a manually operable valve. The latter embodiment, as shown in the attached figures, is preferably carried out by placing valving means 18 in the machine front panel such that a user can easily reach it. Pipe 17 branches in a plurality of conduits 19, 20 each of them reaching one of the tanks 14, 16. As a further multiple-way conduit solution for conveying condensate towards the tanks 14, 16, a plurality of pipes, each dedicated to a single tank, can be provided between the condensate tray 12 and the tanks 14, 16.

[0019] Secondary tank 16 is also hydraulically connected with a pipe 23 to an inlet opening of a steam generator 22 of known type, such that liquor contained in the tank 16 can be evaporated. Steam produced by the generator 22 flows through a pipe 24 into the inner drum region 3 for treating laundry.

[0020] When valving means 18 are in an open position, condensate liquor available in the tray 12 during or after a laundry drying operation is pumped by the pump 13 in the pipe 17 and divided between the principal tank 14 and the secondary tank 16. In this way a portion of the total amount of liquid extracted from laundry is saved in the secondary tank 16 and made available to be reused for a subsequent steam treatment. When valving means 18 are in a closed position all the amount of condensate liquor pumped from the tray 12 is flowed into the principal tank 14 though a opening 25 that is placed at the pipe 19 outlet when the machine is in use. Said opening 25 serves also as overflow opening allowing the condensate to be discharged when the tank is full. Discharged liquor is collect by a hopper 15 on which the principal tank 14 is mounted. The hopper 15 is in fluid connection with the condensate collecting tray 12 by means of a discharge pipe 26 which is shown only in part in figure 2. In this way, condensate liquor can be recirculated from and to the tray 12 and the tank 14 in a closed hydraulic loop until its amount causes the laundry treating machine to be switched off by an appropriate and known safety system to avoid undesired and dangerous flooding. Such safety system, of known type, preferably comprises a floating member placed in the condensate collecting tray 12 and a switch that is activated by the floating member for turning off the laundry machine when the liquor level in tray 12 reaches a preset value.

[0021] Similarly, an overflow opening 27 is provided also in the secondary tank 16 such that when the tank 16 is almost full of liquor, the latter can be discharged into the hopper 15 on which the tank 16 is mounted. Therefore, as described above for liquor discharged from the principal tank 14, also the amount of liquor exceeding the capacity of the secondary tank 16 can be recirculated in a closed hydraulic loop between the condensate collecting tray 12 and the secondary tank 16 by means of

pump 13.

[0022] Evidently, if valving means 18 are in an open position, condensate liquor discharged from principal and/or secondary tanks 14, 16 is recirculated from/to collecting tray 12 and both tanks 14, 16. This is particularly advantageous for retarding the moment in which the laundry machine is switched off automatically by the above described safety system preventing the machine from being flooded by an excessive amount of condensate liquor. When valving means 18 are open, the laundry machine maximum capacity of collecting liquor (substantially given by the inner volume of tanks 14, 16 and by the volume of collecting tray 12) is completely dedicated to receive condensate liquor.

[0023] Secondary tank 16 is also provided with a filler 21, placed at the machine front, allowing the user to fill the tank 16 manually. This is useful both when the user desires to perform a laundry steam treatment without having carried out drying operations before, both when the he/she desires to add chemical substances to liquor that has to be evaporated. Such substances can be, for example, scent imparting chemicals, conditioning or laundry relaxing compositions.

[0024] Even if the present invention has been disclosed describing a laundry treating machine having two tanks, it is obvious for the skilled man to apply the same inventive concept disclosed herein for providing a machine having more than two tanks.

[0025] Conclusively it can be stated that with a laundry treating machine according to the invention a user can perform a steam treatment without performing each time a laundry drying cycle so as to produce a sufficient amount of condensate to be evaporated during the steam treatment. As a further advantage tank refilling operations by the user are greatly reduced because liquor extracted from laundry can be efficiently used for steaming laundry articles. The present machine allows the user to introduce additives, perfumes and other useful treating substances in order to improve laundry steam treatment.

Claims

1. Laundry treating machine comprising: a drum (1) having an inner region (3) for receiving laundry to be treated; air conveying means (7, 11) for conveying treating air from and to said drum inner region (3); a condenser (9) for removing moisture from laundry treating air; collecting means (12, 14, 16, 17, 19, 20) for receiving condensate produced by the condenser (9); a steam generator (22) in fluid connection with the collecting means (12, 14, 16, 17, 19, 20) and with the drum inner region (3) for directing steam in said region (3); said machine being **characterised in that** said collecting means (12, 14, 16, 17, 19, 20) comprise a multiple-way conduit (17, 19, 20) directing said condensate towards a plurality of tanks (14, 16), said conduit (17, 19, 20) being provided with

valving means (18) for controlling condensate flow towards said tanks (14, 16).

2. Laundry treating machine according to claim 1 wherein said multiple-way conduit (17, 19, 20) defines a first hydraulic circuit comprising a principal tank (14) in fluid connection with said condenser (9) and a second hydraulic circuit comprising a secondary tank (16) supplying liquor to said steam generator (22).
5
10
3. Laundry treating machine according to claim 2 wherein the principal tank (14) is removably associated to the machine and the secondary tank (16) has a user accessible filler (21).
15
4. Laundry treating machine according to any preceding claim wherein each of said tanks (14, 16) has an overflow opening (25, 27) for discharging condensate when the tank (14, 16) is full, said tanks (14, 16) being mounted on a hopper (15) in fluid connection with said multiple-way conduit (17, 19, 20) for recirculating said condensate through said tanks (14, 16) in a closed hydraulic loop.
20
25
5. Laundry treating machine according to any preceding claim wherein said valving means (18) comprises a manually operable valve or a solenoid valve.
6. Laundry treating machine according to any preceding claim wherein said collecting means (12, 14, 16, 17, 19, 20) comprises pumping means (13).
30
35
40
45
50
55

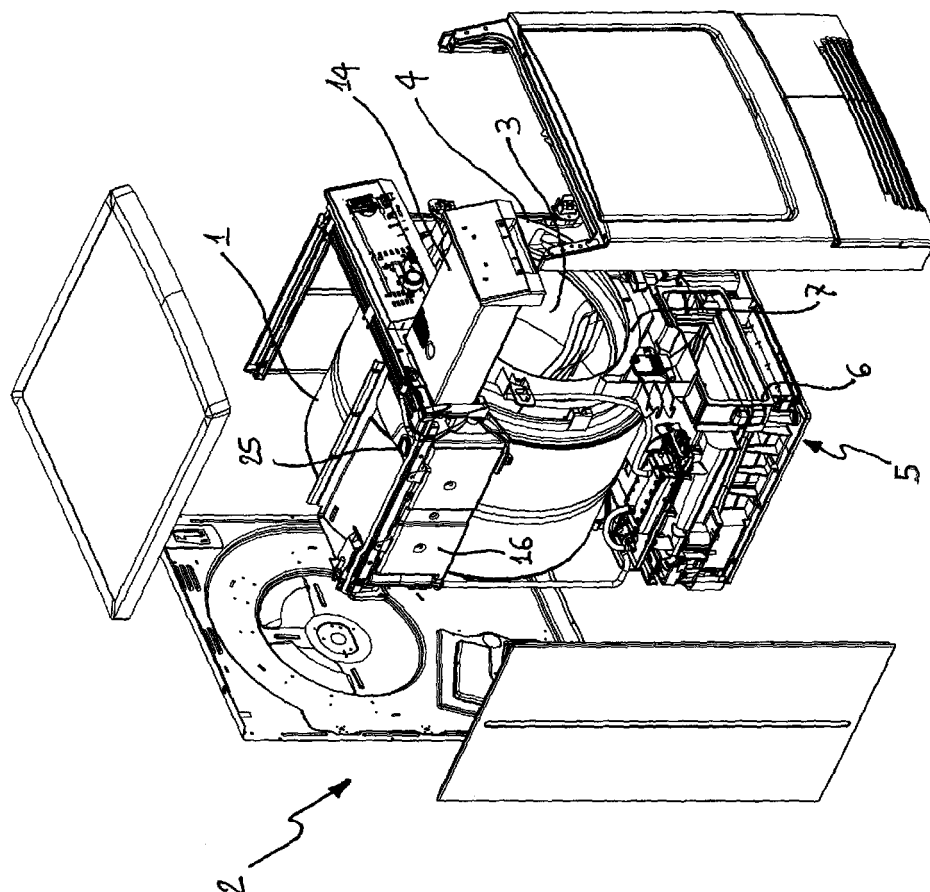

Fig. 1

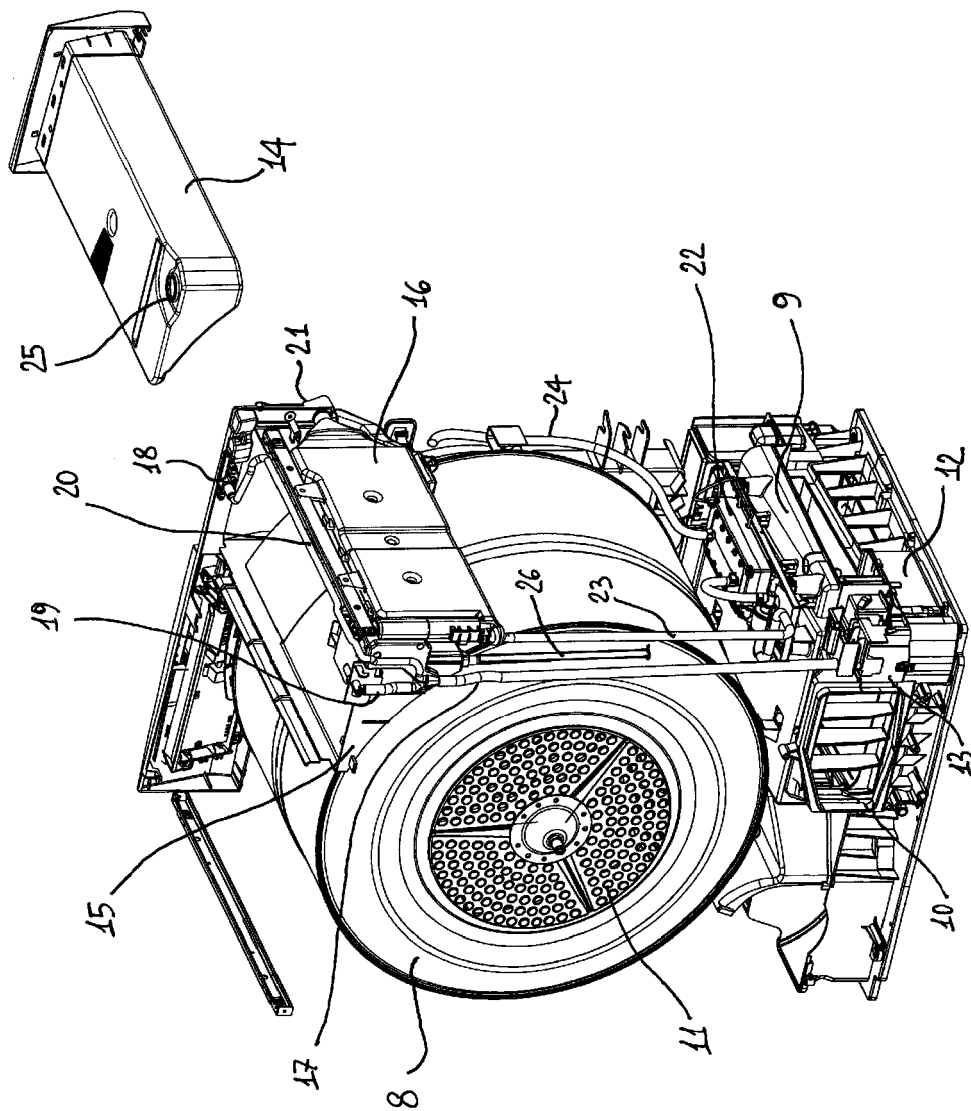

Fig. 2

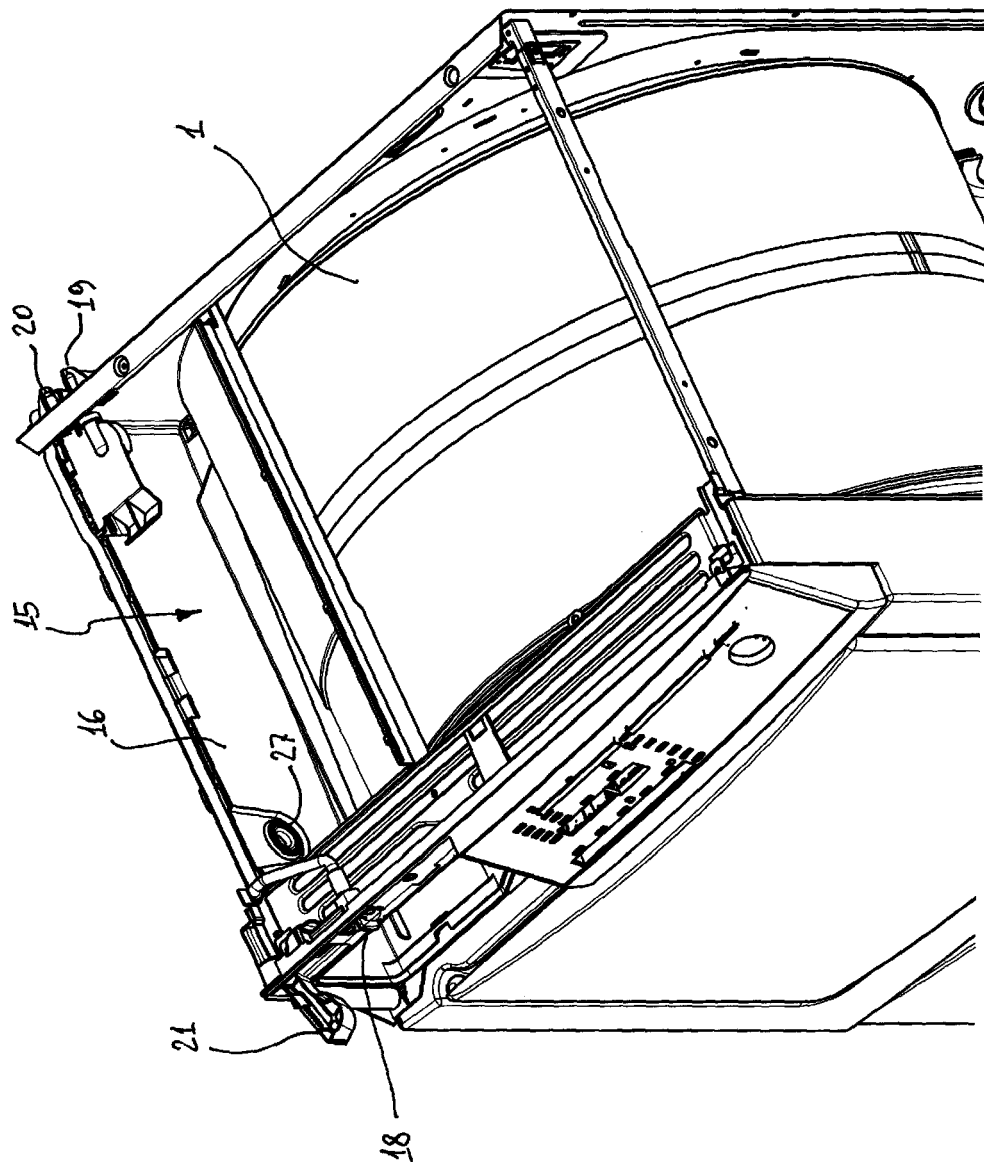

Fig. 3



European Patent
Office

EUROPEAN SEARCH REPORT

Application Number
EP 06 11 8596

DOCUMENTS CONSIDERED TO BE RELEVANT			
Category	Citation of document with indication, where appropriate, of relevant passages	Relevant to claim	CLASSIFICATION OF THE APPLICATION (IPC)
Y,D	DE 102 60 151 A1 (BSH BOSCH SIEMENS HAUSGERAETE [DE]) 1 July 2004 (2004-07-01) * the whole document *	1-6	INV. D06F58/24 D06F58/20
Y	EP 1 564 325 A (ELECTROLUX HOME PROD CORP [BE]) 17 August 2005 (2005-08-17) * column 5, paragraph 28 - column 6, paragraph 34; figures 2,3 *	1-6	
A	EP 1 441 060 A (ELECTROLUX HOME PROD CORP [BE]) 28 July 2004 (2004-07-28) * column 6, paragraph 24 - column 7, paragraph 26; figure 2 *	1-6	
A	US 2006/130354 A1 (CHOI SOUNG B [KR] ET AL) 22 June 2006 (2006-06-22) * page 5, paragraph 130 - paragraph 135; figure 9 *	1-6	
A	DE 20 10 680 A1 (SIEMENS ELEKTROGERAETE GMBH) 16 September 1971 (1971-09-16) * figure 7 *	1-6	
The present search report has been drawn up for all claims			TECHNICAL FIELDS SEARCHED (IPC) D06F
Place of search Munich		Date of completion of the search 18 January 2007	Examiner Lodato, Alessandra
<p>CATEGORY OF CITED DOCUMENTS</p> <p>X : particularly relevant if taken alone Y : particularly relevant if combined with another document of the same category A : technological background O : non-written disclosure P : intermediate document</p> <p>T : theory or principle underlying the invention E : earlier patent document, but published on, or after the filing date D : document cited in the application L : document cited for other reasons & : member of the same patent family, corresponding document</p>			

2

EPO FORM 1503 03.82 (P04C01)

**ANNEX TO THE EUROPEAN SEARCH REPORT
ON EUROPEAN PATENT APPLICATION NO.**

EP 06 11 8596

This annex lists the patent family members relating to the patent documents cited in the above-mentioned European search report. The members are as contained in the European Patent Office EDP file on
The European Patent Office is in no way liable for these particulars which are merely given for the purpose of information.

18-01-2007

Patent document cited in search report	Publication date	Patent family member(s)	Publication date
DE 10260151 A1	01-07-2004	WO 2004059070 A1	15-07-2004
		EP 1579052 A1	28-09-2005
		US 2007006484 A1	11-01-2007
EP 1564325 A	17-08-2005	AU 2005200315 A1	25-08-2005
		CA 2494432 A1	10-08-2005
		US 2005172511 A1	11-08-2005
EP 1441060 A	28-07-2004	DE 10302866 A1	12-08-2004
US 2006130354 A1	22-06-2006	DE 102005053702 A1	22-06-2006
DE 2010680 A1	16-09-1971	NONE	

REFERENCES CITED IN THE DESCRIPTION

This list of references cited by the applicant is for the reader's convenience only. It does not form part of the European patent document. Even though great care has been taken in compiling the references, errors or omissions cannot be excluded and the EPO disclaims all liability in this regard.

Patent documents cited in the description

- EP 1579052 A [0003]