



(11) **EP 1 905 881 A3**

(12) **EUROPEAN PATENT APPLICATION**

(88) Date of publication A3:
23.03.2011 Bulletin 2011/12

(51) Int Cl.:
D06F 39/02 (2006.01)

(43) Date of publication A2:
02.04.2008 Bulletin 2008/14

(21) Application number: **07019064.0**

(22) Date of filing: **27.09.2007**

(84) Designated Contracting States:
AT BE BG CH CY CZ DE DK EE ES FI FR GB GR HU IE IS IT LI LT LU LV MC MT NL PL PT RO SE SI SK TR
Designated Extension States:
AL BA HR MK RS

(72) Inventors:
• **Je, Byoung Soo**
Seoul 151-017 (KR)
• **Kim, Dong Won**
Kyunggi-do 423-064 (KR)

(30) Priority: **29.09.2006 KR 20060095819**

(74) Representative: **Urner, Peter**
TER MEER STEINMEISTER & PARTNER GbR
Patentanwälte
Mauerkircherstrasse 45
81679 München (DE)

(54) **Washing machine**

(57) A washing machine (1) includes a dispenser (20) with a detergent box (30), a locking unit (40), and an automatic withdrawing unit (50). The locking unit (40) acts to lock or unlock the detergent box (30) as it is inserted into and withdrawn from the dispenser (20). The automatic withdrawing unit (50) biases the detergent box (30) to the withdrawal position.

FIG. 2

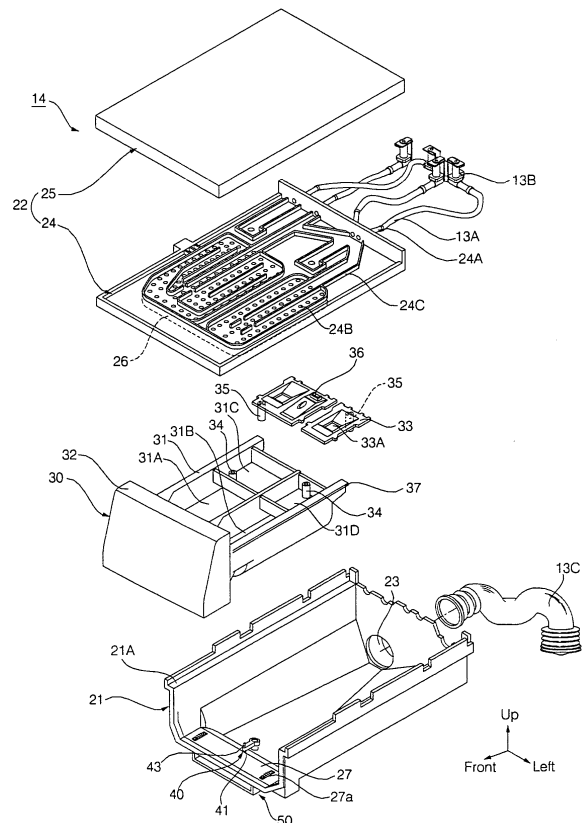

EP 1 905 881 A3



EUROPEAN SEARCH REPORT

Application Number
EP 07 01 9064

DOCUMENTS CONSIDERED TO BE RELEVANT			
Category	Citation of document with indication, where appropriate, of relevant passages	Relevant to claim	CLASSIFICATION OF THE APPLICATION (IPC)
X	US 5 675 994 A (GWEON TAE SOUNG [KR]) 14 October 1997 (1997-10-14)	1,8,9, 12,13	INV. D06F39/02
Y	* column 5, line 17 - line 51; figures 3-7 *	2-7, 10-12	
Y	US 4 660 881 A (KOMEYA SEIJI [JP] ET AL) 28 April 1987 (1987-04-28) * column 4, line 39 - column 9, line 38; figures 2,3,10,11,15,19,20 *	2-4, 10-12	
Y	US 4 828 344 A (OMATA NOBUAKI [JP]) 9 May 1989 (1989-05-09) * column 2, line 31 - column 4, line 23; figures 1,5,7 *	2-7	
X,P	EP 1 724 387 A1 (ITW IND COMPONENTS SRL [IT]) 22 November 2006 (2006-11-22) * paragraph [0011] - paragraph [0021]; figures 1,3,4 *	1-4, 10-13	
X	EP 0 410 086 A1 (BOSCH SIEMENS HAUSGERAETE [DE]) 30 January 1991 (1991-01-30) * column 4, line 1 - line 52; figure 1 *	1-3	TECHNICAL FIELDS SEARCHED (IPC) D06F
The present search report has been drawn up for all claims			
Place of search Munich		Date of completion of the search 11 February 2011	Examiner Kising, Axel
CATEGORY OF CITED DOCUMENTS X : particularly relevant if taken alone Y : particularly relevant if combined with another document of the same category A : technological background O : non-written disclosure P : intermediate document		T : theory or principle underlying the invention E : earlier patent document, but published on, or after the filing date D : document cited in the application L : document cited for other reasons & : member of the same patent family, corresponding document	

1
EPO FORM 1503 03.02 (P04C01)

ANNEX TO THE EUROPEAN SEARCH REPORT
ON EUROPEAN PATENT APPLICATION NO.

EP 07 01 9064

This annex lists the patent family members relating to the patent documents cited in the above-mentioned European search report.
The members are as contained in the European Patent Office EDP file on
The European Patent Office is in no way liable for these particulars which are merely given for the purpose of information.

11-02-2011

Patent document cited in search report		Publication date	Patent family member(s)	Publication date
US 5675994	A	14-10-1997	CN 1141371 A	29-01-1997
			JP 2709294 B2	04-02-1998
			JP 9000781 A	07-01-1997

US 4660881	A	28-04-1987	JP 1808016 C	10-12-1993
			JP 2025816 B	06-06-1990
			JP 61081244 A	24-04-1986

US 4828344	A	09-05-1989	JP 1624338 C	18-11-1991
			JP 2050275 B	01-11-1990
			JP 61078980 A	22-04-1986

EP 1724387	A1	22-11-2006	US 2006261717 A1	23-11-2006

EP 0410086	A1	30-01-1991	DD 295682 A5	07-11-1991
			DE 3924586 A1	31-01-1991

EPO FORM P0459

For more details about this annex : see Official Journal of the European Patent Office, No. 12/82