



(12) **EUROPEAN PATENT APPLICATION**

(88) Date of publication A3:
23.07.2008 Bulletin 2008/30

(51) Int Cl.:
E03C 1/244 (2006.01)

(43) Date of publication A2:
25.06.2008 Bulletin 2008/26

(21) Application number: **07254864.7**

(22) Date of filing: **13.12.2007**

(84) Designated Contracting States:
AT BE BG CH CY CZ DE DK EE ES FI FR GB GR HU IE IS IT LI LT LU LV MC MT NL PL PT RO SE SI SK TR
Designated Extension States:
AL BA HR MK RS

(30) Priority: **13.12.2006 GB 0624863**

(71) Applicant: **Aga Consumer Products Limited**
Shirley
Solihull,
B90 4LH (GB)

(72) Inventor: **Hendley, Steve**
Warwickshire, CV47 9RB (GB)

(74) Representative: **Harris, David James**
Barker Brettell LLP
138 Hagley Road
Edgbaston
Birmingham
B16 9PW (GB)

(54) **Overflow apparatus for sanitary fixtures**

(57) A kit of parts for forming an overflow assembly, the kit of parts comprising a first part (3) arranged so as to be positioned about an external side of an overflow orifice in a sanitary fixture and to be connected to a drain, and a plurality of second parts (4a, 4c) each arranged to be positioned on the internal side of the overflow orifice and to interchangeably engage the first part (3). The kit of parts may further comprise an adaptor (24), arranged

to engage the first part (3), in which, without the adaptor, the first part is sized and shaped to sealably engage an overflow orifice of a first size and/or shape and in which, with the adaptor engaged, the first part (3) and adaptor (24) combined can sealably engage an orifice of a second, different size and/or shape that would not be possible without the adaptor (24). The sanitary fixture may be a bath, sink, washbasin or the like.

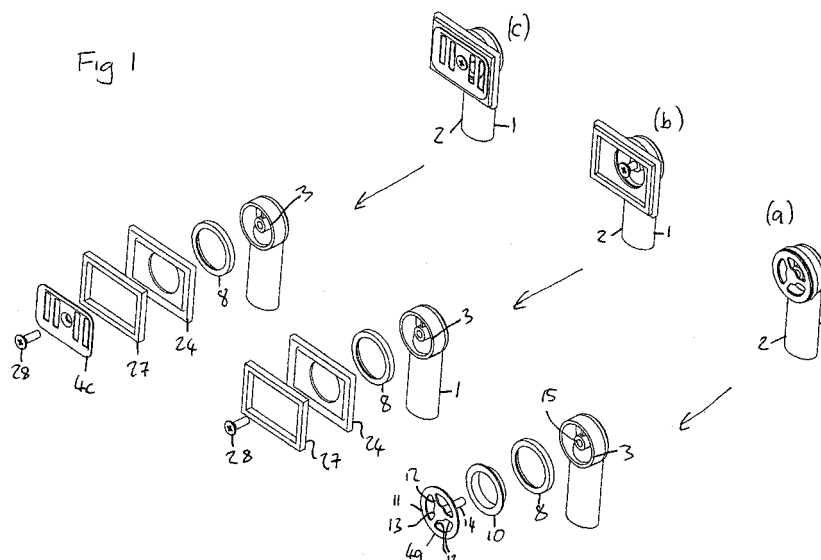



European Patent
Office

EUROPEAN SEARCH REPORT

Application Number
EP 07 25 4864

DOCUMENTS CONSIDERED TO BE RELEVANT			
Category	Citation of document with indication, where appropriate, of relevant passages	Relevant to claim	CLASSIFICATION OF THE APPLICATION (IPC)
X	DE 10 2004 062634 B3 (KALDEWEI FRANZ GMBH & CO [DE]) 6 April 2006 (2006-04-06) * figures 3,7,8 * -----	1-6, 8-12, 15-20	INV. E03C1/244
X	US 2002/032926 A1 (LEWIS STEPHEN W [US]) 21 March 2002 (2002-03-21) * figure 5 * -----	1,9,12	
			TECHNICAL FIELDS SEARCHED (IPC)
			E03C
<p>The present search report has been drawn up for all claims</p>			
Place of search		Date of completion of the search	Examiner
Munich		28 March 2008	Flygare, Esa
<p>CATEGORY OF CITED DOCUMENTS</p> <p>X : particularly relevant if taken alone Y : particularly relevant if combined with another document of the same category A : technological background O : non-written disclosure P : intermediate document</p> <p>T : theory or principle underlying the invention E : earlier patent document, but published on, or after the filing date D : document cited in the application L : document cited for other reasons</p> <p>& : member of the same patent family, corresponding document</p>			

1
EPO FORM 1503 03.82 (P04C01)



European Patent
Office

Application Number

EP 07 25 4864

CLAIMS INCURRING FEES

The present European patent application comprised at the time of filing more than ten claims.

- ☐ Only part of the claims have been paid within the prescribed time limit. The present European search report has been drawn up for the first ten claims and for those claims for which claims fees have been paid, namely claim(s):
- ☐ No claims fees have been paid within the prescribed time limit. The present European search report has been drawn up for the first ten claims.

LACK OF UNITY OF INVENTION

The Search Division considers that the present European patent application does not comply with the requirements of unity of invention and relates to several inventions or groups of inventions, namely:

see sheet B

- ☐ All further search fees have been paid within the fixed time limit. The present European search report has been drawn up for all claims.
- ☐ As all searchable claims could be searched without effort justifying an additional fee, the Search Division did not invite payment of any additional fee.
- ☐ Only part of the further search fees have been paid within the fixed time limit. The present European search report has been drawn up for those parts of the European patent application which relate to the inventions in respect of which search fees have been paid, namely claims:
- ☒ None of the further search fees have been paid within the fixed time limit. The present European search report has been drawn up for those parts of the European patent application which relate to the invention first mentioned in the claims, namely claims:
see additional sheet(s)
- ☐ The present supplementary European search report has been drawn up for those parts of the European patent application which relate to the invention first mentioned in the claims (Rule 164 (1) EPC).



European Patent
Office

**LACK OF UNITY OF INVENTION
SHEET B**

Application Number
EP 07 25 4864

The Search Division considers that the present European patent application does not comply with the requirements of unity of invention and relates to several inventions or groups of inventions, namely:

1. claims: 1-12, 15-20

A kit for an overflow and a method for mounting the kit

2. claims: 13, 14

An adaptor for a kit to form an overflow

**ANNEX TO THE EUROPEAN SEARCH REPORT
ON EUROPEAN PATENT APPLICATION NO.**

EP 07 25 4864

This annex lists the patent family members relating to the patent documents cited in the above-mentioned European search report.
The members are as contained in the European Patent Office EDP file on
The European Patent Office is in no way liable for these particulars which are merely given for the purpose of information.

28-03-2008

Patent document cited in search report	Publication date	Patent family member(s)	Publication date
DE 102004062634 B3	06-04-2006	NONE	

US 2002032926 A1	21-03-2002	NONE	

EPO FORM P0459

For more details about this annex : see Official Journal of the European Patent Office, No. 12/82