



(12) **EUROPEAN PATENT APPLICATION**

(43) Date of publication:
02.07.2008 Bulletin 2008/27

(51) Int Cl.:
B62M 9/16^(2006.01) B62M 9/12^(2006.01)

(21) Application number: **07008897.6**

(22) Date of filing: **02.05.2007**

(84) Designated Contracting States:
AT BE BG CH CY CZ DE DK EE ES FI FR GB GR HU IE IS IT LI LT LU LV MC MT NL PL PT RO SE SI SK TR
Designated Extension States:
AL BA HR MK RS

(72) Inventor: **Nagasawa, Hajime**
Sakai City
Osaka 590-8577 (JP)

(74) Representative: **Harrison, Robert John et al**
Sonnenberg Fortmann
Patent- und Rechtsanwälte
Postfach 33 08 65
80068 München (DE)

(30) Priority: **26.12.2006 US 645030**

(71) Applicant: **SHIMANO INC.**
Osaka 590-8577 (JP)

(54) **Bicycle rear derailleur**

(57) A bicycle derailleur is basically provided with a base member, a linkage assembly movably coupled to the base member, a movable member movably coupled to the linkage assembly and a chain guide movably coupled to the movable member. The chain guide has a pair of cage plates (31,32), a first pulley (33) rotatably supported between the cage plates and a second pulley (34)

rotatably supported between the cage plates. At least one of the cage plates includes a non-metallic cage body and at least one metallic insert (52,62). The metallic insert has a pulley axle receiving bore supporting one of the pulley axles of the pulleys and a fastening part at least partially embedded in the non-metallic cage body.

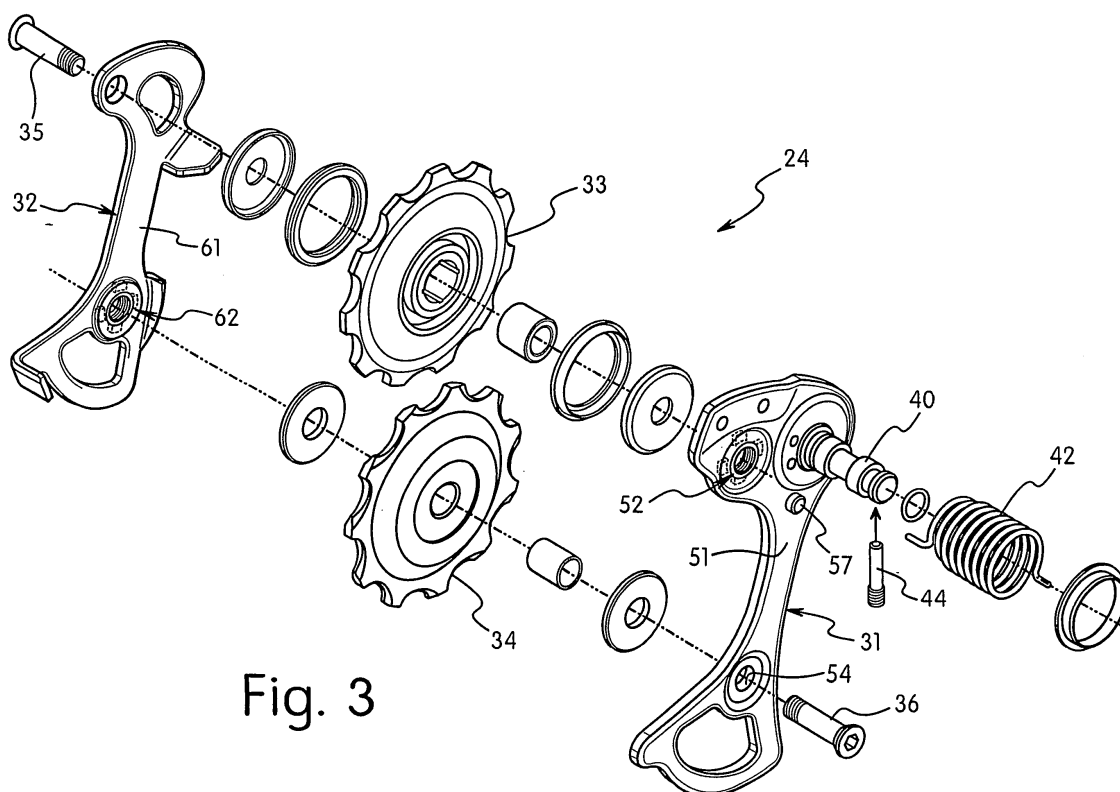

Fig. 3

Description

Field of the Invention

[0001] This invention generally relates to a bicycle rear derailleur. More specifically, the present invention relates to a chain guide of a bicycle rear derailleur having at least one non-metallic cage plates.

Background Information

[0002] Bicycling is becoming an increasingly more popular form of recreation as well as a means of transportation. Moreover, bicycling has become a very popular competitive sport for both amateurs and professionals. Whether the bicycle is used for recreation, transportation or competition, the bicycle industry is constantly improving the various components of the bicycle. One component that has been extensively redesigned is the bicycle rear derailleur.

[0003] A bicycle rear derailleur is used to selectively engage a chain with one of a plurality of sprockets that rotate with the rear wheel of the bicycle. A typical rear derailleur comprises a base member, a movable member supporting a chain guide and a pair of links coupled between the base member and the movable member so that the chain guide moves laterally relative to the base member. The chain guide typically has an inner cage plate, an outer cage plate, an upper pulley rotatably supported between the inner and outer cage plates and a lower pulley rotatably supported between the inner and outer cage plates. In the past, the cage plates were typically made of metal with a pair of bolts acting as the pulley axles for the upper and lower pulleys. Sometimes these bolts (pulley axles) are threaded into one of the cage plates to fasten the bolts to the cage plates. While metal cage plates work well, it is desirable to make the rear derailleur including the cage plates as lightweight as possible.

[0004] In view of the above, it will be apparent to those skilled in the art from this disclosure that there exists a need for an improved rear derailleur. This invention addresses this need in the art as well as other needs, which will become apparent to those skilled in the art from this disclosure.

SUMMARY OF THE INVENTION

[0005] One object of the present invention is to provide a bicycle rear derailleur with at least one non-metallic cage plate.

[0006] In accordance with one aspect of the present invention, a bicycle derailleur cage plate is provided with a non-metallic cage body, and a first metallic insert. The first metallic insert has a first pulley axle receiving bore and a first fastening part at least partially embedded in the non-metallic cage body.

[0007] In accordance with another aspect of the

present invention, a bicycle derailleur is provided with a base member, a linkage assembly movably coupled to the base member, a movable member movably coupled to the linkage assembly, and a chain guide movably coupled to the movable member. The chain guide includes a first cage plate, a second cage plate, a first pulley rotatably supported between the first and second cage plates and a second pulley rotatably supported between the first and second cage plates. The first cage plate includes a first non-metallic cage body and a first metallic insert. The first metallic insert has a first pulley axle receiving bore and a first fastening part at least partially embedded in the non-metallic cage body.

[0008] These and other objects, features, aspects and advantages of the present invention will become apparent to those skilled in the art from the following detailed description, which, taken in conjunction with the annexed drawings, discloses preferred embodiments of the present invention.

BRIEF DESCRIPTION OF THE DRAWINGS

[0009] Referring now to the attached drawings which form a part of this original disclosure:

[0010] Figure 1 is a side elevational view of a bicycle showing a rear derailleur in accordance with a first embodiment of the present invention;

[0011] Figure 2 is an enlarged outboard elevational view of the rear derailleur illustrated in Figure 1 in accordance with the first embodiment of the present invention;

[0012] Figure 3 is an exploded perspective view of the cage chain of the rear derailleur illustrated in Figures 1 and 2 in accordance with the first embodiment of the present invention;

[0013] Figure 4 is an enlarged elevational view of the outer cage plate of the rear derailleur illustrated in Figures 1 and 2 in accordance with the first embodiment of the present invention;

[0014] Figure 5 is an enlarged cross sectional view of the outer cage plate as seen along section line 5-5 of Figure 4;

[0015] Figure 6 is an enlarged elevational view of the inner cage plate of the rear derailleur illustrated in Figures 1 and 2 in accordance with the first embodiment of the present invention;

[0016] Figure 7 is an enlarged cross sectional view of the inner cage plate as seen along section line 7-7 of Figure 6;

[0017] Figure 8 is an enlarged elevational view of the metallic insert of the rear derailleur illustrated in Figures 1 and 2 in accordance with the first embodiment of the present invention;

[0018] Figure 9 is an enlarged cross sectional view of the metallic insert as seen along section line 9-9 of Figure 8;

[0019] Figure 10 is a perspective view of the metallic insert in accordance with the first embodiment of the

present invention;

[0020] Figure 11 is an exploded perspective view of a cage chain of a rear derailleur in accordance with a second embodiment of the present invention;

[0021] Figure 12 is an exploded perspective view of the cage chain of the rear derailleur in accordance with a third embodiment of the present invention;

[0022] Figure 13 is an enlarged elevational view of a metallic insert embedded in a cage plate in accordance with a fourth embodiment of the present invention;

[0023] Figure 14 is an enlarged fragmentary cross sectional view of a portion of the cage plate and the metallic insert as seen along section line 14-14 of Figure 13 in accordance with the fourth embodiment of the present invention;

[0024] Figure 15 is a perspective view of the metallic insert in accordance with the fourth embodiment of the present invention;

[0025] Figure 16 is an enlarged elevational view of a metallic insert embedded in a cage plate in accordance with a fifth embodiment of the present invention;

[0026] Figure 17 is an enlarged fragmentary cross sectional view of a portion of the cage plate and the metallic insert as seen along section line 17-17 of Figure 16 in accordance with the fifth embodiment of the present invention;

[0027] Figure 18 is a perspective view of the metallic insert in accordance with the fifth embodiment of the present invention;

[0028] Figure 19 is an enlarged elevational view of a metallic insert embedded in a cage plate in accordance with a sixth embodiment of the present invention;

[0029] Figure 20 is an enlarged fragmentary cross sectional view of a portion of the cage plate and the metallic insert as seen along section line 20-20 of Figure 19 in accordance with the sixth embodiment of the present invention; and

[0030] Figure 21 is a perspective view of the metallic insert in accordance with the sixth embodiment of the present invention.

DETAILED DESCRIPTION OF THE PREFERRED EMBODIMENTS

[0031] Selected embodiments of the present invention will now be explained with reference to the drawings. It will be apparent to those skilled in the art from this disclosure that the following descriptions of the embodiments of the present invention are provided for illustration only and not for the purpose of limiting the invention as defined by the appended claims and their equivalents.

[0032] Referring initially to Figure 1, a bicycle is illustrated that is equipped with a bicycle rear derailleur 12 in accordance with a first embodiment of the present invention. As shown in Figures 1 and 2, the bicycle 10 has a frame 14 in which the rear derailleur 12 is secured thereto. As shown in Figure 2, the rear derailleur 12 basically includes a base member 16, a pair of links 18 and 20

forming a linkage assembly and a movable member 22 with a chain guide 24 pivotally mounted to the movable member 22. The rear derailleur 12 is movably secured to a rear mounting portion of the frame 14 of the bicycle 10.

[0033] Basically, the rear derailleur 12 is a conventional rear derailleur in which an inner wire 26 of a Bowden cable assembly is coupled to one of the links 18 and 20 (e.g., the inner wire coupled to the link 20 in the illustrated embodiment) to move the movable member 22 and the chain guide 24 laterally relative to the base member 16. A coil spring (not shown) is connected to diagonally opposite pivot shafts so that links 18 and 20 are biased together. Generally speaking, the present invention can be used with any rear derailleur that uses a chain guide. Thus, the parts of the rear derailleur 12 will not be discussed or illustrated in detail herein, except for those parts that relate to the chain guide 24 of the present invention.

[0034] Basically, as best seen in Figure 3, the chain guide 24 has an outer cage plate 31, an inner cage plate 32, an upper or guide pulley 33 and a lower or tension pulley 34. The upper pulley 33 is rotatably supported between the outer and inner cage plates 31 and 32 by an upper axle or pulley bolt 35. The lower pulley 34 is rotatably supported between the outer and inner cage plates 31 and 32 by a lower axle or pulley bolt 36. The chain guide 24 is pivotally supported to the movable member 22 by a pivot axle 40 that is fixed to the outer cage plate 31. A torsion spring 42 is disposed on the pivot axle 40 with a first end of the torsion spring 42 coupled to the outer cage plate 31 and a second end of the torsion spring 42 coupled to the movable member 22 (i.e., second end of the torsion spring 42 is located in a bore of the movable member 22). A screw 44 retains the pivot axle 40 in the movable member 22 in a conventional manner.

[0035] In the first embodiment, the outer cage plate 31 basically includes a non-metallic cage body 51 and a metallic insert 52 embedded in the non-metallic cage body 51. Preferably, the non-metallic cage body 51 is formed from a carbon fiber reinforced plastic such that the metallic insert 52 is embedded in the non-metallic cage body 51. The non-metallic cage body 51 of the outer cage plate 31 also has a pivot axle opening 53, a pair of spring receiving openings 55 and a stop pin receiving opening 56. The pivot axle 40 is fixedly secured within the axle opening 53. The pulley bolt 36 extends through the lower axle bore 54 such that the outer cage plate 31 is one end of the pulley bolt 36. The spring receiving openings 55 are arranged so that one or the other of the spring receiving openings 55 receives the first end of the torsion spring 42 therein. The stop pin receiving opening 56 has a stop pin 57 (Figure 3) secured thereto for limiting rotational of the chain cage 24 relative to the movable member 22.

[0036] The inner cage plate 32 basically includes a non-metallic cage body 61 and a metallic insert 62 embedded in the non-metallic cage body 61. Preferably, the

non-metallic cage body 61 is formed from a carbon fiber reinforced plastic such that the metallic insert 62 is embedded in the non-metallic cage body 61. The non-metallic cage body 61 of the inner cage plate 32 also has an upper axle bore 64 for receiving the pulley bolt 35 therethrough.

[0037] Preferably, the metallic inserts 52 and 62 are identically configured so that they can be used interchangeably and reduce the number of parts that need to be manufactured to create the chain guide 24. Thus, the following description of the metallic insert 52 applies to the metallic insert 62. Of course, if needed and/or desired, the metallic inserts 52 and 62 can have different configurations.

[0038] Referring now to Figures 8 to 10, the metallic insert 52 has an annular base part 71 that defines a pulley axle receiving bore 72 and a fastening part 73 that extends outwardly from the annular base part 71. The pulley axle receiving bore 72 of the metallic insert 52 supports one end of the pulley bolt or axle 35 of the pulley 33. Preferably, the pulley axle receiving bore 72 of the metallic insert 52 has internal threads for threadedly engaging the threads of the pulley bolt or axle 35 and 36. The fastening part 73 of the metallic insert 52 is completely embedded in the non-metallic cage body 51. The fastening part 73 of the metallic insert 52 includes a plurality (four) of projections that extends radially from the annular base part 71. The fastening part 73 is preferably located in the middle of the non-metallic cage body 51.

[0039] Referring now to Figures 6 and 7, the metallic insert 62 has an annular base part 81 that defines a pulley axle receiving bore 82 and a fastening part 83 that extends outwardly from the annular base part 81. The pulley axle receiving bore 82 of the metallic insert 62 supports one end of the pulley bolt or axle 36 of the pulley 34. Preferably, the pulley axle receiving bore 82 of the metallic insert 62 has internal threads for threadedly engaging the threads of the pulley bolt or axle 36. The fastening part 83 of the metallic insert 62 is completely embedded in the non-metallic cage body 61. The fastening part 83 of the metallic insert 62 includes a plurality (four) of projections that extends radially from the annular base part 81. The fastening part 83 is preferably located in the middle of the non-metallic cage body 61.

SECOND EMBODIMENT

[0040] Referring now to Figure 11, a chain guide 124 in accordance with a second embodiment will now be explained. The chain guide 124 is pivotally supported to the movable member 22 by the pivot axle 40. In view of the similarity between the first and second embodiments, the parts of the second embodiment that are identical to the parts of the first embodiment will be given the same reference numerals as the parts of the first embodiment. Moreover, the descriptions of the parts of the second embodiment that are identical to the parts of the first embodiment may be omitted for the sake of brevity.

[0041] Basically, the chain guide 124 of the second embodiment is identical to the chain guide 24 of the first embodiment, except that the outer and inner cage plates 31 and 32 have been replaced with an outer cage plate 131 and an inner cage plate 132 in which both of the metallic inserts 52 and 62 have been embedded in the outer cage plate 131. Thus, the pulley bolts or axles 35 and 36 are inserted through lower and upper axle bores 154 and 164 formed in the non-metallic body 161 of the inner cage plate 132, and then threaded into the metallic inserts 52 and 62 embedded in the non-metallic body 151 of the outer cage plate 131.

THIRD EMBODIMENT

[0042] Referring now to Figure 12, a chain guide 224 in accordance with a third embodiment will now be explained. The chain guide 224 is pivotally supported to the movable member 22 by the pivot axle 40. In view of the similarity between the first and third embodiments, the parts of the third embodiment that are identical to the parts of the first embodiment will be given the same reference numerals as the parts of the first embodiment. Moreover, the descriptions of the parts of the third embodiment that are identical to the parts of the first embodiment may be omitted for the sake of brevity.

[0043] Basically, the chain guide 224 of the second embodiment is identical to the chain guide 24 of the first embodiment, except that the outer and inner cage plates 31 and 32 have been replaced with an outer cage plate 231 and an inner cage plate 232 in which both of the metallic inserts 52 and 62 have been embedded in the inner cage plate 232. Thus, the pulley bolts or axles 35 and 36 are inserted through lower and upper axle bores 254 and 264 formed in the non-metallic body 261 of the outer cage plate 232, and then threaded into the metallic inserts 52 and 62 embedded in the non-metallic body 251 of the inner cage plate 232.

FOURTH EMBODIMENT

[0044] Referring now to Figures 13 to 15, a chain plate 331 (332) with a metallic insert 352 (362) will now be explained in accordance with a fourth embodiment of the present invention. The chain plate 331 (332) can either be the outer or inner chain plate with the metallic insert 352 (362) being an upper axle attachment member or lower axle attachment member. In other words, the metallic insert 352 (362) can be used in place of each of the metallic inserts 52 and 62 in the chain plates of each of the first, second and third embodiments. Thus, the shape of the chain plate 331 (332) is identical to anyone of the chain plates of first, second and third embodiments such that the chain plate 331 (332) has only one or two of the metallic inserts 352 (362) if needed and/or desired. For this reason, the reference numerals in the parentheses are used to indicate parts relating to the inner chain plate and the metallic insert(s) associated with the inner chain

plate, while the reference numerals without parentheses are used to indicate parts relating to the outer chain plate and the metallic insert(s) associated with the outer chain plate.

[0045] In view of the similarity between this embodiment and the prior embodiments, the parts of this embodiment that are identical to the parts of the prior embodiment will be omitted for the sake of brevity. Rather, it will be apparent to those skilled in the art from this disclosure that a rear derailleur constructed with a pair of the chain plate 331 (332) using a pair of the metallic inserts 352 (362) would be identical to the rear derailleur 12, except for the metallic inserts 352 (362) which are embedded in the chain plates in the same manner as either the first, second or third embodiments.

[0046] In this embodiment, the metallic insert 352 (362) has an annular base part 371 that defines a pulley axle receiving bore 372 and an annular fastening part 373 that extends outwardly from the annular base part 371. The pulley axle receiving bore 372 of the metallic insert 352 (362) supports one end of the pulley bolt or axle 35 or 36 of the pulley 33 or 34. Preferably, the pulley axle receiving bore 372 of the metallic insert 352 (362) has internal threads for threadedly engaging the threads of the pulley bolt or axle 35 and 36. The fastening part 373 of the metallic insert 352 (362) is completely embedded in the non-metallic cage body. The fastening part 373 of the metallic insert 352 (362) is preferably a single continuous flange or projection that extends radially from the annular base part 371. The fastening part 373 is preferably located in the middle of the non-metallic cage body.

FIFTH EMBODIMENT

[0047] Referring now to Figures 16 to 18, a chain plate 431 (432) with a metallic insert 452 (462) will now be explained in accordance with a fifth embodiment of the present invention. The chain plate 431 (432) can either be the outer or inner chain plate with the metallic insert 452 (462) being either an upper axle attachment member or lower axle attachment member. In other words, the metallic insert 452 (462) can be used in place of each of the metallic inserts 52 and 62 in each of the first, second and third embodiments. Thus, the shape of the chain plate 431 (432) is identical to anyone of the chain plates of first, second and third embodiments such that the chain plate 431 (432) has only one or two of the metallic inserts 452 (462) as needed and/or desired. For this reason, the reference numerals in the parentheses are used to indicate parts relating to the inner chain plate and the metallic insert(s) associated with the inner chain plate, while the reference numerals without parentheses are used to indicate parts relating to the outer chain plate and the metallic insert(s) associated with the outer chain plate.

[0048] In view of the similarity between this embodiment and the prior embodiments, the parts of this embodiment that are identical to the parts of the prior embodiment will be omitted for the sake of brevity. Rather,

it will be apparent to those skilled in the art from this disclosure that a rear derailleur constructed with a pair of metallic inserts 452 (462) would be identical to the rear derailleur 12, except for the metallic inserts 452 (462) which are embedded in the chain plates in the same manner as either the first, second or third embodiments.

[0049] In this embodiment, the metallic insert 452 (462) has an annular base part 471 that defines a pulley axle receiving bore 472 and a fastening part 473 that extends outwardly from the annular base part 471. The pulley axle receiving bore 472 of the metallic insert 452 (462) supports one end of the pulley bolt or axle 35 or 36 of the pulley 33 or 34. Preferably, the pulley axle receiving bore 472 of the metallic insert 452 (462) has internal threads for threadedly engaging the threads of the pulley bolt or axle 35 and 36. The fastening part 473 of the metallic insert 352 (362) is located at one axial end of the annular base part 471 so that an axial face 473a of the fastening part 473 is not embedded within the non-metallic cage body. The axial face 473a of the fastening part 473 faces away from the other cage plate, when in use. Thus, the axle bolt applies a pulling force on the metallic insert 452 (462) that is directed from the axial face 473a of the fastening part 473 toward the other end of the metallic insert 452 (462). The fastening part 473 of the metallic insert 452 (462) includes a plurality (four) of projections that extend radially from the annular base part 471. However, the fastening part 473 can be formed as a single annular projection similar to the fourth embodiment.

SIXTH EMBODIMENT

[0050] Referring now to Figures 19 to 21, a chain plate 531 (532) with a metallic insert 552 (562) will now be explained in accordance with a sixth embodiment of the present invention. The chain plate 531 (532) can either be the outer or inner chain plate with the metallic insert 552 (562) being either an upper axle attachment member or lower axle attachment member. In other words, the metallic insert 552 (562) can be used in place of each of the metallic inserts 52 and 62 in each of the first, second and third embodiments. Thus, the shape of the chain plate 531 (532) is identical to anyone of the chain plates of first, second and third embodiments such that the chain plate 531 (532) has only one or two of the metallic inserts 552 (562) as needed and/or desired. For this reason, the reference numerals in the parentheses are used to indicate parts relating to the inner chain plate and the metallic insert(s) associated with the inner chain plate, while the reference numerals without parentheses are used to indicate parts relating to the outer chain plate and the metallic insert(s) associated with the outer chain plate.

[0051] In view of the similarity between this embodiment and the prior embodiments, the parts of this embodiment that are identical to the parts of the prior embodiment will be omitted for the sake of brevity. Rather, it will be apparent to those skilled in the art from this disclosure that a rear derailleur constructed with a pair

of metallic inserts 552 (562) would be identical to the rear derailleur 12, except for the metallic inserts 552 (562) which are embedded in the chain plates in the same manner as either the first, second or third embodiments.

[0052] In this embodiment, the metallic insert 552 (562) has an annular base part 571 that defines a pulley axle receiving bore 572 and a fastening part 573 that extends outwardly from the annular base part 571. The pulley axle receiving bore 572 of the metallic insert 552 (562) supports one end of the pulley bolt or axle 35 or 36 of the pulley 33 or 34. Preferably, the pulley axle receiving bore 572 of the metallic insert 552 (562) has internal threads for threadedly engaging the threads of the pulley bolt or axle 35 and 36. The fastening part 573 of the metallic insert 552 (562) is partially embedded in the non-metallic cage body such that the axial end faces of fastening part 573 are exposed. The fastening part 573 of the metallic insert 552 (562) is preferably a plurality of ribs or projections that extends axially along the annular base part 571.

GENERAL INTERPRETATION OF TERMS

[0053] In understanding the scope of the present invention, the term "comprising" and its derivatives, as used herein, are intended to be open ended terms that specify the presence of the stated features, elements, components, groups, integers, and/or steps, but do not exclude the presence of other unstated features, elements, components, groups, integers and/or steps. The foregoing also applies to words having similar meanings such as the terms, "including", "having" and their derivatives. Also, the terms "part," "section," "portion," "member" or "element" when used in the singular can have the dual meaning of a single part or a plurality of parts. As used herein to describe the present invention, the following directional terms "forward, rearward, above, downward, vertical, horizontal, below and transverse" as well as any other similar directional terms refer to those directions of a bicycle equipped with the present invention. Accordingly, these terms, as utilized to describe the present invention should be interpreted relative to a bicycle equipped with the present invention as used in the normal riding position. Also the terms "first" and "second" can be used interchangeably to describe the parts of the chain guide 24, e.g., the outer cage plate can be either the "first" cage plate or the "second" cage plate, the inner cage plate can be either the "first" cage plate or the "second" cage plate, the upper metallic insert can be either the "first" metallic insert or the "second" metallic insert, and the lower metallic insert can be either the "first" metallic insert or the "second" metallic insert. Finally, terms of degree such as "substantially", "about" and "approximately" as used herein mean a reasonable amount of deviation of the modified term such that the end result is not significantly changed.

[0054] While only selected embodiments have been chosen to illustrate the present invention, it will be ap-

parent to those skilled in the art from this disclosure that various changes and modifications can be made herein without departing from the scope of the invention as defined in the appended claims. Furthermore, the foregoing descriptions of the embodiments according to the present invention are provided for illustration only, and not for the purpose of limiting the invention as defined by the appended claims and their equivalents.

Claims

1. A bicycle derailleur cage plate comprising:
 - a non-metallic cage body; and
 - a first metallic insert having a first pulley axle receiving bore and a first fastening part at least partially embedded in the non-metallic cage body.
2. The bicycle derailleur cage plate as set forth in claim 1, wherein the first fastening part of the first metallic insert is completely embedded within the non-metallic cage body.
3. The bicycle derailleur cage plate as set forth in claim 1 or 2, wherein the first fastening part of the first metallic insert includes a plurality of first projections, in particular the first projections of the first metallic insert being completely embedded within the non-metallic cage body.
4. The bicycle derailleur cage plate as set forth in any one of claims 1 to 3, wherein the first pulley axle receiving bore of the first metallic insert includes internal threads.
5. The bicycle derailleur cage plate as set forth in any one of claims 1 to 4, further comprising a second metallic insert having a second pulley axle receiving bore and a second fastening part embedded in the non-metallic cage body, in particular the first and second metallic inserts being identically configured.
6. The bicycle derailleur cage plate as set forth in any one of claims 1 to 5, wherein the non-metallic cage body includes a carbon fiber reinforced plastic.
7. A bicycle derailleur comprising:
 - a base member;
 - a linkage assembly movably coupled to the base member;
 - a movable member movably coupled to the linkage assembly; and
 - a chain guide movably coupled to the movable

member, the chain guide including a first cage plate, a second cage plate, a first pulley rotatably supported between the first and second cage plates and a second pulley rotatably supported between the first and

5

second cage plates, the first cage plate being as set forth in any one of claims 1 to 6.

8. The bicycle derailleur as set forth in claim 7, wherein the second cage plate includes

10

a second non-metallic cage body; and

a second metallic insert having a second pulley axle receiving bore supporting a second pulley axle of the

second pulley and a second fastening part at least partially embedded in the second non-metallic cage

15

body.

9. The bicycle derailleur as set forth in claim 8, wherein the first and second metallic inserts are identically configured.

20

25

30

35

40

45

50

55

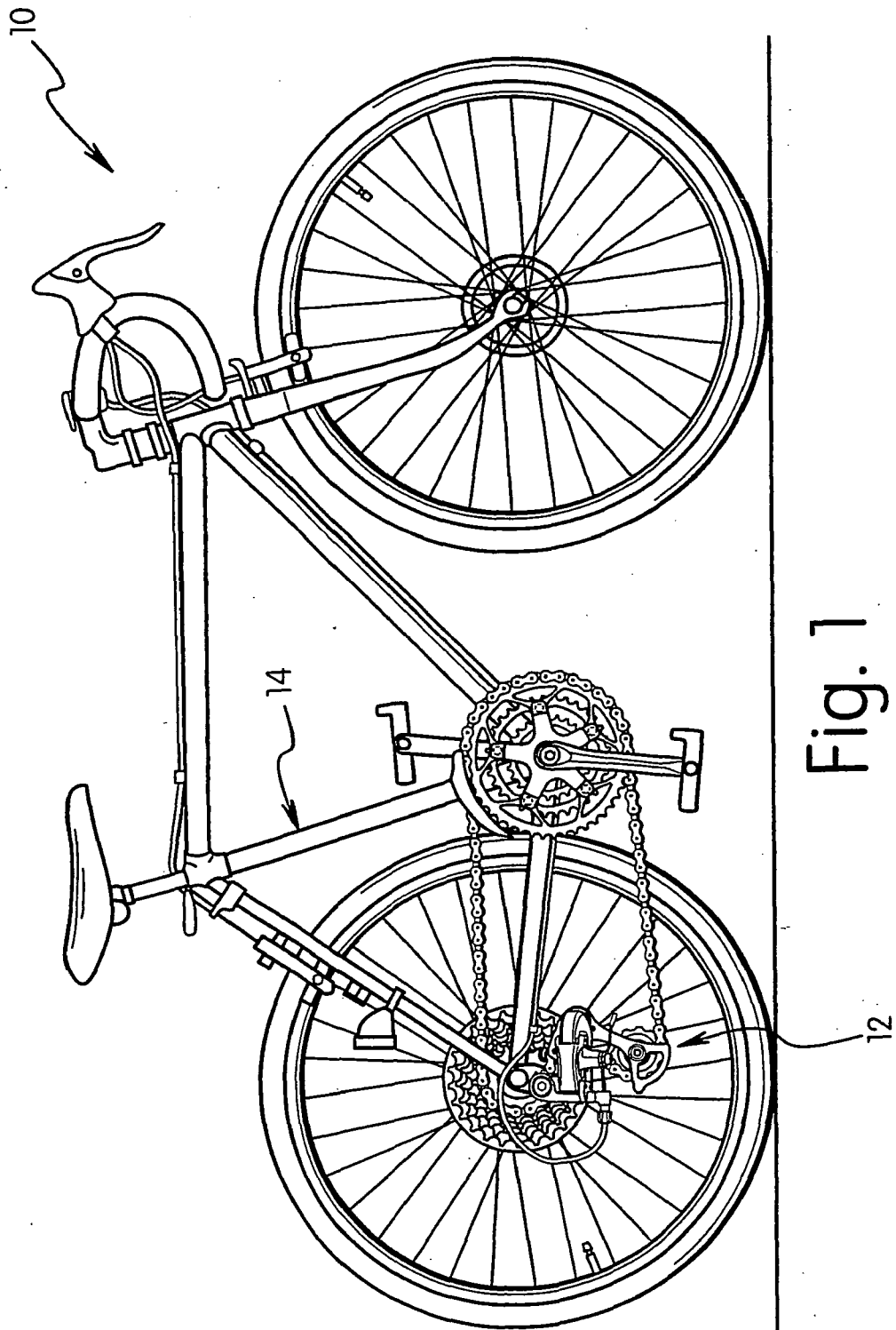

Fig. 1

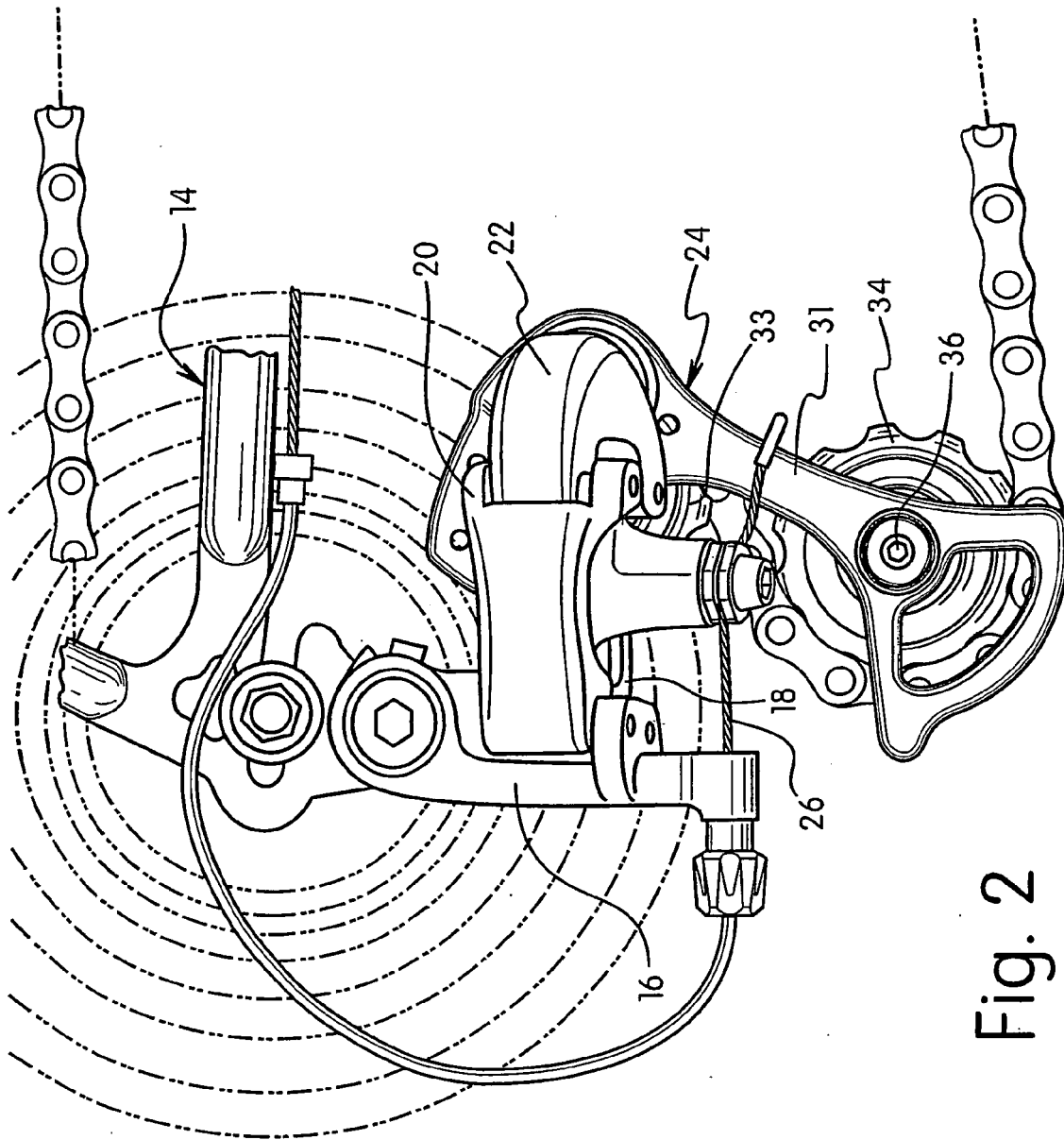

Fig. 2

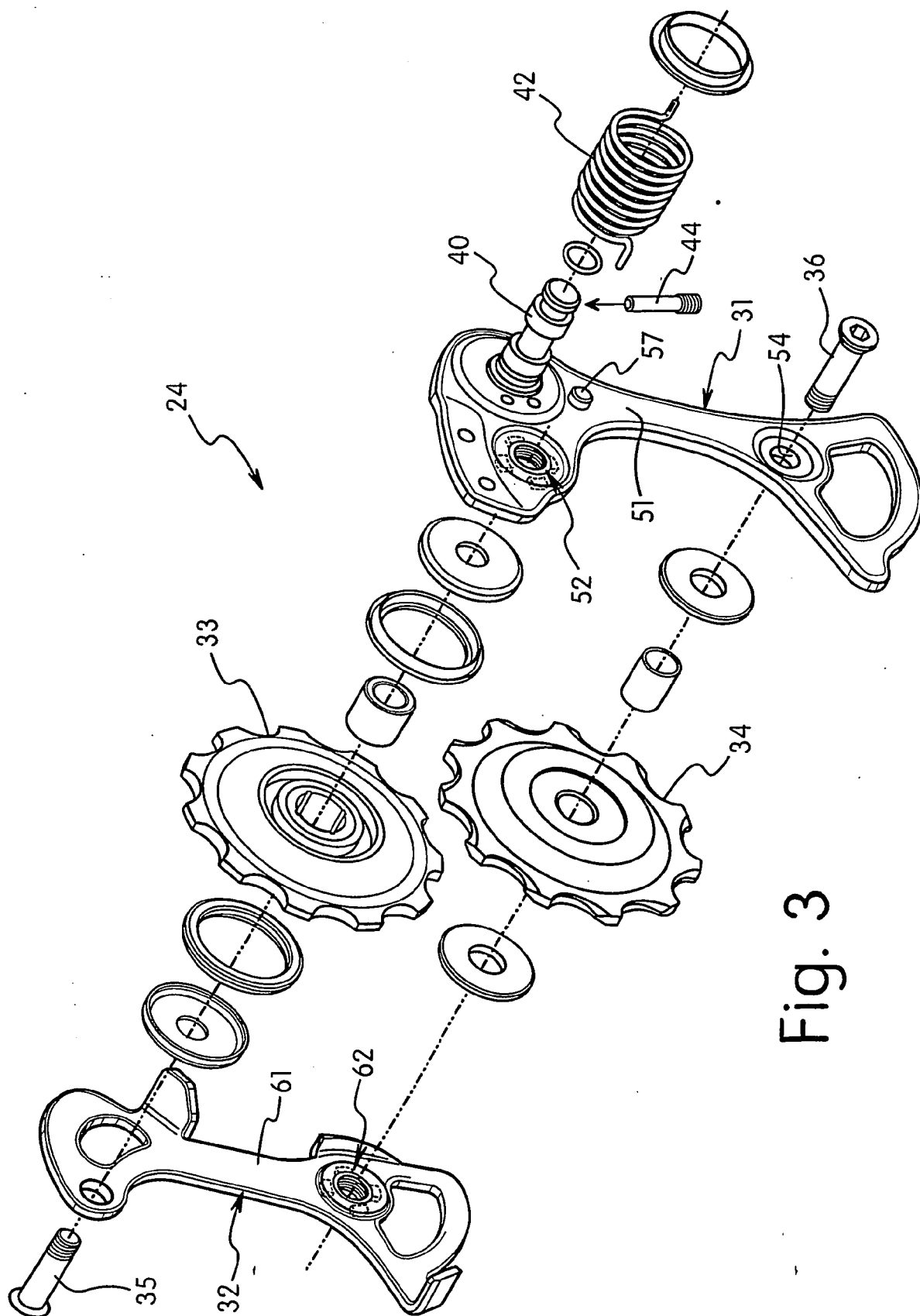
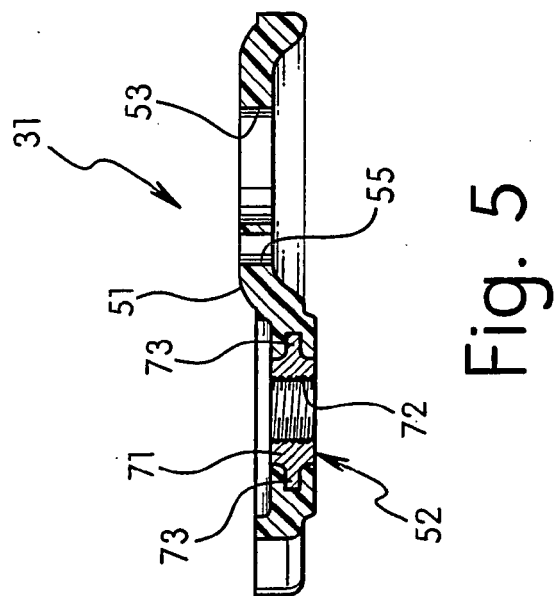
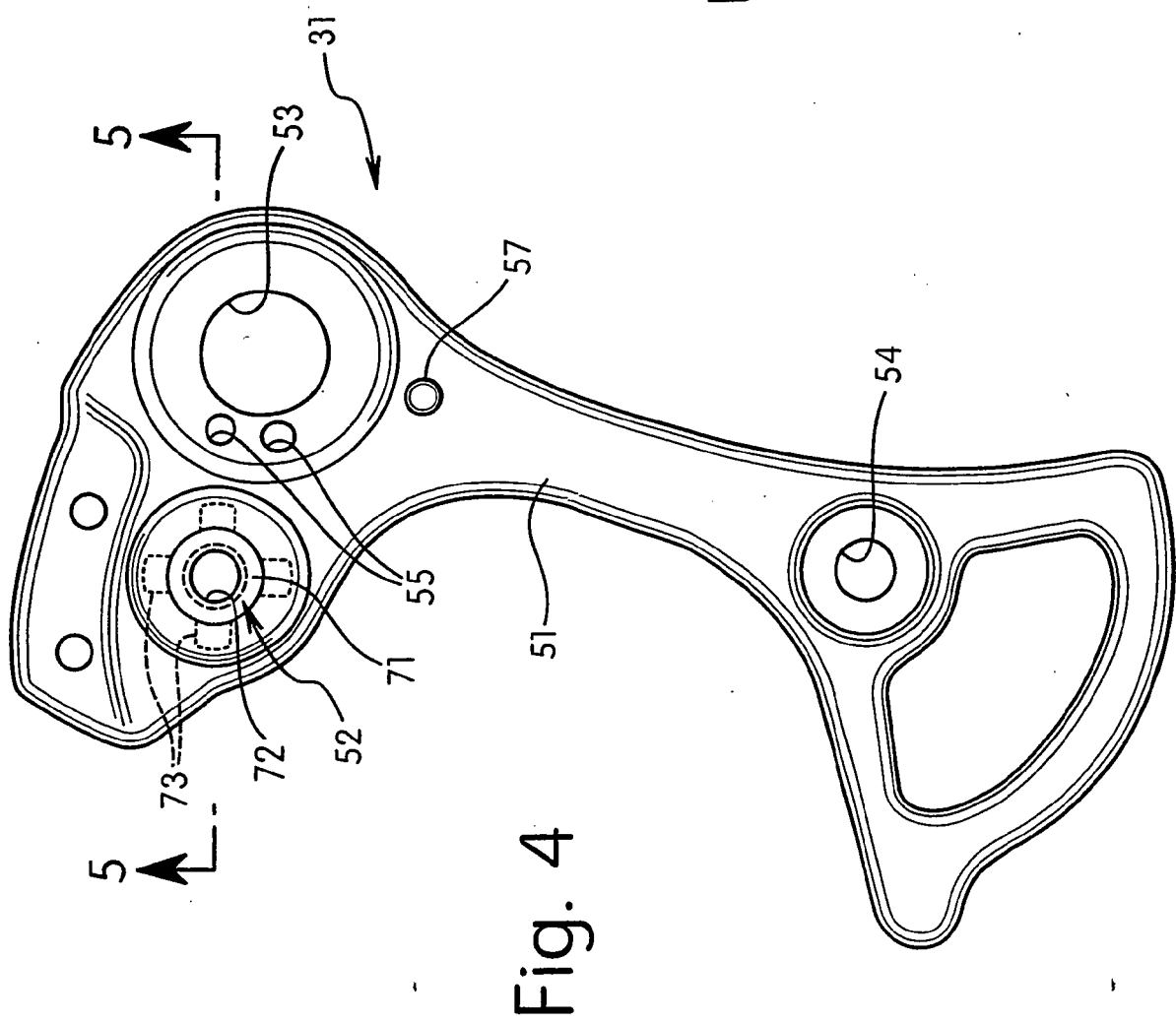
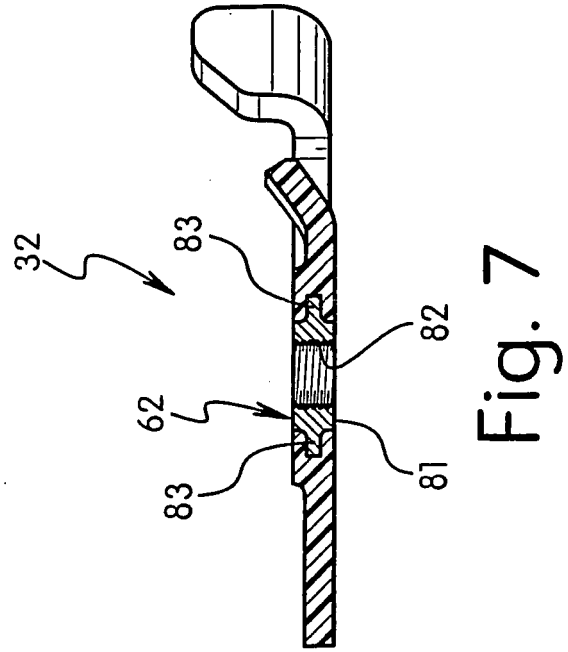
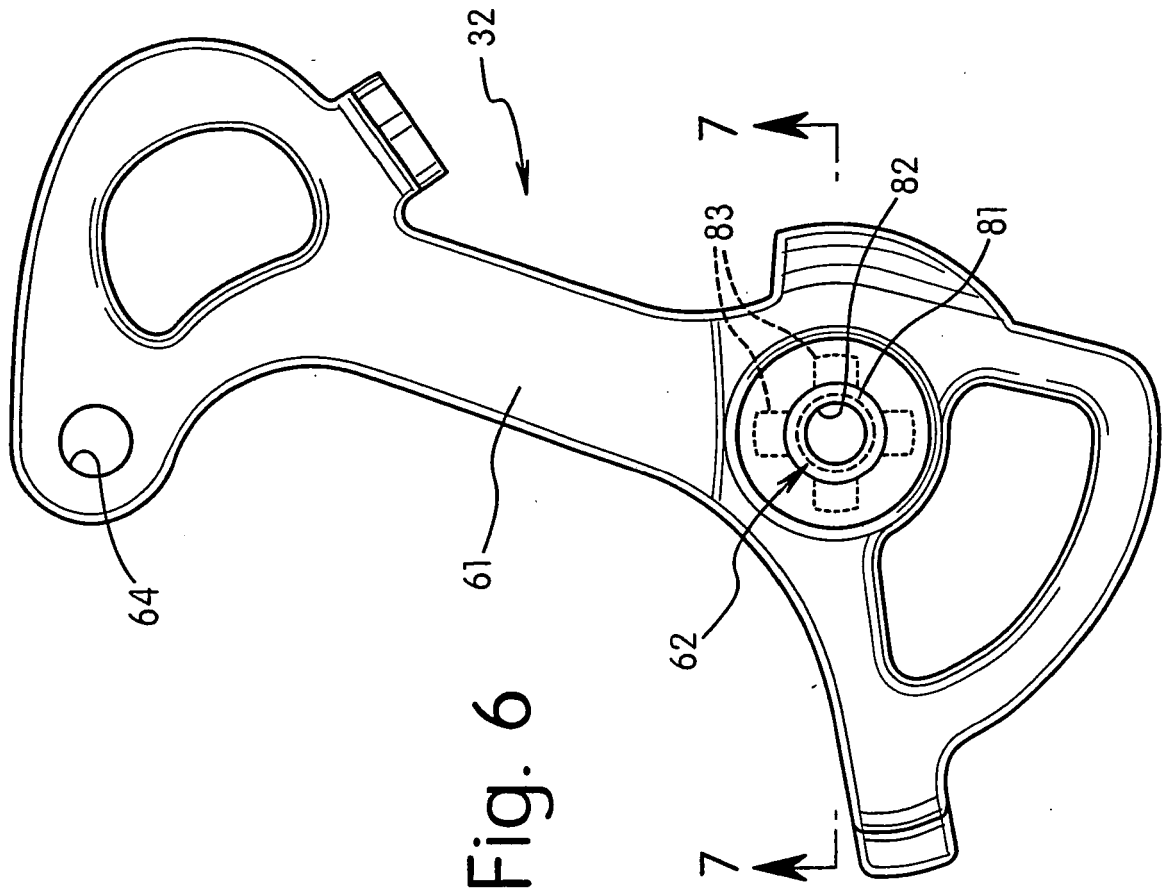

Fig. 3





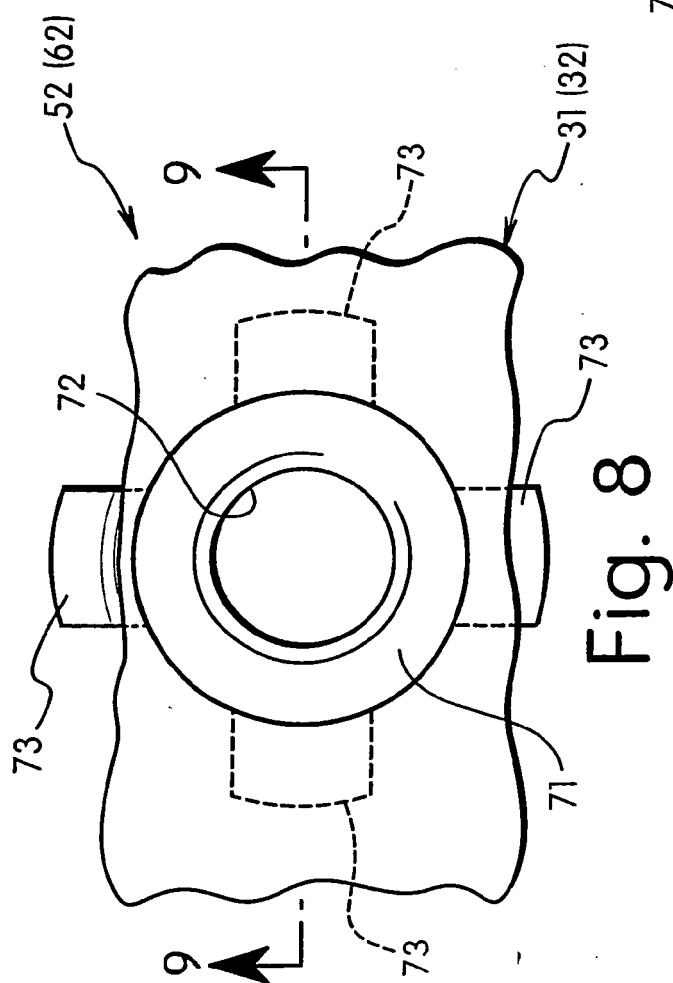

Fig. 8

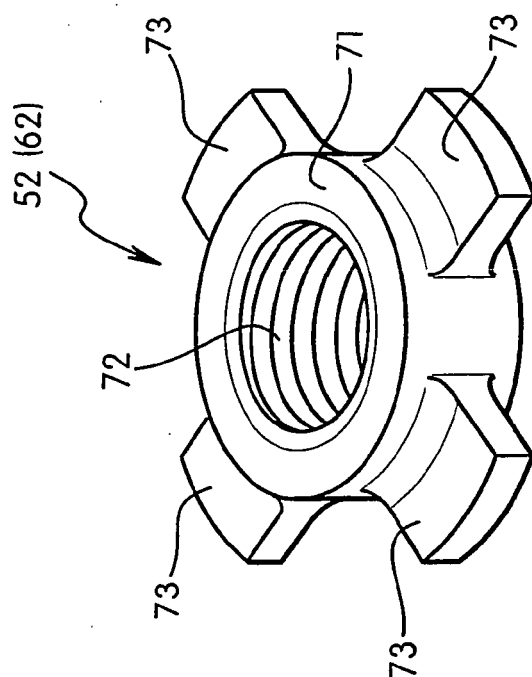

Fig. 10

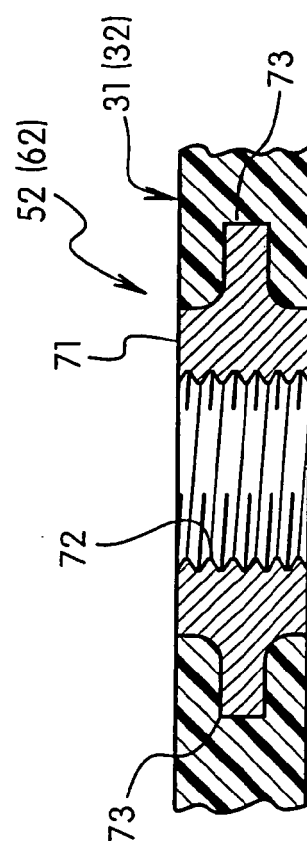

Fig. 9

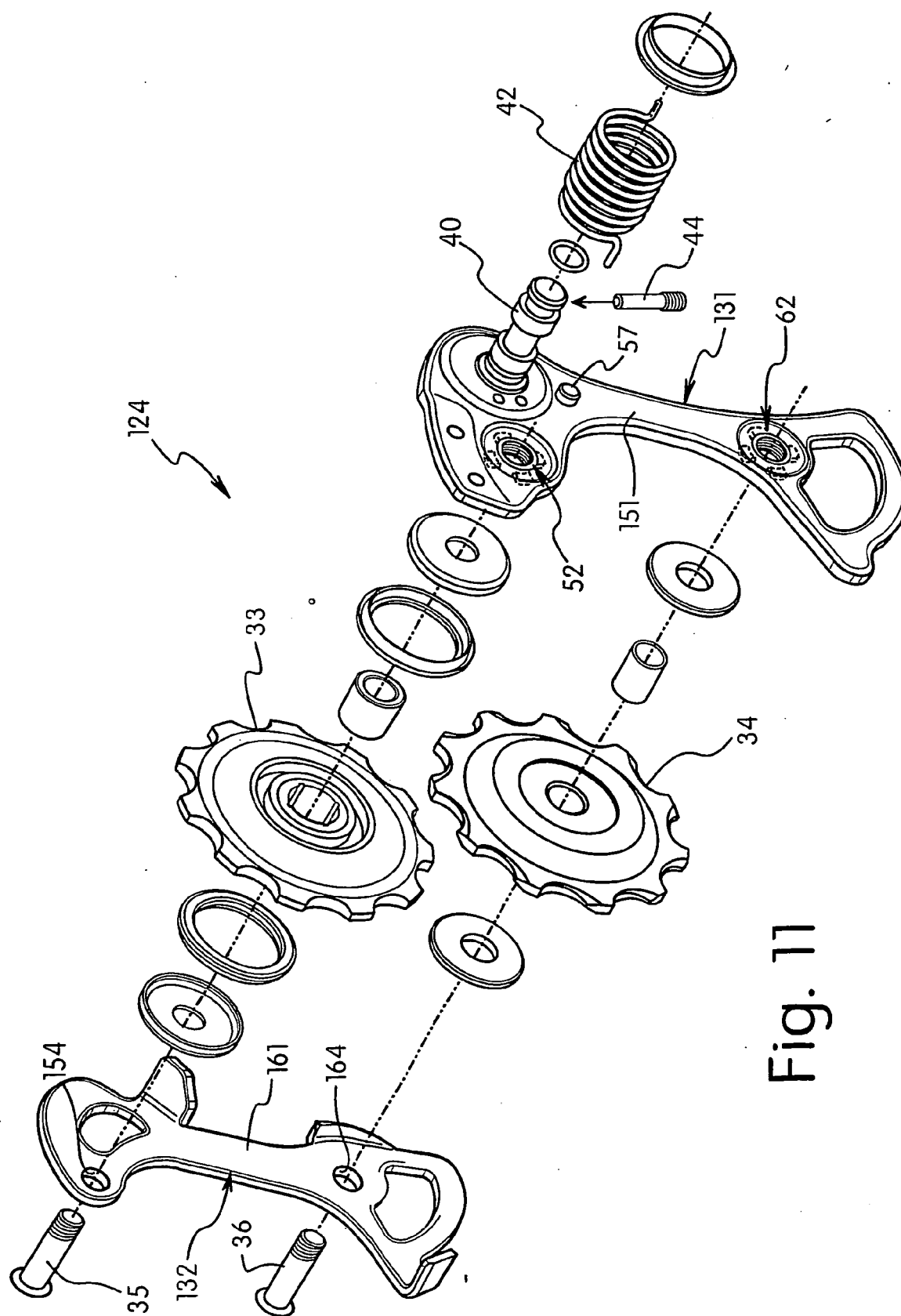

Fig. 11

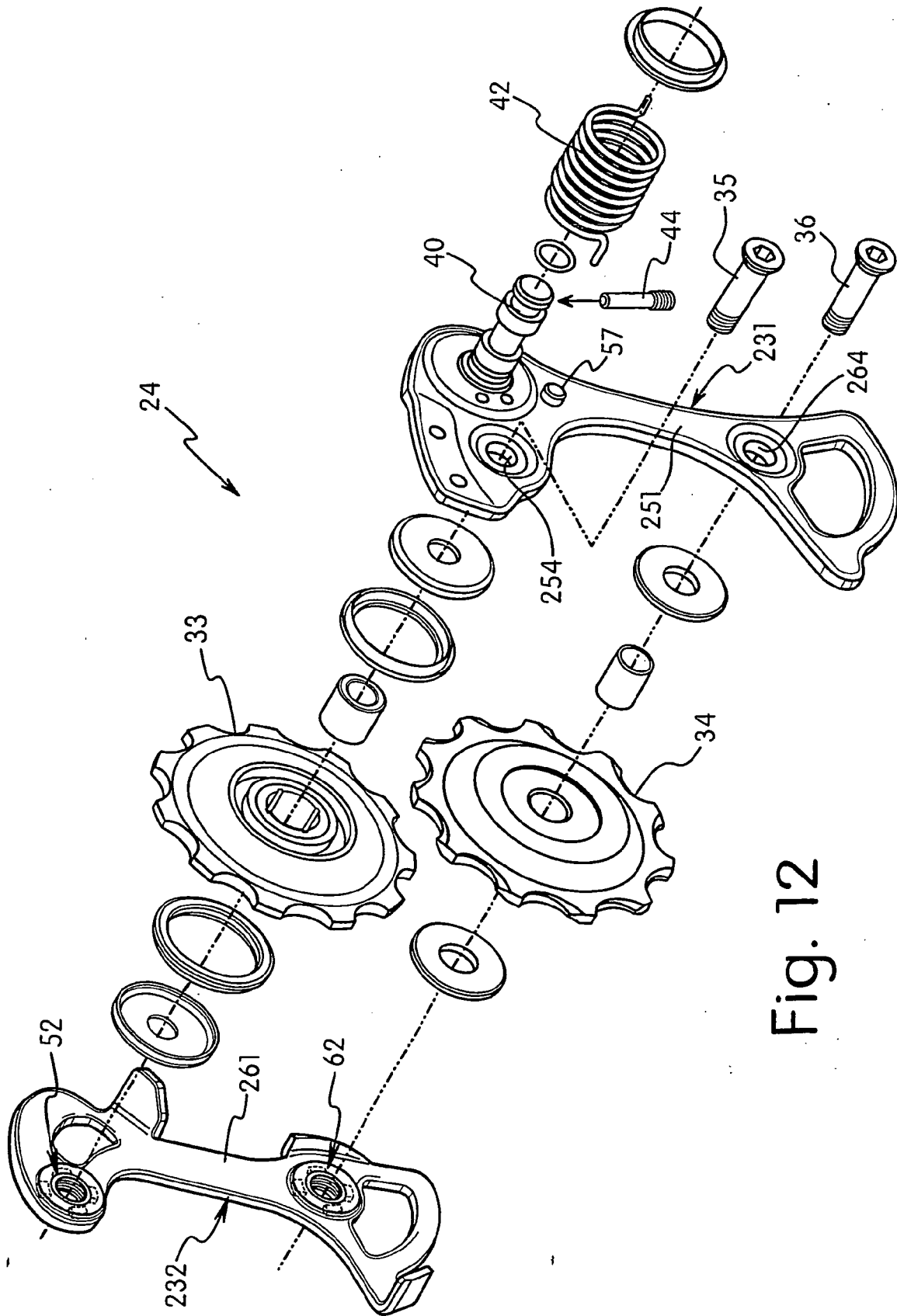

Fig. 12

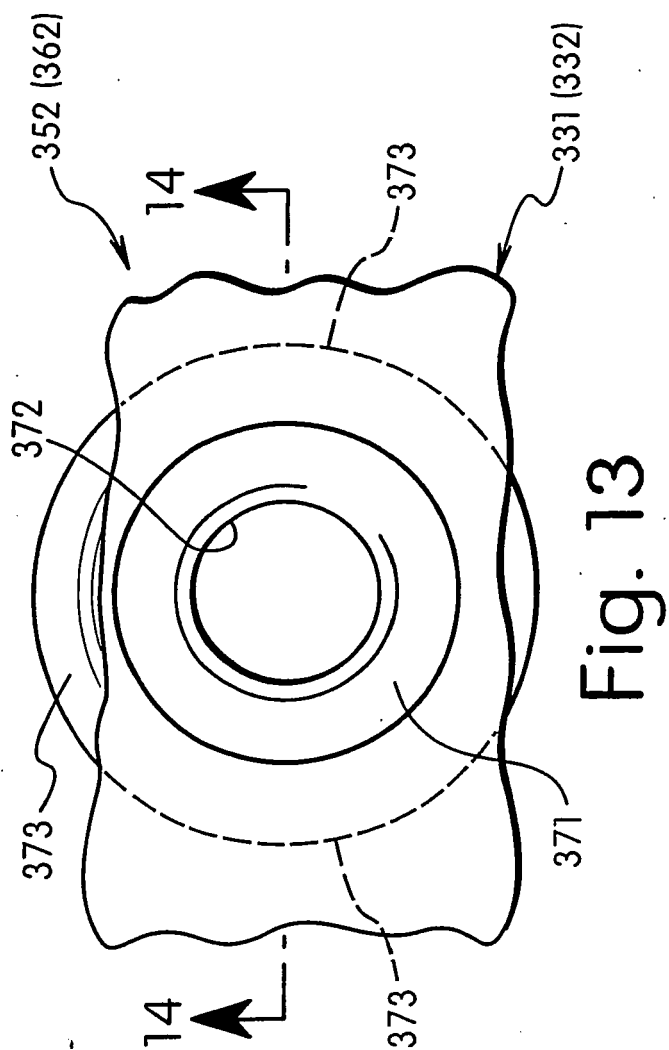

Fig. 13

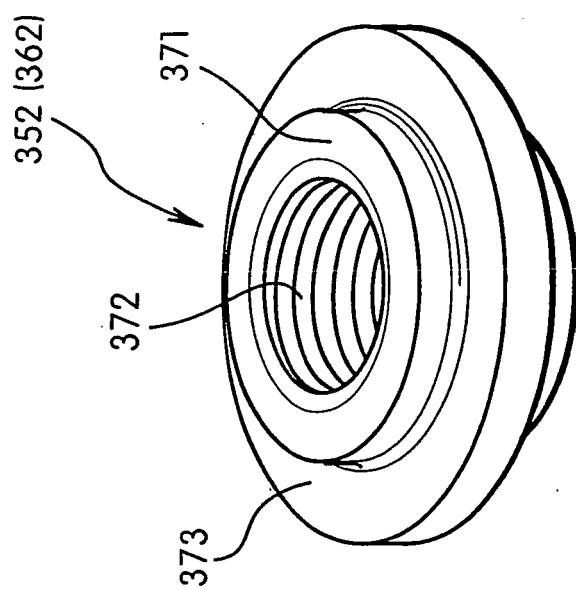

Fig. 15

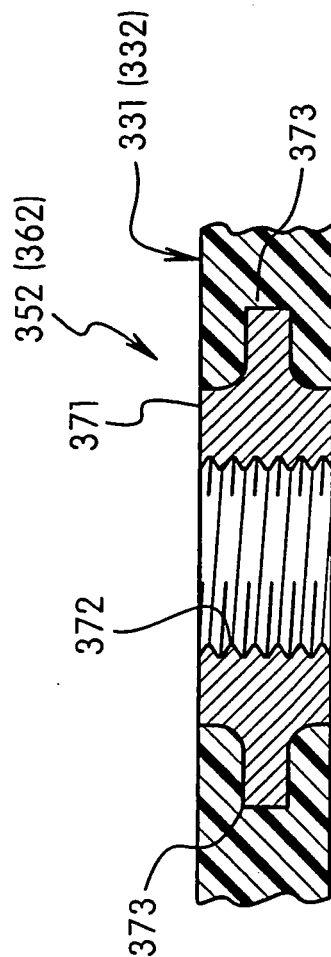
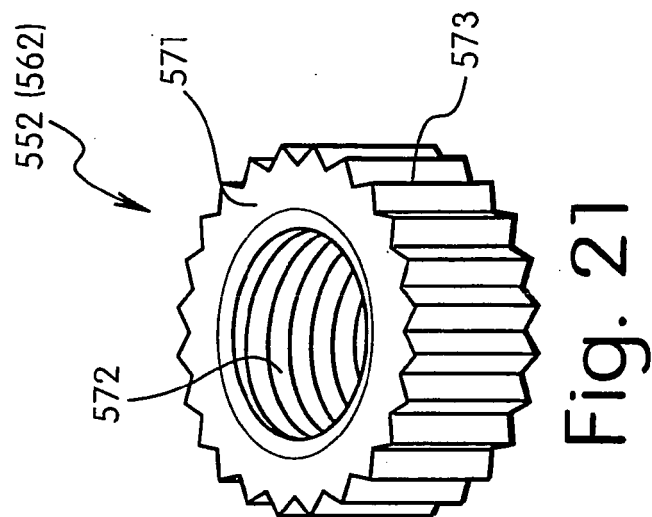
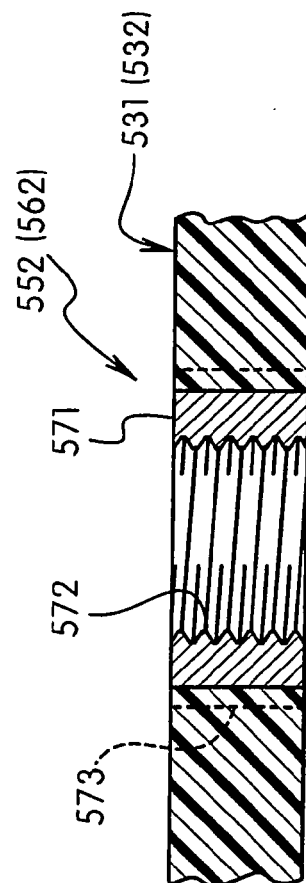
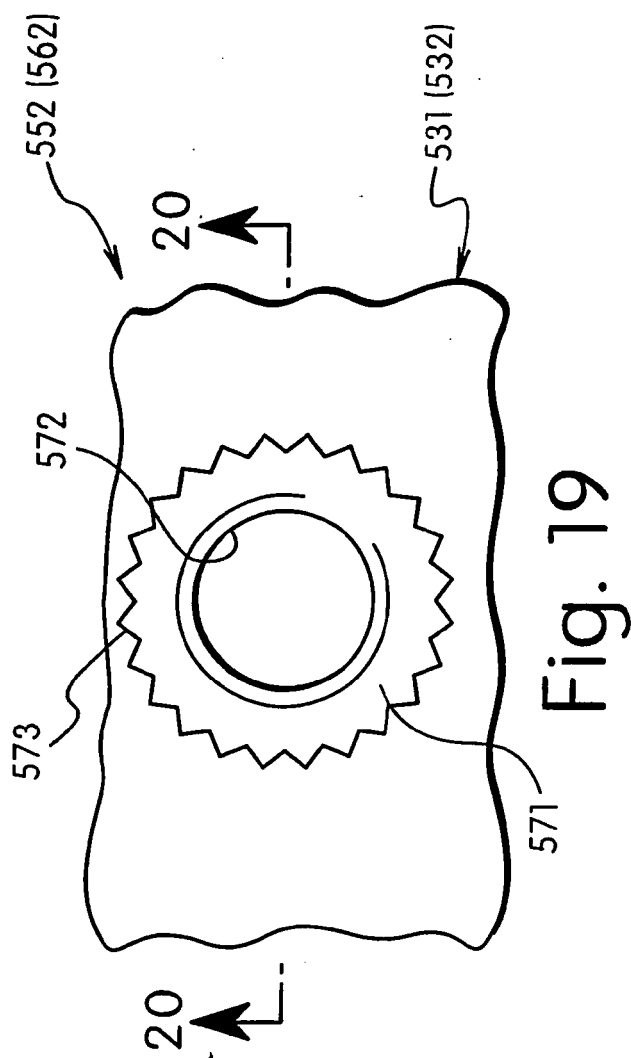

Fig. 14





European Patent
Office

EUROPEAN SEARCH REPORT

Application Number
EP 07 00 8897

DOCUMENTS CONSIDERED TO BE RELEVANT			
Category	Citation of document with indication, where appropriate, of relevant passages	Relevant to claim	CLASSIFICATION OF THE APPLICATION (IPC)
X	FR 2 520 693 A (SIMPLEX ETS [FR]) 5 August 1983 (1983-08-05)	1,2,4,5,7	INV. B62M9/16
Y	* page 5, line 20 - line 24; claims; figures *	3,6,8,9	B62M9/12

X	US 2003/083162 A1 (TSAI MING-CHIH [TW] ET AL) 1 May 2003 (2003-05-01) * claims; figures *	1	

Y	US 6 202 506 B1 (STORCK MARKUS [DE] ET AL) 20 March 2001 (2001-03-20) * claims; figures *	3,6	

Y	EP 1 568 591 A (SHIMANO KK [JP]) 31 August 2005 (2005-08-31) * figure 10 *	8,9	

A	US 4 580 327 A (JUY HENRI [FR]) 8 April 1986 (1986-04-08) * claims; figures *	1	

			TECHNICAL FIELDS SEARCHED (IPC)
			B62M B62K
The present search report has been drawn up for all claims			
Place of search The Hague		Date of completion of the search 11 March 2008	Examiner Grunfeld, Michael
CATEGORY OF CITED DOCUMENTS X : particularly relevant if taken alone Y : particularly relevant if combined with another document of the same category A : technological background O : non-written disclosure P : intermediate document T : theory or principle underlying the invention E : earlier patent document, but published on, or after the filing date D : document cited in the application L : document cited for other reasons & : member of the same patent family, corresponding document			

2

EPO FORM 1503 03.82 (P04C01)

**ANNEX TO THE EUROPEAN SEARCH REPORT
ON EUROPEAN PATENT APPLICATION NO.**

EP 07 00 8897

This annex lists the patent family members relating to the patent documents cited in the above-mentioned European search report.
The members are as contained in the European Patent Office EDP file on
The European Patent Office is in no way liable for these particulars which are merely given for the purpose of information.

11-03-2008

Patent document cited in search report		Publication date	Patent family member(s)		Publication date
FR 2520693	A	05-08-1983	ES	278003 U	01-11-1984
			IT	1160715 B	11-03-1987
			JP	1002556 B	17-01-1989
			JP	1524478 C	12-10-1989
			JP	58133987 A	09-08-1983

US 2003083162	A1	01-05-2003	NONE		

US 6202506	B1	20-03-2001	AT	191892 T	15-05-2000
			DE	29608748 U1	01-08-1996
			WO	9743167 A1	20-11-1997
			EP	0898542 A1	03-03-1999

EP 1568591	A	31-08-2005	CN	1660656 A	31-08-2005
			JP	3819396 B2	06-09-2006
			JP	2005238980 A	08-09-2005
			TW	237615 B	11-08-2005
			US	2005192141 A1	01-09-2005

US 4580327	A	08-04-1986	DE	3465928 D1	15-10-1987
			EP	0156089 A1	02-10-1985
			ES	296661 Y1	27-04-1990
			FR	2560816 A1	13-09-1985
			JP	60206794 A	18-10-1985

EPO FORM P0459

For more details about this annex : see Official Journal of the European Patent Office, No. 12/82