



(12) **EUROPEAN PATENT APPLICATION**

(88) Date of publication A3:
03.02.2010 Bulletin 2010/05

(51) Int Cl.:
F02M 61/14 (2006.01) B25B 27/24 (2006.01)

(43) Date of publication A2:
03.09.2008 Bulletin 2008/36

(21) Application number: **08000536.6**

(22) Date of filing: **14.01.2008**

(84) Designated Contracting States:
AT BE BG CH CY CZ DE DK EE ES FI FR GB GR HR HU IE IS IT LI LT LU LV MC MT NL NO PL PT RO SE SI SK TR
Designated Extension States:
AL BA MK RS

(71) Applicant: **Van Baal & Partners**
3411 NV Lopik (NL)

(72) Inventor: **Van Baal, Petrus Gerardus**
3401 PH IJsselstein (NL)

(74) Representative: **Huygens, Arthur Victor**
Octrooibureau Huygens
P.O. Box 86
3400 AB IJsselstein (NL)

(30) Priority: **13.01.2007 NL 1033222**

(54) **Apparatus for supporting a pulling device**

(57) The invention relates to an apparatus for supporting a pulling device (10) which is able to pull a tubular component (20) such as an atomiser from a cylindrical channel (21) in a cylinder head (12) of an engine, which comprises a supporting plate (6) having an annular supporting surface (7) with a centre line (9), and supporting means (4) for supporting the supporting plate (6) on the

cylinder head (12) as the centre line is positioned above the cylindrical channel (21).

In accordance with the present invention the supporting means (4) comprise a base plate (4) which on one side of the centre line (9) is provided with supporting surfaces, and wherein one or more supporting surfaces with the larger distance to the centre line can be pressed to the cylinder head (12) by means of a clip (1,2,3).

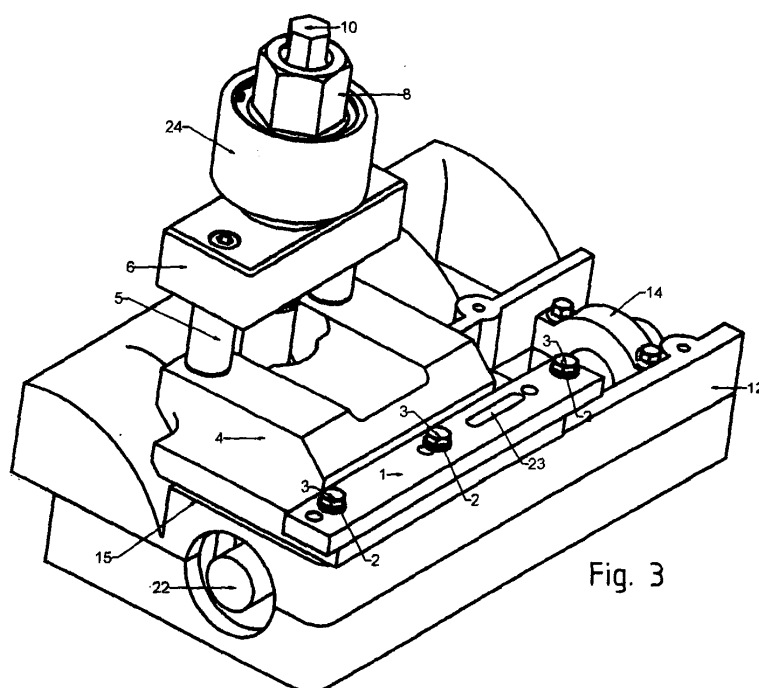

Fig. 3



EUROPEAN SEARCH REPORT

Application Number
EP 08 00 0536

DOCUMENTS CONSIDERED TO BE RELEVANT			
Category	Citation of document with indication, where appropriate, of relevant passages	Relevant to claim	CLASSIFICATION OF THE APPLICATION (IPC)
X	DE 20 2005 019595 U1 (KLANN SPEZIAL WERKZEUGBAU GMBH [DE]) 23 February 2006 (2006-02-23) * paragraphs [0038], [0046], [0051], [0053], [0054], [0073] * * figures 1-4,7-9 *	1-6	INV. F02M61/14 B25B27/24
X	US 2007/000113 A1 (DESILETS RICHARD [US]) 4 January 2007 (2007-01-04) * paragraphs [0018] - [0021] * * figures 3-7 *	1-4,6	
X	GB 907 046 A (JOHN HENRY CHOWN) 3 October 1962 (1962-10-03) * page 1, line 71 - page 2, line 50 * * figure 1 *	1-4,6	
A	DE 203 16 274 U1 (KLANN SPEZIAL WERKZEUGBAU GMBH [DE]) 15 January 2004 (2004-01-15) * figures 9,10 *	1	
The present search report has been drawn up for all claims			TECHNICAL FIELDS SEARCHED (IPC)
			B25B
3	Place of search Munich	Date of completion of the search 21 December 2009	Examiner Schultz, Tom
CATEGORY OF CITED DOCUMENTS X : particularly relevant if taken alone Y : particularly relevant if combined with another document of the same category A : technological background O : non-written disclosure P : intermediate document		T : theory or principle underlying the invention E : earlier patent document, but published on, or after the filing date D : document cited in the application L : document cited for other reasons & : member of the same patent family, corresponding document	

EPO FORM 1503 03.82 (P04C01)

**ANNEX TO THE EUROPEAN SEARCH REPORT
ON EUROPEAN PATENT APPLICATION NO.**

EP 08 00 0536

This annex lists the patent family members relating to the patent documents cited in the above-mentioned European search report.
The members are as contained in the European Patent Office EDP file on
The European Patent Office is in no way liable for these particulars which are merely given for the purpose of information.

21-12-2009

Patent document cited in search report	Publication date	Patent family member(s)	Publication date
DE 202005019595 U1	23-02-2006	EP 1797999 A2	20-06-2007
US 2007000113 A1	04-01-2007	NONE	
GB 907046 A	03-10-1962	NONE	
DE 20316274 U1	15-01-2004	DE 102004051059 A1	19-05-2005

EPO FORM P0459

For more details about this annex : see Official Journal of the European Patent Office, No. 12/82