



(12) **EUROPEAN PATENT APPLICATION**

(88) Date of publication A3:  
**13.07.2011 Bulletin 2011/28**

(51) Int Cl.:  
**E04G 3/00** (2006.01) **E04G 5/04** (2006.01)  
**E04G 21/32** (2006.01) **E04G 3/20** (2006.01)

(43) Date of publication A2:  
**24.09.2008 Bulletin 2008/39**

(21) Application number: **08001216.4**

(22) Date of filing: **23.01.2008**

(84) Designated Contracting States:  
**AT BE BG CH CY CZ DE DK EE ES FI FR GB GR HR HU IE IS IT LI LT LU LV MC MT NL NO PL PT RO SE SI SK TR**  
Designated Extension States:  
**AL BA MK RS**

(72) Inventor: **Taylor, Mark Brighton Essex BN1 6QX (GB)**

(74) Representative: **Hoarton, Lloyd Douglas Charles et al Forrester & Boehmert Pettenkoferstrasse 20-22 80336 Munich (DE)**

(30) Priority: **23.03.2007 GB 0705669**

(71) Applicant: **SGB Services Limited Leatherhead, Surrey KT22 7SG (GB)**

(54) **Scaffold arrangement**

(57) A scaffold arrangement (1) comprising a scaffold component (2) and a support unit (3) for releasably supporting the scaffold component in an operative position on a scaffold assembly or building, the support unit (3) comprising a mounting portion for fixedly mounting the support unit to said scaffold assembly, a supporting member for seating a first part of the scaffold component, and a releasable locking member moveable to a locking

position for locking the scaffold component to the support unit, the arrangement being such that when the scaffold component (2) is seated on the supporting member in said operative position, and the locking member is in said locking position, the locking member is spaced immediately below a second part of the scaffold component (2) and acts as a back-up supporting member for arresting uncontrolled downward movement of the scaffold component (2) relative to the support unit (3).

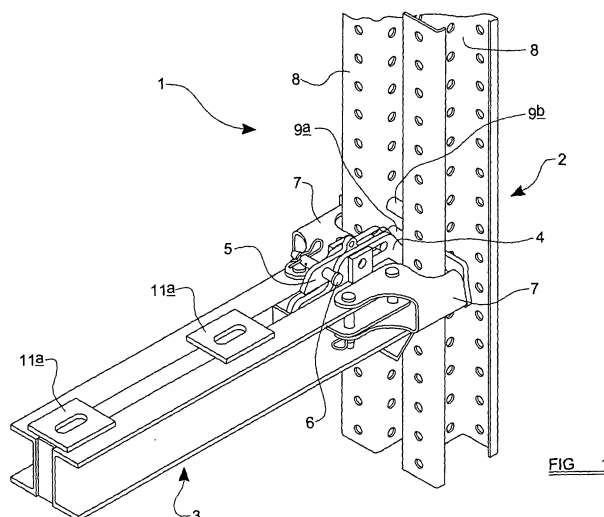

**FIG. 1**



## EUROPEAN SEARCH REPORT

Application Number  
EP 08 00 1216

DOCUMENTS CONSIDERED TO BE RELEVANT			
Category	Citation of document with indication, where appropriate, of relevant passages	Relevant to claim	CLASSIFICATION OF THE APPLICATION (IPC)
A	FR 2 151 624 A5 (SECURITE TECH INDUS) 20 April 1973 (1973-04-20) * page 3, line 11 - page 4, line 17; figures 3,4 *	1-12	INV. E04G3/00 E04G5/04 E04G21/32 E04G3/20
A	----- AU 2003 254 411 A1 (FORMULA ONE SELF DRIVING SCREE) 19 March 2004 (2004-03-19) * page 7, line 23 - page 8, line 7; figures 2,3 *	1	
A	----- AU 478 278 B2 (TRANS AUSTRALIA HOLDINGS) 29 November 1976 (1976-11-29) * pages 4,5 *	1	
The present search report has been drawn up for all claims			TECHNICAL FIELDS SEARCHED (IPC)
			E04G
Place of search		Date of completion of the search	Examiner
Munich		31 May 2011	Saretta, Guido
CATEGORY OF CITED DOCUMENTS		T : theory or principle underlying the invention E : earlier patent document, but published on, or after the filing date D : document cited in the application L : document cited for other reasons ..... & : member of the same patent family, corresponding document	
X : particularly relevant if taken alone Y : particularly relevant if combined with another document of the same category A : technological background O : non-written disclosure P : intermediate document			

1  
EPO FORM 1503 03.82 (P04C01)

**ANNEX TO THE EUROPEAN SEARCH REPORT  
ON EUROPEAN PATENT APPLICATION NO.**

EP 08 00 1216

This annex lists the patent family members relating to the patent documents cited in the above-mentioned European search report.  
The members are as contained in the European Patent Office EDP file on  
The European Patent Office is in no way liable for these particulars which are merely given for the purpose of information.

31-05-2011

Patent document cited in search report	Publication date	Patent family member(s)	Publication date
FR 2151624	A5	20-04-1973	NONE
AU 2003254411	A1	19-03-2004	NONE
AU 478278	B2	29-11-1976	AU 7426374 A 29-11-1976