



(12) **EUROPEAN PATENT APPLICATION**

(88) Date of publication A3:
09.03.2011 Bulletin 2011/10

(51) Int Cl.:
E05D 7/04 (2006.01)

(43) Date of publication A2:
31.12.2008 Bulletin 2009/01

(21) Application number: **08158210.8**

(22) Date of filing: **13.06.2008**

(84) Designated Contracting States:
AT BE BG CH CY CZ DE DK EE ES FI FR GB GR
HR HU IE IS IT LI LT LU LV MC MT NL NO PL PT
RO SE SI SK TR
 Designated Extension States:
AL BA MK RS

(30) Priority: **28.06.2007 IT PD20070221**

(71) Applicant: **Fratelli Comunello S.p.A.**
36027 Rosa (Vicenza) (IT)

(72) Inventor: **Lorenzetti, Paolo**
36027, Vicenza (IT)

(74) Representative: **Gallo, Luca**
Gallo & Partners S.r.l.
Via Trieste 49
35121 Padova (IT)

(54) **Adjustable hinge support and method for adjusting the position of said support**

(57) Adjustable hinge support designed to allow rotation of a leaf, in particular a gate, comprising a support plate intended to be fixed to a pillar, an internally threaded bush which is inserted inside an eyelet formed in the plate and has a threaded inner surface inside which the shank of the eye-piece of the hinge engages and a threaded

outer surface on which an adjusting ring engages, said ring being able to be fixed at the desired height by means of retaining grub screws. A tightening ring is also envisaged, said ring being engaged by means of screwing on the shank of the eye-piece and being able to fix the latter against the bush, coming into contact against the free edge of the said bush.

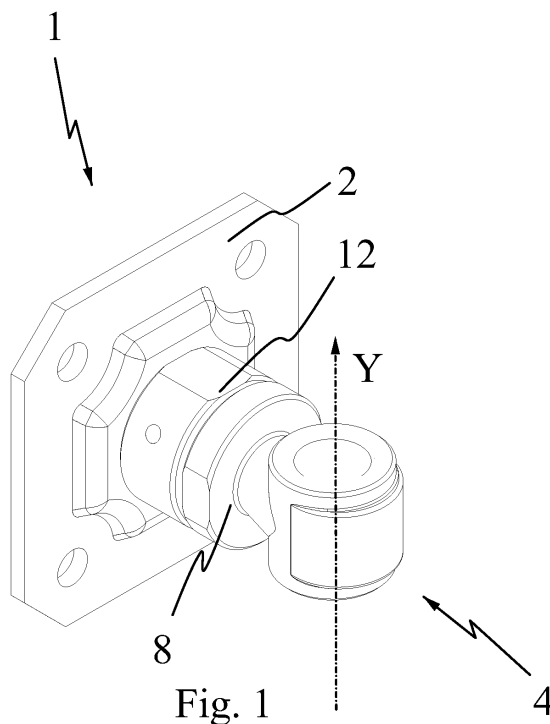

Fig. 1



EUROPEAN SEARCH REPORT

Application Number
EP 08 15 8210

DOCUMENTS CONSIDERED TO BE RELEVANT			
Category	Citation of document with indication, where appropriate, of relevant passages	Relevant to claim	CLASSIFICATION OF THE APPLICATION (IPC)
A	FR 2 679 590 A1 (TORDO BELGRANO SA [FR]) 29 January 1993 (1993-01-29) * abstract *	1	INV. E05D7/04
A	DE 32 17 131 A1 (POERSCHKE ECKHARD) 10 November 1983 (1983-11-10) * page 2, paragraph 4 * * figures 5,6 *	1	
			TECHNICAL FIELDS SEARCHED (IPC)
			E05D
The present search report has been drawn up for all claims			
Place of search The Hague		Date of completion of the search 31 January 2011	Examiner Van Kessel, Jeroen
<p>CATEGORY OF CITED DOCUMENTS</p> <p>X : particularly relevant if taken alone Y : particularly relevant if combined with another document of the same category A : technological background O : non-written disclosure P : intermediate document</p> <p>T : theory or principle underlying the invention E : earlier patent document, but published on, or after the filing date D : document cited in the application L : document cited for other reasons & : member of the same patent family, corresponding document</p>			

1
EPO FORM 1503 03/82 (P04C01)

**ANNEX TO THE EUROPEAN SEARCH REPORT
ON EUROPEAN PATENT APPLICATION NO.**

EP 08 15 8210

This annex lists the patent family members relating to the patent documents cited in the above-mentioned European search report.
The members are as contained in the European Patent Office EDP file on
The European Patent Office is in no way liable for these particulars which are merely given for the purpose of information.

31-01-2011

Patent document cited in search report	Publication date	Patent family member(s)	Publication date
FR 2679590	A1	29-01-1993	NONE
DE 3217131	A1	10-11-1983	NONE