



(11) **EP 2 039 638 A3**

(12) **EUROPEAN PATENT APPLICATION**

(88) Date of publication A3:  
**17.03.2010 Bulletin 2010/11**

(51) Int Cl.:  
**B65H 43/08 (2006.01) B65H 45/22 (2006.01)**  
**B65H 23/032 (2006.01) B65H 45/18 (2006.01)**

(43) Date of publication A2:  
**25.03.2009 Bulletin 2009/13**

(21) Application number: **08015466.9**

(22) Date of filing: **02.09.2008**

(84) Designated Contracting States:  
**AT BE BG CH CY CZ DE DK EE ES FI FR GB GR**  
**HR HU IE IS IT LI LT LU LV MC MT NL NO PL PT**  
**RO SE SI SK TR**  
Designated Extension States:  
**AL BA MK RS**

(71) Applicant: **Komori Corporation**  
**Sumida-ku**  
**Tokyo (JP)**

(72) Inventor: **Yamamoto, Osamu**  
**Noda-shi**  
**Chiba (JP)**

(30) Priority: **20.09.2007 JP 2007243716**  
**29.07.2008 JP 2008194746**

(74) Representative: **UEXKÜLL & STOLBERG**  
**Patentanwälte**  
**Beselerstrasse 4**  
**22607 Hamburg (DE)**

(54) **Control method and apparatus for strip-shaped material printing press**

(57) A control apparatus for a web rotary printing press includes: a detector (29), located downstream of a former (108) and provided halfway through a transport path for a web (Wb) or a signature (Sb1) from the former (108) to a chopper (107b), for detecting the position of an end portion of the web (Wb) on a side folded by the former (108); and a former and turn bar control device (10) for adjusting the position, in the paper flow direction, of the former (108) or the position, in the lateral direction, of the chopper (107b) in response to an output from the detector (29).

**Fig.11**

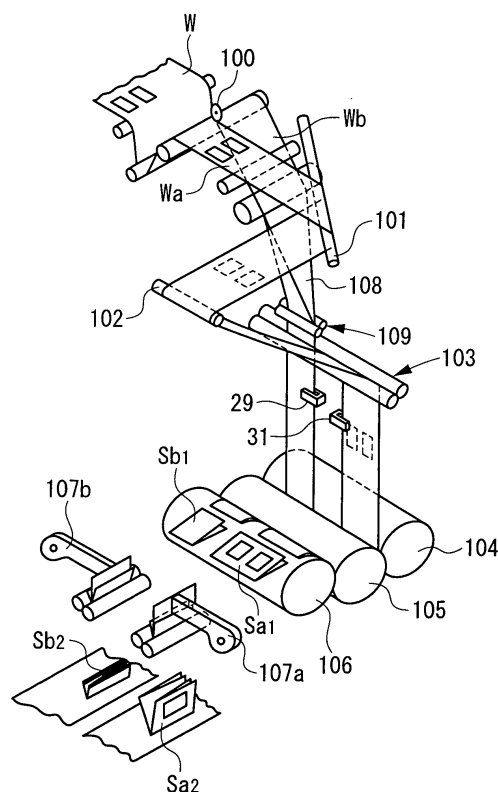

**EP 2 039 638 A3**



## EUROPEAN SEARCH REPORT

Application Number  
EP 08 01 5466

DOCUMENTS CONSIDERED TO BE RELEVANT			
Category	Citation of document with indication, where appropriate, of relevant passages	Relevant to claim	CLASSIFICATION OF THE APPLICATION (IPC)
X	JP 08 174804 A (TOPPAN PRINTING CO LTD) 9 July 1996 (1996-07-09) * the whole document *	1-4	INV. B65H43/08 B65H45/22 B65H23/032 B65H45/18
A,D	JP 59 179346 A (KOMORI PRINTING MACH) 11 October 1984 (1984-10-11) * abstract; figures 1,2 *	1-4	
A,D	JP 07 041247 A (KOMORI PRINTING MACH) 10 February 1995 (1995-02-10) * abstract; figures 1-5 *	1-4	
P,X	DE 10 2006 035289 B3 (KOENIG & BAUER AG [DE]) 31 January 2008 (2008-01-31) * the whole document *	1-4	
L	JP 2009 208881 A (MITSUBISHI HEAVY IND LTD) 17 September 2009 (2009-09-17) * the whole document *	1-4	
A	WO 2004/074151 A (KOENIG & BAUER AG [DE]; BOPPEL JOHANNES [DE]; LEIDIG PETER WILHELM KUR) 2 September 2004 (2004-09-02) * the whole document *	1-4	TECHNICAL FIELDS SEARCHED (IPC) B65H
A	JP 63 242851 A (TOPPAN PRINTING CO LTD) 7 October 1988 (1988-10-07) * abstract; figures 1-4 *	1-4	
A	JP 57 042455 A (TOUHIN SEIKI KK) 10 March 1982 (1982-03-10) * abstract; figures 1,2 *	1-4	
The present search report has been drawn up for all claims			
Place of search The Hague		Date of completion of the search 3 February 2010	Examiner Jezierski, Krzysztof
CATEGORY OF CITED DOCUMENTS X : particularly relevant if taken alone Y : particularly relevant if combined with another document of the same category A : technological background O : non-written disclosure P : intermediate document T : theory or principle underlying the invention E : earlier patent document, but published on, or after the filing date D : document cited in the application L : document cited for other reasons & : member of the same patent family, corresponding document			

 3  
EPO FORM 1503 03.82 (P04C01)

**ANNEX TO THE EUROPEAN SEARCH REPORT  
ON EUROPEAN PATENT APPLICATION NO.**

EP 08 01 5466

This annex lists the patent family members relating to the patent documents cited in the above-mentioned European search report.  
The members are as contained in the European Patent Office EDP file on  
The European Patent Office is in no way liable for these particulars which are merely given for the purpose of information.

03-02-2010

Patent document cited in search report	Publication date	Patent family member(s)	Publication date
JP 8174804 A	09-07-1996	NONE	
JP 59179346 A	11-10-1984	JP 1583593 C	22-10-1990
		JP 2008902 B	27-02-1990
JP 7041247 A	10-02-1995	JP 3404079 B2	06-05-2003
DE 102006035289 B3	31-01-2008	NONE	
JP 2009208881 A	17-09-2009	NONE	
WO 2004074151 A	02-09-2004	AT 326417 T	15-06-2006
		AT 388918 T	15-03-2008
		AT 337249 T	15-09-2006
		AT 347489 T	15-12-2006
		EP 1594784 A1	16-11-2005
JP 63242851 A	07-10-1988	JP 2058095 C	10-06-1996
		JP 7090945 B	04-10-1995
JP 57042455 A	10-03-1982	NONE	