



(12) **CORRECTED EUROPEAN PATENT APPLICATION**

(15) Correction information:  
**Corrected version no 1 (W1 A1)**  
**Corrections, see**  
**Bibliography INID code(s) 71**

(51) Int Cl.:  
**B60G 7/00 (2006.01) B60G 9/02 (2006.01)**

(48) Corrigendum issued on:  
**16.12.2009 Bulletin 2009/51**

(43) Date of publication:  
**01.07.2009 Bulletin 2009/27**

(21) Application number: **08169749.2**

(22) Date of filing: **24.11.2008**

(84) Designated Contracting States:  
**AT BE BG CH CY CZ DE DK EE ES FI FR GB GR**  
**HR HU IE IS IT LI LT LU LV MC MT NL NO PL PT**  
**RO SE SI SK TR**  
Designated Extension States:  
**AL BA MK RS**

(71) Applicant: **Faresin Industries S.p.A.**  
**36042 Breganze VI (IT)**

(72) Inventor: **Faresin, Sante**  
**36042 Breganze, Frazione Maragnole VI (IT)**

(74) Representative: **Modiano, Micaela Nadia et al**  
**Dr. Modiano & Associati SpA**  
**Via Meravigli 16**  
**20123 Milano (IT)**

(30) Priority: **19.12.2007 IT PD20070417**

(54) **Articulated suspension particularly for connection between the axle and the chassis of a work vehicle**

(57) An articulated suspension (10), particularly for connection between the axle (11) and the chassis (12) of a work vehicle, which comprises elements (13) that yield elastically, in a damped manner, for supporting the chassis (12) on the axle (11), and arms (14) for connection between the axle (11) and the chassis (12). The arms (14) are connected to the chassis (12) and to the axle (11) by means of articulations (15) that form three axes of rotation (A, B, C) of the arms (14) with respect to the

chassis (12) and the axle (11).

A first axis of rotation (A) is parallel to the axis of longitudinal extension of the arm (14), the second axis (B) is parallel to the longitudinal axis of the axle (11), and the third axis (C) is perpendicular to the first two axes (A, B).

The suspension (10) is adapted to allow the mutual rotation of the axle (11) and of the chassis (12) mainly about a roll axis (D) of the work vehicle.

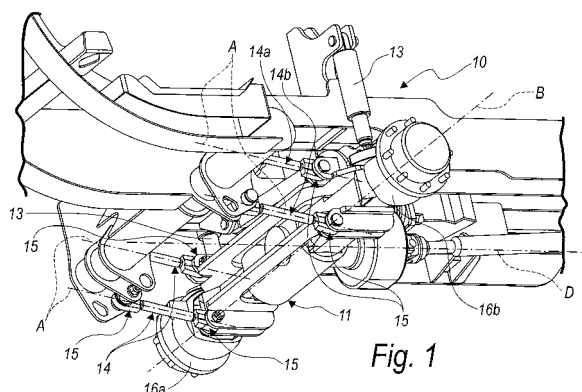

Fig. 1