



(12) **EUROPEAN PATENT APPLICATION**

(88) Date of publication A3:
05.03.2014 Bulletin 2014/10

(51) Int Cl.:
E05C 17/16 (2006.01)

(43) Date of publication A2:
05.08.2009 Bulletin 2009/32

(21) Application number: **09100068.7**

(22) Date of filing: **23.01.2009**

(84) Designated Contracting States:
AT BE BG CH CY CZ DE DK EE ES FI FR GB GR HR HU IE IS IT LI LT LU LV MC MK MT NL NO PL PT RO SE SI SK TR
Designated Extension States:
AL BA RS

(30) Priority: **24.01.2008 GB 0801277**
10.05.2008 GB 0808511

(71) Applicant: **J. Banks & Co. Ltd.**
Tipton
West Midlands DY4 9LE (GB)

(72) Inventors:
• **Wellman, David Anthony**
Aldridge, West Midlands WS9 0JW (GB)
• **Harrison, Peter James**
Darlaston, West Midlands WS10 7QT (GB)

(74) Representative: **Gee, Steven William**
D.W. & S.W. GEE
1 South Lynn Gardens
London Road
Shipston on Stour
Warwickshire CV36 4ER (GB)

(54) **Window restrictor**

(57) This invention relates to a window restrictor, primarily for use upon a tilt and turn window. The window has a window frame (2) and a window panel (1) which is movable relative to the frame between a closed position and an open position, the window panel having a lip (90) which overlies a part of the window frame when the window panel is closed. The window restrictor has a first mounting part (16; 116) adapted for mounting upon an edge (9) of the window frame in the gap between the window frame and the window panel, a stay (20; 120) pivotably mounted upon the first mounting part, the stay comprising a beam (32) and a hooked end (34; 134), the hooked end being adapted to engage and retain a peg (36; 136) mounted upon the window panel, the stay being resiliently biased relative to the first mounting part, a second mounting part (12; 112) adapted for mounting upon the edge (9) of the window frame adjacent to the lip (90) of the window panel, a slider (14; 114) which is movably mounted upon the second mounting part, the slider having a control member (84; 184) adapted to lie underneath the lip and to engage the stay. When used with a tilt and turn window the peg may be the stud of the tilt and turn mechanism.

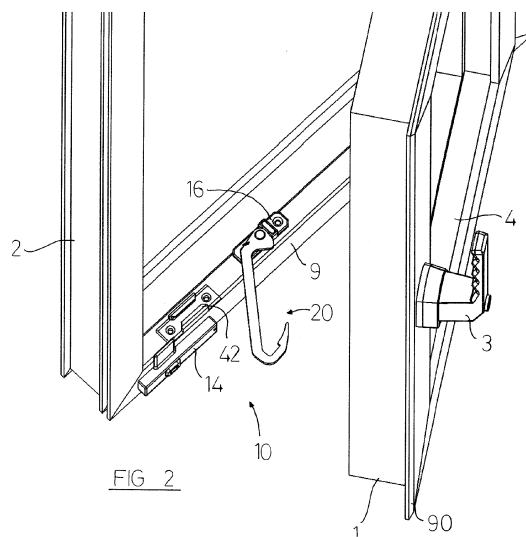



EUROPEAN SEARCH REPORT

Application Number
EP 09 10 0068

DOCUMENTS CONSIDERED TO BE RELEVANT			
Category	Citation of document with indication, where appropriate, of relevant passages	Relevant to claim	CLASSIFICATION OF THE APPLICATION (IPC)
A	GB 2 353 560 A (LATHAM LTD [GB]) 28 February 2001 (2001-02-28) * page 5, line 8 - page 6, line 20 * * page 8, line 23 - page 9, line 6 * * figures 1-2 * -----	1-12	INV. E05C17/16
A	GB 2 288 433 A (BANKS J & CO LTD [GB]) 18 October 1995 (1995-10-18) * page 8, line 27 - page 9, line 9 * * page 9, line 25 - page 12, line 10 * * page 14, line 22 - page 15, line 5 * * figures 3-6 * -----	1-12	
			TECHNICAL FIELDS SEARCHED (IPC)
			E05C
The present search report has been drawn up for all claims			
Place of search The Hague		Date of completion of the search 27 January 2014	Examiner Antonov, Ventseslav
<p>CATEGORY OF CITED DOCUMENTS</p> <p>X : particularly relevant if taken alone Y : particularly relevant if combined with another document of the same category A : technological background O : non-written disclosure P : intermediate document</p> <p>T : theory or principle underlying the invention E : earlier patent document, but published on, or after the filing date D : document cited in the application L : document cited for other reasons & : member of the same patent family, corresponding document</p>			

2

EPO FORM 1503 03.82 (P04C01)

**ANNEX TO THE EUROPEAN SEARCH REPORT
ON EUROPEAN PATENT APPLICATION NO.**

EP 09 10 0068

This annex lists the patent family members relating to the patent documents cited in the above-mentioned European search report.
The members are as contained in the European Patent Office EDP file on
The European Patent Office is in no way liable for these particulars which are merely given for the purpose of information.

27-01-2014

Patent document cited in search report	Publication date	Patent family member(s)	Publication date
GB 2353560	A	28-02-2001	NONE

GB 2288433	A	18-10-1995	NONE

EPO FORM P0459

For more details about this annex : see Official Journal of the European Patent Office, No. 12/82