



(12) **EUROPEAN PATENT APPLICATION**

(88) Date of publication A3:
18.11.2009 Bulletin 2009/47

(51) Int Cl.:
E05F 15/14 ^(2006.01) **E05F 15/12** ^(2006.01)
E05F 15/10 ^(2006.01)

(43) Date of publication A2:
05.08.2009 Bulletin 2009/32

(21) Application number: **09380004.3**

(22) Date of filing: **21.01.2009**

(84) Designated Contracting States:
AT BE BG CH CY CZ DE DK EE ES FI FR GB GR HR HU IE IS IT LI LT LU LV MC MK MT NL NO PL PT RO SE SI SK TR
Designated Extension States:
AL BA RS

(71) Applicant: **MASATS, S.A.**
08253 Sant Salvador de Guardiola (ES)

(72) Inventor: **Palleja Pares, Joan**
08253 Sant Salvador de Guardiola (ES)

(74) Representative: **De Verdonces Llargués, Enrique**
Surgranes - Verdonces - Ferregüela
304, calle Provenza
08008 Barcelona (ES)

(30) Priority: **31.01.2008 ES 200800250**

(54) **Device for coupling and uncoupling an opening and closing mechanism for vehicle doors from a corresponding drive motor**

(57) The present invention relates to a device suitable for mechanisms comprising a speed reducer unit with a gear wheel geared with the motor, comprising a support plate for supporting the motor, which can rotate in both directions about a shaft integral with the speed reducer unit, and movement means for moving the support plate comprising an angular lever the resistance arm of which

comprises a first end portion, provided with a bar articulated thereto and to a point of the support plate, and a side appendage defining a second end portion, this end portion being subjected to the action of elastic means tending to move the lever towards a stable position of gearing between the gear wheel and the shaft of the motor.

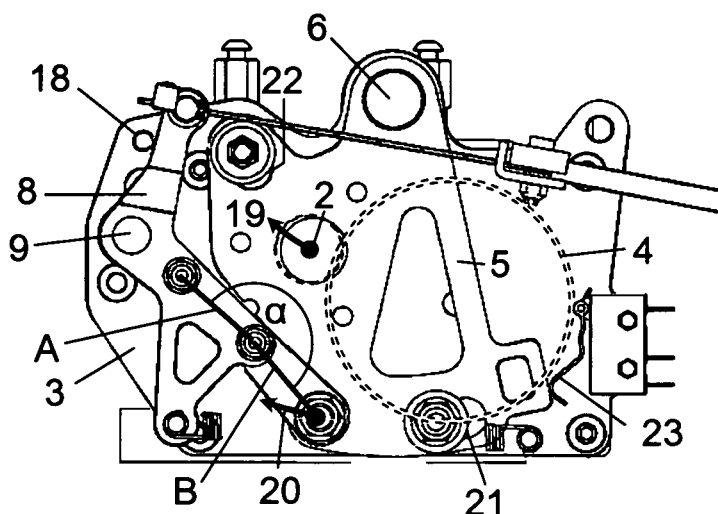

Fig. 4



EUROPEAN SEARCH REPORT

Application Number
EP 09 38 0004

DOCUMENTS CONSIDERED TO BE RELEVANT			
Category	Citation of document with indication, where appropriate, of relevant passages	Relevant to claim	CLASSIFICATION OF THE APPLICATION (IPC)
A	DE 199 27 169 A1 (BODE GMBH & CO KG [DE]) 21 December 2000 (2000-12-21) * column 1, line 63 - column 3, line 36; claim 1; figures 1-3 * -----	1-5	INV. E05F15/14 E05F15/12 E05F15/10
D,A	ES 2 162 758 A1 (MASATS SA [ES]) 1 January 2002 (2002-01-01) * the whole document * -----	1-5	
			TECHNICAL FIELDS SEARCHED (IPC)
			E05F
The present search report has been drawn up for all claims			
Place of search Munich		Date of completion of the search 8 October 2009	Examiner Balice, Marco
<p>CATEGORY OF CITED DOCUMENTS</p> <p>X : particularly relevant if taken alone Y : particularly relevant if combined with another document of the same category A : technological background O : non-written disclosure P : intermediate document</p> <p>T : theory or principle underlying the invention E : earlier patent document, but published on, or after the filing date D : document cited in the application L : document cited for other reasons & : member of the same patent family, corresponding document</p>			

3
EPO FORM 1503 03.82 (P04C01)

**ANNEX TO THE EUROPEAN SEARCH REPORT
ON EUROPEAN PATENT APPLICATION NO.**

EP 09 38 0004

This annex lists the patent family members relating to the patent documents cited in the above-mentioned European search report.
The members are as contained in the European Patent Office EDP file on
The European Patent Office is in no way liable for these particulars which are merely given for the purpose of information.

08-10-2009

Patent document cited in search report	Publication date	Patent family member(s)	Publication date
DE 19927169	A1	21-12-2000	AT 283959 T 15-12-2004
		EP 1072749 A2 31-01-2001	
		ES 2231073 T3 16-05-2005	

ES 2162758	A1	01-01-2002	NONE
