



(12) **EUROPEAN PATENT APPLICATION**

(88) Date of publication A3:
05.05.2010 Bulletin 2010/18

(51) Int Cl.:
A61G 5/08 (2006.01)

(43) Date of publication A2:
09.09.2009 Bulletin 2009/37

(21) Application number: **08169924.1**

(22) Date of filing: **25.11.2008**

(84) Designated Contracting States:
AT BE BG CH CY CZ DE DK EE ES FI FR GB GR HR HU IE IS IT LI LT LU LV MC MT NL NO PL PT RO SE SI SK TR
Designated Extension States:
AL BA MK RS

(72) Inventor: **Jinks, Steven**
Tyseley
Birmingham, West Midlands B11 3RS (GB)

(74) Representative: **Shaw, Matthew Nigel**
Forrester & Boehmert
Pettenkoferstrasse 20-22
80336 München (DE)

(30) Priority: **08.03.2008 GB 0804348**

(71) Applicant: **Evac + Chair International Limited**
Birmingham West Midlands B11 3RS (GB)

(54) **Wheelchair**

(57) A wheelchair (10) is described including a pair of side frames (14, 16) and at least one footrest (32), each side frame (14, 16) having a lower frame part (14a, 16a) and an upper frame part (14b, 16b) which are moveable relative to each other between a 'storage' condition, in which an uppermost part of each upper frame part (14b, 16b) is positioned remotely from its respective lower frame support (14a, 16a), and an 'in use' condition, in which the uppermost part of each upper frame part (14b, 16b) is positioned closer to its respective lower frame part (14a, 16a), wherein movement of the upper frame parts (14b, 16b) from their 'storage' condition to their 'in use' condition effects movement of the footrest (32) to a deployed condition.

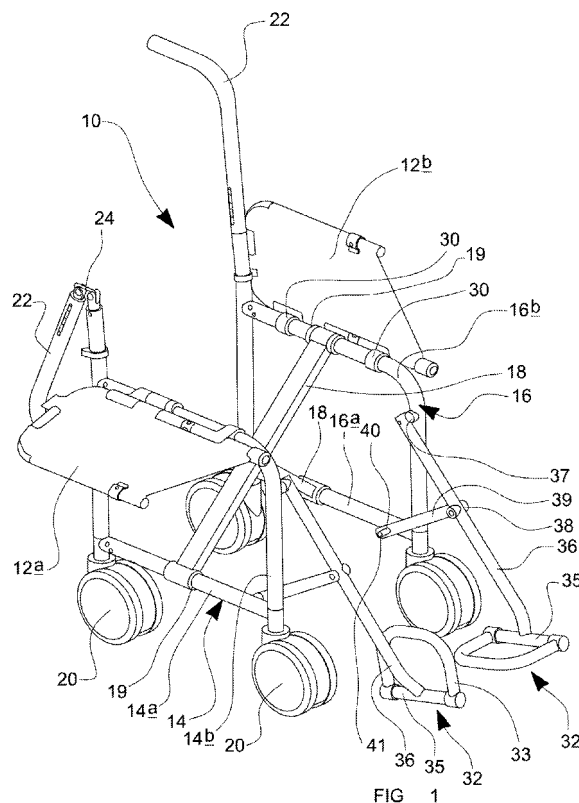



EUROPEAN SEARCH REPORT

Application Number
EP 08 16 9924

DOCUMENTS CONSIDERED TO BE RELEVANT			
Category	Citation of document with indication, where appropriate, of relevant passages	Relevant to claim	CLASSIFICATION OF THE APPLICATION (IPC)
X	GB 646 902 A (STANLEY ALBERT ELDRIDGE) 29 November 1950 (1950-11-29) * the whole document *	1-2,4-7	INV. A61G5/08
A	US 2 379 566 A (SAM DUKE) 3 July 1945 (1945-07-03) * the whole document *	1-7	
			TECHNICAL FIELDS SEARCHED (IPC)
			A61G
The present search report has been drawn up for all claims			
Place of search The Hague		Date of completion of the search 25 March 2010	Examiner Godot, Thierry
<p>CATEGORY OF CITED DOCUMENTS</p> <p>X : particularly relevant if taken alone Y : particularly relevant if combined with another document of the same category A : technological background O : non-written disclosure P : intermediate document</p> <p>T : theory or principle underlying the invention E : earlier patent document, but published on, or after the filing date D : document cited in the application L : document cited for other reasons & : member of the same patent family, corresponding document</p>			

2
EPO FORM 1503 03.02 (P04C01)

**ANNEX TO THE EUROPEAN SEARCH REPORT
ON EUROPEAN PATENT APPLICATION NO.**

EP 08 16 9924

This annex lists the patent family members relating to the patent documents cited in the above-mentioned European search report.
The members are as contained in the European Patent Office EDP file on
The European Patent Office is in no way liable for these particulars which are merely given for the purpose of information.

25-03-2010

Patent document cited in search report		Publication date	Patent family member(s)	Publication date
GB 646902	A	29-11-1950	NONE	

US 2379566	A	03-07-1945	NONE	
