



(12) **EUROPEAN PATENT APPLICATION**

(43) Date of publication:  
**14.10.2009 Bulletin 2009/42**

(51) Int Cl.:  
**F24F 1/00 (2006.01) F24F 13/20 (2006.01)**

(21) Application number: **09005100.4**

(22) Date of filing: **07.04.2009**

(84) Designated Contracting States:  
**AT BE BG CH CY CZ DE DK EE ES FI FR GB GR HR HU IE IS IT LI LT LU LV MC MK MT NL NO PL PT RO SE SI SK TR**

(30) Priority: **08.04.2008 JP 2008100258**

(71) Applicant: **Hitachi Appliances, Inc.**  
**Minato-ku**  
**Tokyo (JP)**

(72) Inventors:  
• **Nagahashi, Katsuaki**  
**Shizuoka-shi**  
**Shizuoka (JP)**

- **Sato, Ryoji**  
**Shizuoka-shi**  
**Shizuoka (JP)**
- **Kishitani, Tetsushi**  
**Shizuoka-shi**  
**Shizuoka (JP)**
- **Endo, Michiko**  
**Shizuoka-shi**  
**Shizuoka (JP)**
- **Kosugi, Shinichi**  
**Shizuoka-shi**  
**Shizuoka (JP)**

(74) Representative: **Beetz & Partner**  
**Patentanwälte**  
**Steinsdorfstrasse 10**  
**80538 München (DE)**

(54) **Heat source unit installed into ceiling and air conditioner**

(57) A heat source unit, for facilitating the maintenance of a fan assembly even in a ceiling having a limited space, including: a rectangular housing (12); an air inlet (24) and an air outlet (26) which are provided in the same side surface of the housing; a fan assembly (18) which includes a sirocco fan (28) disposed in the housing and a fan motor (30) driving the sirocco fan; a heat exchanger (16) which performs a heat exchange using air sucked from the air inlet; and a compressor (14). Particularly, on a side surface (36) (rear side surface) opposed to a side surface (22) (front side surface) on which the air inlet of the housing is provided, there is provided an openable extraction port which is used to extract the fan assembly. In addition, on a separation plate (38) of the housing is provided a pair of guide rails (58) which are disposed in a direction along left and right side surfaces (32 and 34) of the housing, and a mounting member (43) to which the fan assembly is fixed is guided by the guide rails so as to be extracted to the outside of the housing in a sliding manner.

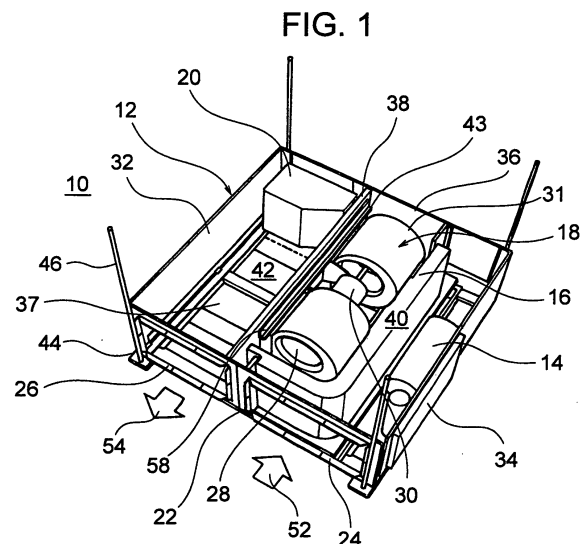

## Description

### Field of the Invention

**[0001]** The present invention relates to a heat source unit installed into a ceiling and an air conditioner, and more particularly, to a technology for facilitating the maintenance of a fan assembly including a fan motor and a blowing fan of a heat source unit installed into a ceiling.

### Description of the Related Art

**[0002]** Recently, in order to preserve the scenic beauty of the street having a historical scenery in a historical street (for example, Kyoto), the government establishes laws related to the regulation of the building height, the prohibition of the electric advertising displays, and the like. From this viewpoint, it is desirable to hide an outdoor unit of an air conditioner so as not to be noticeable.

**[0003]** Therefore, the outdoor unit installed on the outside of a building is installed into a ceiling of the building so as to be hidden therein and not to be noticeable from the outside of the building. In this kind of the heat source unit installed into a ceiling, it is required to facilitate the maintenance of components constituting the heat source unit, that is, particularly a component such as a fan assembly including a blowing fan and a fan motor driving the blowing fan.

**[0004]** That is, since it is troublesome to detach the heat source unit, installed into a ceiling, for the maintenance of the component, it is desirable to carry out the maintenance in such a manner that only the target component is extracted for the maintenance and after the maintenance, it is returned to its original position while the heat source unit itself is installed in the ceiling. However, since the type or size of a space in the ceiling is different for each building and the space in the ceiling is narrow in some buildings, a space used for a series of operations of extracting and returning the target component may not be ensured in some cases.

**[0005]** In detail, when the height dimension in the ceiling is small, a top surface of a housing may not be detached for an operation of extracting and returning the target component. In addition, in the case where a side surface of the housing is provided with an air inlet and an air outlet for a heat exchange, since an air inlet duct or an air outlet duct is mounted to the side surface provided with the air inlet and the air outlet, it is difficult to extract and return the target component via this side surface.

**[0006]** Although it may be supposed that the air inlet and the air outlet are provided in the same side surface of the housing, it is difficult to extract and return the target component via the left and right side surfaces of the housing in the case that plural heat source units are continuously installed side by side.

**[0007]** For this reason, JP-A-2005-133969 discloses a technology in which a mounting member fixed with a

blowing fan and a motor driving the blowing fan is mounted to a mounting plate vertically installed in a housing and moves in a sliding manner in a downward direction of an air conditioner body. According to this technology, it is described that the maintenance of the driving motor is easily carried out just by extracting the mounting member in a downward direction of the air conditioner body.

**[0008]** However, the technology disclosed in JP-A-2005-133969 may not be suitable for the maintenance of the fan assembly of the heat source unit installed into a ceiling of a building.

**[0009]** That is, when the ceiling provided with the heat source unit is made of concrete in some buildings, it is difficult to form an opening which is used to extract and return the fan assembly.

**[0010]** In addition, since the heat source unit is provided with heavy components such as a fan assembly, a compressor, and a heat exchanger, the heat source unit may weigh 100 kg or more in accordance with its type. Accordingly, the housing's bottom surface supporting the heavy components is required to have the sufficient strength. However, when the bottom surface of the housing is provided with the opening used to extract and return the fan assembly, the strength of the housing reduces. Accordingly, it is not desirable to form the opening in the bottom surface.

### Brief Summary of the Invention

**[0011]** Therefore, an object of the invention is to provide a heat source unit installed into a ceiling capable of facilitating the maintenance of a fan assembly even in a ceiling having a limited space.

**[0012]** According to an aspect of the invention, there is provided a heat source unit installed into a ceiling including: a rectangular housing; an air inlet and an air outlet which are provided on the same side surface of the housing or respectively provided on side surfaces not opposed to each other; a fan assembly which includes a centrifugal fan disposed in the housing and a fan motor driving the centrifugal fan; a heat exchanger which performs a heat exchange using air sucked from the air inlet; and a compressor, and the heat source unit is disposed into the ceiling of a building.

**[0013]** In particular, on a side surface opposed to the side surface on which the air inlet of the housing is provided is provided an openable extraction port which is used to extract the fan assembly and a slide mechanism which is used to slide the fan assembly to the outside of the housing via the extraction port.

**[0014]** That is, in the heat source unit having the above-described configuration, assuming that the side surface on which the air inlet of the housing is provided is set to the front side surface, the extraction port configured to be openable for the maintenance is provided on the rear side surface opposed to the front side surface, and the fan assembly is moved to the outside in a sliding manner via the extraction port so as to carry out the maintenance.

**[0015]** With such a configuration, even when the maintenance space is not ensured on the top surface and the bottom surface sides of the housing in the heat source unit, the air inlet and the air outlet are provided on, for example, the same side surface, and the left and right side surfaces of the heat source unit are continuously disposed so as to be opposed to each other, it is possible to detach the fan assembly in a sliding manner from the rear side surface. Accordingly, it is not necessary to detach from the ceiling the heat source unit installed into the ceiling. Also, even when the ceiling floor surface provided with the heat source unit is formed into a concrete surface or the like, it is possible to easily carry out the maintenance of the fan assembly.

**[0016]** In the heat source unit having the above-described configuration, the slide mechanism may include a pair of guide rails which extends in parallel in the housing in a direction perpendicular to the side surface on which the air inlet of the housing is provided, and a mounting member which is guided by the guide rails to move in a sliding manner and to which the fan assembly is fixed.

**[0017]** In the heat source unit having the above-described configuration, it is preferred that the fan assembly is disposed in the housing so that a rotation shaft of the centrifugal fan is disposed in a direction perpendicular to the side surface on which the air inlet of the housing is provided, and is extracted to the outside of the housing in a sliding manner in a direction along the rotation shaft of the centrifugal fan. Particularly, the heat source unit having the above-described configuration is desirable in the case where the fan assembly includes at least two or more sirocco fans which are arranged in series on the same rotation shaft and a fan motor which drives the sirocco fans.

**[0018]** That is, in the case where two or more sirocco fans are arranged in series on the same rotation shaft, when the maintenance of the fan assembly is carried out in the state that the rear side surface of the housing is detached, the maintenance of the sirocco fan or the fan motor on the operator side may be carried out, but the maintenance of the sirocco fan or the fan motor on the inmost side cannot be carried out. Accordingly, in this case, particularly, it is desirable to extract the fan assembly in a sliding manner from the housing in a direction along the rotation shaft.

**[0019]** In the heat source unit having the above-described configuration, when an opening may be provided at a position corresponding to an air outlet of the fan assembly, and a separation plate, which separates an air intake passageway used for air sucked from the air inlet of the housing from an air outlet passageway used for air discharged from the air outlet of the fan assembly, may be disposed in a manner perpendicular to the side surface on which the air inlet of the housing is provided, the slide mechanism may include a pair of guide rails which is provided on a surface of the separation plate on the side of the air intake passageway so as to extend in parallel in the housing in a direction perpendicular to the

side surface on which the air inlet of the housing is provided, and a mounting member which is guided by the guide rails to move in a sliding manner and to which the fan assembly is fixed.

**[0020]** In the heat source unit having the above-described configuration, it is preferred that the mounting member to which the fan assembly is fixed is formed detachably from the separation plate provided with the guide rails. In the case that the maintenance of the fan assembly can be carried out in the state that the fan assembly is extracted to the outside in a sliding manner, the maintenance thereof is carried out in such the above state, and after the maintenance ends, the fan assembly is returned to its original position in a sliding manner. On the other hand, in the case that the maintenance cannot be carried out in the ceiling, the fan assembly is extracted from the housing in a sliding manner, and then the mounting member is detached from the separation plate. After the maintenance ends, the mounting member is mounted to the separation plate again and is returned to its original position in a sliding manner.

**[0021]** According to another aspect of the invention, there is provided an air conditioner including: the heat source unit having any one of the above-described configurations; and an indoor unit which includes an expansion valve and a heat exchanger for indoor unit, wherein the heat source unit is connected to the indoor unit by means of piping which circulates a coolant.

**[0022]** According to the invention, it is possible to provide a heat source unit installed into a ceiling capable of facilitating the maintenance of a fan assembly even in a ceiling having a limited space.

#### Brief Description of Several Views of Drawing

#### **[0023]**

Fig. 1 is a perspective view showing a heat source unit installed into a ceiling according to an embodiment in a state where an upper cover is detached from the heat source unit.

Fig. 2 is a top view showing the heat source unit according to this embodiment.

Fig. 3 is a vertical sectional view showing the heat source unit according to this embodiment when viewed from a front side thereof.

Fig. 4 is a vertical sectional view showing the heat source unit according to this embodiment when viewed from a side thereof.

Fig. 5 is a perspective view showing a relationship of a separation plate, a mounting plate, and a fan assembly.

Fig. 6 is a perspective view showing a fixed structure between the mounting member and the separation plate.

## Detailed Description of the Invention

**[0024]** Hereinafter, a heat source unit installed into a ceiling according to an embodiment of the invention will be described. In addition, in the following description, the same reference numerals will be given to the same components and the repetitive description thereof will be omitted.

**[0025]** The heat source unit according to this embodiment is a heat source unit which is installed into a ceiling of a building for various demands need to be handled, for example, in the cases that the scenic beauty of the street needs to be preserved, the installation space cannot be ensured in outdoor, or the like.

**[0026]** Figs. 1 to 4 are views showing the heat source unit installed into a ceiling according to the invention. Fig. 1 is a perspective view showing the heat source unit in the state where an upper cover is detached from a housing. Fig. 2 is a top view. Fig. 3 is a vertical sectional view when viewed from the front side thereof. Fig. 4 is a vertical sectional view when viewed from the side thereof.

**[0027]** In addition, in this embodiment, a side surface, on which an air inlet and an air outlet are provided, among side surfaces of the housing of the heat source unit will be described as the front side surface. In the perspective view of Fig. 1, an air inlet duct and an air outlet duct are omitted.

**[0028]** As shown in Figs. 1 to 4, a heat source unit 10 according to this embodiment is configured to arrange in a rectangular housing 12, a compressor 14 which compresses a coolant; a heat exchanger 16 which performs a heat exchange between the coolant and air; a fan assembly 18 which sucks air from the outside so as to use the air for a heat exchange using the heat exchanger 16 and discharges the air to the outside after using the air for the heat exchange; and an electrical box 20 which accommodates electrical components such as a control circuit board.

**[0029]** The housing is provided with an air inlet 24 and an air outlet 26 on a front side surface 22. The air inlet 24 and the air outlet 26 are respectively provided with an air inlet duct 25 and an air outlet duct 27 so as to communicate with the external air of the building.

**[0030]** The fan assembly 18 includes two sirocco fans (centrifugal fans) 28 which are arranged in series on the same rotation shaft and a fan motor 30 which drives the sirocco fans 28. The sirocco fans 28 are accommodated in a fan casing 31. The fan assembly 18 is disposed at the substantially center in the housing so that the rotation shaft of the sirocco fans 28 is perpendicular to the front side surface 22 on which the air inlet 24 is provided (in a direction along left and right side surfaces 32 and 34 of the housing). In other words, the rotation shaft of the sirocco fans 28 is disposed in the same direction as an air intake direction from the air inlet 24.

**[0031]** The heat exchanger 16 is disposed on the air inlet side of the fan assembly 18 so as to have a substantially L-shaped section in a horizontal direction,

where the L-shaped section surrounds the fan assembly 18. The compressor 14 is disposed between the heat exchanger 16 and the right side surface 34. The electrical box 20 is disposed adjacent to a rear side surface 36 on the air outlet side of the fan assembly 18. The compressor 14, the heat exchanger 16, the electrical box 20, and the like can be arbitrarily fixed to a bottom surface 37 of the housing.

**[0032]** In the housing, a separation plate 38 provided with an opening formed at a position corresponding to an air outlet of the fan assembly 18 separates an air intake passageway 40 which is used for the air sucked from the air inlet 24 of the housing from an air outlet passageway 42 which is used for the air discharged from the air outlet of the fan assembly 18 so as to communicate with the air outlet 26 of the housing. The separation plate 38 is disposed so as to be perpendicular to the front side surface 22 of the housing. In addition, on a surface of the separation plate 38 on the side of the air intake passageway 40 is provided a mounting member 43 to which the fan assembly 18 is fixed. The relationship of the separation plate 38, the mounting member 43, and the fan assembly 18 will be described later in detail.

**[0033]** The heat source unit 10 is suspended from an upper surface 48 in the ceiling of the building by means of four suspension bars 46 which are respectively fixed to metallic suspension members 44 provided at four corners of the housing. However, instead of the suspension, in the case where a lower surface 50 in the ceiling of the building is formed into a concrete floor surface or the like, the heat source unit 10 may be directly installed on the floor surface.

**[0034]** Next, an air stream with an operation of driving the fan assembly 18 of the heat source unit according to this embodiment will be described. When the sirocco fans 28 are rotated by the driving operation of the fan motor 30, air is sucked from the outside of the building via the air intake duct 25 (air stream 52), and is introduced into the air intake passageway 40 via the air intake 24 formed on the front side surface of the housing.

**[0035]** Subsequently, a heat exchange is carried out between the air and the coolant flowing through the inside of the heat exchanger 16, and then, the air is discharged to the air outlet passageway 42 via the air outlet of the fan assembly 18. The discharged air is curved toward the air outlet 26 by a wall surface of the left side surface 32 of the housing, and the air is discharged from the air outlet 26 to the outside of the building via the air outlet duct 27 (air stream 54).

**[0036]** Likewise, when the air outlet direction of the fan assembly 18 is arranged perpendicular to the air outlet 26 formed on the front side surface of the housing, the blowing sound is not directly audible. Accordingly, a sound insulation advantage can be expected.

**[0037]** In addition, in order to ensure an absorption surface as much as possible within the limited dimension of a product, the heat exchanger 16 is formed to have a substantially L-shaped section provided with one curved

portion in a horizontal direction, and the short side of the L-shaped section is disposed on the side of the air inlet 24 of the housing. Accordingly, an air-conditioning ability is improved by increasing a heat transmission area of the heat exchanger 16, and a ventilation resistance is reduced. As a result, it is possible to reduce the rotation number of the sirocco fans 28 generating the same amount of wind, and thus to reduce the noise or consumption power. Likewise, the heat source unit according to this embodiment is best suited to realize the noise reduction, the energy saving, and the compact in size.

**[0038]** Meanwhile, in the heat source unit installed into a ceiling according to this embodiment, the maintenance has to be easily carried out in the components constituting the heat source unit, that is, particularly in the components such as the fan assembly 18 which includes a driving portion and is frequently exchanged or repaired due to its lifetime.

**[0039]** That is, since it is troublesome to detach the heat source unit installed into a ceiling, for the maintenance of the components, it is desirable to carry out the maintenance in such a manner that only the target component is extracted for the maintenance and after the maintenance ends, is returned to its original position while the heat source unit itself is installed into the ceiling.

**[0040]** Meanwhile, as shown in Figs. 3 and 4, in some buildings, it is not possible to detach the upper surface (top surface) 56 from the housing and extract the fan assembly 18 from the housing due to the relationship of the dimension between the upper surface 48 and the lower surface 50 of the ceiling and the height dimension of the housing. Particularly, when the lower surface 50 is formed into a concrete surface, the fan assembly 18 may not slide in a downward direction of the housing as in the same case of the

related art.

**[0041]** In addition, in the case where plural heat source units are installed, the left and right side surfaces 32 and 34 of the housing may be installed adjacent to each other. Accordingly, in some cases, the maintenance space may not be ensured in a transverse direction of the housing.

**[0042]** For this reason, in the heat source unit according to this embodiment, in order to easily carry out the maintenance of the fan assembly 18 even in the case of the above-described limitation, on the rear side surface 36 opposed to the front side surface 22 of the housing is provided an openable extraction port which is used to extract the fan assembly 18, and a slide mechanism which is used to slide the fan assembly 18 to the outside of the housing via the extraction port. In the extraction port, a portion of the rear side surface 36 corresponding to at least the fan assembly 18 is detachable or formed in a door shape so as to be opened.

**[0043]** Regarding the slide mechanism, in detail, on the surface of the separation plate 38 on the side of the air intake passageway 40 is provided a pair of guide rails

58 which extends in parallel in a direction perpendicular to the front side surface 22 of the housing, as shown in Fig. 5. In other words, the guide rails 58 extend in parallel to a direction along the rotation shaft of the sirocco fans 28. In addition, the mounting member 43 is guided by the pair of guide rails 58 in a sliding manner, and the fan casing 31 of the fan assembly 18 is fixed to the mounting member.

**[0044]** That is, the slide mechanism is configured to move the fan assembly 18 to the outside of the housing in a sliding manner via the extraction port formed on the rear side surface of the housing by means of the mounting member 43 and the pair of guide rails 58.

**[0045]** Accordingly, when the maintenance of the fan assembly 18 is carried out, for example, the detachable rear side surface 36 of the housing is detached so as to open the extraction port, and the mounting member 43 or the fan assembly 18 is extracted to the outside in a sliding manner. Subsequently, the maintenance of the extracted fan assembly 18 is carried out while keeping the extracted state, the extracted fan assembly 18 is returned to its original position in a sliding manner after the maintenance is carried out, and then the rear side surface 36 is attached to its original position, thereby ending the maintenance procedure.

**[0046]** In addition, in the case that the mounting member 43 is detachably mounted to the separation plate 38, after the mounting member 43 is extracted to the outside in a sliding manner, the mounting member 43 is detached from the separation plate 38. Subsequently, the maintenance of the fan assembly is carried out in other places, and then, the mounting member 43 is mounted to the separation plate 38 again and is returned to its original position.

**[0047]** The mounting member 43 is fixed to the separation plate 38 by means of a screw or the like at the position on the side of the rear side surface 36 of the housing. In case of the fixing operation on the side of the front side surface 22 of the housing, it is difficult to fasten or unfasten a screw. For this reason, on a portion of the separation plate 38 on the side of the front side surface 22 of the housing is provided a claw 60 which engages with the mounting member 43. Also, on the mounting member 43 is provided a notch 62 which engages with the claw 60.

**[0048]** With such a configuration, the claw 60 serves as a stopper during the sliding operation. In addition, the separation plate 38 serves as a reinforcing member which reinforces the upper surface 56 or the bottom surface 37 of the housing, and the guide rail 58 itself serves as a reinforcing member which reinforces the separation plate 38 or the mounting member 43 supported thereto. Accordingly, it is advantageous to improve the strength or to reduce the vibration.

**[0049]** As described above, in the heat source unit according to this embodiment, it is possible to extract the fan assembly from the rear side surface of the housing in a sliding manner. Accordingly, it is not necessary to

detach the heat source unit from the ceiling. Also, even when the ceiling floor surface provided with the heat source unit is formed into the concrete surface or the like, it is possible to easily carry out the maintenance of the fan assembly.

**[0050]** In the case where the fan assembly 18 is fixed to the inside of the housing, it is not possible touch with a hand one of the sirocco fans 28 or the fan motor 30 disposed on the inside of the rear side surface 36 of the housing. For this reason, according to this embodiment, since it is possible to detach or attach the mounting member 43 from or to the heat source unit upon checking or exchanging the fan assembly 18, it is possible to easily carry out the maintenance.

**[0051]** Since the electrical box 20, the compressor 14, and the like of which the maintenance is highly frequently carried out are disposed so that the access can be made via the rear side surface of the housing, the maintenance space being reliably ensured on the rear side surface, it is possible to simply carry out the maintenance just by detaching the rear side surface.

**[0052]** In addition, in this embodiment, there is described an example in which the fan assembly is disposed so that the rotation shaft of the sirocco fans 28 is disposed in a direction along the left and right side surfaces of the housing. However, the invention is not limited thereto, and the fan assembly may be disposed in an arbitrary direction. That is, even in the heat source unit installed into a ceiling, the fan assembly may be configured to be extracted from the rear side surface of the housing in a sliding manner, where the maintenance space is not limited in the rear side surface.

**[0053]** Further, in this embodiment, there is described an example in which the separation plate is provided with the guide rail. However, the invention is not limited thereto, and the guide rail may be formed at an arbitrary position (for example, the bottom surface of the housing) in the housing. That is, the guide rail may be formed so that the fan assembly is extracted from the rear side surface of the housing in a sliding manner.

**[0054]** Furthermore, in this embodiment, there is described an example in which on the same side surface of the housing is provided the air inlet and the air outlet. However, the invention is not limited thereto, and the air inlet and the air outlet may be respectively formed on the side surfaces which are not opposed to each other. That is, on condition of setting the side surface on which the air inlet is provided to the front side surface, even in the heat source unit installed into a ceiling, the fan assembly may be configured to be extracted in a sliding manner from the rear side surface where the maintenance space is not limited.

## Claims

1. A heat source unit installed into a ceiling comprising:

a rectangular housing (12);  
an air inlet (24) and an air outlet (26) which are provided on the same side surface of the housing (12) or respectively provided on side surfaces not opposed to each other;  
a fan assembly (18) which includes a centrifugal fan (28) disposed in the housing (12) and a fan motor (30) driving the centrifugal fan (28);  
a heat exchanger (16) which performs a heat exchange using air sucked from the air inlet (24); and  
a compressor (14),

wherein on a side surface (36) opposed to the side surface (22) on which the air inlet (24) of the housing (12) is provided there is provided an openable extraction port which is used to extract the fan assembly (18) and a slide mechanism which is used to slide the fan assembly (18) to the outside of the housing (12) via the extraction port.

2. The heat source unit according to Claim 1, wherein the slide mechanism includes a pair of guide rails (58) which extend in parallel in the housing (12) in a direction perpendicular to the side surface (22) on which the air inlet (24) of the housing (12) is provided and a mounting member (43) which is guided by the guide rails (58) in a sliding manner and to which the fan assembly (18) is fixed.
3. The heat source unit according to Claim 1, wherein the fan assembly (18) is disposed in the housing (12) so that a rotation shaft of the centrifugal fan (28) is disposed in a direction perpendicular to the side surface (22) on which the air inlet (24) of the housing (12) is provided, and the fan assembly (18) is extracted to the outside of the housing (12) in a sliding manner in a direction along the rotation shaft of the centrifugal fan (28).
4. The heat source unit according to Claim 1, wherein an opening is provided at a position corresponding to an air outlet (26) of the fan assembly (18), and a separation plate (38), which separates an air intake passageway used for air sucked from the air inlet (24) of the housing (12) from an air outlet passageway used for air discharged from the air outlet (26) of the fan assembly (18), is disposed in a direction perpendicular to the side surface (22) the air inlet (24) of the housing (12) is provided, and wherein the slide mechanism includes a pair of guide rails (58) which are provided on a surface of the separation plate (38) on the side of the air intake passageway so as to extend in parallel in the housing (12) in a direction perpendicular to the side surface (22) on which the air inlet (24) of the housing (12) is provided and a mounting member (43) which is guided by the guide rails (58) in a sliding manner and to

which the fan assembly (18) is fixed.

5. The heat source unit according to Claim 4, wherein the mounting member (43) to which the fan assembly (18) is fixed is detachably provided on the separation plate (38) on which the guide rails (58) are provided. 5
  
6. The heat source unit according to Claim 4, wherein on the separation plate (38) on the side of the air inlet (24) of the housing (12) there is provided a claw (60) which engages with the mounting member (43) and the mounting member (43) is provided with a notch which engages with the claw (60). 10
  
7. The heat source unit according to Claim 1, wherein the heat exchanger (16) is disposed on the air intake side of the fan assembly (18) so as to surround sides except for a side positioned in the slide direction of the fan assembly (18). 15  
20
  
8. The heat source unit according to Claim 1, wherein the fan assembly (18) includes two or more sirocco fans (28) which are arranged in series on the same rotation shaft and a fan motor (30) which drives the sirocco fans (28). 25
  
9. An air conditioner comprising:
  - the heat source unit according to any one of Claims 1 to 8; and 30
  - an indoor unit which includes an expansion valve and a heat exchanger for indoor unit,

wherein the heat source unit is connected to the indoor unit by means of piping which circulates a coolant. 35

40

45

50

55

FIG. 1

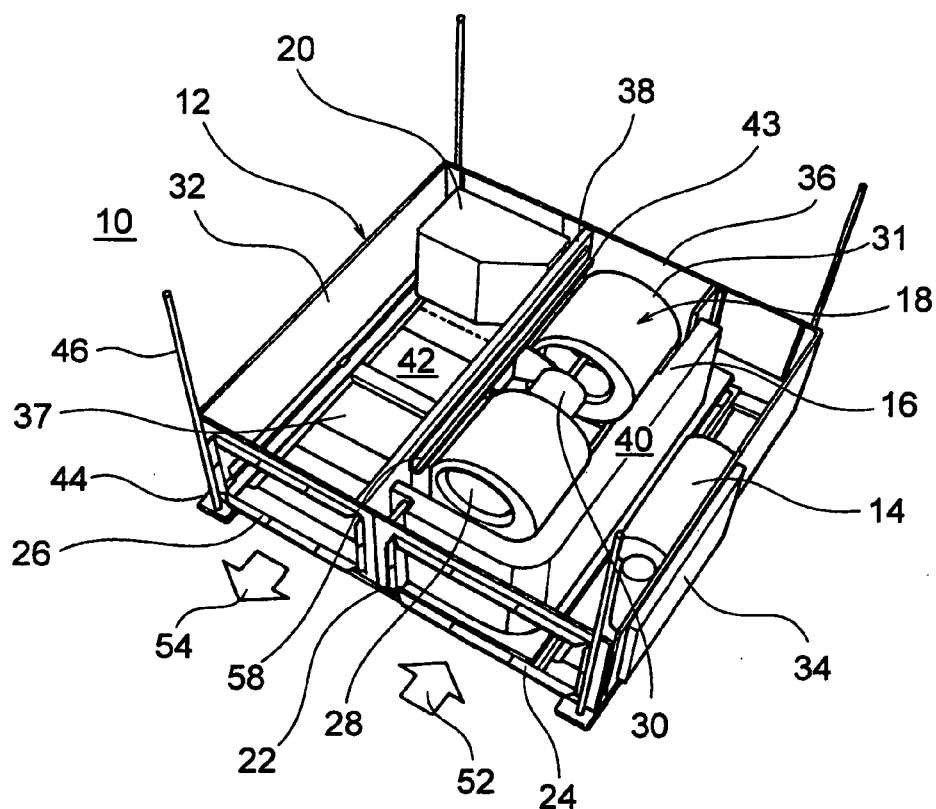

FIG. 2

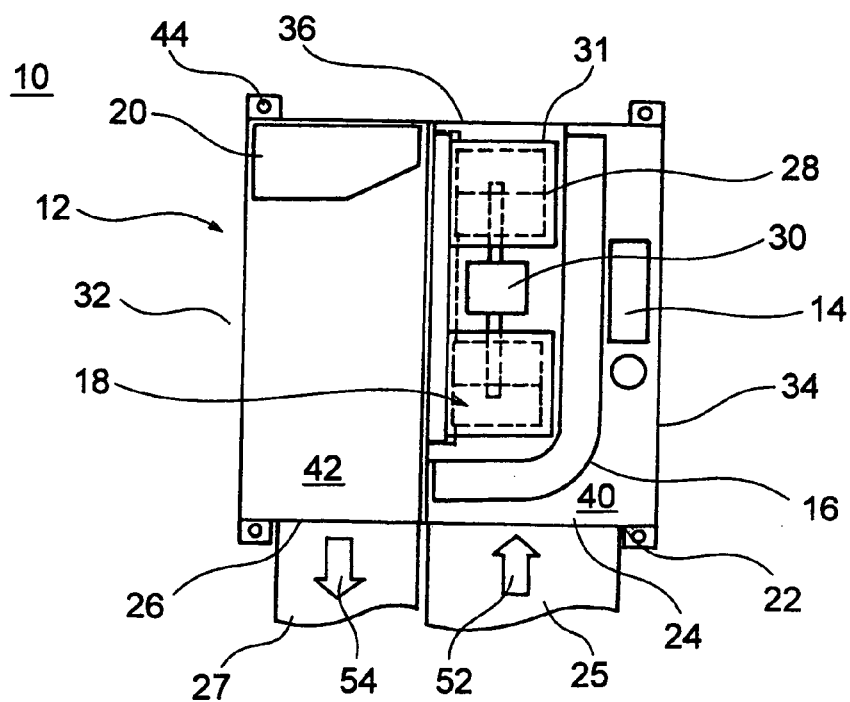



FIG. 3

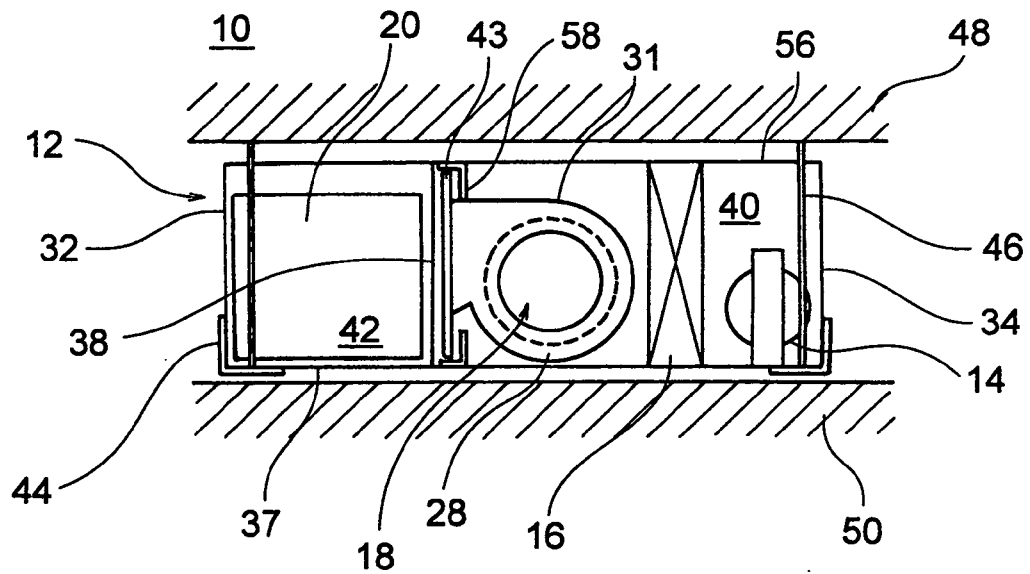

FIG. 4

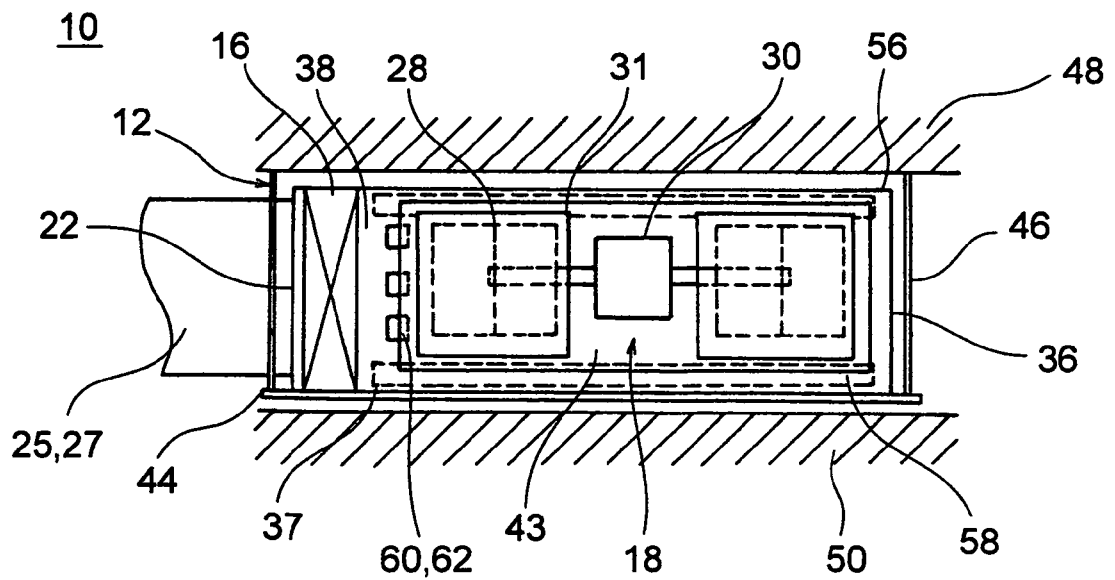

FIG. 5

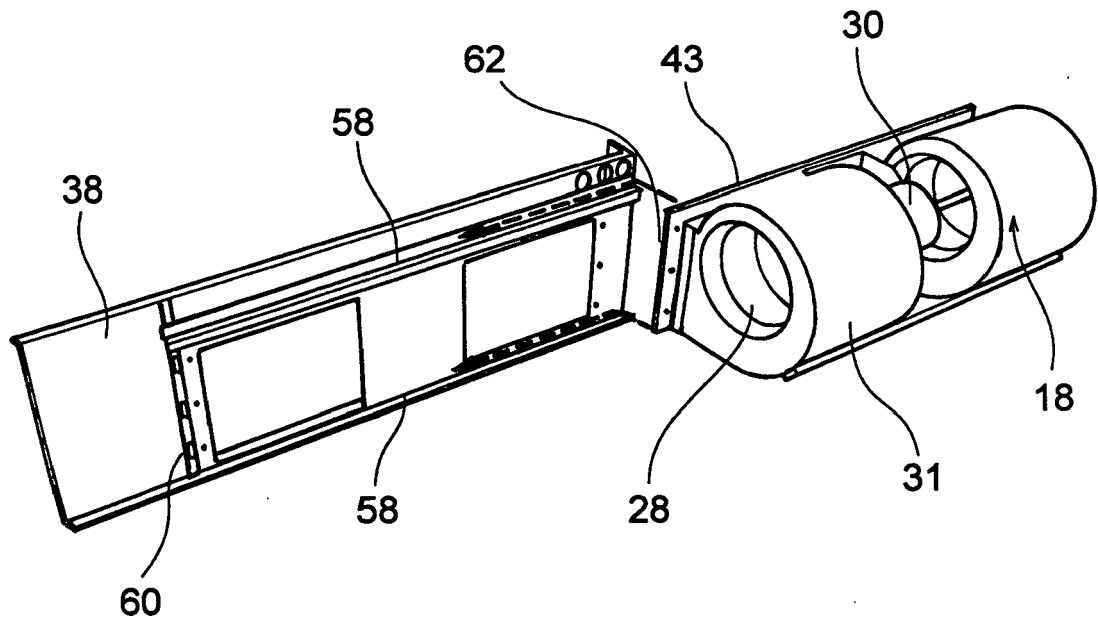
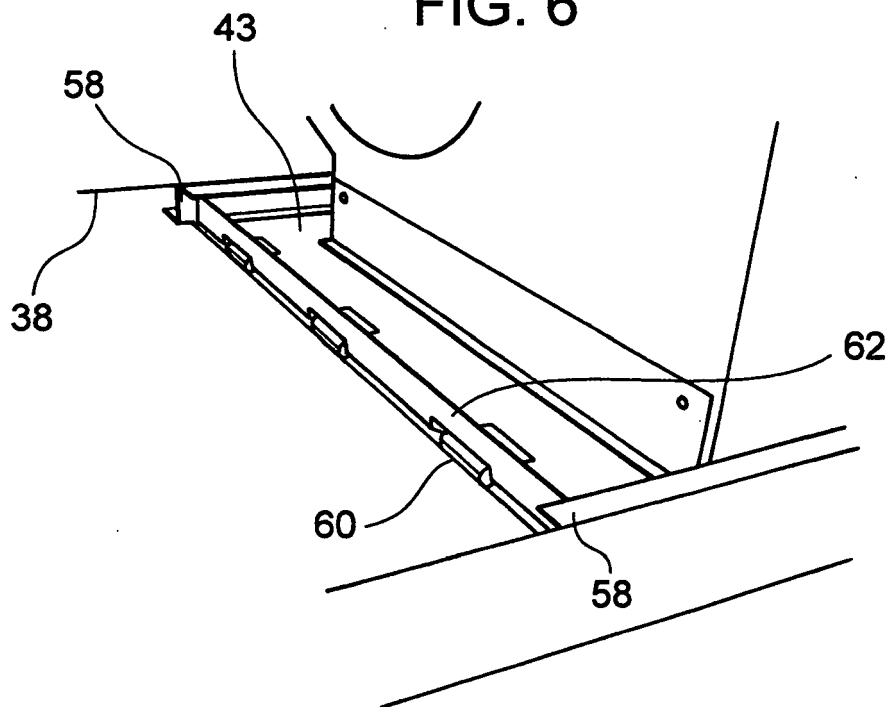

FIG. 6





## EUROPEAN SEARCH REPORT

Application Number  
EP 09 00 5100

DOCUMENTS CONSIDERED TO BE RELEVANT			
Category	Citation of document with indication, where appropriate, of relevant passages	Relevant to claim	CLASSIFICATION OF THE APPLICATION (IPC)
A	JP 2005 133969 A (MATSUSHITA ELECTRIC IND CO LTD) 26 May 2005 (2005-05-26) * abstract; figures 1,2,4,7 * -----	1-9	INV. F24F1/00 F24F13/20
A	JP 07 332727 A (DAIKIN IND LTD) 22 December 1995 (1995-12-22) * abstract; figures 1-4 * -----	1-9	
A	EP 1 103 768 A (ROSENBERG VENTILATOREN GMBH [DE]) 30 May 2001 (2001-05-30) * paragraph [0009] - paragraph [0011]; figures 1-4 * -----	1-9	
			TECHNICAL FIELDS SEARCHED (IPC)
			F24F
The present search report has been drawn up for all claims			
Place of search Munich		Date of completion of the search 14 July 2009	Examiner Decking, Oliver
CATEGORY OF CITED DOCUMENTS X : particularly relevant if taken alone Y : particularly relevant if combined with another document of the same category A : technological background O : non-written disclosure P : intermediate document T : theory or principle underlying the invention E : earlier patent document, but published on, or after the filing date D : document cited in the application L : document cited for other reasons & : member of the same patent family, corresponding document			

2

EPO FORM 1503 03.82 (P04C01)

**ANNEX TO THE EUROPEAN SEARCH REPORT  
ON EUROPEAN PATENT APPLICATION NO.**

EP 09 00 5100

This annex lists the patent family members relating to the patent documents cited in the above-mentioned European search report.  
The members are as contained in the European Patent Office EDP file on  
The European Patent Office is in no way liable for these particulars which are merely given for the purpose of information.

14-07-2009

Patent document cited in search report	Publication date	Patent family member(s)	Publication date
JP 2005133969 A	26-05-2005	NONE	
JP 7332727 A	22-12-1995	NONE	
EP 1103768 A	30-05-2001	DE 29920574 U1	13-04-2000

EPO FORM P0459

For more details about this annex : see Official Journal of the European Patent Office, No. 12/82

**REFERENCES CITED IN THE DESCRIPTION**

*This list of references cited by the applicant is for the reader's convenience only. It does not form part of the European patent document. Even though great care has been taken in compiling the references, errors or omissions cannot be excluded and the EPO disclaims all liability in this regard.*

**Patent documents cited in the description**

- JP 2005133969 A [0007] [0008]