



(12) **EUROPEAN PATENT APPLICATION**

(88) Date of publication A3:
30.12.2009 Bulletin 2009/53

(51) Int Cl.:
A63H 33/30 (2006.01)

(43) Date of publication A2:
04.11.2009 Bulletin 2009/45

(21) Application number: **09250996.7**

(22) Date of filing: **31.03.2009**

(84) Designated Contracting States:
AT BE BG CH CY CZ DE DK EE ES FI FR GB GR HR HU IE IS IT LI LT LU LV MC MK MT NL NO PL PT RO SE SI SK TR
Designated Extension States:
AL BA RS

- **Nagai, Tomohito**
Shibuya-ku
Tokyo (JP)
- **Konno, Yoichiro**
Shibuya-ku
Tokyo (JP)

(30) Priority: **08.04.2008 JP 2008100785**

(74) Representative: **Bates, Philip Ian**
Reddie & Grose
16 Theobalds Road
London
WC1X 8PL (GB)

(71) Applicant: **Tomy Company, Ltd.**
Katsushika-ku
Tokyo (JP)

(72) Inventors:
• **Ehama, Ryoko**
Katsushika-ku
Tokyo (JP)

(54) **Toy cup and toy dispenser for simulating dispensing of beverage into the toy cup**

(57) A toy cup (1), and a toy dispenser (2) for simulating the dispensing of a beverage therein, which are realistic because a liquid in the cup (1) gradually goes out of sight when the toy cup (1) is tilted, and returns when the toy cup (1) is set on the toy dispenser (2) and an operating member (51) is operated, as if a drink were poured from a dispenser into a cup. The toy cup (1) includes a hermetically closed container (10) and a division plate (13) dividing an interior of the container (10) into upper and lower chambers (UR, LR). The division plate (13) has a plurality of small holes (23) at its periphery at predetermined intervals for communicating the chambers (UR, LR) with each other and permitting a liquid (L) to flow, and an upwardly protruding vent tube (25) provided at the center thereof to communicate the chambers (UR, LR) with each other. Opening/closing of the vent tube (25) is controlled by a control valve (27). The toy dispenser (2) includes a placement base (40), on which the toy cup (1) is placed, and a control device (50) provided above the placement base (40) for controlling opening/closing of the control valve (27).

FIG.1

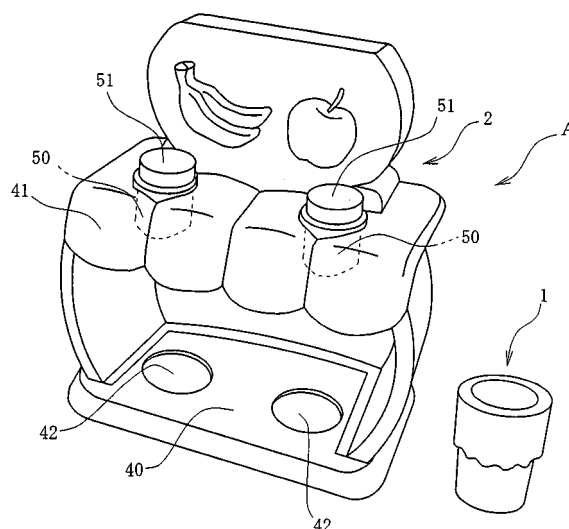



EUROPEAN SEARCH REPORT

Application Number
EP 09 25 0996

DOCUMENTS CONSIDERED TO BE RELEVANT			
Category	Citation of document with indication, where appropriate, of relevant passages	Relevant to claim	CLASSIFICATION OF THE APPLICATION (IPC)
A	US 3 250 531 A (FRANK CONVERTINE) 10 May 1966 (1966-05-10) * column 1, line 51 - column 2, line 39 * * figures *	1-4	INV. A63H33/30
A	US 5 176 561 A (GREENBERG LAWRENCE J [US] ET AL) 5 January 1993 (1993-01-05) * column 4, line 15 - line 36 * * figures 3,4 *	1-4	
			TECHNICAL FIELDS SEARCHED (IPC)
			A63H
The present search report has been drawn up for all claims			
Place of search Munich		Date of completion of the search 7 August 2009	Examiner Turmo, Robert
<p>CATEGORY OF CITED DOCUMENTS</p> <p>X : particularly relevant if taken alone Y : particularly relevant if combined with another document of the same category A : technological background O : non-written disclosure P : intermediate document</p> <p>T : theory or principle underlying the invention E : earlier patent document, but published on, or after the filing date D : document cited in the application L : document cited for other reasons & : member of the same patent family, corresponding document</p>			

2
EPO FORM 1503 03.82 (P04C01)



Application Number

EP 09 25 0996

CLAIMS INCURRING FEES

The present European patent application comprised at the time of filing claims for which payment was due.

☐ Only part of the claims have been paid within the prescribed time limit. The present European search report has been drawn up for those claims for which no payment was due and for those claims for which claims fees have been paid, namely claim(s):

☐ No claims fees have been paid within the prescribed time limit. The present European search report has been drawn up for those claims for which no payment was due.

LACK OF UNITY OF INVENTION

The Search Division considers that the present European patent application does not comply with the requirements of unity of invention and relates to several inventions or groups of inventions, namely:

see sheet B

☐ All further search fees have been paid within the fixed time limit. The present European search report has been drawn up for all claims.

☐ As all searchable claims could be searched without effort justifying an additional fee, the Search Division did not invite payment of any additional fee.

☐ Only part of the further search fees have been paid within the fixed time limit. The present European search report has been drawn up for those parts of the European patent application which relate to the inventions in respect of which search fees have been paid, namely claims:

☒ None of the further search fees have been paid within the fixed time limit. The present European search report has been drawn up for those parts of the European patent application which relate to the invention first mentioned in the claims, namely claims:

1-4

☐ The present supplementary European search report has been drawn up for those parts of the European patent application which relate to the invention first mentioned in the claims (Rule 164 (1) EPC).



**LACK OF UNITY OF INVENTION
SHEET B**

Application Number
EP 09 25 0996

The Search Division considers that the present European patent application does not comply with the requirements of unity of invention and relates to several inventions or groups of inventions, namely:

1. claims: 1-4

A toy cup comprising a vent tube provided at a center of the division plate to communicate the upper chamber and the lower chamber with each other, and an urging member urging the control valve so as to close the vent tube.

2. claims: 5-7

A toy dispenser suitable for simulating dispensing of a beverage into a toy cup according to claim 1 comprising a control device above a placement base, the control device controlling opening and closing of the vent tube by the control valve.

**ANNEX TO THE EUROPEAN SEARCH REPORT
ON EUROPEAN PATENT APPLICATION NO.**

EP 09 25 0996

This annex lists the patent family members relating to the patent documents cited in the above-mentioned European search report.
The members are as contained in the European Patent Office EDP file on
The European Patent Office is in no way liable for these particulars which are merely given for the purpose of information.

07-08-2009

Patent document cited in search report		Publication date	Patent family member(s)	Publication date
US 3250531	A	10-05-1966	NONE	

US 5176561	A	05-01-1993	AU 2616892 A	08-04-1993
			CA 2079738 A1	03-04-1993
			DE 69203817 D1	07-09-1995
			DE 69203817 T2	23-11-1995
			EP 0535673 A1	07-04-1993
			ES 2075562 T3	01-10-1995
			MX 9205629 A1	01-05-1993
