



(11) **EP 2 124 110 A3**

(12) **EUROPEAN PATENT APPLICATION**

(88) Date of publication A3:
16.06.2010 Bulletin 2010/24

(51) Int Cl.:
G03G 15/16 (2006.01)

(43) Date of publication A2:
25.11.2009 Bulletin 2009/48

(21) Application number: **09159029.9**

(22) Date of filing: **29.04.2009**

(84) Designated Contracting States:
AT BE BG CH CY CZ DE DK EE ES FI FR GB GR HR HU IE IS IT LI LT LU LV MC MK MT NL NO PL PT RO SE SI SK TR
Designated Extension States:
AL BA RS

(30) Priority: **12.05.2008 JP 2008124525**

(71) Applicant: **Konica Minolta Business Technologies, Inc.**
Tokyo 100-0005 (JP)

(72) Inventors:
• **Sendo, Hiroshi**
Tokyo Tokyo (JP)
• **Tomino, Toshiaki**
Tokyo Tokyo (JP)
• **Takahashi, Kouki**
Tokyo Tokyo (JP)

(74) Representative: **Gille Hrabal Struck Neidlein Prop Roos**
Patentanwälte
Brucknerstrasse 20
40593 Düsseldorf (DE)

(54) **Image forming apparatus provided with transfer and separation device**

(57) An image forming apparatus having: a drum-shaped image carrier; a transfer and separation device which comprises: a conveyor belt for conveying a transfer material; a transfer roller for supporting the conveyor belt; and a nip regulating roller that is disposed downstream of the transfer roller in a conveyance direction of the transfer material; and a transfer region changing section adapted to change a downstream end of the transfer region in a conveyance direction of the transfer material by changing a position of the nip regulating roller; wherein the transfer region changing section sets the nip regulating roller, at a first position at which the conveyor belt is supported such that a direction of separation of the conveyor belt from the image carrier at the downstream end of the transfer region coincides with a tangential direction with respect to the image carrier, or at a second position.

FIG. 1

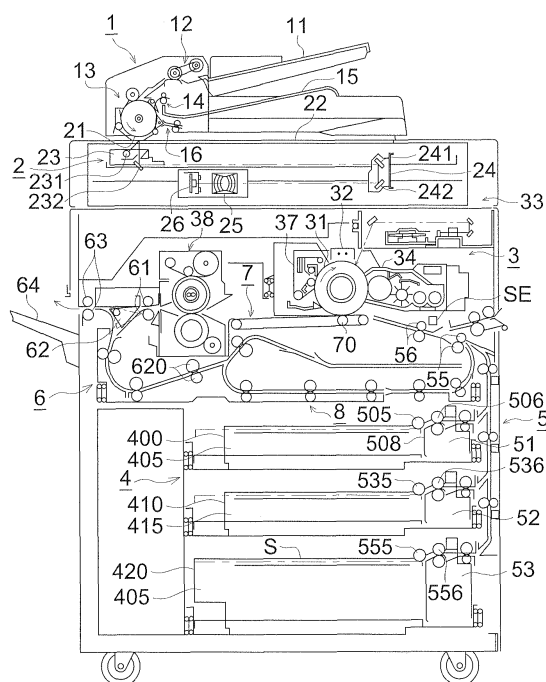



EUROPEAN SEARCH REPORT

Application Number
EP 09 15 9029

DOCUMENTS CONSIDERED TO BE RELEVANT			
Category	Citation of document with indication, where appropriate, of relevant passages	Relevant to claim	CLASSIFICATION OF THE APPLICATION (IPC)
X	US 6 389 242 B1 (WATANABE TAKESHI [JP] ET AL) 14 May 2002 (2002-05-14) * column 10, line 36 - column 11, line 5; figures 13,14 *	1-6	INV. G03G15/16
X	EP 0 899 625 A2 (TOSHIBA KK [JP]) 3 March 1999 (1999-03-03) * figures 6,8,11 *	1	
X	EP 1 400 865 A1 (RICOH KK [JP]) 24 March 2004 (2004-03-24) * paragraph [0038]; figure 1 *	1	
X	US 5 666 624 A (KANESAWA YOSHIO [JP] ET AL) 9 September 1997 (1997-09-09) * figure 12 *	1	
			TECHNICAL FIELDS SEARCHED (IPC)
			G03G
The present search report has been drawn up for all claims			
Place of search Munich		Date of completion of the search 10 May 2010	Examiner Mandreoli, Lorenzo
<p>CATEGORY OF CITED DOCUMENTS</p> <p>X : particularly relevant if taken alone Y : particularly relevant if combined with another document of the same category A : technological background O : non-written disclosure P : intermediate document</p> <p>T : theory or principle underlying the invention E : earlier patent document, but published on, or after the filing date D : document cited in the application L : document cited for other reasons & : member of the same patent family, corresponding document</p>			

1
EPO FORM 1503 03.82 (P04C01)

**ANNEX TO THE EUROPEAN SEARCH REPORT
ON EUROPEAN PATENT APPLICATION NO.**

EP 09 15 9029

This annex lists the patent family members relating to the patent documents cited in the above-mentioned European search report.
The members are as contained in the European Patent Office EDP file on
The European Patent Office is in no way liable for these particulars which are merely given for the purpose of information.

10-05-2010

Patent document cited in search report		Publication date		Patent family member(s)		Publication date
US 6389242	B1	14-05-2002	JP	2002156839 A		31-05-2002
			US	2002164177 A1		07-11-2002

EP 0899625	A2	03-03-1999	CN	1206130 A		27-01-1999
			JP	11038796 A		12-02-1999
			US	6044244 A		28-03-2000

EP 1400865	A1	24-03-2004	DE	60317283 T2		28-08-2008
			JP	2004133419 A		30-04-2004
			US	2006170936 A1		03-08-2006

US 5666624	A	09-09-1997	JP	3282494 B2		13-05-2002
			JP	9034291 A		07-02-1997

EPO FORM P0459

For more details about this annex : see Official Journal of the European Patent Office, No. 12/82