



(12) **EUROPEAN PATENT APPLICATION**

(88) Date of publication A3:  
**17.08.2011 Bulletin 2011/33**

(51) Int Cl.:  
**A47L 9/24 (2006.01)**

(43) Date of publication A2:  
**02.12.2009 Bulletin 2009/49**

(21) Application number: **09007024.4**

(22) Date of filing: **26.05.2009**

(84) Designated Contracting States:  
**AT BE BG CH CY CZ DE DK EE ES FI FR GB GR**  
**HR HU IE IS IT LI LT LU LV MC MK MT NL NO PL**  
**PT RO SE SI SK TR**  
 Designated Extension States:  
**AL BA RS**

(30) Priority: **30.05.2008 CN 200810109817**

(71) Applicant: **Panasonic Corporation**  
**Kadoma-shi**  
**Osaka 571-8501 (JP)**

(72) Inventors:  
 • **Hatano, Tsuyoshi**  
**Osaka-shi,**  
**Osaka 540-6207 (JP)**  
 • **Itou, Kouichi**  
**Osaka-shi,**  
**Osaka 540-6207 (JP)**  
 • **Qi, Junmin**  
**Hangzhou (CN)**

(74) Representative: **Trösch, Hans-Ludwig**  
**Eisenführ, Speiser & Partner**  
**Postfach 31 02 60**  
**80102 München (DE)**

(54) **Joint construction of suction head for vacuum cleaner and vacuum cleaner having the construction**

(57) The present invention relates to a joint construction of a suction head for a vacuum cleaner and a vacuum cleaner having said construction. The joint construction of the suction head for the vacuum cleaner in this invention comprises: a suction head body, a connecting tube and an extension tube. Said connecting tube connects in between the suction head body and the extension tube, and said connecting tube is provided with a first joint section at the joint of said connecting tube and said extension tube, for connecting and fixing said extension tube; said extension tube is provided with a second joint section at the joint of said extension tube and said connecting tube, for interlocking with said first joint section to connect and fix said extension tube and said connecting tube; a joint release section for releasing the interlocking between said first and second joint sections is provided above said connecting tube and covers said first joint section; said joint release section is arranged substantially along with the longitudinal direction of said connecting tube, with one end thereof provided with a supporting section which is shaft supported at the external surface of said connecting tube, and the other end thereof provided with an operating section for operating the motion of said joint release section.

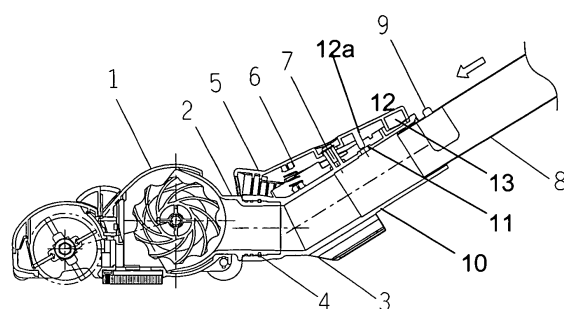

Fig. 1



## EUROPEAN SEARCH REPORT

Application Number  
EP 09 00 7024

DOCUMENTS CONSIDERED TO BE RELEVANT			
Category	Citation of document with indication, where appropriate, of relevant passages	Relevant to claim	CLASSIFICATION OF THE APPLICATION (IPC)
X	US 4 700 429 A (MARTIN WILLIAM J [US] ET AL) 20 October 1987 (1987-10-20) * column 3 - column 4; figures * -----	1-8	INV. A47L9/24
X	US 2008/022489 A1 (GOGEL NATHAN A [US] ET AL) 31 January 2008 (2008-01-31) * paragraph [0015] - paragraph [0023]; figures * -----	1-3,5,8	
X	DE 39 42 267 C1 (ARNOLD, HANS-PETER) 3 January 1991 (1991-01-03) * figures 3-5 * -----	1,8	
			TECHNICAL FIELDS SEARCHED (IPC)
			A47L
The present search report has been drawn up for all claims			
Place of search <b>Munich</b>		Date of completion of the search <b>4 July 2011</b>	Examiner <b>Masset, Markus</b>
CATEGORY OF CITED DOCUMENTS X : particularly relevant if taken alone Y : particularly relevant if combined with another document of the same category A : technological background O : non-written disclosure P : intermediate document		T : theory or principle underlying the invention E : earlier patent document, but published on, or after the filing date D : document cited in the application L : document cited for other reasons ..... & : member of the same patent family, corresponding document	

1  
EPO FORM 1503 03.82 (P04C01)

**ANNEX TO THE EUROPEAN SEARCH REPORT  
ON EUROPEAN PATENT APPLICATION NO.**

EP 09 00 7024

This annex lists the patent family members relating to the patent documents cited in the above-mentioned European search report.  
The members are as contained in the European Patent Office EDP file on  
The European Patent Office is in no way liable for these particulars which are merely given for the purpose of information.

04-07-2011

Patent document cited in search report		Publication date	Patent family member(s)	Publication date
US 4700429	A	20-10-1987	CA 1288205 C	03-09-1991
US 2008022489	A1	31-01-2008	CA 2556620 A1	28-01-2008
DE 3942267	C1	03-01-1991	AT 91606 T	15-08-1993
			DE 59002030 D1	26-08-1993
			DK 0433609 T3	27-12-1993
			EP 0433609 A1	26-06-1991
			ES 2042174 T3	01-12-1993
			JP 1941867 C	23-06-1995
			JP 3195527 A	27-08-1991
			JP 6075561 B	28-09-1994
			PT 96339 A	30-09-1991