



(12) **EUROPEAN PATENT APPLICATION**

(88) Date of publication A3:  
**09.03.2011 Bulletin 2011/10**

(51) Int Cl.:  
**A47L 9/00** (2006.01) **A47L 9/24** (2006.01)  
**A47L 9/32** (2006.01)

(43) Date of publication A2:  
**10.03.2010 Bulletin 2010/10**

(21) Application number: **09251992.5**

(22) Date of filing: **14.08.2009**

(84) Designated Contracting States:  
**AT BE BG CH CY CZ DE DK EE ES FI FR GB GR HR HU IE IS IT LI LT LU LV MC MK MT NL NO PL PT RO SE SI SK SM TR**  
Designated Extension States:  
**AL BA RS**

(72) Inventors:  
• **Kim, Hyoun-soo**  
**Busan (KR)**  
• **Jung, Il-du**  
**Gwangju-city (KR)**

(30) Priority: **08.09.2008 KR 20080088180**

(74) Representative: **Pratt, David Martin et al**  
**Withers & Rogers LLP**  
**Goldings House**  
**2 Hays Lane**  
**London SE1 2HW (GB)**

(71) Applicant: **Samsung Gwangju Electronics Co., Ltd.**  
**Gwangju-city (KR)**

(54) **Suction flow speed control apparatus and vacuum cleaner having the same**

(57) A suction flow speed control apparatus of a vacuum cleaner is provided. The suction flow speed control apparatus includes a first suction flow path (100), one end of which is connected to the main body (1) of the vacuum cleaner, and the other end of which is connected to a nozzle unit (2). The apparatus includes a second

section flow path (200) which is formed inside a hand grip (3) disposed on a flow path connection device (18), and which includes a first port (210) connected to the outside and a second port (220) connected the first suction flow path. An opening/closing unit (300) is provided for opening and closing the second port (220).

**FIG. 1**

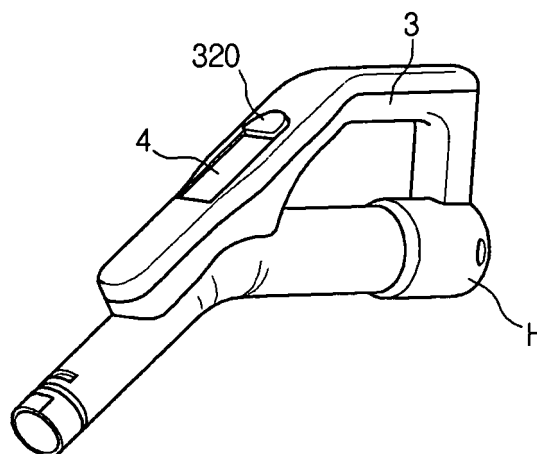



## EUROPEAN SEARCH REPORT

Application Number  
EP 09 25 1992

DOCUMENTS CONSIDERED TO BE RELEVANT			
Category	Citation of document with indication, where appropriate, of relevant passages	Relevant to claim	CLASSIFICATION OF THE APPLICATION (IPC)
E	EP 2 198 764 A2 (BSH BOSCH SIEMENS HAUSGERAETE [DE]) 23 June 2010 (2010-06-23) * paragraph [0007]; figures 1,2 *	1-3,7	INV. A47L9/00 A47L9/24 A47L9/32
X	FR 2 876 569 A1 (SEB SA [FR]) 21 April 2006 (2006-04-21) * page 3, line 24 - page 5, line 18; figures 1,2 * * page 6, line 2 - line 4 *	1-15	
A	EP 1 820 434 A1 (BLACK & DECKER INC [US]) 22 August 2007 (2007-08-22) * abstract *	1-15	
A	US 4 961 245 A (BARNES JR JAMES F [US] ET AL) 9 October 1990 (1990-10-09) * the whole document *	1-15	
A	US 5 704 090 A (BERFIELD ROBERT C [US]) 6 January 1998 (1998-01-06) * abstract *	1-15	
			TECHNICAL FIELDS SEARCHED (IPC)
			A47L
The present search report has been drawn up for all claims			
Place of search Munich		Date of completion of the search 21 January 2011	Examiner Clarke, Alister
CATEGORY OF CITED DOCUMENTS X : particularly relevant if taken alone Y : particularly relevant if combined with another document of the same category A : technological background O : non-written disclosure P : intermediate document T : theory or principle underlying the invention E : earlier patent document, but published on, or after the filing date D : document cited in the application L : document cited for other reasons & : member of the same patent family, corresponding document			

 1  
EPO FORM 1503 03.82 (P04C01)

**ANNEX TO THE EUROPEAN SEARCH REPORT  
ON EUROPEAN PATENT APPLICATION NO.**

EP 09 25 1992

This annex lists the patent family members relating to the patent documents cited in the above-mentioned European search report.  
The members are as contained in the European Patent Office EDP file on  
The European Patent Office is in no way liable for these particulars which are merely given for the purpose of information.

21-01-2011

Patent document cited in search report		Publication date	Patent family member(s)	Publication date
EP 2198764	A2	23-06-2010	DE 102008055049 A1	01-07-2010
FR 2876569	A1	21-04-2006	CN 101035456 A	12-09-2007
			EP 1811886 A1	01-08-2007
			WO 2006042927 A1	27-04-2006
EP 1820434	A1	22-08-2007	AT 452567 T	15-01-2010
			AU 2007200603 A1	06-09-2007
			CA 2579066 A1	20-08-2007
			CN 101023851 A	29-08-2007
			NZ 553209 A	30-06-2008
			US 2007199605 A1	30-08-2007
US 4961245	A	09-10-1990	AU 618685 B2	02-01-1992
			AU 6221390 A	08-08-1991
			CA 2024778 A1	06-08-1991
			DE 4102810 A1	29-08-1991
			FR 2657768 A1	09-08-1991
			JP 5003844 A	14-01-1993
			JP 6075560 B	28-09-1994
US 5704090	A	06-01-1998	NONE	